

F.A.P. RITE	SECTION	COUNTY	TOTAL SHEETS	SHEET NO.
64	(10B) BR	PEORIA	183	44
STA.		TO STA.		
FED. ROAD DIST. NO.		ILLINOIS IL RTE 29		

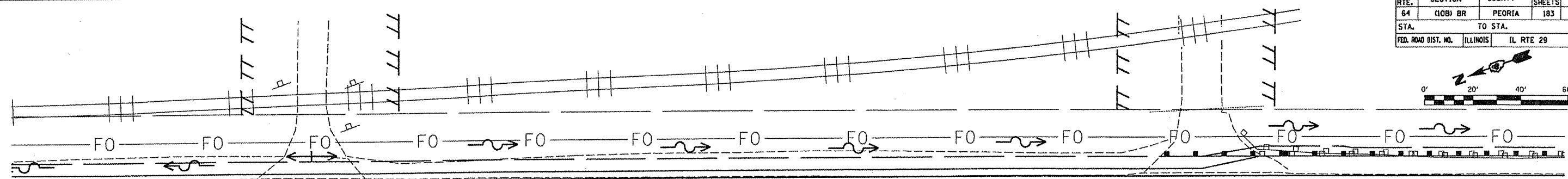
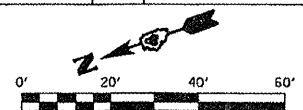

STA 75+00.00 46.87' RT
 PR INLET TY B (STD 602306)
 W/ FLAT SLAB TOP (STD 602601)
 & TY 3 F&G (STD 604006)
 FL TOG = 467.46
 FL INVERT = 465.18
 CUT TOP OF PIPE TO FIT INSIDE INLET

EX INLET & 18" RCP
 TO BE REMOVED
 EX 8" CLAY PIPE TO
 TIE INTO PR INLET

EX INLET & PIPE
 TO BE REMOVED

10'± TRANSITION FR. CCC&G, TY B-6.24
 TO CONC GUTTER, TY A (MODIFIED)
 (STD 606101-D4)

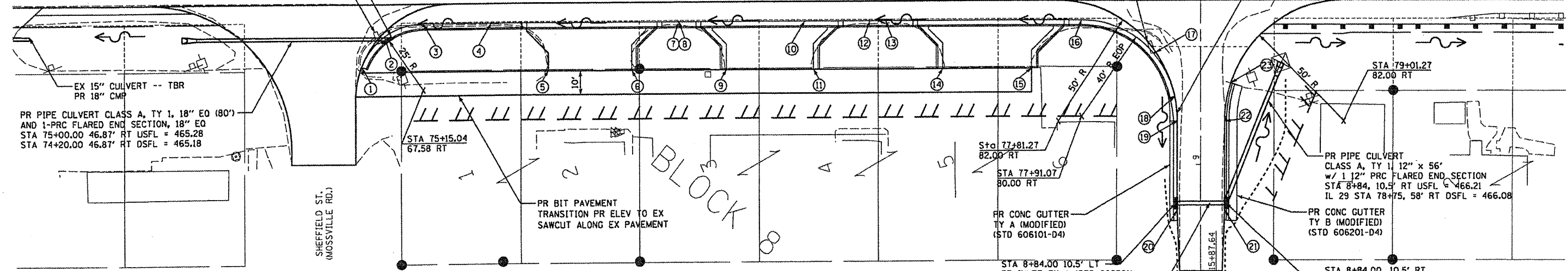

EX 15" CULVERT -- TBR
 PR 18" CMP

PR PIPE CULVERT CLASS A, TY 1, 18" EO (80')
 AND 1-PRC FLARED END SECTION, 18" EO
 STA 75+00.00 46.87' RT USFL = 465.28
 STA 74+20.00 46.87' RT DSFL = 465.18

STA 75+15.04
 67.58 RT

PR BIT PAVEMENT
 TRANSITION PR ELEV TO EX
 SAWCUT ALONG EX PAVEMENT

Sta 77+81.27
 82.00 RT

Sta 77+91.07
 80.00 RT

PR CONC GUTTER
 TY A (MODIFIED)
 (STD 606101-D4)

STA 8+84.00 10.5' LT
 PR INLET TY A (STD 602301)
 W/ TY 9 F&G (STD 604041-01)
 FL TOG = 468.26
 FL INVERT = 466.26

STA 79+01.27
 82.00 RT

PR PIPE CULVERT
 CLASS A, TY 1, 12" x 56"
 W/ 1 1/2" PRC FLARED END SECTION
 STA 8+84, 10.5' RT USFL = 466.21
 IL 29 STA 78+75, 58' RT DSFL = 466.08

PR CONC GUTTER
 TY B (MODIFIED)
 (STD 606201-D4)

STA 8+84.00, 10.5' RT
 PR INLET TY B, SPECIAL (SEE DETAIL BELOW)
 W/ SPECIAL FRAME & GRATE
 (SEE SPECIAL PROVISIONS)
 FL TOG = 468.26
 FL INVERT = 466.21

POINT	STATION	EDGE OF PVT/SHLDR OFFSET	EDGE OF PVT/SHLDR ELEVATION	FLOWLINE STATION	FLOWLINE OFFSET	FLOWLINE ELEVATION
1	74+89.28	57.77' RT	488.02	74+91.13	58.48' RT	487.88
2	74+98.82	45.27' RT	487.67	75+00	48.87' RT	487.46
3	75+15.04	40' RT	487.84	75+15.04	42' RT	487.49
4	75+43.80	40' RT	487.74	75+43.80	42' RT	487.8
5	75+87.42	80' RT	488.82	75+85.42	60' RT	488.5
6	75+02.59	60' RT	488.74	76+04.59	60' RT	488.62
7	76+22.42	40' RT	488.06	76+22.42	42' RT	487.92
8	76+22.44	40' RT	488.06	76+22.44	42' RT	487.92
9	76+42.27	60' RT	488.57	76+40.27	60' RT	488.45
10	76+28.82	40' RT	488.27	76+78.83	42' RT	488.13
11	76+75.82	60' RT	488.7	76+77.92	60' RT	488.58
12	77+02.44	40' RT	488.49	77+02.44	42' RT	488.35
13	77+09.02	40' RT	488.54	77+09.02	42' RT	488.4
14	77+32.84	60' RT	489.05	77+30.84	60' RT	488.94
15	77+70.20	60' RT	489.31	77+72.20	60' RT	489.19
16	77+91.07	40' RT	489.2	77+91.07	42' RT	489.05
17	78+22.38 (IL 29)	53.54' RT	489.17	78+19.91 (IL 29)	55.25' RT	489.05
	9+46.46 (TR 103 W)	18.88' LT		9+44.75 (TR 103 W)	21.37' LT	
18	9+28 (TR 103 W)	11.01' LT	489.18	9+27.60 (TR 103 W)	12.97' LT	488.91
19	9+18 (TR 103 W)	10' LT	489	9+18 (TR 103 W)	11.5' LT	488.75
20	8+81 (TR 103 W)	10' LT	488.32	8+81 (TR 103 W)	11.5' LT	488.28
21	8+81 (TR 103 W)	10' RT	488.32	8+81 (TR 103 W)	11.5' RT	488.28
22	9+18 (TR 103 W)	10' RT	489	9+28 (TR 103 W)	11.5' RT	488.75
23	9+33.69 (TR 103 W)	12.53' RT	489.11	9+33.28	13.378' RT	488.88

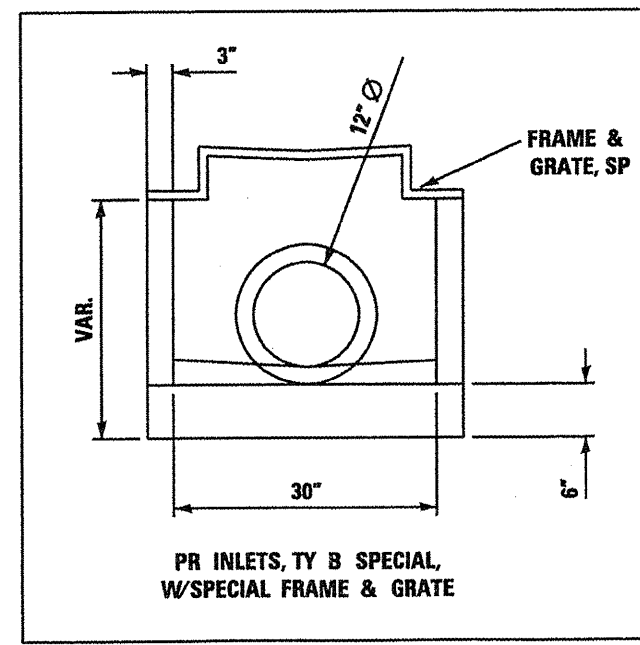

COOMBE-BLOXDORF P.C.
 Engineers/Land Surveyors
 Springfield, Illinois
 Design Firm License No. 184-002703

REVISIONS	
NAME	DATE

ILLINOIS DEPARTMENT OF TRANSPORTATION
**CONCRETE CURB & GUTTER
 AND GUTTER ELEVATION
 DETAIL**
 SCALE: _____
 DATE AUG. 2008
 DRAWN BY CFC
 CHECKED BY MCB/CLS

12/13/2008 #FILE ABBREV#