

The existing 3 span steel beam structures were constructed in 1965 as section 26-0B-4 at Sta. 138+78. SN 026-0009 carries FAI-70 eastbound and SN 026-0010 carries FAI-70 westbound. The proposed project consists of new expansion joints, partial and full depth deck patching, new microsilica wearing surface, and new deck drains.

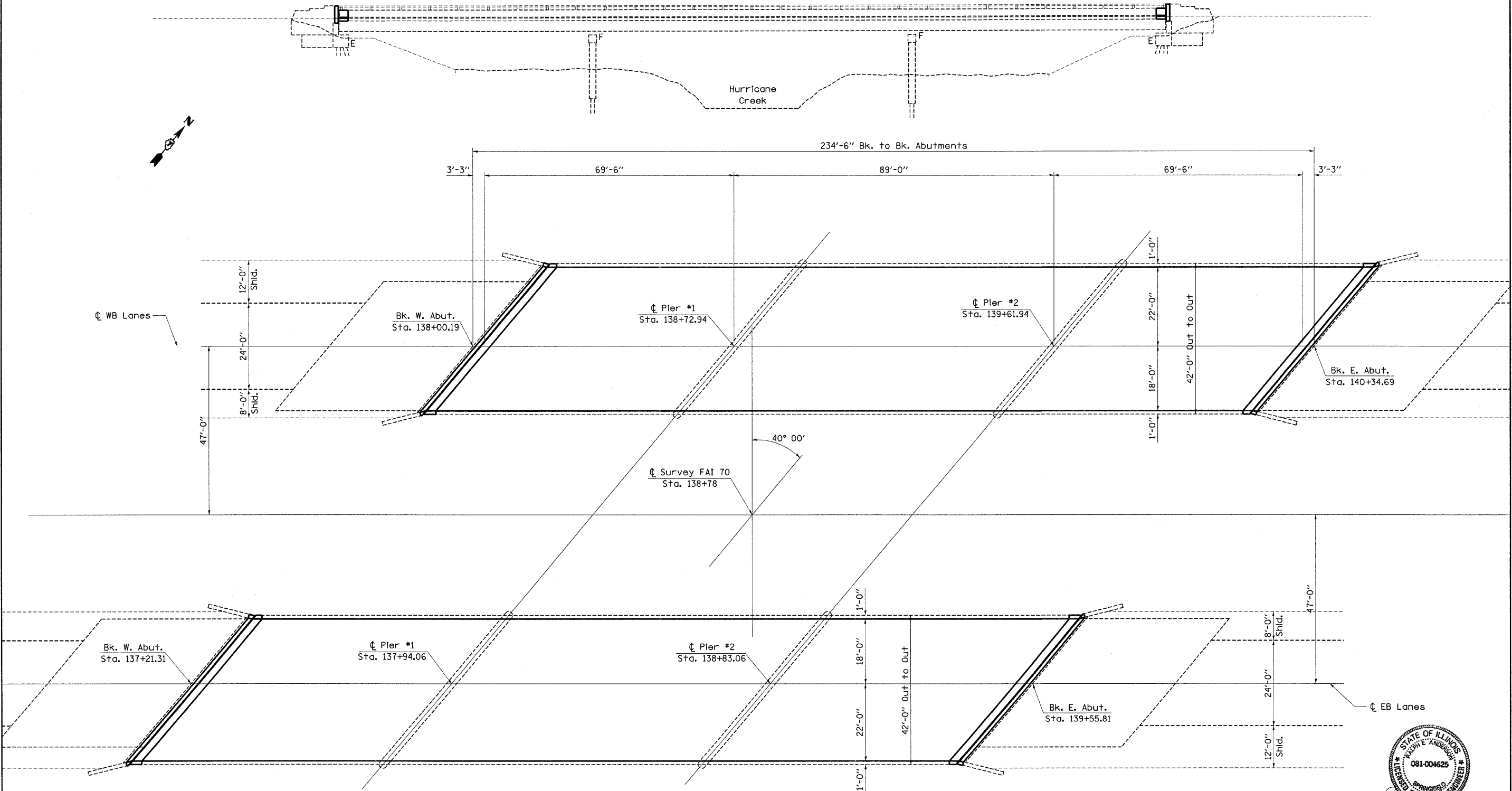

Expires Nov. 30, 2010

FILE NAME =	USER NAME = swartzrw	DESIGNED -	REVISED -	STATE OF ILLINOIS DEPARTMENT OF TRANSPORTATION	GENERAL PLAN & ELEVATION SN. 026-0009 (EB) & SN. 026-0010 (WB)		F.A.I. RTE.	SECTION	COUNTY	TOTAL SHEETS	SHEET NO.		
ca:\pwwork\pwwid\SWARTZRW\dms36228\theledesign_94993.dgn	eldesign_94993.dgn	DRAWN -	REVISED -		SCALE: N/A	SHEET NO. 2 OF 14 SHEETS	STA.	TO STA.	70	D-7 BRIDGE DECK REPAIRS	FAYETTE	59	47
PLOT SCALE = 20.0000' / 1" IN.		CHECKED -	REVISED -						CONTRACT NO. 94993				
PLOT DATE = 10/17/2009		DATE -	REVISED -						ILLINOIS FED. AID PROJECT				