

F.A.S.	SECTION	COUNTY	TOTAL SHEETS	SHEET NO.
1819	06-00074-00-RS	WABASH	2	1
FED. ROAD DIST. NO. 7		ILLINOIS	GOODSON ORCHARD ROAD	
LEC JOB # H061005WB			CONTRACT # 95549	

**STATE OF ILLINOIS**  
**DEPARTMENT OF TRANSPORTATION**  
**DIVISION OF HIGHWAYS**

# PLANS FOR PROPOSED FEDERAL-AID SECONDARY PROJECT

**F.A.S. 1819 SECTION 06-00074-00-RS WABASH COUNTY**

**PROJECT RS-1819(106) JOB NO. C-97-066-08**

**INDEX OF SHEETS**

SHEET NO.	DESCRIPTION
1	TITLE SHEET
2	TYPICAL SECTIONS, SUMMARY OF QUANTITIES, GENERAL NOTES, MISCELLANEOUS DETAILS

**THE FOLLOWING STANDARDS ARE A PART OF THESE PLANS AND ARE INCLUDED AFTER SHEET NO. 2**

000001-05	STANDARD SYMBOLS, ABBREVIATIONS & PATTERNS
701306-02	LANE CLOSURE, 2L, 2W, SLOW MOVING OPERATIONS DAY ONLY, FOR SPEEDS ≥ 45 MPH
701311-03	LANE CLOSURE 2L, 2W MOVING OPERATIONS-DAY ONLY
701901-01	TRAFFIC CONTROL DEVICES
780001-02	TYPICAL PAVEMENT MARKINGS

CONTRACT NO. 95549  
DESIGN CLASS - MAJOR COLLECTOR  
CURRENT A.D.T. = 1000  
DESIGN SPEED = 50 MPH

**J.U.L.I.E.**  
**JOINT UTILITY LOCATION INFORMATION FOR EXCAVATION**  
**1-800-892-0123**

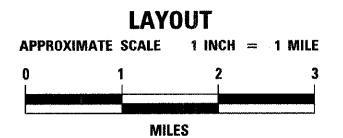
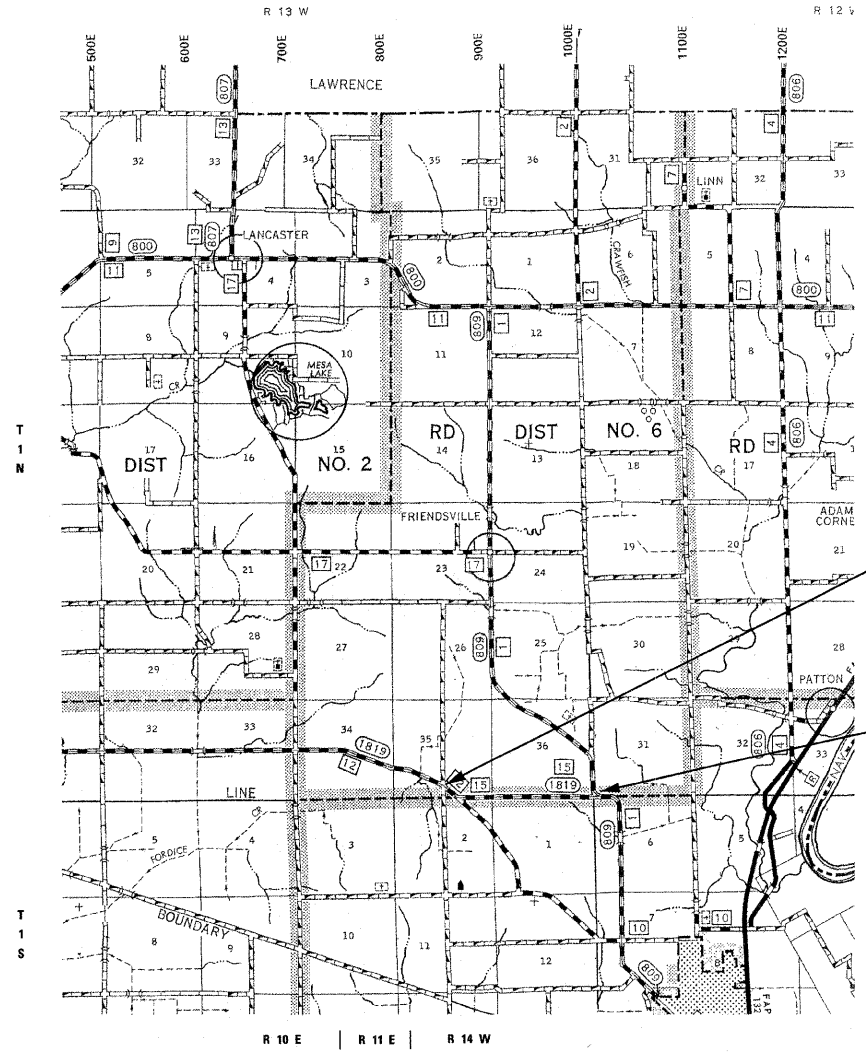

GROSS LENGTH	8,833 FT	1.6729 MILES
OMISSION	0 FT	0 MILES
NET LENGTH	8,833 FT	1.6729 MILES

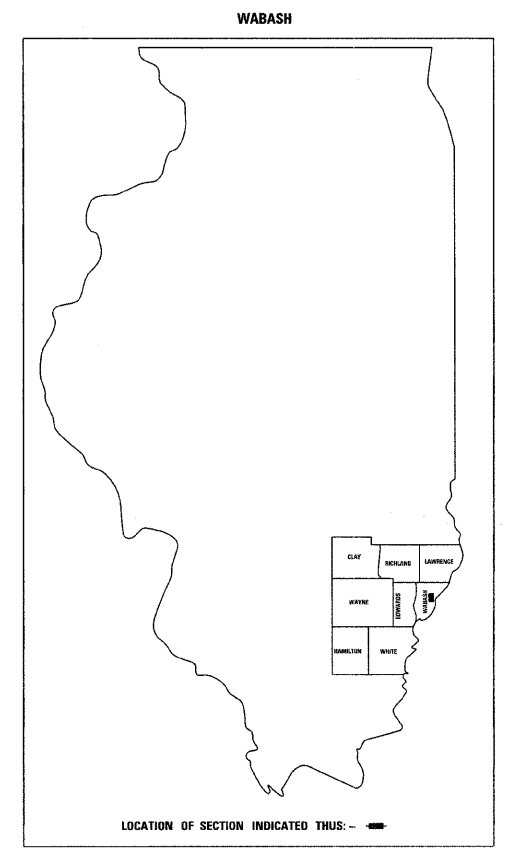

323 W. 3RD ST.  
P.O. BOX 160  
MT. CARMEL, IL  
62863  
PHONE: (618)-262-8651  
FAX: (618)-263-3327

405 W. STATE ST.  
SUITE 1  
PRINCETON, IN  
47670  
PHONE: (812)-386-7611  
FAX: (812)-385-2612



PROFESSIONAL  
DESIGN FIRM  
LAND SURVEY &  
PROFESSIONAL  
ENGINEERING  
CORPORATION  
184-000887  
(62-032435)(35-002769)



AARON M. MEFFORD  
NAME  
*Aaron M. Mefford*  
SIGNATURE  
12-08-08  
DATE  
11-30-09  
EXPIRES

APPROVED 12-08 20 08  
*Aaron M. Mefford*  
COUNTY ENGINEER

PASSED 1-7 20 09  
*Maureen Cantel*  
DISTRICT SEVEN ENGINEER OF  
LOCAL ROADS & STREETS

Releasing For  
Bid Based on  
Limited Review 1-7 20 09  
*Roger R. Bushnell*  
DEPUTY DIRECTOR OF HIGHWAYS,  
REGION FOUR ENGINEER  
STATE OF ILLINOIS  
DEPARTMENT OF TRANSPORTATION