

STATE OF ILLINOIS
DEPARTMENT OF TRANSPORTATION

PLANS FOR
PROPOSED LOCAL AGENCY IMPROVEMENT
FEDERAL AID URBAN PROJECT

ROUTE NO.	SECTION	CITY	TOTAL SHEETS	SHEET NO.
FAU 7356	06-00007-00-RP	FORSYTH	25	1
FED. ROAD DIST. NO.		ILLINOIS	PROJECT M-5169 (041)	

CONTRACT NUMBER 95564

PLAN 1" = 20'
PROFILE HOR. 1" = 20'
PROFILE VERT. 1" = 2'
CROSS SECTIONS HOR. 1" = 5'
VERT. 1" = 2'

VILLAGE OF FORSYTH, ILLINOIS

HICKORY POINT DRIVE IMPROVEMENTS

FAU ROUTE 7356
SECTION 06-00007-00-RP
PROJECT M-5169 (041)
C - 97-017-09
MACON COUNTY, ILLINOIS

UTILITIES

AMEREN IP 500 S. 27TH STREET DECATUR, IL 62521	GAS AND ELECTRIC	800-892-7715
ATT 2250 N. JASPER ST. DECATUR, IL 62526	TELEPHONE POLES, BOXES AND CABLES	217-429-8596
COMCAST 1275 N. WATER STREET DECATUR, IL 62521	POLES, BOXES AND CABLES	217-424-8474
VILLAGE OF FORSYTH 301 S. US ROUTE 51 FORSYTH, IL 62535	SEWERS AND WATER MAINS	217-877-9445

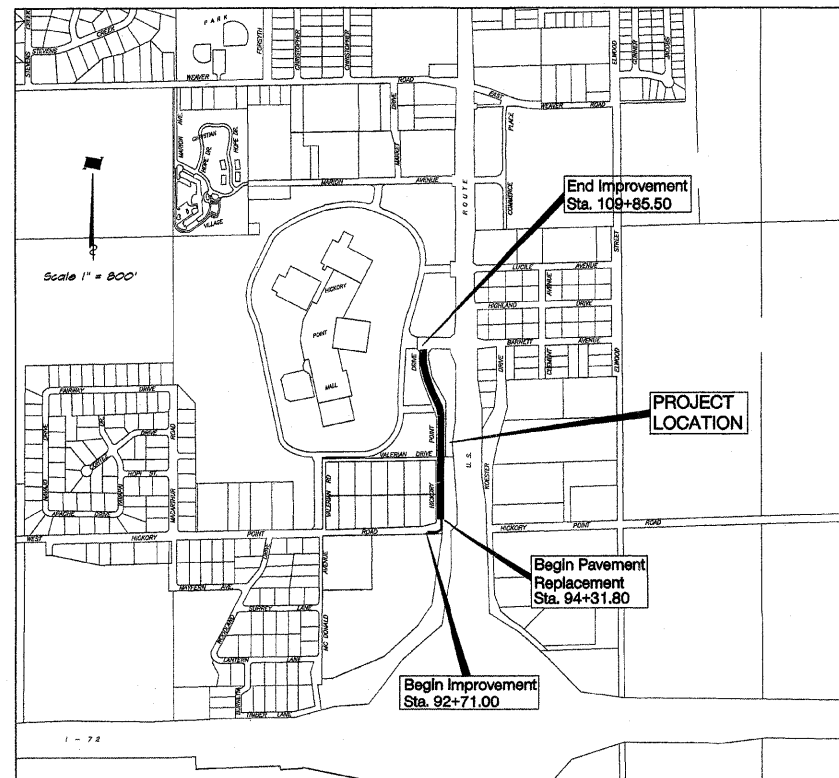

LOCATION MAP
TOTAL LENGTH OF PROJECT = 1714.50 FEET = 0.325 MILES
NET LENGTH OF PROJECT = 1714.50 FEET = 0.325 MILES

DESIGN DESIGNATION
390 (2018) COLLECTOR 0.441 (PCC-20)
DESIGN SPEED = 30 MPH
ADT = 9450 PC = 3240 SU = 175 MU = 35

IDOT STANDARDS

- 280001-04 Temporary Erosion Control Systems
- 420001-07 Pavement Joints
- 420108-04 36' Jointed PCC Pavement
- 420111-02 PCC Pavement Roundouts
- 424001-05 Curb Ramps for Sidewalks
- 442101-07 Class B Patches
- 542301-02 Precast Concrete Flared End Sections
- 602301-02 Inlet, Type A
- 602306-02 Inlet, Type B
- 602401-02 Manhole, Type A
- 602801-02 Precast Reinforced Concrete Flat Slab Top
- 604001-03 Frames and Lids, Type 1
- 606001-04 Concrete Curb Type B and Combination Concrete Curb and Gutter
- 606301-04 PC Concrete Islands and Medians
- 701901-01 Traffic Control Devices
- 780001-02 Typical Pavement Markings
- BLR 21-8 Typical Application of Traffic Control Devices for Construction on Rural Local Highways
- BLR 22-6 Typical Application of Traffic Control Devices for Construction on Rural Local Highways

BAINBRIDGE-GEE-MILANSKI & ASSOC., INC.
1670 S. TAYLORVILLE RD.
DECATUR, ILLINOIS 62521
TELE: (217) 423-8800

INDEX TO SHEETS
SEE SHEET NO. 2

NOTE

Underground facilities, structures and utilities have been plotted from available surveys and records and their locations must be considered approximate only. There may be others, the existence of which is presently not known. The depth of utilities is assumed to be normal and customary. Contractor shall verify location and depth of all utilities prior to construction.

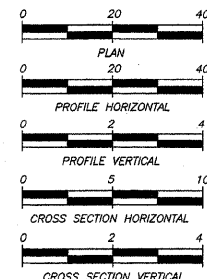

IT'S THE LAW IN ILLINOIS

PRIOR TO COMMENCING ANY CONSTRUCTION OR EXCAVATION, THE CONTRACTOR SHALL VERIFY THE LOCATION OF ALL UTILITIES BY CALLING:
J.U.L.I.E. * 1-800-892-0123 or Cell 811

* Joint Utilities Locating Information for Excavators.



by *Michael H. Price*
date 10/31/2008
expires NOV.30, 2009

APPROVED	October 31, 2008
<i>Harold P. Schmitt</i> MAYOR, VILLAGE OF FORSYTH, ILLINOIS	
PASSED	Jan 22, 2009
<i>Maureen Costello</i> DISTRICT SEVEN ENGINEER OF LOCAL ROADS & STREETS	
Releasing For Bid Based on Limited Review	Jan 22, 2009
<i>Ryan L. Bushnell</i> DEPUTY DIRECTOR OF HIGHWAYS, REGION FOUR ENGINEER	
STATE OF ILLINOIS DEPARTMENT OF TRANSPORTATION	