

DETAILS OF SURFACING AT INTERSECTIONS AND SIDEROADS

F.A.S.	SECTION	COUNTY	TOTAL SHEETS	SHEET NO.
1884	06-0062-00-RS	EDWARDS	4	3
FED. ROAD DIST. NO. 7		ILLINOIS	RED HILL RD SOUTH	
LEC JOB # 0071004ED			CONTRACT # 95566	

DETAIL OF TAPER STA. 154+00 TO STA. 154+50

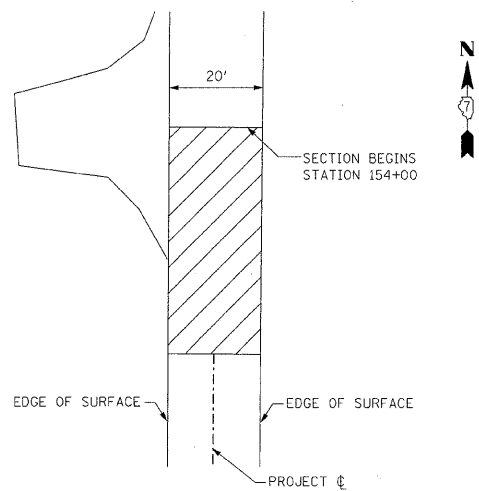

NOTE: THE QUANTITY SHOWN FOR HOT-MIX ASPHALT SURFACE COURSE, MIX "C", N50 INCLUDES 8.8 TONS OF MATERIAL FOR THE TAPER FROM STATION 154+50 TO STATION 155+00.

PROFILE TAPER

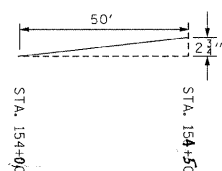

DETAIL OF INTERSECTION 180+23 LT AND 180+26 RT

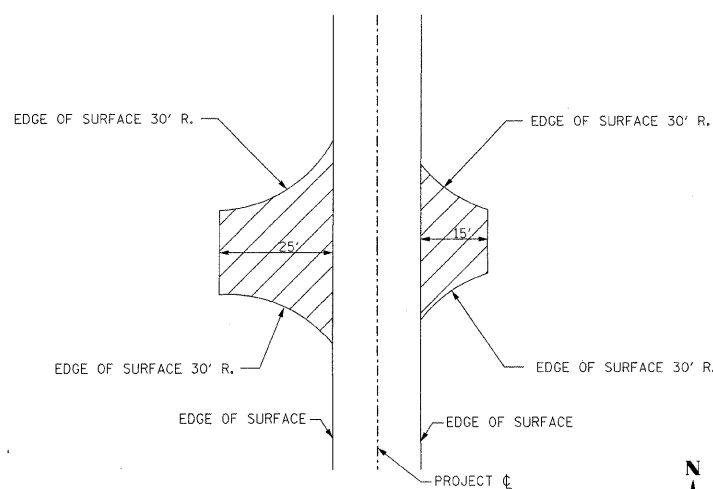

NOTE: THE QUANTITY SHOWN FOR HOT-MIX ASPHALT SURFACE COURSE, MIX "C", N50 INCLUDES 5.6 TONS OF MATERIAL FOR THE SIDEROAD LT APPROACH AND RADII AND 11.3 TONS OF MATERIAL FOR THE SIDEROAD RT. APPROACH AND RADII.

PROFILE RT

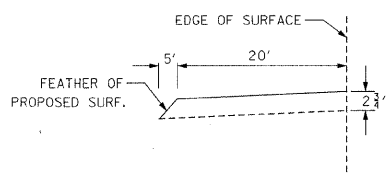

PROFILE LT

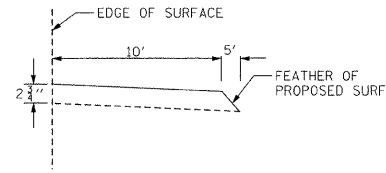

DETAIL OF TAPER STA. 217+46.5 TO STA. 217+96.5 & STA. 218+56 TO STA. 219+06

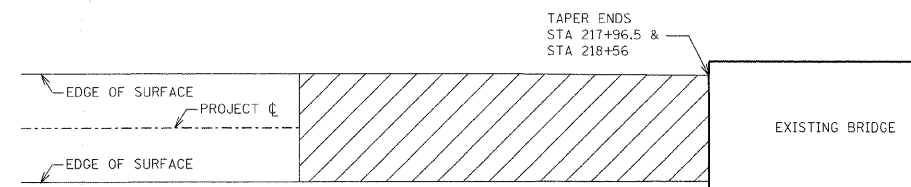

BUTT JOINT DETAIL

STA 217+46.5 TO STA 217+96.5 & STA 218+56 TO STA 219+06

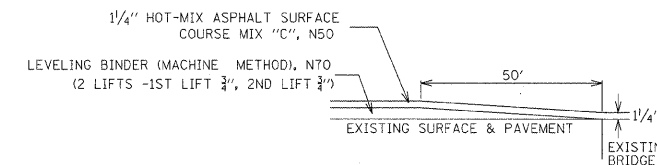

DETAIL OF INTERSECTION 233+37 LT AND 234+10 RT

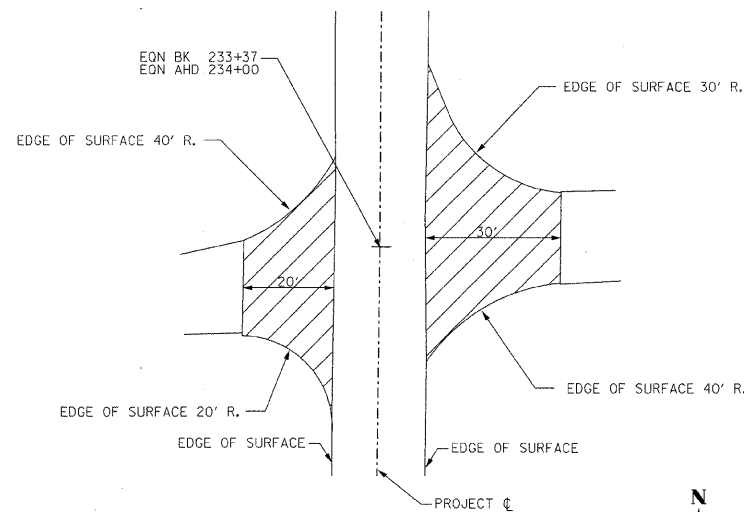

NOTE: THE QUANTITY SHOWN FOR HOT-MIX ASPHALT SURFACE COURSE, MIX "C", N50 INCLUDES 17.3 TONS OF MATERIAL FOR THE SIDEROAD LT APPROACH AND RADII AND 11.1 TONS OF MATERIAL FOR THE SIDEROAD RT. APPROACH AND RADII.

PROFILE RT

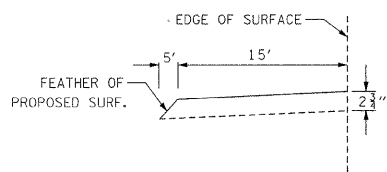

PROFILE LT

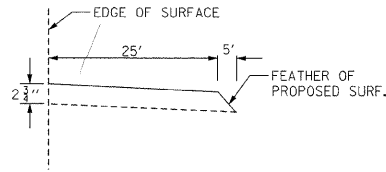

DETAIL OF INTERSECTION LT, STA. 273+83

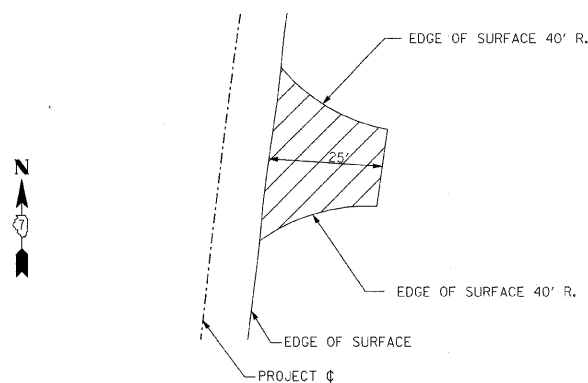

NOTE: THE QUANTITY SHOWN FOR HOT-MIX ASPHALT SURFACE COURSE, MIX "C", N50 INCLUDES 10.4 TONS OF MATERIAL FOR THE SIDEROAD LT APPROACH AND RADII.

PROFILE LT

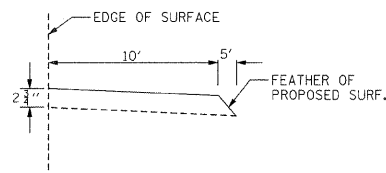

DETAIL OF INTERSECTION RT, STA. 287+27

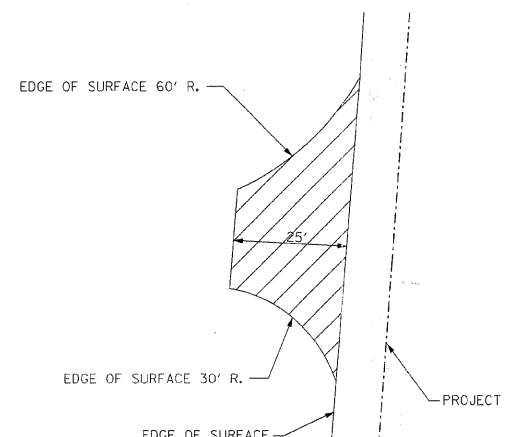

NOTE: THE QUANTITY SHOWN FOR HOT-MIX ASPHALT SURFACE COURSE, MIX "C", N50 INCLUDES 16.3 TONS OF MATERIAL FOR THE SIDEROAD RT. APPROACH AND RADII.

PROFILE RT

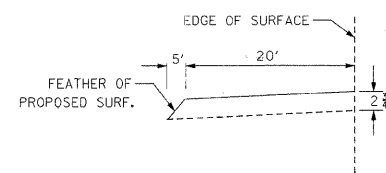

DETAIL OF TAPER STA. 288+00 TO STA. 288+50

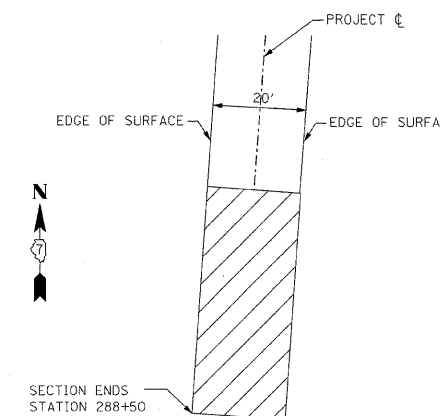

NOTE: THE QUANTITY SHOWN FOR HOT-MIX ASPHALT SURFACE COURSE, MIX "C", N50 INCLUDES 8.8 TONS OF MATERIAL FOR THE TAPER FROM STATION 288+00 TO STATION 288+50.

PROFILE TAPER

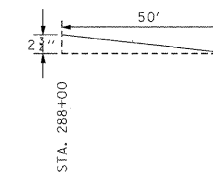

323 W. 3RD ST.
P.O. BOX 160
MT. CARMEL, IL
62863
PHONE:
(618)-262-8651
FAX:
(618)-263-3327

405 W. STATE ST.
SUITE 1
PRINCETON, IN
47670
PHONE:
(812)-386-7611
FAX:
(812)-385-2812



PROFESSIONAL DESIGN FIRM
LAND SURVEY &
PROFESSIONAL
ENGINEERING CORPORATION
184-000887
(62-032435)(35-002769)



AARON M. MEFFORD
NAME
Signature
12-08-08
DATE
11-30-09
EXPIRES