

F.A.U. RTE.	SECTION	COUNTY	TOTAL SHEETS	SHEET NO.
8894	05-00073-01-PV	MADISON	68	14
STA. 86+50		TO STA. 92+50		
FED. ROAD DIST. NO.		ILLINOIS FEDERAL AID PROJECT		

REVISION #1: 2/6/09

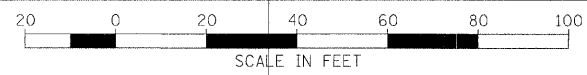

PLAN	DATE
BY	
CHECKED	
DATE	
NO.	

PROFILE	DATE
BY	
CHECKED	
DATE	
NO.	

PLOT DATE = 2/6/2009
 FILE NAME = I:\road\pvt\11074512\drain\shades\014_PP-03.dgn
 USER NAME = Russj Millburne

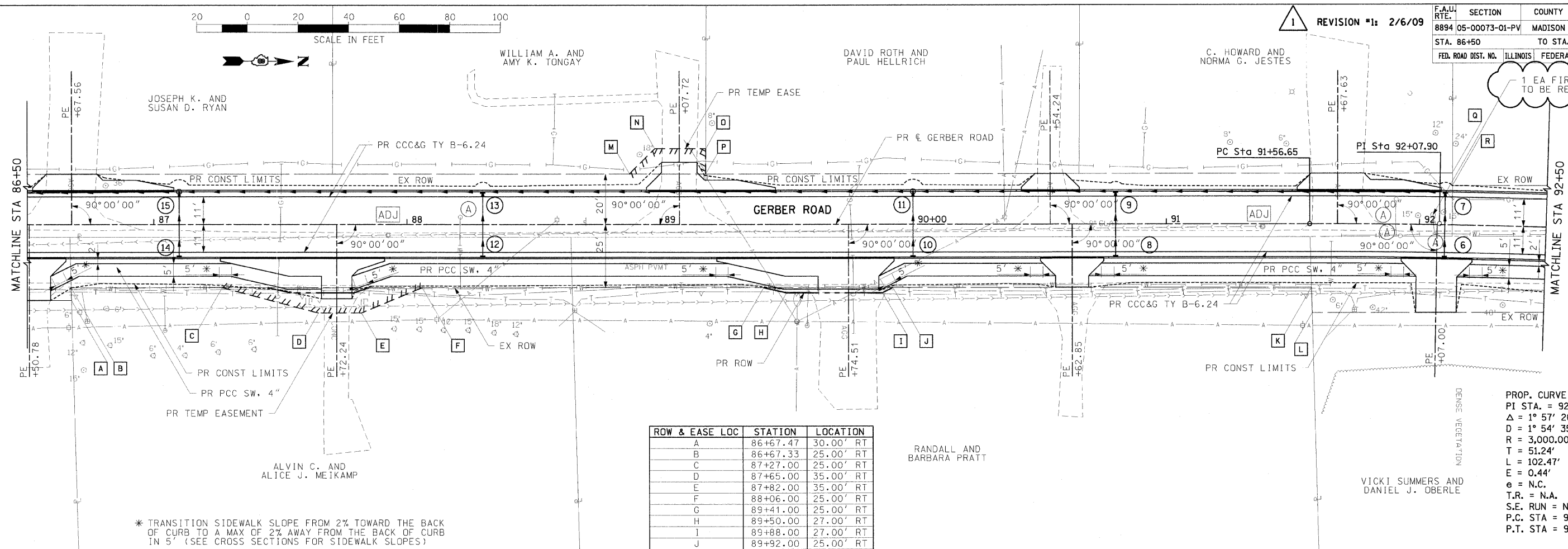

ROW & EASE LOC	STATION	LOCATION
A	86+67.47	30.00' RT
B	86+67.33	25.00' RT
C	87+27.00	25.00' RT
D	87+65.00	35.00' RT
E	87+82.00	35.00' RT
F	88+06.00	25.00' RT
G	89+41.00	25.00' RT
H	89+50.00	27.00' RT
I	89+88.00	27.00' RT
J	89+92.00	25.00' RT
K	91+57.34	25.00' RT
L	91+57.61	35.00' RT
M	88+88.00	20.00' LT
N	88+98.00	30.00' LT
O	89+18.15	30.00' LT
P	89+18.11	20.00' LT
Q	92+12.55	20.52' LT
R	92+12.64	15.53' LT

* TRANSITION SIDEWALK SLOPE FROM 2% TOWARD THE BACK OF CURB TO A MAX OF 2% AWAY FROM THE BACK OF CURB IN 5' (SEE CROSS SECTIONS FOR SIDEWALK SLOPES)

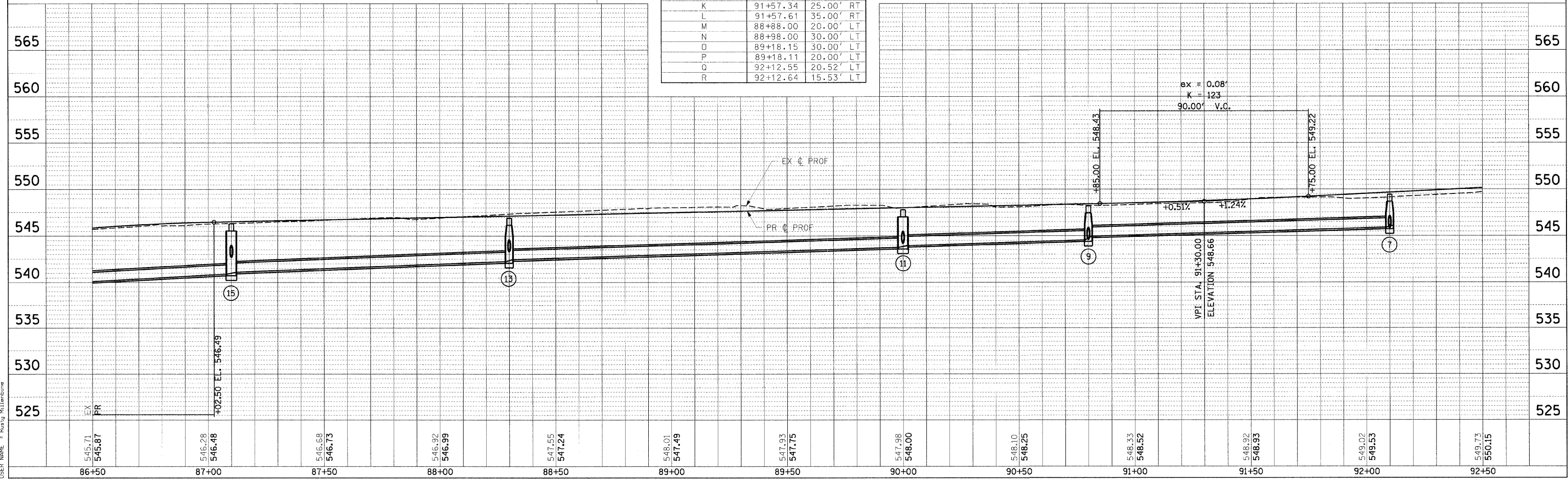

PLAN & PROFILE: GERBER ROAD - STA 86+50.00 TO STA 92+50.00