

F.A.U. RTE.	SECTION	COUNTY	TOTAL SHEETS	SHEET NO.
8894	05-00073-01-PV	MADISON	68	40
STA. 92+50.00		TO STA. 103+79.86		
FED. ROAD DIST. NO. ILLINOIS		FEDERAL AID PROJECT		

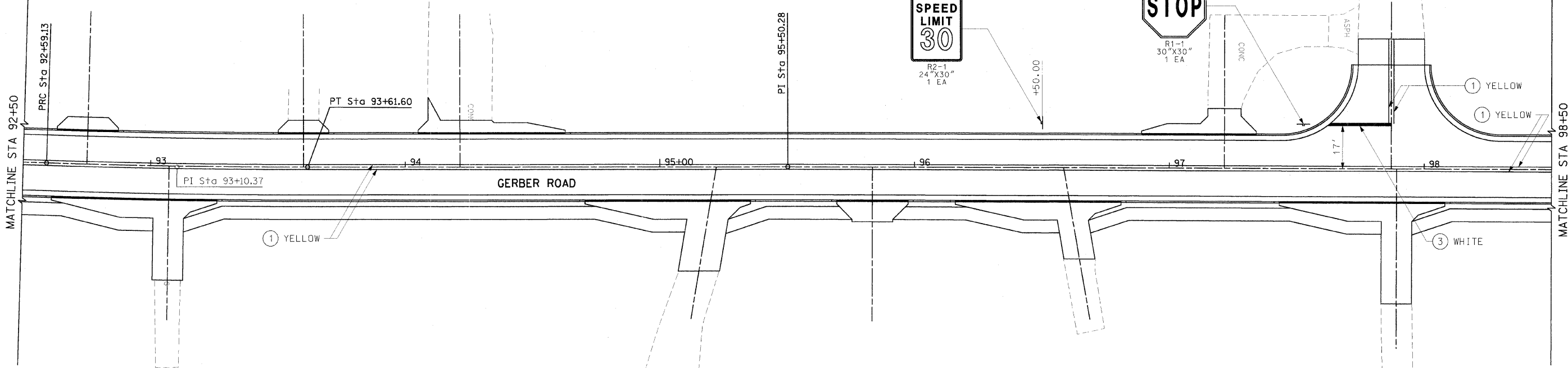

LEGEND

- ① THERMOPLASTIC PAVEMENT MARKING - LINE 4"
- ② THERMOPLASTIC PAVEMENT MARKING - LINE 6"
- ③ THERMOPLASTIC PAVEMENT MARKING - LINE 12"

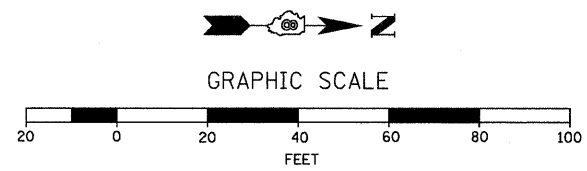
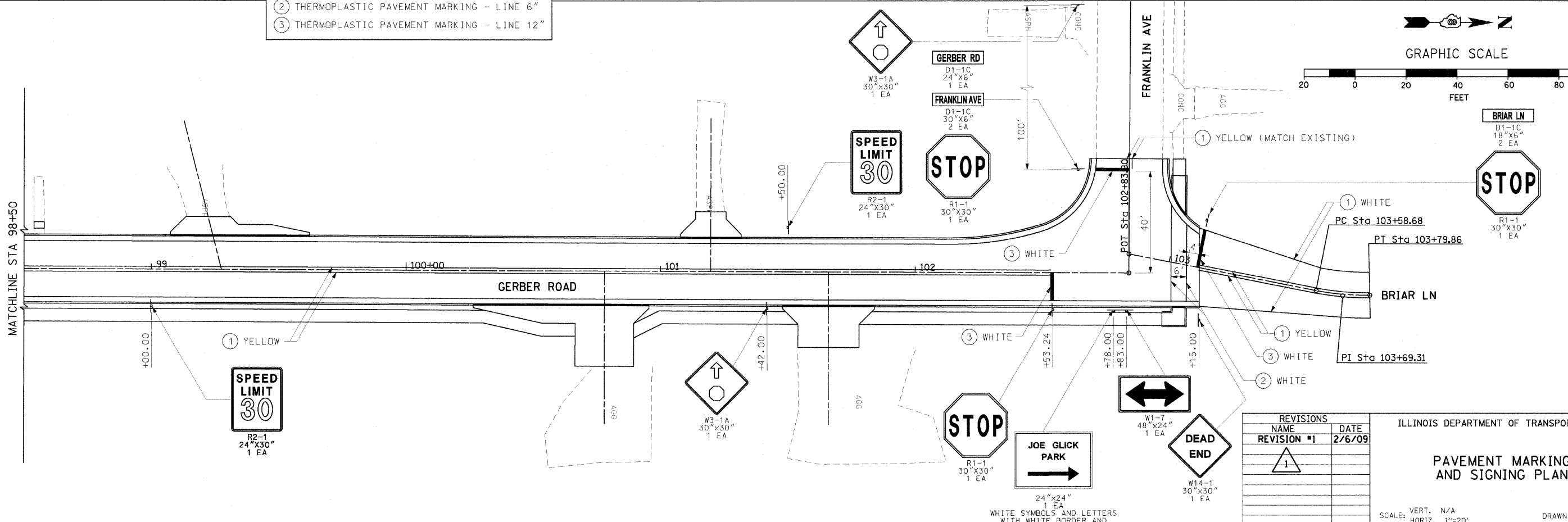
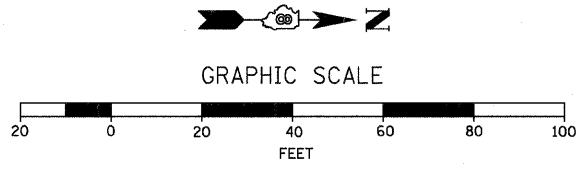

REVISIONS		
NAME	REVISION #1	DATE
		2/6/09

ILLINOIS DEPARTMENT OF TRANSPORTATION

PAVEMENT MARKING AND SIGNING PLAN

SCALE: VERT. N/A
 HORIZ. 1"=20'
 DATE 11/5/03

DRAWN BY: AJK, RJM
 CHECKED BY: JWB

PAVEMENT MARKING AND SIGNING PLAN: GERBER ROAD - STA. 92+50.00 TO STA. 103+79.86