

F.A.U. RTE.	SECTION	COUNTY	TOTAL SHEETS	SHEET NO.
8894	05-00073-01-PV	MADISON	68	1
CONTRACT 97364		FEDERAL AID PROJECT		

STATE OF ILLINOIS
DEPARTMENT OF TRANSPORTATION
DIVISION OF HIGHWAYS

PROPOSED HIGHWAY PLANS

F.A.U. ROUTE 8894 (GERBER ROAD)
SECTION 05-00073-01-PV
PROJECT NO. M-5011(206)
CITY OF EDWARDSVILLE
GERBER ROAD FROM EAST LAKE DRIVE
TO FRANKLIN AVENUE
MADISON COUNTY
JOB NUMBER C-98-340-06
STU PROGRAM

INDEX OF SHEETS

- 1 COVER SHEET
- 2 GENERAL NOTES AND SUMMARY OF QUANTITIES
- 3-5 TYPICAL SECTIONS
- 6-10 SCHEDULE OF QUANTITIES
- 11 ALIGNMENT AND BENCHMARKS
- 12-16 PLAN AND PROFILE SHEETS
- 17-18 TRAFFIC CONTROL PLAN
- 19-22 EROSION CONTROL PLAN
- 23-24 WATERMAIN PLAN AND PROFILE
- 25-26 WATERMAIN GENERAL NOTES AND MISCELLANEOUS DETAILS
- 27-28 SANITARY SEWER PLAN AND PROFILE
- 29 SANITARY SEWER GENERAL NOTES AND MISCELLANEOUS DETAILS
- 30-32 INTERSECTION DETAILS
- 33-35 DRIVEWAY DETAILS
- 36-37 MISCELLANEOUS DETAILS
- 38-40 PAVEMENT MARKING AND SIGNING PLAN
- 41-43 REMOVAL PLAN
- 44-46 SEGMENTAL CONCRETE BLOCK WALL PLAN AND PROFILE SHEETS
- 47-49 SEGMENTAL CONCRETE BLOCK WALL DETAILS
- 50-68 CROSS SECTIONS

IDOT STANDARDS

- 000001-05
- 001001-02
- 001006
- 280001-04
- 424001-05
- 542301-02
- 542606-01
- 602301-02
- 602306-02
- 602401-02
- 602601-02
- 602701-02
- 604001-03
- 604011-04
- 604036-02
- 604091-02

LIST OF UTILITIES

- CITY OF EDWARDSVILLE
- AT&T
- AMEREN IP
- CHARTER COMMUNICATIONS
MAPPING AND DESIGN
DEPARTMENT
- P.O. BOX 407
EDWARDSVILLE, IL 62025-0407
PHONE: (618) 692-7535
- 203 GOETHE STREET
FLOOR 2 1/2
COLLINSVILLE, IL 62234
PHONE: (618) 346-6426
- 2600 N CENTER STREET
PO BOX 378, MC Q-10
MARYVILLE, IL 62062-0378
PHONE: (618) 346-1236
- 941 CHARTER COMMONS
TOWN & COUNTRY, MO 63017



LOCATION OF SECTION INDICATED THUS: -

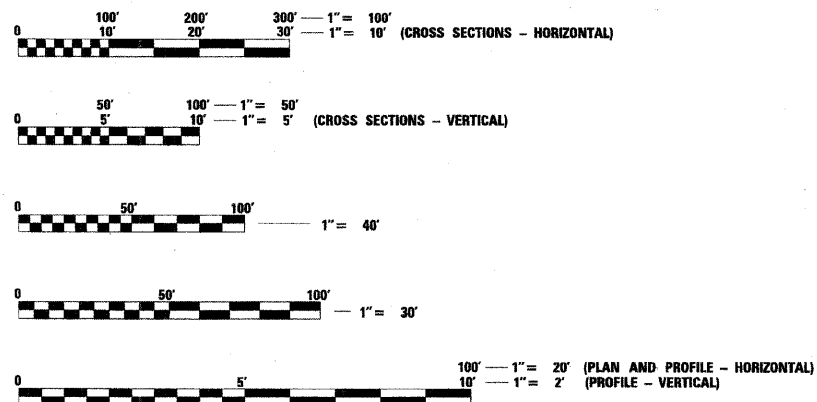

FULL SIZE PLANS HAVE BEEN PREPARED USING STANDARD ENGINEERING SCALES. REDUCED SIZED PLANS WILL NOT CONFORM TO STANDARD SCALES. IN MAKING MEASUREMENTS ON REDUCED PLANS, THE ABOVE SCALES MAY BE USED.

J.U.L.I.E.
JOINT UTILITY LOCATION INFORMATION FOR EXCAVATION
1-800-892-0123

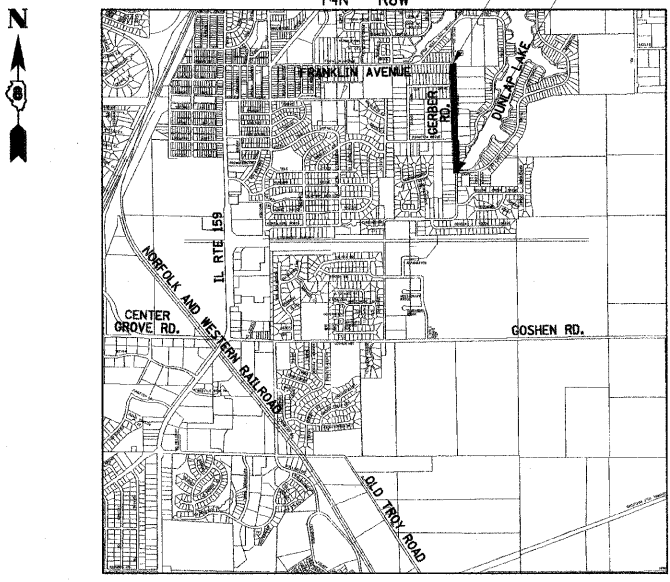

LOCATION MAP



PROJECT GROSS AND NET LENGTHS = 2453.90 FEET (0.465 MILES)
DESIGN DESIGNATION - URBAN COLLECTOR
CURRENT ADT - 2000
DESIGN TRAFFIC - 3031
DESIGN SPEED - 30 MPH

STATE OF ILLINOIS
DEPARTMENT OF TRANSPORTATION
DIVISION OF HIGHWAYS

APPROVED 12/2/08 20
Gary Niebur
GARY NIEBUR, MAYOR

PASSED 12/16 20 08
[Signature]
DISTRICT 8 ENGINEER OF LOCAL ROADS AND STREETS

RELEASING FOR BID
BASED ON LIMITED
REVIEW 12/16 20 08
[Signature]
DEPUTY DIRECTOR OF HIGHWAYS, REGION 5 ENGINEER

SIGNATURE: *Jack W. Blahnik*
DATE SIGNED: 12/5/08
LICENSE EXPIRATION DATE: 11/30/09

SEAL
CRAWFORD MURPHY & TILLY, INC.
CONSULTING ENGINEERS
SPRINGFIELD, IL ■ AURORA, IL ■ PEORIA, IL
ROCKFORD, IL ■ ST. LOUIS, MO ■ CHICAGO, IL
EDWARDSVILLE, IL ■ INDIANAPOLIS, IN
COLUMBUS, OH