

GENERAL NOTES

- 1. WHERE THE PROPOSED BITUMINOUS SURFACE ABUTS THE EXISTING PAVEMENT THAT IS TO REMAIN, THE EXISTING PAVEMENT SHALL BE SAW CUT TO PRODUCE A STRAIGHT VERTICAL FACE TO ABUT THE PROPOSED SURFACE TO. COST OF THIS WORK SHALL BE INCLUDED IN THE PRICE BID FOR PAY ITEM AR401655 "BUTT JOINT CONSTRUCTION" AND NO ADDITIONAL COMPENSATION WILL BE ALLOWED.
- 2. PRIOR TO PLACEMENT OF THE PROPOSED BITUMINOUS SURFACE, THE VERTICAL FACES OF ALL ABUTTING EXISTING PAVEMENT WILL BE SPRAYED WITH AN APPLICATION OF BITUMINOUS TACK COAT. AN APPLICATION RATE OF 0.20 GALLONS PER SQUARE YARD WAS USED FOR CALCULATING THE QUANTITY OF TACK COAT FOR THIS APPLICATION. THE EXACT AMOUNT OF BITUMINOUS TACK COAT TO BE USED SHALL BE DETERMINED BY THE RESIDENT ENGINEER AT THE TIME OF CONSTRUCTION.

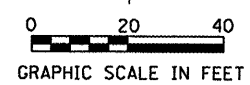

PLAN	DATE
REVISIONS	BY
ALIGNED	CHECKED
NOTE BOOK	NO.
CADD FILE NAME	

PROFILE	DATE
SURVEYED	BY
PROCESSED	CHECKED
B.M. NOTED	NO.
STRUCTURE NOTATIONS CHD	

FILE NAME = P:\07\1899\Design\Plans\Plan & Profile Sheets.dgn

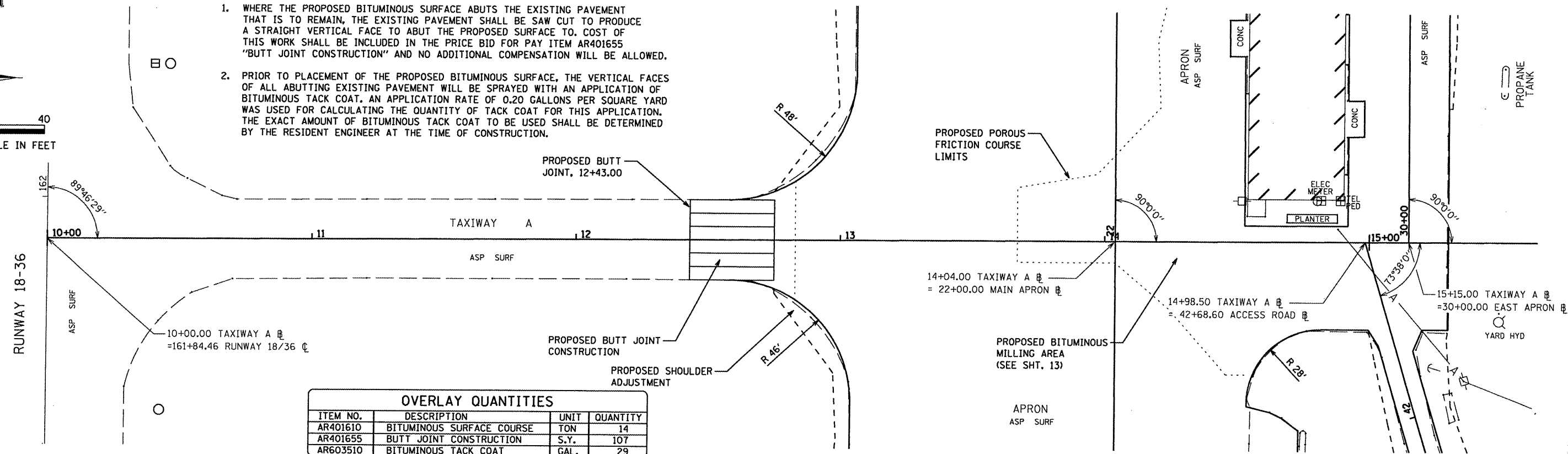

ITEM NO.	DESCRIPTION	UNIT	QUANTITY
AR401610	BITUMINOUS SURFACE COURSE	TON	14
AR401655	BUTT JOINT CONSTRUCTION	S.Y.	107
ARG03510	BITUMINOUS TACK COAT	GAL.	29

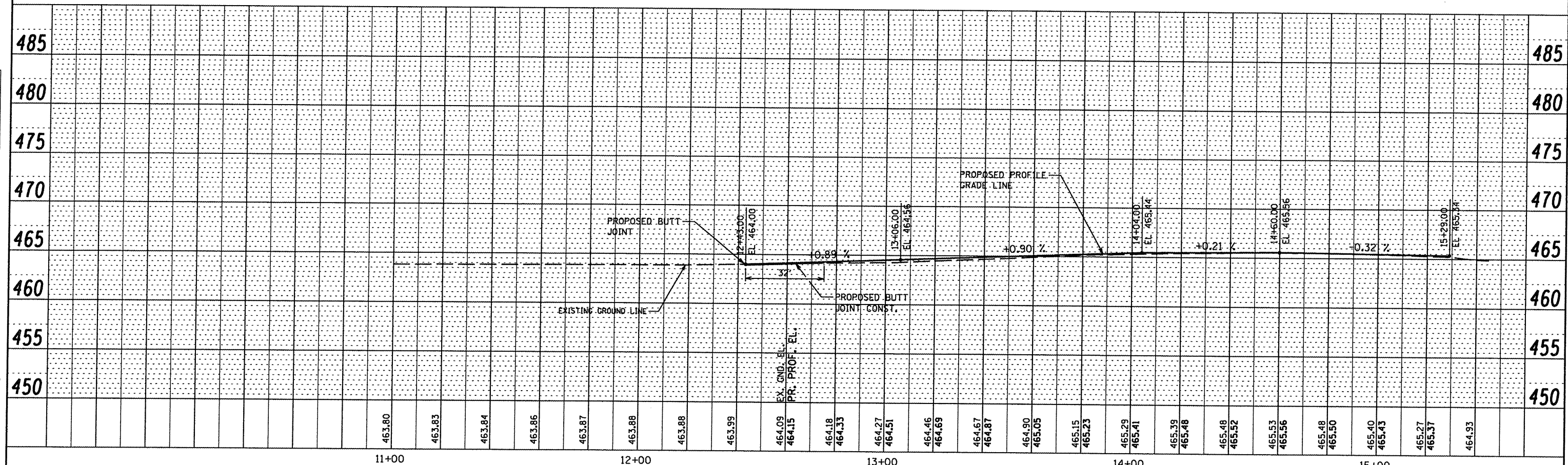

DATE	REVISION	GREATER BEARDSTOWN MUNICIPAL AIRPORT CITY OF BEARDSTOWN, BEARDSTOWN, ILLINOIS	FILENAME Plan & Profile Sheets.dgn PLOT SCALE 40,000' / IN. DATE JANUARY 9, 2009 SHEET 7 OF 40 SHEETS	 BENTON & ASSOCIATES, INC. 1970 W. LAFAYETTE AVE., JACKSONVILLE IL 62650 (217) 245-4146 (217) 245-4149 FAX KIRKSVILLE MISSOURI MACOMB ILLINOIS ST. LOUIS MISSOURI	TAXIWAY A PLAN AND PROFILE ILL. PROJ. NO. K06-3749 A.I.P. PROJ. NO. 3-17-0004-B12
			LAYOUT MCM 04/07/08 DRAWN MCM 04/07/08 REVIEWED RHB 05/09/08		