

KA039

K:\Kankakee\0807505 Term Apron Ph 1\Draw\Sheet
 FILE: Ph1-site.dwg
 LAYOUT: Layout1
 UPDATE BY: Jim Ohse
 SURVEY BOOK #
 DATE: Thursday, January 15, 2009 11:52:06 AM
 XREF DWG: tbcint.dwg
 tb.dwg
 Terminal-base.dwg

VERTICAL CONTROL		
BENCHMARK	DESCRIPTION	ELEVATION
BM #1	N.W. CORNER OF BEACON FOUNDATION	622.41



REVISIONS

NUMBER	BY	DATE

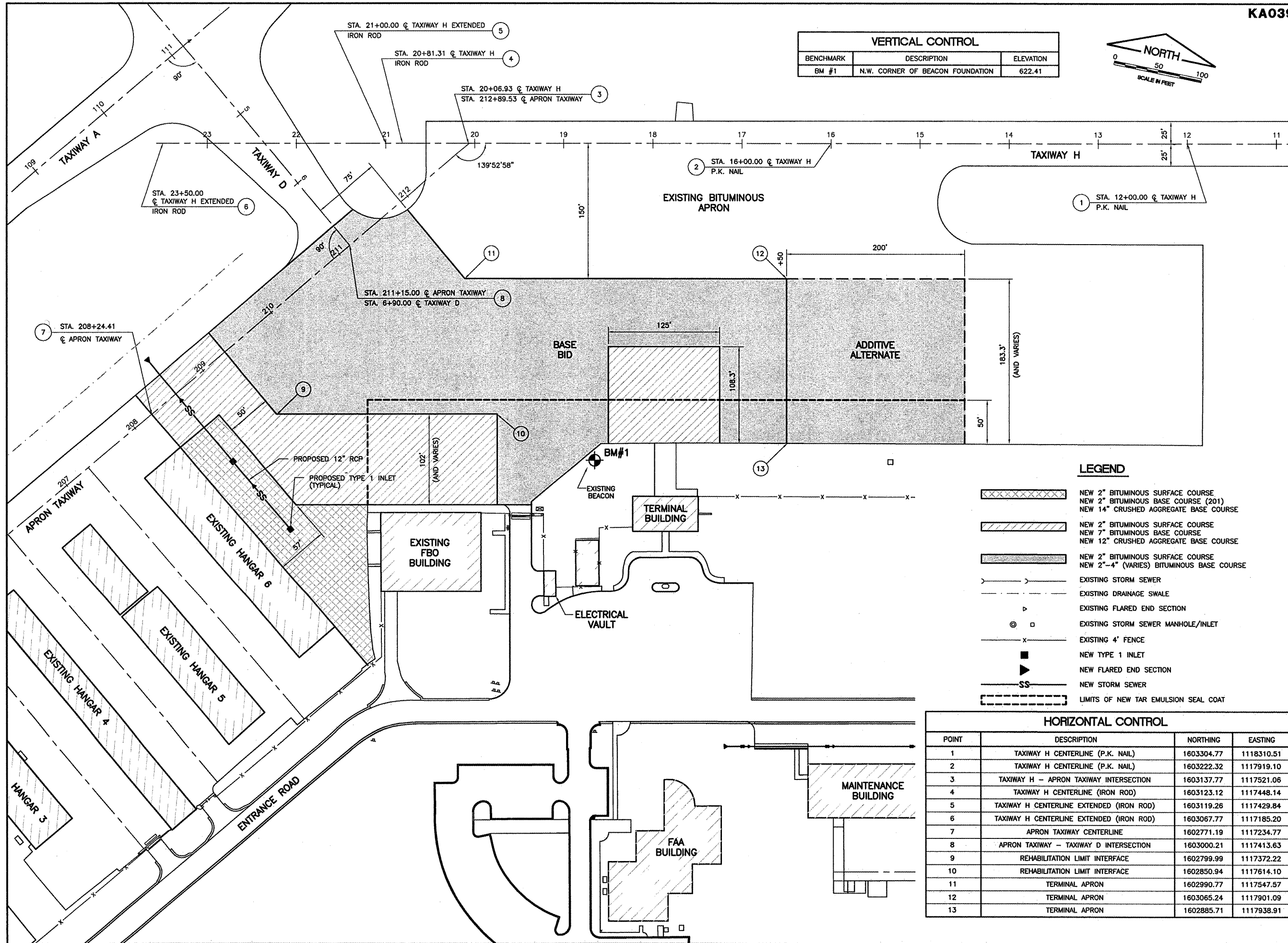
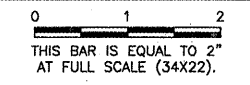

LEGEND

- NEW 2" BITUMINOUS SURFACE COURSE
NEW 2" BITUMINOUS BASE COURSE (201)
NEW 14" CRUSHED AGGREGATE BASE COURSE
- NEW 2" BITUMINOUS SURFACE COURSE
NEW 7" BITUMINOUS BASE COURSE
NEW 12" CRUSHED AGGREGATE BASE COURSE
- NEW 2" BITUMINOUS SURFACE COURSE
NEW 2"-4" (VARIES) BITUMINOUS BASE COURSE
- EXISTING STORM SEWER
- EXISTING DRAINAGE SWALE
- EXISTING FLARED END SECTION
- EXISTING STORM SEWER MANHOLE/INLET
- EXISTING 4' FENCE
- NEW TYPE 1 INLET
- NEW FLARED END SECTION
- NEW STORM SEWER
- LIMITS OF NEW TAR EMULSION SEAL COAT

HORIZONTAL CONTROL

POINT	DESCRIPTION	NORTHING	EASTING
1	TAXIWAY H CENTERLINE (P.K. NAIL)	1603304.77	1118310.51
2	TAXIWAY H CENTERLINE (P.K. NAIL)	1603222.32	1117919.10
3	TAXIWAY H - APRON TAXIWAY INTERSECTION	1603137.77	1117521.06
4	TAXIWAY H CENTERLINE (IRON ROD)	1603123.12	1117448.14
5	TAXIWAY H CENTERLINE EXTENDED (IRON ROD)	1603119.26	1117429.84
6	TAXIWAY H CENTERLINE EXTENDED (IRON ROD)	1603067.77	1117185.20
7	APRON TAXIWAY CENTERLINE	1602771.19	1117234.77
8	APRON TAXIWAY - TAXIWAY D INTERSECTION	1603000.21	1117413.63
9	REHABILITATION LIMIT INTERFACE	1602799.99	1117372.22
10	REHABILITATION LIMIT INTERFACE	1602850.94	1117614.10
11	TERMINAL APRON	1602990.77	1117547.57
12	TERMINAL APRON	1603065.24	1117901.09
13	TERMINAL APRON	1602885.71	1117938.91

GREATER KANKAKEE AIRPORT
 KANKAKEE, ILLINOIS
 REHABILITATE TERMINAL APRON AND TAXIWAY H - PHASE 1
 SITE PLAN/PROJECT CONTROL PLAN

© Copyright CMT, Inc.
CMT
 CRAWFORD, MURPHY & TILLY, INC.
 CONSULTING ENGINEERS
 License No. 84-000613

DESIGN BY: MND
 DRAWN BY: JRO
 CHECKED BY: MND
 APPROVED BY:
 DATE: 01/16/09
 JOB No: 08075-05
 I.L. PROJECT: IKK-3864
 A.I.P. PROJECT: 3-17-0057-B16
FINAL SUBMITTAL
 SHEET 3 OF 17 SHEETS