

KA039

K:\Kankakee\0807505 Term Apron Ph 1\Draw\Sheet
FILE: Ph1-econd-1.dwg
LAYOUT: Layout1
UPDATE BY: Jim Ohse
SURVEY BOOK #
DATE: Thursday, January 15, 2009 11:38:27 AM
XREF DWG: tbcint.dwg
tb.dwg
Terminal-base.dwg

REVISIONS		
NUMBER	BY	DATE

0 1 2
THIS BAR IS EQUAL TO 2"
AT FULL SCALE (34X22).



MATCHLINE STA. 18+50 TAXIWAY H

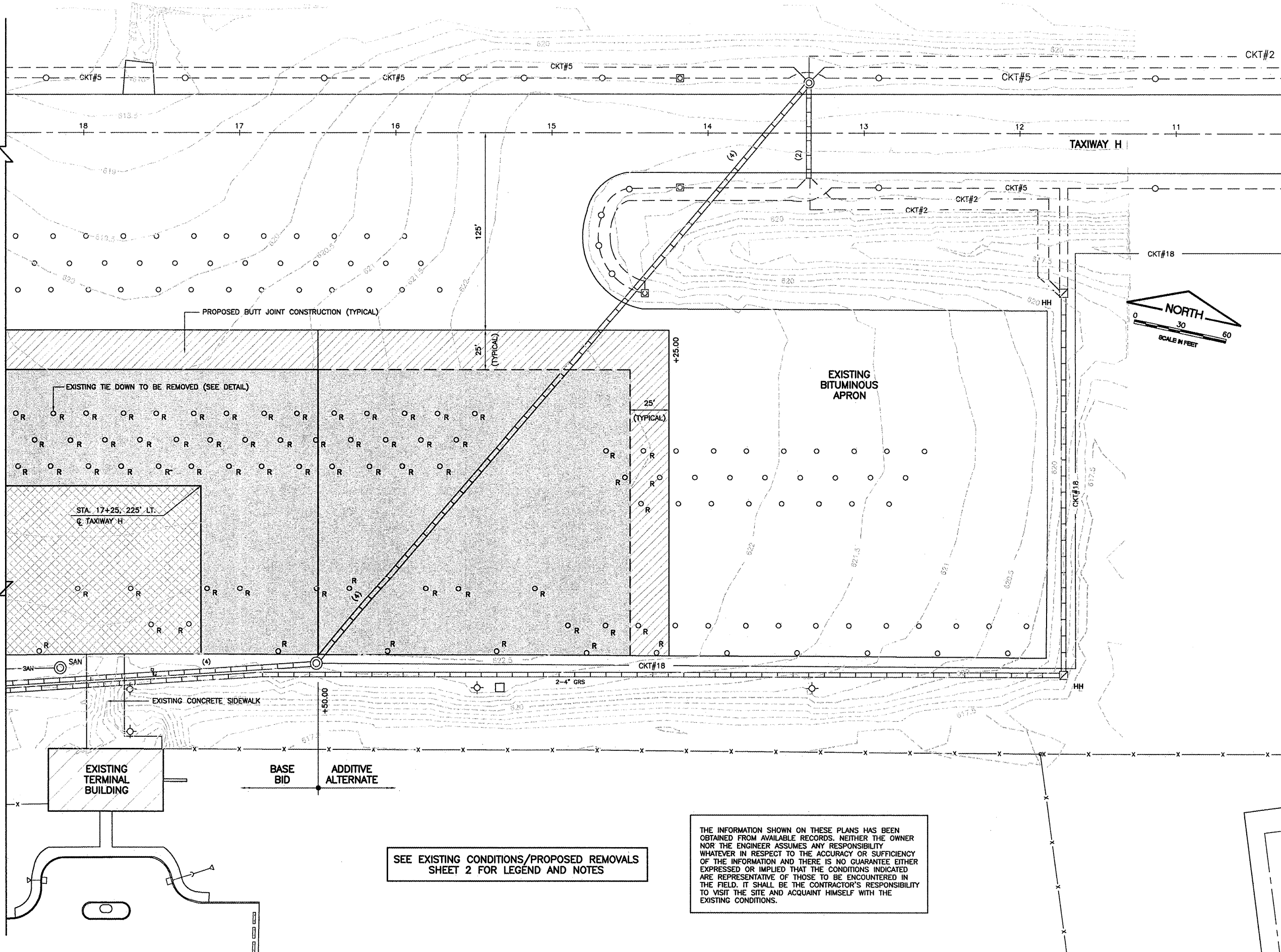

**GREATER KANKAKEE AIRPORT
KANKAKEE, ILLINOIS
REHABILITATE TERMINAL APRON AND TAXIWAY H - PHASE 1
EXISTING CONDITIONS/PROPOSED REMOVALS
SHEET 1**

© Copyright CMT, Inc.
CMT
CRAWFORD MURPHY & TILLY, INC.
CONSULTING ENGINEERS
License No. 84-006913

DESIGN BY:	MND
DRAWN BY:	JRO
CHECKED BY:	MND
APPROVED BY:	
DATE:	01/16/09
JOB No:	08075-05
IL PROJECT:	IKK-3864
A.I.P. PROJECT:	3-17-0057-B16
FINAL SUBMITTAL	
SHEET 8 OF 17 SHEETS	

SEE EXISTING CONDITIONS/PROPOSED REMOVALS SHEET 2 FOR LEGEND AND NOTES

THE INFORMATION SHOWN ON THESE PLANS HAS BEEN OBTAINED FROM AVAILABLE RECORDS. NEITHER THE OWNER NOR THE ENGINEER ASSUMES ANY RESPONSIBILITY WHATSOEVER IN RESPECT TO THE ACCURACY OR SUFFICIENCY OF THE INFORMATION AND THERE IS NO GUARANTEE EITHER EXPRESSED OR IMPLIED THAT THE CONDITIONS INDICATED ARE REPRESENTATIVE OF THOSE TO BE ENCOUNTERED IN THE FIELD. IT SHALL BE THE CONTRACTOR'S RESPONSIBILITY TO VISIT THE SITE AND ACQUAINT HIMSELF WITH THE EXISTING CONDITIONS.