

KA039

K:\Kankakee\0807505 Term Apron Ph 1\Draw\Sheet
FILE: Ph1-marking-2.dwg
LAYOUT: Layout1
UPDATE BY: Jim Ohse
SURVEY BOOK #
DATE: Thursday, January 15, 2009 11:45:25 AM
XREF DWG: tbcint.dwg
tb.dwg
Terminal-base.dwg

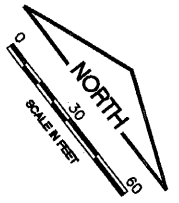

REVISIONS		
NUMBER	BY	DATE

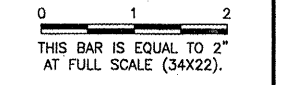

LEGEND

- PROPOSED AIRCRAFT TIEDOWN (WITH 3 MOORING EYES)
- EXISTING PAVEMENT MARKING
- PROPOSED PAVEMENT MARKING
- PROPOSED GROUND ROD
- EXISTING MOORING EYE

SEE TIEDOWN/PAVEMENT MARKING PLAN SHEET 1 FOR NOTES

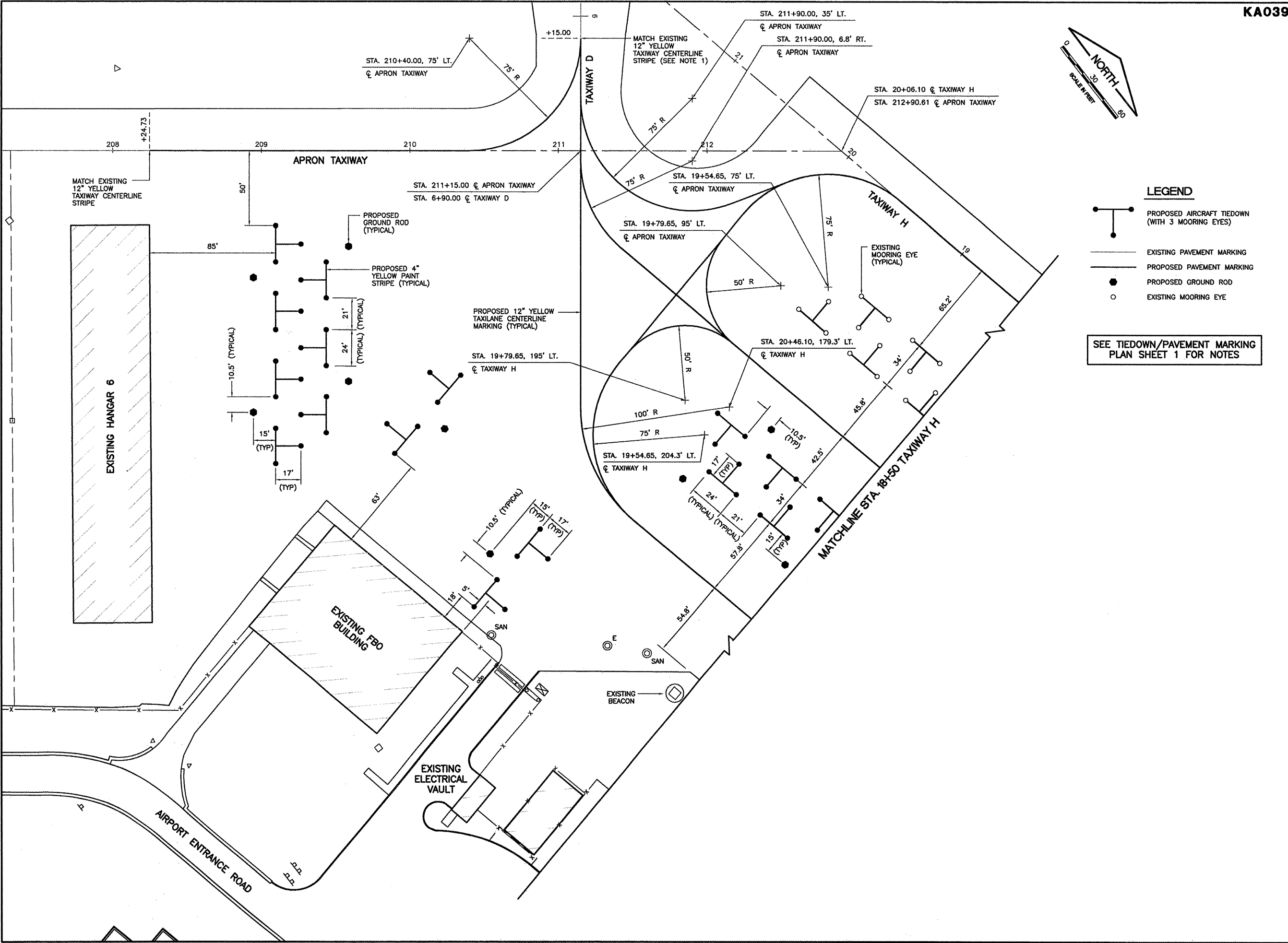

**GREATER KANKAKEE AIRPORT
KANKAKEE, ILLINOIS
REHABILITATE TERMINAL APRON AND TAXIWAY H - PHASE 1
TIEDOWN/PAVEMENT MARKING PLAN
SHEET 2**

© Copyright CMT, Inc.
CMT
CRAMFORD, MURPHY & TILLY, INC.
CONSULTING ENGINEERS
License No. 84-000673

DESIGN BY:	MND
DRAWN BY:	JRO
CHECKED BY:	MND
APPROVED BY:	
DATE:	01/16/09
JOB No:	08075-05
IL PROJECT: IKK-3864 A.I.P. PROJECT: 3-17-0057-B16	
FINAL SUBMITTAL	
SHEET 13 OF 17 SHEETS	