

K:\Danville\0504203 Taxiway Extension\Draw\Sheets
 FILE: 06_PROPIMP_REVISIED.dwg
 LAYOUT: PROPIMP
 UPDATE BY: dallen
 SURVEY BOOK #
 DATE: Mon 1/5/09 4:27pm
 XREF DWG: C:\info.dwg
 DNV-EXISTBASE.DWG
 BASE_PROPGE0.dwg

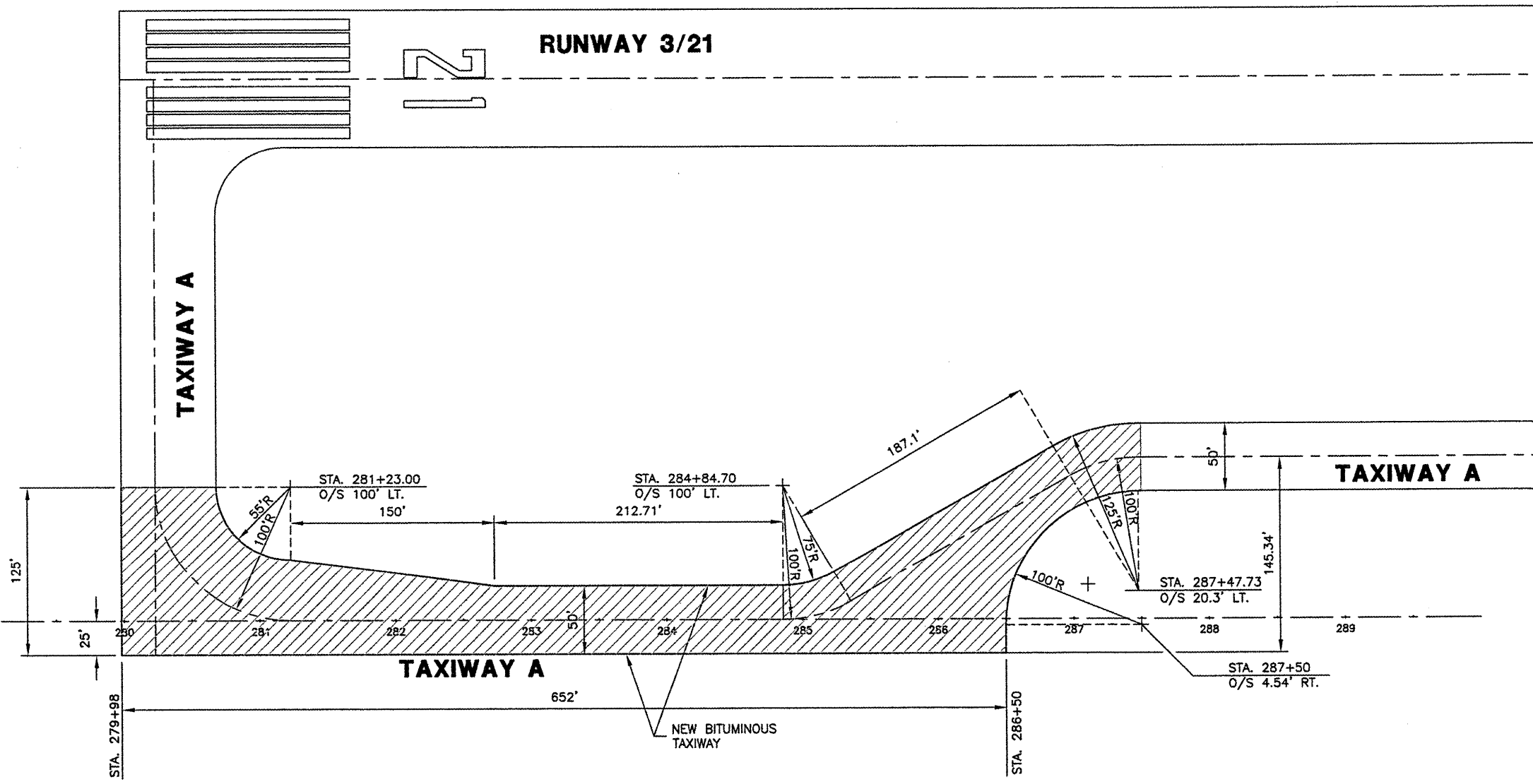

REVISIONS		
NUMBER	BY	DATE

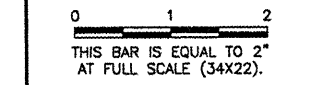

**VERMILLION COUNTY AIRPORT
 DANVILLE, ILLINOIS**
**EXTEND PARALLEL TAXIWAY 600 FEET
 PROPOSED IMPROVEMENTS**

© Copyright CMT, Inc.
CMT
 CRAWFORD, MURPHY & TILLY, INC.
 CONSULTING ENGINEERS
 License No. 184-000613

DESIGN BY:	JEF
DRAWN BY:	DPA
CHECKED BY:	JEF
APPROVED BY:	JEF
DATE:	01/09/2009
JOB No:	05042-0300
ILLINOIS PROJECT DNV-3537	
A.I.P. PROJECT 3-17-0032-B10	
SHEET	06 OF 26 SHEETS