

K:\Danville\0504203 Taxiway Extension\Draw\Sheets  
 FILE: 19\_MARKPLAN\_REVIS.DWG  
 LAYOUT: 22\_MARKPLAN  
 UPDATE BY: dallan  
 SURVEY BOOK #  
 DATE: Mon 1/5/09 6:03pm  
 XREF DWG: C:\info.dwg  
 DNV-EXISTBASE.DWG  
 BASE\_PROPGE0.DWG

REVISIONS

NUMBER	BY	DATE

0 1 2  
 THIS BAR IS EQUAL TO 2"  
 AT FULL SCALE (34X22).

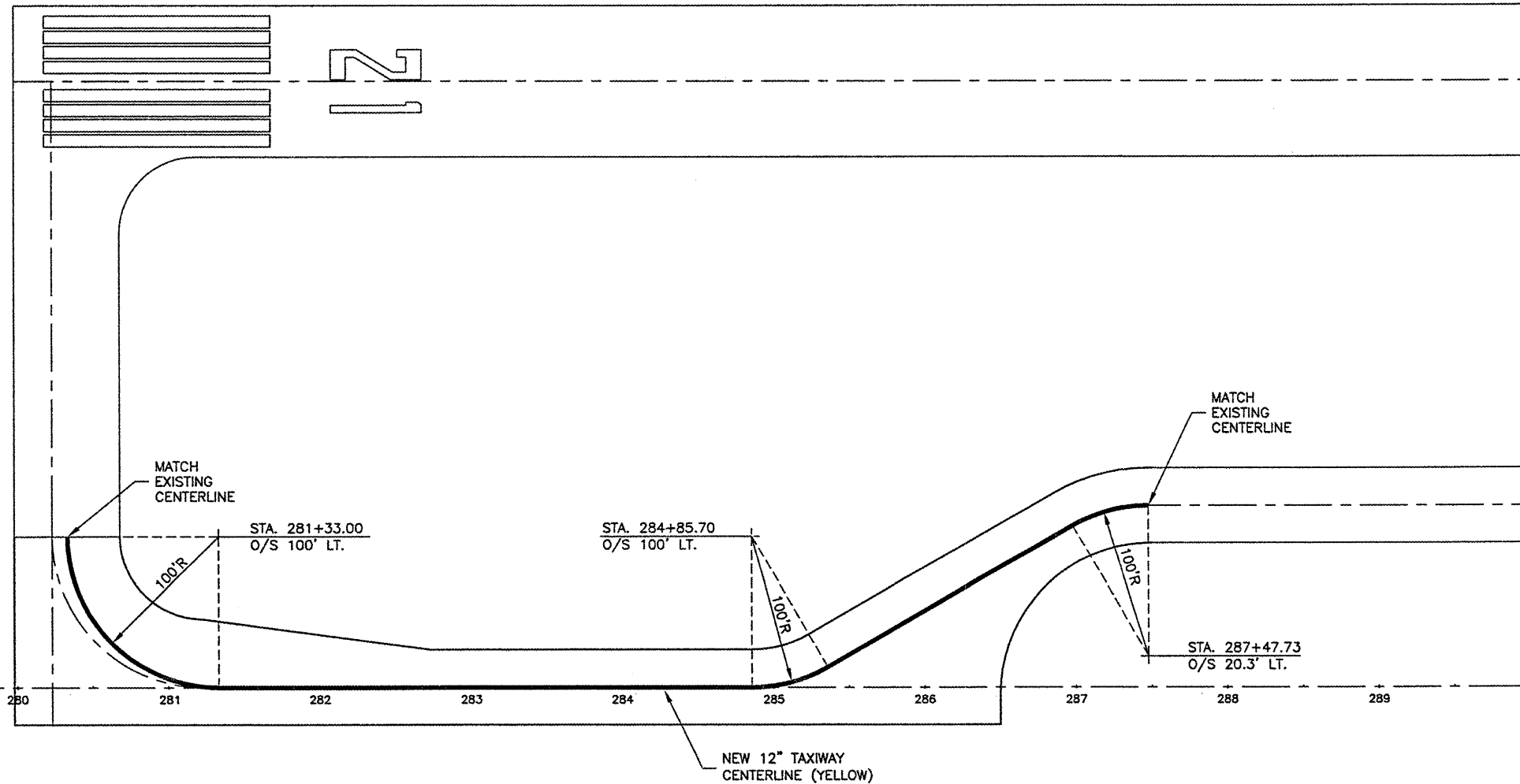
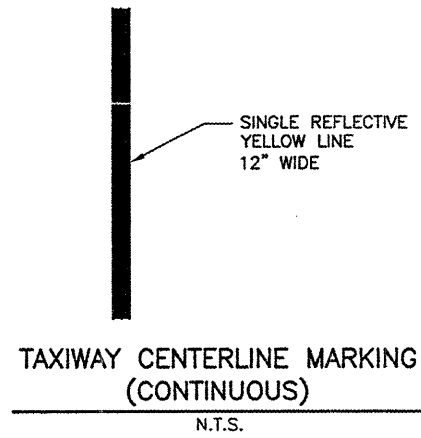
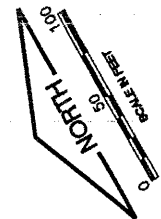

VERMILLION COUNTY AIRPORT  
 DANVILLE, ILLINOIS  
 EXTEND PARALLEL TAXIWAY 600 FEET  
 MARKING PLAN

© Copyright CMT, Inc.  
**CMT**  
 CRAWFORD, MURPHY & TILLY, INC.  
 CONSULTING ENGINEERS  
 License No. 184-000013

DESIGN BY: JEF  
 DRAWN BY: DPA  
 CHECKED BY: JEF  
 APPROVED BY: JEF  
 DATE: 01/09/2009  
 JOB No: 05042-0300  
 ILLINOIS PROJECT DNV-3537  
 A.I.P. PROJECT 3-17-0032-B10  
 SHEET 19 OF 26 SHEETS