

INDEX OF SHEETS

SHEET NO.	TITLE
1	COVER SHEET
2	INDEX OF SHEETS, BENCHMARKS AND HIGHWAY STANDARDS
3	GENERAL NOTES
4 -9	SUMMARY OF QUANTITIES
10-13	TYPICAL SECTIONS
14	MAINTENANCE OF TRAFFIC GENERAL NOTES
15	MAINTENANCE OF TRAFFIC DETOUR PLAN - LAKE STREET
16-17	GEOMETRIC PLAN: CENTER STREET
18-20	PLAN AND PROFILE: CENTER STREET
21-24	PLAN AND PROFILE: LAKE STREET
25-26	SOIL EROSION AND SEDIMENT CONTROL NOTES, CONSTRUCTION SEQUENCE AND EROSION CONTROL DETAILS
27	EROSION CONTROL PLAN: CENTER STREET
28	EROSION CONTROL PLAN: LAKE STREET
29-31	WATER MAIN AND UTILITIES: CENTER STREET
32-35	DRAINAGE AND UTILITIES: LAKE STREET
36-37	PAVEMENT MARKING PLAN: CENTER STREET
38	PAVEMENT MARKING PLAN: LAKE STREET
38A	LANDSCAPING PLAN: LAKE STREET
39-40	MISCELLANEOUS DETAILS
41	DETAILS FOR FRAMES AND LIDS ADJUSTMENT WITH MILLING (BD-08)
42	PAVEMENT PATCHING FOR HMA SURFACED PAVEMENT (BD-22)
43	CURB OR CURB AND GUTTER REMOVAL AND REPLACEMENT (BD-24)
44	BUTT JOINT AND HMA TAPER DETAILS (BD-32)
45	TRAFFIC CONTROL AND PROTECTION FOR SIDE ROADS, INTERSECTIONS AND DRIVEWAYS (TC-10)
46	DISTRICT ONE TYPICAL PAVEMENT MARKINGS (TC-13)
47	PAVEMENT MARKING LETTERS AND SYMBOLS FOR TRAFFIC STAGING (TC-16)
47A	DETOUR SIGNING FOR CLOSING STATE HIGHWAYS (TC-21)
48	ARTERIAL ROAD INFORMATION SIGN (TC-22)
49	DRIVEWAY ENTRANCE SIGNING (TC-26)
50-52	CROSS SECTIONS: CENTER STREET
53-55	CROSS SECTIONS: LAKE STREET

HIGHWAY STANDARDS

000001-06	STANDARD SYMBOLS, ABBREVIATIONS AND PATTERNS
280001-07	TEMPORARY EROSION CONTROL SYSTEMS
424001-08	PERPENDICULAR CURB RAMPS FOR SIDEWALKS
424016-02	MID-BLOCK CURB RAMPS FOR SIDEWALKS
442201-03	CLASS C AND D PATCHES
542301-03	PRECAST REINFORCED CONCRETE FLARED END SECTION
602001-02	CATCH BASIN TYPE A
602011-02	CATCH BASIN TYPE C
602301-04	INLET - TYPE A
602601-03	PRECAST REINFORCED CONCRETE FLAT SLAB TOP
602701-02	MANHOLE STEPS
604001-04	FRAME AND LIDS TYPE 1
604036-03	GRATE TYPE 8
604051-04	FRAME AND GRATE TYPE 11
604091-03	FRAME AND GRATE TYPE 24
606001-06	CONCRETE CURB TYPE B AND COMBINATION CONCRETE CURB AND GUTTER
701001-02	OFF-RD OPERATIONS, 2L, 2W, MORE THAN 15' (4.5 m) AWAY
701006-05	OFF-RD OPERATIONS, 2L, 2W, 15' (4.5 m) TO 24" (600 mm) FROM PAVEMENT EDGE
701011-04	OFF-RD MOVING OPERATIONS, 2L, 2W, DAY ONLY
701301-04	LANE CLOSURE, 2L, 2W, SHORT TIME OPERATIONS
701311-03	LANE CLOSURE 2L, 2W MOVING OPERATIONS - DAY ONLY
701501-06	URBAN LANE CLOSURE, 2L, 2W, UNDIVIDED
701701-09	URBAN LANE CLOSURE, MULTILANE INTERSECTION
701801-05	SIDEWALK, CORNER OR CROSSWALK CLOSURE
701901-04	TRAFFIC CONTROL DEVICES
780001-05	TYPICAL PAVEMENT MARKINGS
821101-01	LUMINAIRE WIRING DIAGRAM
836001-02	LIGHT POLE FOUNDATION
886001-01	DETECTOR LOOP INSTALLATIONS
886006-01	TYPICAL LAYOUTS FOR DETECTION LOOPS
B.L.R. 22-7	TYPICAL APPLICATION OF TRAFFIC CONTROL DEVICES FOR CONSTRUCTION ON RURAL LOCAL HIGHWAYS (TWO-LANE TWO WAY RURAL TRAFFIC) (ROAD CLOSED TO THRU TRAFFIC)

BENCHMARK LIST

DATUM IS NAV 88	
BM #3	RAILROAD SPIKE AT 1ST POWER POLE SOUTH OF SHOREWOOD ROAD ON EAST SIDE OF LAKE STREET EL = 783.30
BM #5	RAILROAD SPIKE AT 1ST POWER POLE SOUTH OF CRISFIELD DRIVE ON EAST SIDE OF LAKE STREET EL = 784.85
BM #7	RAILROAD SPIKE AT 1ST POWER POLE NORTH OF DRIVEWAY FOR McDONALDS ON EAST SIDE OF LAKE STREET EL = 784.61
BM #13	NORTHEAST FLANGE BOLT ON FIRE HYDRANT AT NORTHEAST CORNER OF CENTER STREET AND SEYMOUR AVENUE EL = 786.53
BM #14	NORTH NUT ON FIRE HYDRANT AT NORTHEAST CORNER OF CENTER STREET AND RAILROAD AVENUE EL = 786.09
BM #16	NORTHEAST FLANGE BOLT ON FIRE HYDRANT ACROSS FROM HOUSE #445 ON CENTER STREET EL = 783.65
BM #17	CHISEL SQUARE ON TOP OF SOUTH END OF CONCRETE BASE FOR DOG N SUDS SIGN EL = 783.58
BM #19	NORTHEAST FLANGE BOLT ON FIRE HYDRANT ON NORTH SIDE OF CENTER STREET IN FRONT OF BANK EL = 782.23

COPYRIGHT © 2014 BY BAXTER & WOODMAN, INC.
 STATE OF ILLINOIS - PROFESSIONAL DESIGN FIRM
 LICENSE NO. 184-00121 - EXPIRES 4/30/2015
 2/17/2015 11:35:20 AM
 I:\C:\ystrtol\lake\GRAY\140428-Lake SH-Index.dgn

BAXTER & WOODMAN <small>Consulting Engineers</small>	DESIGNED - JDM	REVISED -1-6-15 PER IDOT REVIEW
	DRAWN - UKB	REVISED -2-17-15 ADDENDUM 1
	CHECKED - RWL	REVISED -
	DATE - 12-15-14	FILE - 140428.SH-Index.dgn

**STATE OF ILLINOIS
DEPARTMENT OF TRANSPORTATION**

**INDEX OF SHEETS, BENCHMARKS
AND HIGHWAY STANDARDS**

SCALE:

STA. TO STA.

F.A.U. RTE.	SECTION	COUNTY	TOTAL SHEETS	SHEET NO.
189	14-00062-00-WR	LAKE	55	2
CONTRACT NO. 61B18				
FED. ROAD DIST. NO. 1 ILLINOIS FED. AID PROJECT M-40034361				

SUMMARY OF QUANTITIES

CODE NUMBER	ITEM	UNIT	TOTAL QUANTITY	CONSTRUCTION TYPE CODE	
				ROADWAY	NON PARTICIPATING
				0004 STU	100% LOCAL
# XX008839	WATER MAIN TO BE ABANDONED	L SUM	1		1
# XX008945	WATER VALVE TO BE REMOVED	EACH	1		1
B2006016	TREE, SYRINGA PEKINENSIS (PEKING LILAC), 2" CALIPER, TREE FORM, BALLED AND BURLAPPED	EACH	13	13	
C2001636	SHRUB, CORNUS SERICEA (REDSIER DOGWOOD), 3' HEIGHT, BALLED AND BURLAPPED	EACH	9	9	
C2002936	SHRUB, FORSYTHIA X INTERMEDIA (BORDER FORSYTHIA), 3' HEIGHT, BALLED AND BURLAPPED	EACH	9	9	
C2C01024	SHRUB, BUXUS MICROPHYLLA WINTERGREEN (WINTERGREEN LITTLELEAF BOXWOOD), 2' HEIGHT, CONTAINER	EACH	7	7	
# K1005481	SHREDDED BARK MULCH 3"	SQ YD	180	180	

* SPECIALTY ITEM
SPECIAL PROVISION

EARTHWORK							
LOCATION	UNDERCUT AND PGE REPLACEMENT (CU YD)	UNSUITABLE EXCAVATION (TOPSOIL) (CU YD)	REMOVAL & DISPOSAL OF UNSUITABLE MATERIAL (CU YD)	EARTH EXCAVATION (CU YD)	EXCAVATION TO BE USED IN EMBANKMENT (15% SHRINKAGE) (CU YD)	EMBANKMENT (CU YD)	EARTHWORK BALANCE WASTE (+) OR SHORTAGE (-) (CU YD)
CENTER STREET	239	213	452	60	51	48	3
LAKE STREET	354	570	924	469	399	634	-235
TOTAL	593	783	1,376	529	450	682	-232

COPYRIGHT © 2004 BY BAXTER & WOODMAN, INC.
 STATE OF ILLINOIS - PROFESSIONAL DESIGN FIRM
 LICENSE NO. - 84-00021 - EXPIRES 4/30/2015
 11:35:22 AM 2/17/2015
 I:\C:\stc\lake\ORATL\140428-Lake St Imp\CADD\PH-2\140428-SH-S00.dgn

DESIGNED - JDM	REVISED -1-6-15 PER IDOT REVIEW
DRAWN - LKB	REVISED -2-17-15 ADDENDUM 1
CHECKED - RWL	REVISED -
DATE - 12-15-14	FILE - 140428_SH-S00.dgn

**STATE OF ILLINOIS
DEPARTMENT OF TRANSPORTATION**

SUMMARY OF QUANTITIES

SCALE: _____ STA. _____ TO STA. _____

F.A.U. RTE.	SECTION	COUNTY	TOTAL SHEETS	SHEET NO.
189	14-0062-00-WR	LAKE	55	9
CONTRACT NO. 61B18				
FED. ROAD DIST. NO. 1 ILLINOIS FED. AID PROJECT M-40034361				

CONSTRUCTION SEQUENCE

MAINTENANCE OF TRAFFIC NOTES:

- THE CONTRACTOR SHALL SUBMIT A PREPLANNED SEQUENCE OF WORK AT THE PRECONSTRUCTION CONFERENCE FOR REVIEW AND APPROVAL. WORK SHALL BE SCHEDULED TO MINIMIZE INCONVENIENCE TO RESIDENTS AND BUSINESSES AND TO MAINTAIN A REASONABLE LEVEL OF CONSTRUCTION EFFICIENCY. THE ENGINEER RESERVES THE RIGHT TO RESTRICT WORK ON ANY ROADWAY SEGMENT IF CONSTRUCTION OPERATIONS ON A PREVIOUS SEGMENT ARE UNACCEPTABLE; TRAFFIC CONTROL OPERATIONS BECOME UNACCEPTABLE; OR AN EROSION CONTROL DEFICIENCY EXISTS.
- ACCESS FOR LOCAL TRAFFIC, MAIL SERVICE, GARBAGE SERVICE AND EMERGENCY VEHICLES SHALL BE MAINTAINED AT ALL TIMES.
- THE ENGINEER SHALL BE NOTIFIED 48 HOURS IN ADVANCE OF ANY CHANGES TO CONSTRUCTION STAGING. ALL CHANGES TO CONSTRUCTION STAGING MUST BE APPROVED BY THE ENGINEER PRIOR TO IMPLEMENTATION.
- PROVIDE 72 HOUR ADVANCED NOTIFICATION TO THE ENGINEER, VILLAGE, POLICE AND FIRE, AND THE DISTRICT ONE TRAFFIC CONTROL SUPERVISOR AT (847) 705-4470 PRIOR TO THE LAKE STREET ROAD CLOSURE.
- MAINTAIN ACCESS TO DRIVEWAYS AT ALL TIMES. CURB AND GUTTER INSTALLATION ACROSS DRIVEWAYS SHALL BE CONSTRUCTED HALF AT A TIME TO MAINTAIN ACCESS.
- CENTER STREET AND ALL SIDE STREETS SHALL BE KEPT OPEN TO TWO-WAY TRAFFIC AT ALL TIMES.
- ALL TRENCHES, HOLES, AND PITS SHALL BE FILLED OR COVERED WITH STEEL PLATES EXCEPT DURING ACTUAL CONSTRUCTION THERE IN. THIS WORK SHALL BE INCLUDED IN THE COST OF THE ITEMS FOR WHICH IT APPLIES.
- THE CONTRACTOR SHALL MAINTAIN ONE CROSSWALK IN EACH DIRECTION AT ALL INTERSECTIONS DURING CONSTRUCTION.
- ALL SIDEWALKS AND CROSSWALKS ON CENTER STREET WEST OF SEYMOUR AVENUE SHALL BE OPEN DURING SPECIAL EVENTS (SEE NOTE 11 FOR DATES).
- THE CONTRACTOR SHALL COORDINATE WITH THE ENGINEER TO MINIMIZE DISRUPTION TO SPECIAL EVENTS IN THE DOWNTOWN AREA. THIS SHALL INCLUDE SCHEDULING OPERATIONS AROUND THE EVENTS LISTED BELOW AS DETERMINED BY THE ENGINEER. THE ENGINEER RESERVES THE RIGHT TO RESTRICT WORK ON PORTIONS OF CENTER STREET DURING THESE EVENTS.
 - ALL SATURDAYS FROM APRIL 3 TO MAY 23, 2015 - FARMERS MARKET
 - ALL WEDNESDAYS FROM JUNE 3 TO SEPTEMBER 30, 2015 - FARMERS MARKET
 - ALL SATURDAYS FROM OCTOBER 3 TO DECEMBER 18, 2015 - FARMERS MARKET
 - MAY 29-30, 2015 - CRAFT BEER FESTIVAL
 - JUNE 12-13, 2015 - ARTS FESTIVAL
 - JUNE 26-27, 2015 - TASTE OF GRAYSLAKE
 - JULY 10-11, 2015 - 5K FAMILY FUN RUN
 - AUGUST 13-15, 2015 - SUMMER DAYS
- THE 5K FAMILY RUN (JULY 11) RACE COURSE RUNS ALONG SEYMOUR AVE AND CENTER STREET FROM LAKE STREET TO SEYMOUR AVENUE. THE CONTRACTOR SHALL SCHEDULE ACTIVITIES SUCH THAT NO TRIP HAZARDS EXIST ALONG CENTER STREET AND SEYMOUR AVE AND THAT CENTER STREET IS PAVED THROUGH THE HMA SURFACE COURSE OR THE EXISTING HMA SURFACE COURSE REMAINS FOR THE RACE. NO EXPOSED STRUCTURE FRAMES, MILLED PAVEMENT OR LEVELING BINDER WILL BE ALLOWED FOR THE RACE.
- VARIOUS CONTRACTORS WILL BE PERFORMING WORK ON PROJECTS ADJACENT TO AND AT THE SAME TIME AS THE CENTER STREET PROJECT. THE CONTRACTOR SHALL COORDINATE ALL CONSTRUCTION ACTIVITIES, EROSION CONTROL, SCHEDULES, TRAFFIC CONTROL, AND STAGING WITH THE CONTRACTORS OF THE ADJACENT PROJECTS. ANY TRAFFIC CONTROL MEASURES REQUIRED DUE TO TIMING OR STAGING OF VARIOUS WORK, INCLUDING BUT NOT LIMITED TO CURB AND GUTTER AND SIDEWALK INSTALLATION, SHALL BE INCLUDED IN THE COST OF TRAFFIC CONTROL AND PROTECTION (SPECIAL).
- THE CONTRACTOR SHALL PROVIDE 36 INCH X 36 INCH CONSTRUCTION SIGNS STATING "BUSINESSES OPEN DURING CONSTRUCTION" DURING ALL CONSTRUCTION WORK. SIGNS SHALL BE IN ACCORDANCE WITH THE LATEST VERSION OF THE MUTCD AND SHALL HAVE 4" BLACK LETTERS ON AN ORANGE BACKGROUND. SIGNS SHALL BE PLACED AT THE SOUTH LAKE STREET CONSTRUCTION LIMIT, AT THE CENTER STREET CONSTRUCTION LIMITS AND AT ALL SIDE STREETS ALONG CENTER STREET. THIS WORK SHALL BE PAID FOR AS TEMPORARY INFORMATION SIGNING.
- THE CONTRACTOR SHALL PROTECT ALL EXISTING DECORATIVE CONCRETE TO REMAIN INCLUDING THE INTERSECTIONS AND CROSSWALKS AT CENTER STREET WITH WHITNEY ST, SLUSSER ST AND LIBRARY LANE UTILIZING TEMPORARY AGGREGATE TO MINIMIZE BITUMINOUS TRACKING. ANY DAMAGE TO DECORATIVE CONCRETE SHALL BE REPAIRED AT THE CONTRACTOR'S EXPENSE.
- DECORATIVE CROSSWALKS SHALL BE STAGED TO MAINTAIN TWO-WAY TRAFFIC AT ALL TIMES.

CONSTRUCTION SEQUENCE

CENTER STREET

- ESTABLISH TRAFFIC CONTROL ITEMS.
- ESTABLISH EROSION CONTROL MEASURES.
- REMOVE TREES AS NECESSARY AND ESTABLISH TREE PROTECTION ON TREES TO REMAIN.
- CONSTRUCT WATER MAIN LINING, INSTALLATION AND ABANDONMENT.
- REPAIR EXISTING CURB AND GUTTER AND SIDEWALK EAST OF SEYMOUR AVENUE. CURB AND GUTTER WORK SHALL BE LIMITED TO WORKING ON ONE SIDE OF THE STREET IN EACH DIRECTION AT ALL TIMES TO MINIMIZE CONGESTION. CONCRETE SHALL HAVE A MINIMUM OF 72 HOURS CURING TIME AND ALL DRIVEWAYS SHALL BE FULLY ACCESSIBLE PRIOR TO REMOVING EXISTING CURB ON THE OPPOSITE SIDE OF THE STREET.
- CONSTRUCT AGGREGATE SUBGRADE IMPROVEMENTS AND CURB AND GUTTER IN WIDENING AREA.
- REPAIR EXISTING CURB AND GUTTER AND SIDEWALK WEST OF SEYMOUR AVENUE. ONLY PARKING SPACES DIRECTLY IN FRONT OF CURB AND GUTTER AND SIDEWALK REPAIRS SHALL BE CLOSED. PARKING SPACES NOT IN FRONT OF CURB AND GUTTER REPAIRS SHALL REMAIN OPEN DURING CONSTRUCTION.
- CONSTRUCT HOT-MIX ASPHALT BASE COURSE IN WIDENING AREA.
- MILL AND CONSTRUCT HOT-MIX ASPHALT PATCHING. PAVEMENT MILLING SHALL NOT OCCUR UNTIL ALL CURB AND GUTTER REPAIRS ARE COMPLETED. MILLED PAVEMENT COMPLETE HOT-MIX ASPHALT LEVELING AND SURFACE COURSES.
- INSTALL REQUIRED PAVEMENT MARKINGS.

WORK ON CENTER STREET SHALL BE COMPLETED INCLUDING HMA SURFACE COURSE AND PAVEMENT MARKINGS BY JULY 31, 2015 UNLESS ADDITIONAL TIME IS GRANTED IN ACCORDANCE WITH SECTION 108.08 OF THE STANDARD SPECIFICATIONS, OR THE CONTRACTOR SHALL BE LIABLE FOR LIQUIDATED DAMAGES PER CALENDAR DAY IN ACCORDANCE WITH SECTION 108.09 OF THE STANDARD SPECIFICATIONS.

- COMPLETE PARKWAY RESTORATION.
- COMPLETE PUNCH LIST ITEMS.
- REMOVE TEMPORARY EROSION CONTROL ITEMS ONCE SEED ESTABLISHES.

LAKE STREET

- ESTABLISH DETOUR ROUTE AND OTHER TRAFFIC CONTROL ITEMS - MAINTAIN ACCESS TO COMMERCIAL DRIVEWAY WITHIN RECONSTRUCTION SECTION AT ALL TIMES DURING CONSTRUCTION. MAINTAIN ACCESS TO BIKE PATH DURING CONSTRUCTION.
- ESTABLISH EROSION CONTROL MEASURES.
- REMOVE TREES AS NECESSARY AND ESTABLISH TREE PROTECTION ON TREES TO REMAIN.
- CONSTRUCT STORM SEWER.
- REMOVE EXISTING PAVEMENT AND CURB.
- CONSTRUCT AGGREGATE SUBGRADE IMPROVEMENTS AND CURB AND GUTTER.
- CONSTRUCT SIDEWALK AND BIKE PATH REPAIRS.
- MILL AND CONSTRUCT HOT-MIX ASPHALT BASE COURSE AND PATCHING.
- COMPLETE HOT-MIX ASPHALT LEVELING AND SURFACE COURSES.
- COMPLETE PARKWAY RESTORATION.
- INSTALL REQUIRED PAVEMENT MARKINGS.
- REOPEN ROADWAY.
- COMPLETE PUNCH LIST ITEMS.
- REMOVE TEMPORARY EROSION CONTROL ITEMS ONCE SEED ESTABLISHES.

ALL WORK SHALL BE COMPLETED BY SEPTEMBER 18, 2015 IN ACCORDANCE WITH THE SPECIAL PROVISION FOR COMPLETION DATE PLUS WORKING DAYS, UNLESS ADDITIONAL TIME IS GRANTED IN ACCORDANCE WITH SECTION 108.08 OF THE STANDARD SPECIFICATIONS, OR THE CONTRACTOR SHALL BE LIABLE FOR LIQUIDATED DAMAGES PER CALENDAR DAY IN ACCORDANCE WITH SECTION 108.09 OF THE STANDARD SPECIFICATIONS.

ARTERIAL ROAD INFORMATION SIGN FOR ROADS TO BE FULLY CLOSED AND DETOURED

SHALL BE PAID FOR AS TEMPORARY INFORMATION SIGNING. ONE SIGN ASSEMBLY EQUALS 27.3 SQ. FT.



"HIGHWAY C" FONT

- OVERLAY PANEL 1 TO CONTAIN STARTING DATE OF FULL CLOSURE AND DETOUR IMPLEMENTATION. (i.e. "FROM APR 2")
- OVERLAY PANEL 2 TO CONTAIN ENDING MONTH OF FULL CLOSURE & DETOUR (i.e. "THRU JULY") OMIT THE DATE ON PANEL 2; MONTH ONLY.

ERECT SIGN ASSEMBLY (POST-MOUNTED WITH PANELS 1 AND 2) IN PLACE ON ROAD TO BE CLOSED IN EACH DIRECTION NEAR POINT OF CLOSURE OR WITHIN SECTION TO BE FULLY CLOSED TWO (2) WEEKS PRIOR TO START DATE OF FULL CLOSURE. REMOVE ASSEMBLY AFTER CLOSURE.

TEMPORARY INFORMATION SIGN DETAIL

COPYRIGHT © 2014 BY BAXTER & WOODMAN, INC.
 STATE OF ILLINOIS - PROFESSIONAL DESIGN FIRM
 LICENSE NO. 184-00121 - EXPIRES 4/30/2015
 444315 PM 2/19/2015
 ...\\dot-dr-v\pdf-BW_Default.plt
 ...\\140428-14042-P12-B&W.rdi
 is\Crystol Lake\GRATL\140428-Lake St Imp\LOADD\PH-2\140428.SH-MoTGrtes.dgn

DESIGNED - JDM	REVISED -1-6-15 PER IDOT REVIEW
DRAWN - LKB	REVISED -2-18-15 ADDENDUM 2
CHECKED - RWL	REVISED -
DATE - 12-15-14	FILE - 140428.SH-MoTGrtes.dgn

STATE OF ILLINOIS
DEPARTMENT OF TRANSPORTATION

**MAINTENANCE OF TRAFFIC
GENERAL NOTES**

SCALE: NONE

STA. TO STA.

F.A.U. RTE.	SECTION	COUNTY	TOTAL SHEETS	SHEET NO.
195	14-00062-00-WR	LAKE	55	14
CONTRACT NO. 61B18			FED. ROAD DIST. NO. 1 (ILLINOIS) FED. AID PROJECT M-40034361	

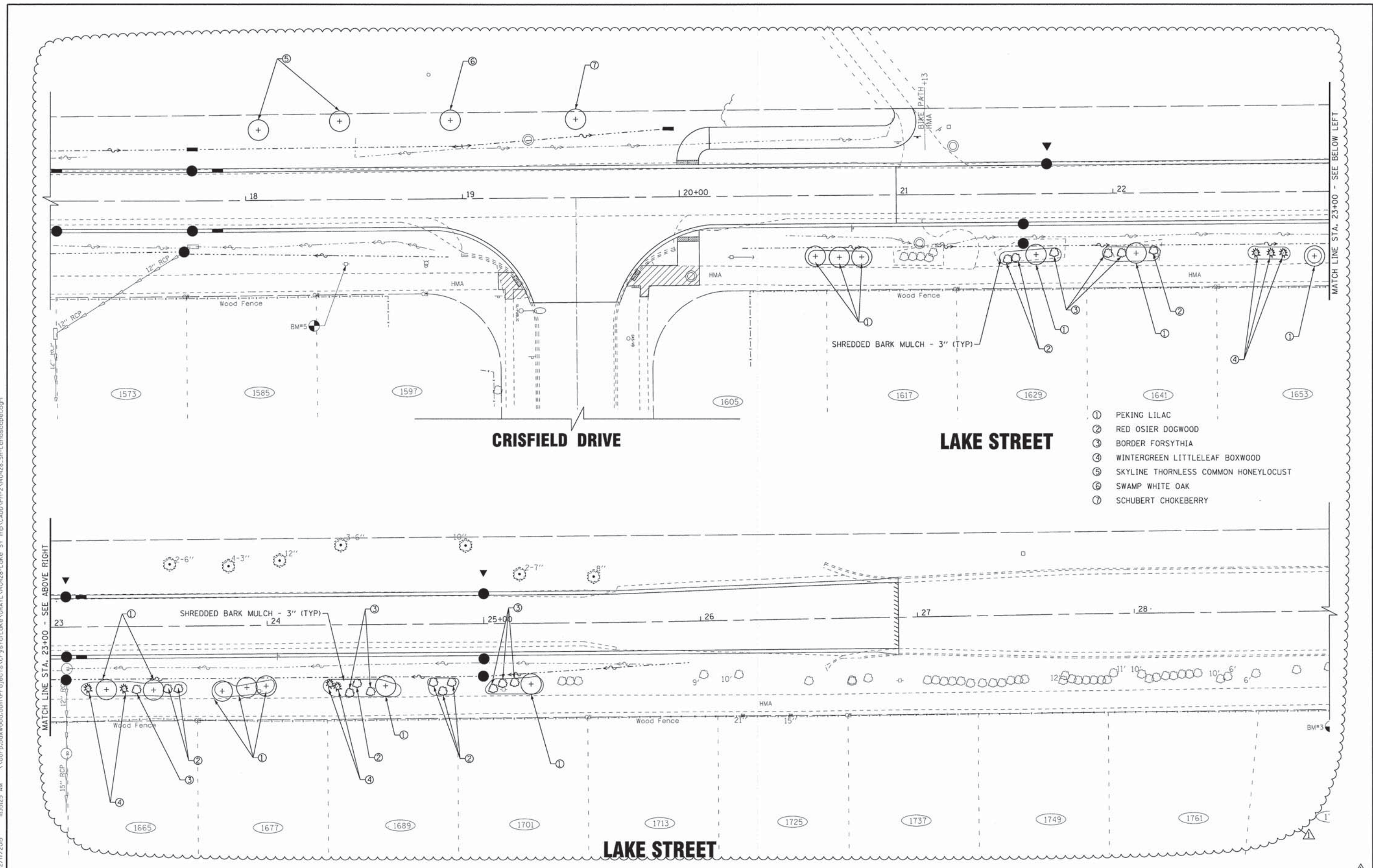

- ① PEKING LILAC
- ② RED OSIER DOGWOOD
- ③ BORDER FORSYTHIA
- ④ WINTERGREEN LITTLELEAF BOXWOOD
- ⑤ SKYLINE THORNLESS COMMON HONEYLOCUST
- ⑥ SWAMP WHITE OAK
- ⑦ SCHUBERT CHOKEBERRY

COPYRIGHT © 2014 BY BAXTER & WOODMAN, INC.
 STATE OF ILLINOIS - PROFESSIONAL DESIGN FIRM
 LICENSE NO. - 184-00121 - EXPIRES 4/30/2015
 560kar 2/17/2015
 \\corporate\boxwood.com\Projects\CrystalLake\140428-Lake St Imp\CADD\PH-2\140428_SH-Landscape.dgn

DESIGNED - DJS	REVISED - 2-17-15 ADDENDUM 1
DRAWN - KAR	REVISED -
CHECKED - RWL	REVISED -
DATE - 12-15-14	FILE - 140428_SH-Landscape1.dgn

STATE OF ILLINOIS
DEPARTMENT OF TRANSPORTATION

LANDSCAPING PLAN	
LAKE STREET	
SCALE: 1"=40'	STA. TO STA.

F.A.U. RTE. 189	SECTION 14-00062-00-WR	COUNTY LAKE	TOTAL SHEETS 55	SHEET NO. 38A
CONTRACT NO. 61B18				
FED. ROAD DIST. NO. 1 (ILLINOIS) FED. AID PROJECT M-40034361				