

STATE OF ILLINOIS
DEPARTMENT OF TRANSPORTATION
DIVISION OF HIGHWAYS

**PROPOSED
HIGHWAY PLANS**

F.A.P. ROUTE 734 (IL 2)
SECTION: D2 DECK REPAIR 2015-3
PROJECT: BRIDGE REPAIR
TYPE of IMPROVEMENT
WINNEBAGO COUNTY

F.A.P. RTE.	SECTION	COUNTY	TOTAL SHEETS	SHEET NO.
734	D2 DECK REPAIR 2015-3	WINNEBAGO	24	1
ILLINOIS CONTRACT NO. 64K43				

D-92-063-14



FOR INDEX OF SHEETS, SEE SHEET NO. 2
FOR STATE STANDARDS, SEE SHEET NO. 2

ROCKTON TOWNSHIP - SECTIONS 19 & 24

SN 101-0124

C-92-085-14

R.1-2E

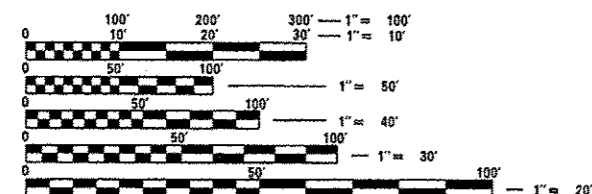
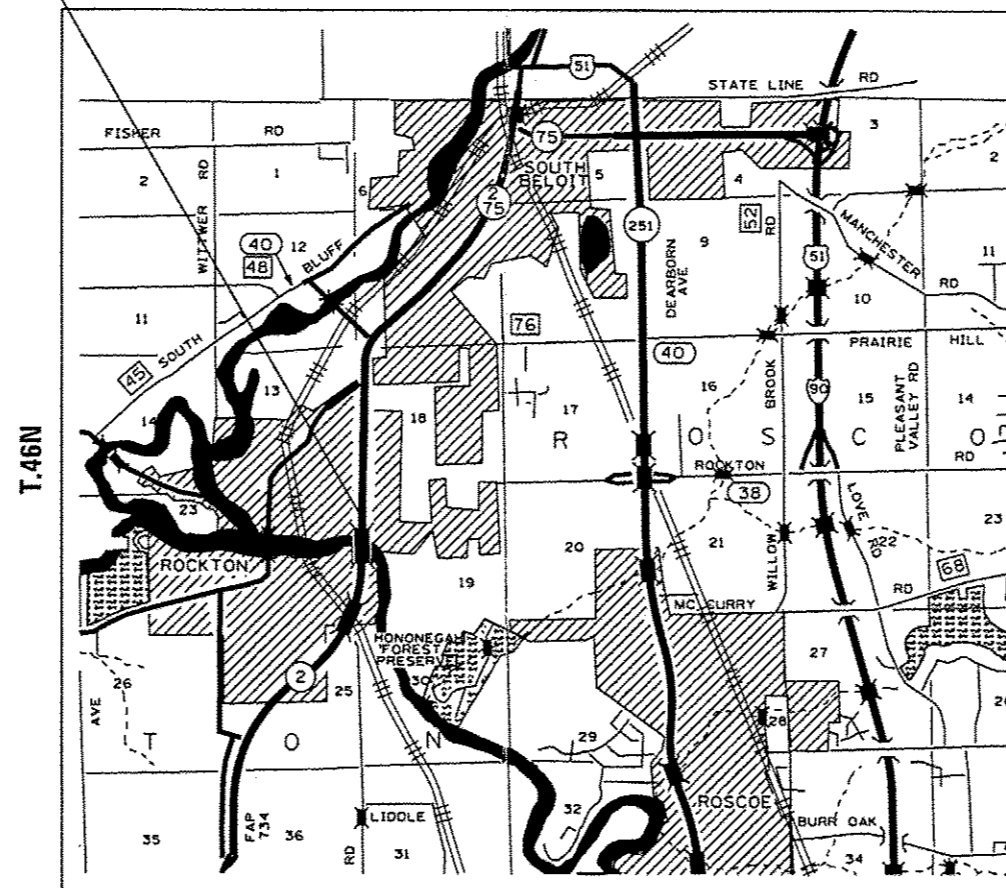

FULL SIZE PLANS HAVE BEEN PREPARED USING STANDARD ENGINEERING SCALES. REDUCED SIZED PLANS WILL NOT CONFORM TO STANDARD SCALES. IN MAKING MEASUREMENTS ON REDUCED PLANS, THE ABOVE SCALES MAY BE USED.

J.U.L.I.E.
JOINT UTILITY LOCATION INFORMATION FOR EXCAVATION
1-800-892-0123
OR 811

PROJECT ENGINEER: DAVID DOSS (815) 284-5416
PROJECT MANAGER: MAHMOUD ETEMADI (815) 284-5393

CONTRACT NO. 64K43

STATE OF ILLINOIS
DEPARTMENT OF TRANSPORTATION
DIVISION OF HIGHWAYS

SUBMITTED Nov. 7th 2014
Paul C. [Signature]
DEPUTY DIRECTOR OF HIGHWAYS, REGION ENGINEER

Jan 20 2015
John D. Baranzelli, P.E.
ENGINEER OF DESIGN AND ENVIRONMENT

Jan 20 2015
Omer Osman, P.E.
DIRECTOR OF HIGHWAYS, CHIEF ENGINEER

PRINTED BY THE AUTHORITY
OF THE STATE OF ILLINOIS

INDEX OF SHEETS

1	COVER SHEET
2	INDEX OF SHEETS, STATE STANDARDS & GENERAL NOTES
3- 4	SUMMARY OF QUANTITIES
5	STAGING TYPICALS
6 - 11	TRAFFIC CONTROL PLAN FOR SN 101-0124
12	SIDEWALK AND CURB REPAIR DETAILS
13	STOP LINE SIGN FOR TEMPORARY SIGNALS (DIST STD 99.4)
13	INFORMATIONAL WARNING SIGN (FOR NARROW TRAVEL LANES) (DIST STD 39.2)
14	ENTRANCE SIGN FOR USE WITH TEMPORARY SIGNALS (DIST STD 75.2)
15 - 17	TYPICAL PAVEMENT MARKINGS (DIST STD 41.1)
18	PAINTING DETAILS (DIST STD 44.1)
19	PLAN AND ELEVATION SN 101-0124
20 - 21	REPAIR DETAILS AT ABUTMENTS
22	REPAIR DETAILS
23	PREFORMED JOINT STRIP SEAL
24	BAR SPLICER ASSEMBLY AND MECHANICAL SPLICER DETAILS SN 101-0124

STATE STANDARDS

000001 - 06	STANDARD SYMBOLS, ABBREVIATIONS, AND PATTERNS
001006	DECIMAL EQUIVALENTS OF AN INCH AND FOOT
701006 - 05	OFF ROAD OPERATIONS, 2L, 2W, 15'(4.5 m) TO 24" (600 mm) FROM PAVEMENT EDGE
701201 - 04	LANE CLOSURE, 2L, 2W, DAY ONLY, FOR SPEEDS ≥ 45 MPH
701301 - 04	LANE CLOSURE, 2L, 2W, SHORT TIME OPERATIONS
701311 - 03	LANE CLOSURE, 2L, 2W, MOVING OPERATIONS - DAY ONLY
701321 - 14	LANE CLOSURE, 2L, 2W, BRIDGE REPAIR WITH BARRIER
701801 - 05	SIDEWALK, CORNER OR CROSSWALK CLOSURE
701901 - 04	TRAFFIC CONTROL DEVICES
704001 - 07	TEMPORARY CONCRETE BARRIER
720011 - 01	METAL POSTS FOR SIGNS, MARKERS & DELINEATORS
728001 - 01	TELESCOPING STEEL SIGN SUPPORT
729001 - 01	APPLICATIONS OF TYPES A & B METAL POSTS (FOR SIGNS & MARKERS)

GENERAL NOTES

All Borrow/Waste/Use sites must be approved by the Department prior to removing any material from the project or initiating any earthmoving activities, including temporary stockpiling outside the limits of construction.

The Contractor shall be responsible for protecting utility property during construction operations as outlined in Article 107.31 of the Standard Specifications. A minimum of 48 hours advance notice is required for non-emergency work. The JULIE number is 800-892-0123. The following listed utilities located within the project limits or immediately adjacent to the project construction limits are members of JULIE:

GAS AND ELECTRIC:

ROCK ENERGY COOPERATIVE
ATTN: ROD MAGNUSON (866) 752-4550
P.O. BOX 126/ 15229 WILLOWBROOK ROAD
SOUTH BEOLOIT, IL 61080

WATER AND SEWER:

VILLAGE OF ROCKTON
ATTN: GORDON NYGREN (815) 624-7600
110 E MAIN STREET
ROCKTON, IL 61072

TELEPHONE:

FRONTIER
ATTN: DONALD BELMORE (815) 544-6171
2239 NEWBURG ROAD
BELVIDERE, IL 61008

WIINDSTREAM
ATTN: ADAM VICKERY (217) 519-8766
1815 S. MEYERS ROAD, SUITE 900
OAK BROOK TERRACE, IL 60181

COMMUNICATIONS:

CHARTER COMMUNICATIONS
ATTN: (608) 365-3382
2016 CRANSTON ROAD
BELOIT, WI 53511

IFIBER
ATTN: LANCE SANDY (815) 753-6075
3100 SYCAMORE ROAD
DEKALB, IL 60115

ELECTRIC:

COMMONWEALTH EDISON COMPANY
ATTN: NORA FERNANDEZ
123 ENERGY AVENUE
ROCKFORD, IL 61109

GAS:

NICOR GAS CO.
ATTN: BRUCE KOPPANG (630) 388-3046
1844 FERRY ROAD
NAPERVILLE, IL 60563

IDOT is not a member of JULIE. If you are near any overhead lighting, intersection lighting or traffic signals, contact the IDOT Traffic Office at 815/284-5469 at least 48 hours prior to work.

Hazards behind Temporary Concrete Barrier Wall
No materials, equipment, vehicles or other hazards shall be within 3'-6" of the temporary concrete barrier wall, measured from the closest point of the barrier wall perpendicular to the hazard. Equipment that is actively working with 3'-6" of the barrier wall may be allowed for a short duration, if approved by the engineer, required for the work activity, and there is not another method to complete the work.

FILE NAME : G:\BR\Docs\Winnebago\54K43 Repair\SN 101-0124\CADD\02-shr-cover.dgn	USER NAME : dosadd	DESIGNED - _____	REVISED - _____	STATE OF ILLINOIS DEPARTMENT OF TRANSPORTATION	INDEX OF SHEETS, STATE STANDARDS GENERAL NOTES				F.A.P. RTE.	SECTION	COUNTY	TOTAL SHEETS	SHEET NO.		
Default	PLOT SCALE : 100.0000 / 1" = 100'	CHECKED - _____	REVISED - _____		SCALE: _____	SHEET _____	OF _____	SHEETS	STA. _____	TO STA. _____	734	D2 DECK REPAIR 2015-3	WINNEBAGO	24	2
	PLOT DATE : Wed Dec 03 10:41:00 2014	DATE - _____	REVISED - _____						ILLINOIS FED. AID PROJECT						

SUMMARY OF QUANTITIES

URBAN
0014
100%
State Funds

CODE NUMBER	ITEM	UNIT	TOTAL QUANTITY
50102400	CONCRETE REMOVAL	CU YD	16.2
50157300	PROTECTIVE SHIELD	SQ YD	390
50300255	CONCRETE SUPERSTRUCTURE	CU YD	16.2
50300260	BRIDGE DECK GROOVING	SQ YD	837
50800205	REINFORCEMENT BARS, EPOXY COATED	POUND	2340
50800515	BAR SPLICERS	EACH	24
52000110	PREFORMED JOINT STRIP SEAL	FOOT	102
67000400	ENGINEER'S FIELD OFFICE, TYPE A	CAL MO	3
67100100	MOBILIZATION	L SUM	1
70100405	TRAFFIC CONTROL AND PROTECTION, STANDARD 701321	EACH	1
70100450	TRAFFIC CONTROL AND PROTECTION, STANDARD 701201	L SUM	1
70100500	TRAFFIC CONTROL AND PROTECTION, STANDARD 701326	L SUM	1
70102640	TRAFFIC CONTROL AND PROTECTION, STANDARD 701801	L SUM	1
70106500	TEMPORARY BRIDGE TRAFFIC SIGNALS	EACH	1
70300220	TEMPORARY PAVEMENT MARKING LINE, 4"	FOOT	2,601
70300280	TEMPORARY PAVEMENT MARKING LINE, 24"	FOOT	24

Rev.

FILE NAME : G:\BRV\Draws\Winnabago\64K43 Repair.dwg	USER NAME : dosadd	DESIGNED - _____	REVISED - _____	STATE OF ILLINOIS DEPARTMENT OF TRANSPORTATION	SUMMARY OF QUANTITIES	F.A.P. RTE. 734	SECTION 02 DECK REPAIR 2015-3	COUNTY WINNEBAGO	TOTAL SHEETS 24	SHEET NO. 3
Default	PLOT SCALE : 100.0000 / 1 in.	CHECKED - _____	REVISED - _____		SCALE: _____ SHEET _____ OF _____ SHEETS					
	PLOT DATE : Thu Nov 06 10:00:35 2014	DATE - _____	REVISED - _____		STA. _____ TO STA. _____					
ILLINOIS FED. AID PROJECT CONTRACT NO. 64K43										

SUMMARY OF QUANTITIES

0014
100%
State Funds

CODE NUMBER	ITEM	UNIT	TOTAL QUANTITY
70301000	WORK ZONE PAVEMENT MARKING REMOVAL	SQ FT	875
70400100	TEMPORARY CONCRETE BARRIER	FOOT	453.6
70400200	RELOCATE TEMPORARY CONCRETE BARRIER	FOOT	441
70600240	IMPACT ATTENUATORS, TEMPORARY (NON-REDIRECTIVE), TEST LEVEL 2	EACH	1
70600251	IMPACT ATTENUATORS, TEMPORARY (NON-REDIRECTIVE, NARROW), TEST LEVEL 3	EACH	1
70600340	IMPACT ATTENUATORS, RELOCATE (NON-REDIRECTIVE), TEST LEVEL 2	EACH	1
70600352	IMPACT ATTENUATORS, RELOCATE (NON-REDIRECTIVE, NARROW), TEST LEVEL 3	EACH	1
78300100	PAVEMENT MARKING REMOVAL	SQ FT	291
Z0012144	BRIDGE DECK SCARIFICATION 2 1/2"	SQ YD	895
Z0006014	BRIDGE DECK LATEX CONCRETE OVERLAY 2 1/2 INCHES	SQ YD	895
Z0012754	STRUCTURAL REPAIR OF CONCRETE (DEPTH EQUAL TO OR LESS THAN 5 INCHES)	SQ FT	1078
Z0012755	STRUCTURAL REPAIR OF CONCRETE (DEPTH GREATER THAN 5 INCHES)	SQ FT	403
Z0016001	DECK SLAB REPAIR (FULL DEPTH, TYPE I)	SQ YD	50
Z0016002	DECK SLAB REPAIR (FULL DEPTH, TYPE II)	SQ YD	10

Rev.

STAGING TYPICALS

SIDEWALK CLOSED

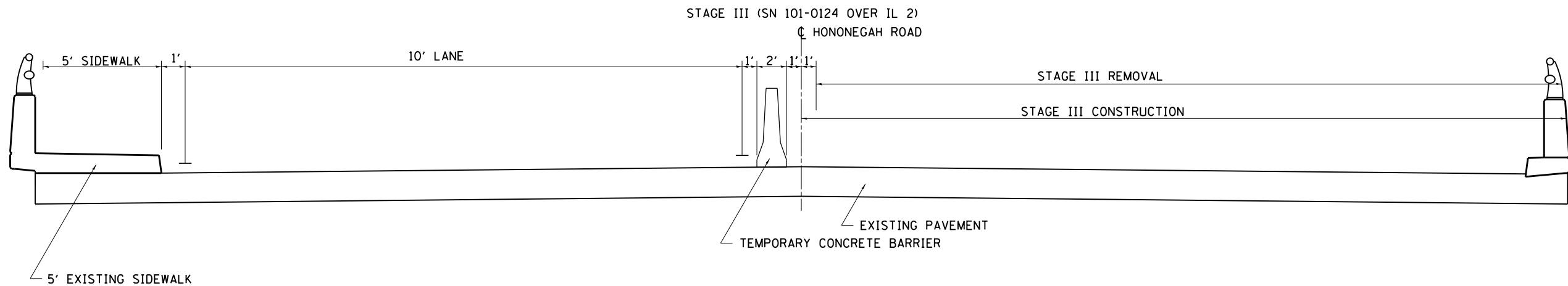
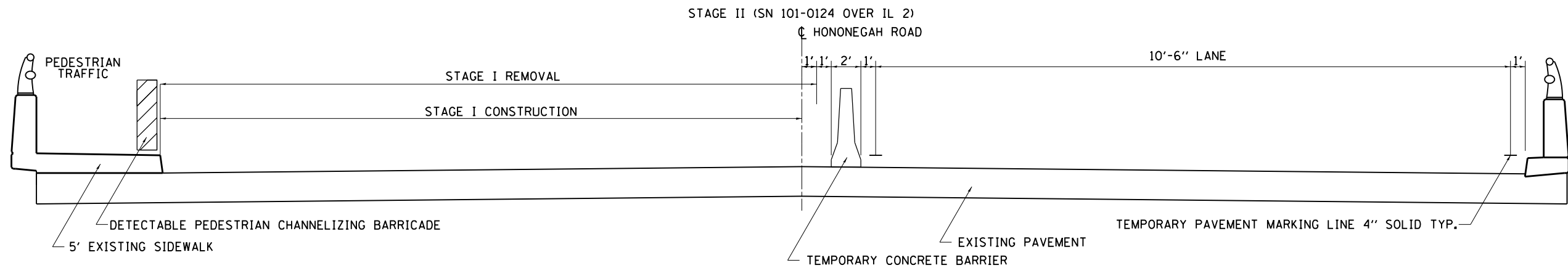
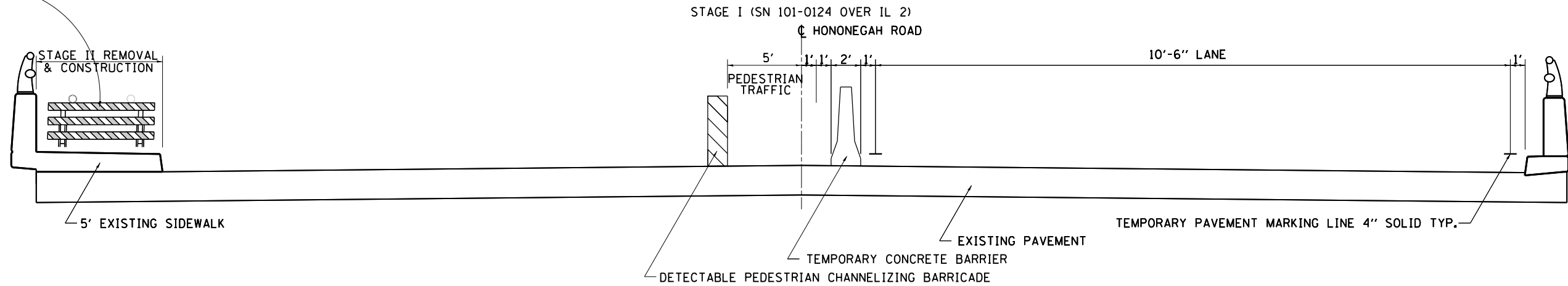

FILE NAME =	USER NAME = dossdd	DESIGNED - _____	REVISED - _____
D:\NBR\Doss\Winnebago\64K43 Repairs SN 101-0124\CADD\02-sht-cover.dgn		DRAWN - _____	REVISED - _____
Default	PLOT SCALE = 100.0000' / 1" =	CHECKED - _____	REVISED - _____
	PLOT DATE = Thu Nov 06 10:00:47 2014	DATE - _____	REVISED - _____

STATE OF ILLINOIS
 DEPARTMENT OF TRANSPORTATION

STAGING TYPICALS

SCALE: _____ SHEET _____ OF _____ SHEETS STA. _____ TO STA. _____

F.A.P. RTE.	SECTION	COUNTY	TOTAL SHEETS	SHEET NO.
734	D2 DECK REPAIR 2015-3	WINNEBAGO	24	5
CONTRACT NO. 64K43			ILLINOIS FED. AID PROJECT	

TRAFFIC CONTROL PLAN FOR SN 101-0124 STAGE I

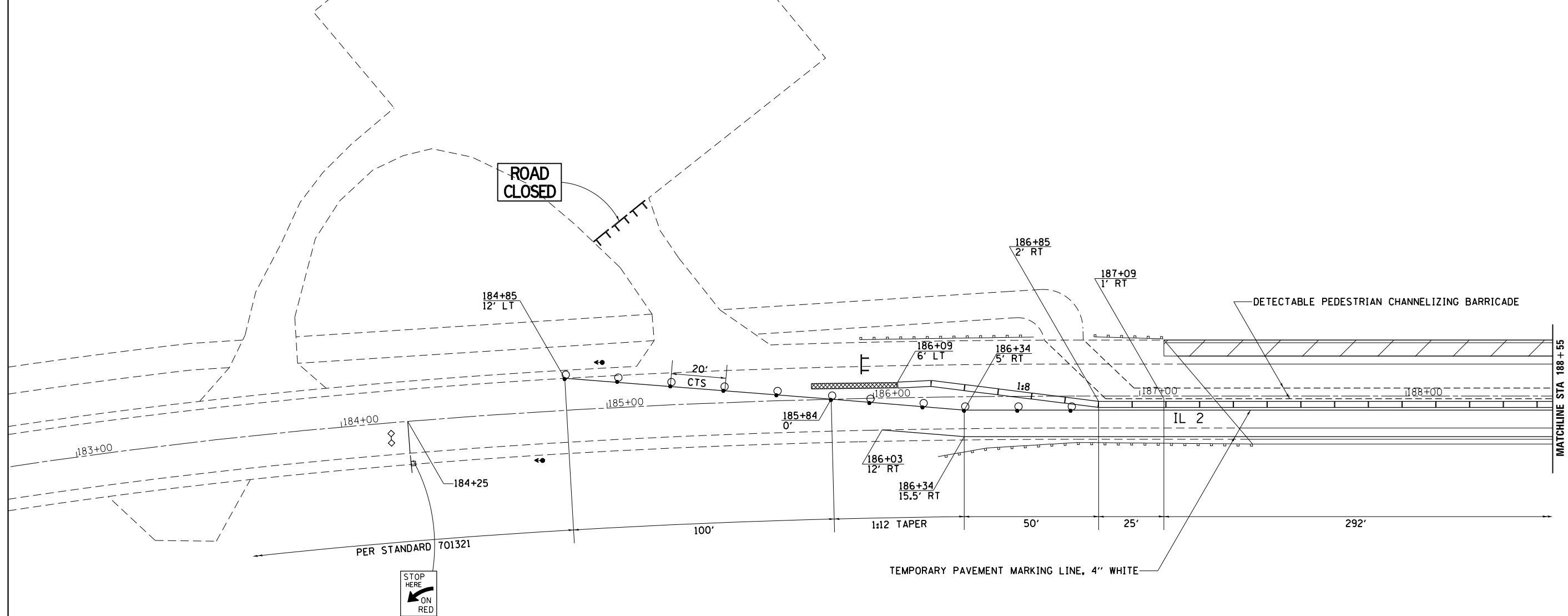
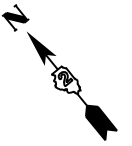

MAINTENANCE OF PEDESTRIAN TRAFFIC NOTES

Pedestrian access shall be maintained at all times.

Contractor shall provide signage and detectable pedestrian channelizing barricades to facilitate and protect pedestrians.

The contractor shall protect pedestrians from hazards caused by construction activities at all times. This includes, but is not limited to flying debris from work.

GENERAL NOTES

See Traffic Control and Protection Standard 701321 for details not shown.

This Standard is used where, at any time, any vehicle, equipment, workers, or their activities will encroach on one lane of a bridge. Traffic signals and a positive barrier are required.

Traffic signals shall be operational only when all traffic controls are in place. When traffic signals are not in operation, flaggers shall be used and traffic control shall conform to Standard 701201 or 701206.

Temporary concrete barrier shall be according to Standard 704001.

Existing or temporary pavement markings shall be on both sides of open lane from stop bar to stop bar.

All dimensions are in inches (millimeters) unless otherwise shown.

SYMBOLS	
	Work area
	Sign
	Type III barricade
	Traffic signal
	Detector loops
	Impact attenuator
	Drum with steady burning bi-directional light
	Temporary concrete barrier
	Temporary rumble strip (when specified)
	Double vertical panel (see detail)
	Crystal, bidirectional barrier wall/guardrail marker
	Detectable Pedestrian Channelizing Barricade

FILE NAME =	USER NAME = dssdd	DESIGNED - _____	REVISED - _____
D:\BR\Draws\Winnebago\64K43 Repairs SN	101-0124\CADD\02-sht-cover.dgn	DRAWN - _____	REVISED - _____
Default	PLOT SCALE = 40.0000' / in.	CHECKED - _____	REVISED - _____
	PLOT DATE = Thu Nov 06 10:01:03 2014	DATE - _____	REVISED - _____

STATE OF ILLINOIS
DEPARTMENT OF TRANSPORTATION

TRAFFIC CONTROL PLAN FOR SN 101-0124
STAGE I

SCALE: _____ SHEET _____ OF _____ SHEETS STA. _____ TO STA. _____

F.A.P. RTE.	SECTION	COUNTY	TOTAL SHEETS	SHEET NO.
734	D2 DECK REPAIR 2015-3	WINNEBAGO	24	6
CONTRACT NO. 64K43			ILLINOIS FED. AID PROJECT	

TRAFFIC CONTROL PLAN FOR SN 101-0124 STAGE I

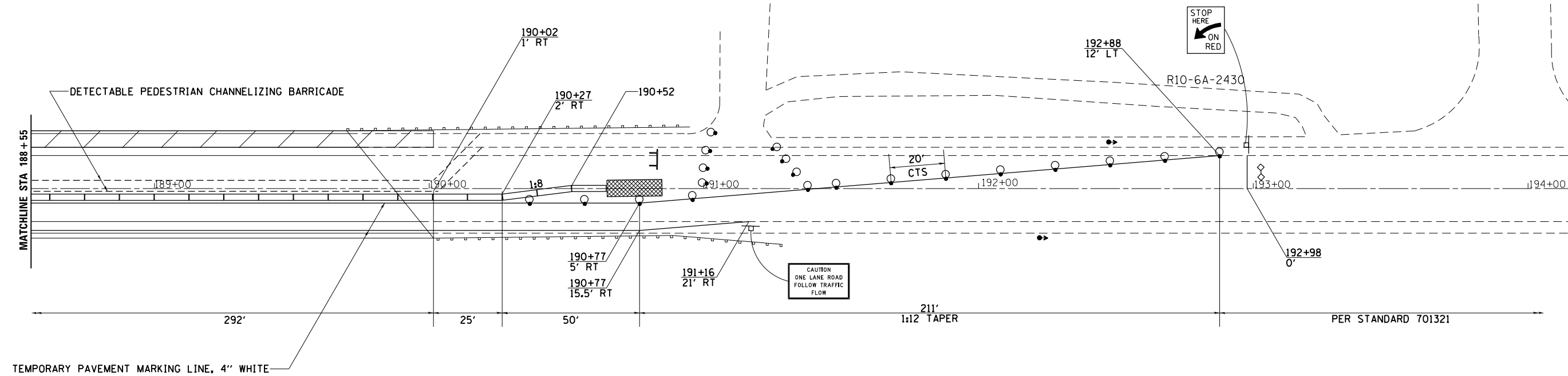
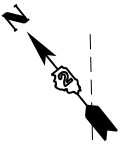

MAINTENANCE OF PEDESTRIAN TRAFFIC NOTES

Pedestrian access shall be maintained at all times.

Contractor shall provide signage and detectable pedestrian channelizing barricades to facilitate and protect pedestrians.

The contractor shall protect pedestrians from hazards caused by construction activities at all times. This includes, but is not limited to flying debris from work.

GENERAL NOTES

See Traffic Control and Protection Standard 701321 for details not shown.

This Standard is used where, at any time, any vehicle, equipment, workers, or their activities will encroach on one lane of a bridge. Traffic signals and a positive barrier are required.

Traffic signals shall be operational only when all traffic controls are in place. When traffic signals are not in operation, flaggers shall be used and traffic control shall conform to Standard 701201 or 701206.

Temporary concrete barrier shall be according to Standard 704001.

Existing or temporary pavement markings shall be on both sides of open lane from stop bar to stop bar.

All dimensions are in inches (millimeters) unless otherwise shown.

SYMBOLS

- Work area
- Sign
- Type III barricade
- Traffic signal
- Detector loops
- Impact attenuator
- Drum with steady burning bi-directional light
- Temporary concrete barrier
- Temporary rumble strip (when specified)
- Double vertical panel (see detail)
- Crystal, bidirectional barrier wall/guardrail marker
- Detectable Pedestrian Channelizing Barricade

FILE NAME =	USER NAME = dosddd	DESIGNED - _____	REVISED - _____
D:\BR\Bos\Winnebago\64K43 Repairs SN 101-0124\CADD\02-sht-cover.dgn		DRAWN - _____	REVISED - _____
Default	PLOT SCALE = 40.0000' / in.	CHECKED - _____	REVISED - _____
	PLOT DATE = Thu Nov 06 10:01:12 2014	DATE - _____	REVISED - _____

STATE OF ILLINOIS
DEPARTMENT OF TRANSPORTATION

TRAFFIC CONTROL PLAN FOR SN 101-0124
STAGE I

SCALE: _____ SHEET _____ OF _____ SHEETS STA. _____ TO STA. _____

F.A.P. RTE.	SECTION	COUNTY	TOTAL SHEETS	SHEET NO.
734	D2 DECK REPAIR 2015-3	WINNEBAGO	24	7
CONTRACT NO. 64K43			ILLINOIS FED. AID PROJECT	

TRAFFIC CONTROL PLAN FOR SN 101-0124 STAGE II

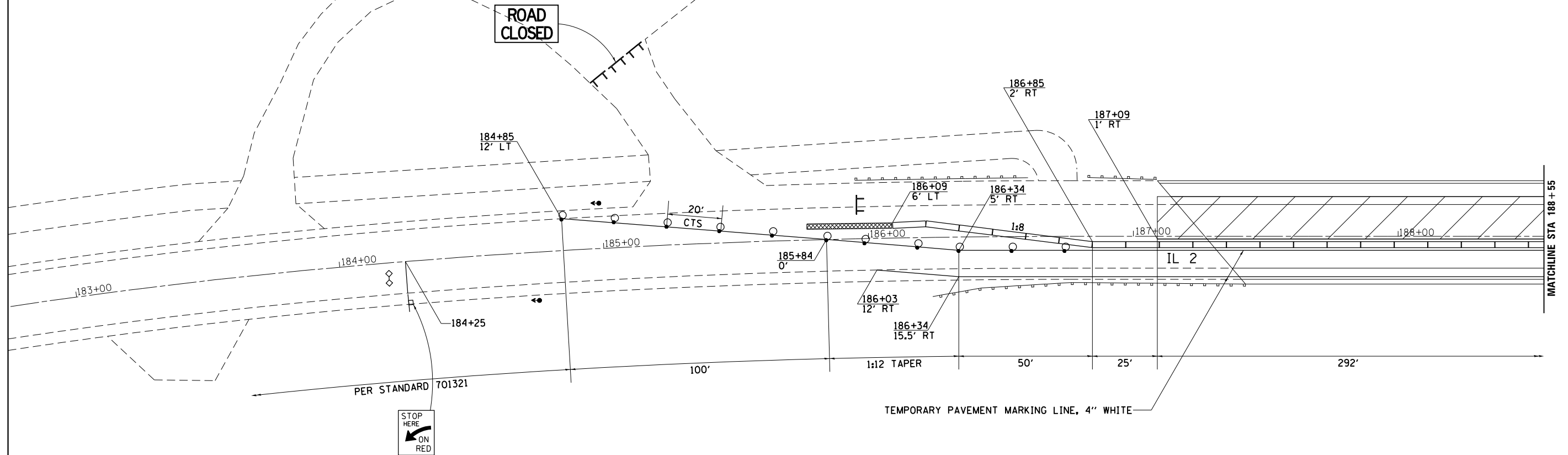
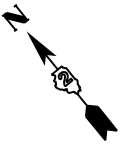

R10-6A-2430

GENERAL NOTES

See Traffic Control and Protection Standard 701321 for details not shown.

This Standard is used where, at any time, any vehicle, equipment, workers, or their activities will encroach on one lane of a bridge. Traffic signals and a positive barrier are required.

Traffic signals shall be operational only when all traffic controls are in place. When traffic signals are not in operation, flaggers shall be used and traffic control shall conform to Standard 701201 or 701206.

Temporary concrete barrier shall be according to Standard 704001.

Existing or temporary pavement markings shall be on both sides of open lane from stop bar to stop bar.

All dimensions are in inches (millimeters) unless otherwise shown.

- ### SYMBOLS
- Work area
 - Sign
 - Type III barricade
 - Traffic signal
 - Detector loops
 - Impact attenuator
 - Drum with steady burning bi-directional light
 - Temporary concrete barrier
 - Temporary rumble strip (when specified)
 - Double vertical panel (see detail)
 - Crystal, bidirectional barrier wall/guardrail marker
 - Detectable Pedestrian Channelizing Barricade

FILE NAME =	USER NAME = dossed	DESIGNED - _____	REVISED - _____
D:\BR\Bos\Winnebago\64K43 Repairs SN	101-0124\CADD\02-sht-cover.dgn	DRAWN - _____	REVISED - _____
Default	PLOT SCALE = 40.0000' / in.	CHECKED - _____	REVISED - _____
	PLOT DATE = Thu Nov 06 10:01:18 2014	DATE - _____	REVISED - _____

STATE OF ILLINOIS
DEPARTMENT OF TRANSPORTATION

TRAFFIC CONTROL PLAN FOR SN 101-0124
STAGE II

SCALE: _____ SHEET _____ OF _____ SHEETS STA. _____ TO STA. _____

F.A.P. RTE.	SECTION	COUNTY	TOTAL SHEETS	SHEET NO.
734	D2 DECK REPAIR 2015-3	WINNEBAGO	24	8
CONTRACT NO. 64K43			ILLINOIS FED. AID PROJECT	

TRAFFIC CONTROL PLAN FOR SN 101-0124 STAGE II

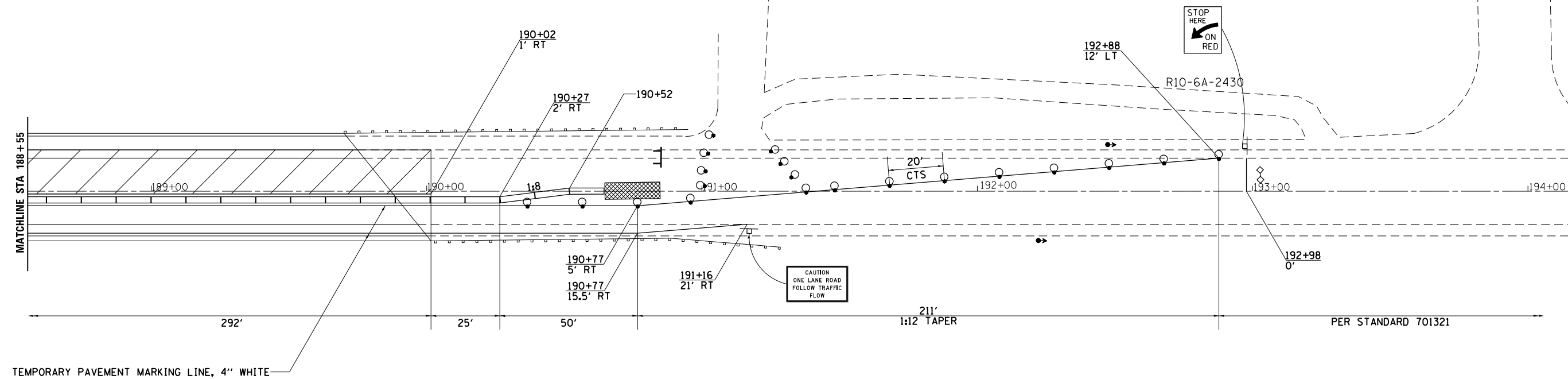
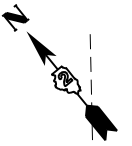

GENERAL NOTES

See Traffic Control and Protection Standard 701321 for details not shown.

This Standard is used where, at any time, any vehicle, equipment, workers, or their activities will encroach on one lane of a bridge. Traffic signals and a positive barrier are required.

Traffic signals shall be operational only when all traffic controls are in place. When traffic signals are not in operation, flaggers shall be used and traffic control shall conform to Standard 701201 or 701206.

Temporary concrete barrier shall be according to Standard 704001.

Existing or temporary pavement markings shall be on both sides of open lane from stop bar to stop bar.

All dimensions are in inches (millimeters) unless otherwise shown.

SYMBOLS

- Work area
- Sign
- Type III barricade
- Traffic signal
- Detector loops
- Impact attenuator
- Drum with steady burning bi-directional light
- Temporary concrete barrier
- Temporary rumble strip (when specified)
- Double vertical panel (see detail)
- Crystal, bidirectional barrier wall/guardrail marker
- Detectable Pedestrian Channelizing Barricade

FILE NAME =	USER NAME = dosddd	DESIGNED - _____	REVISED - _____
Q:\BR\Draws\Winnebago\64K43 Repairs SN	101-0124\CADD\02-sht-cover.dgn	DRAWN - _____	REVISED - _____
Default	PLOT SCALE = 40.0000' / in.	CHECKED - _____	REVISED - _____
	PLOT DATE = Thu Nov 06 10:01:28 2014	DATE - _____	REVISED - _____

**STATE OF ILLINOIS
DEPARTMENT OF TRANSPORTATION**

**TRAFFIC CONTROL PLAN FOR SN 101-0124
STAGE II**

SCALE: _____ SHEET _____ OF _____ SHEETS STA. _____ TO STA. _____

F.A.P. RTE.	SECTION	COUNTY	TOTAL SHEETS	SHEET NO.
734	D2 DECK REPAIR 2015-3	WINNEBAGO	24	9
CONTRACT NO.			64K43	
ILLINOIS FED. AID PROJECT				

TRAFFIC CONTROL PLAN FOR SN 101-0124 STAGE III

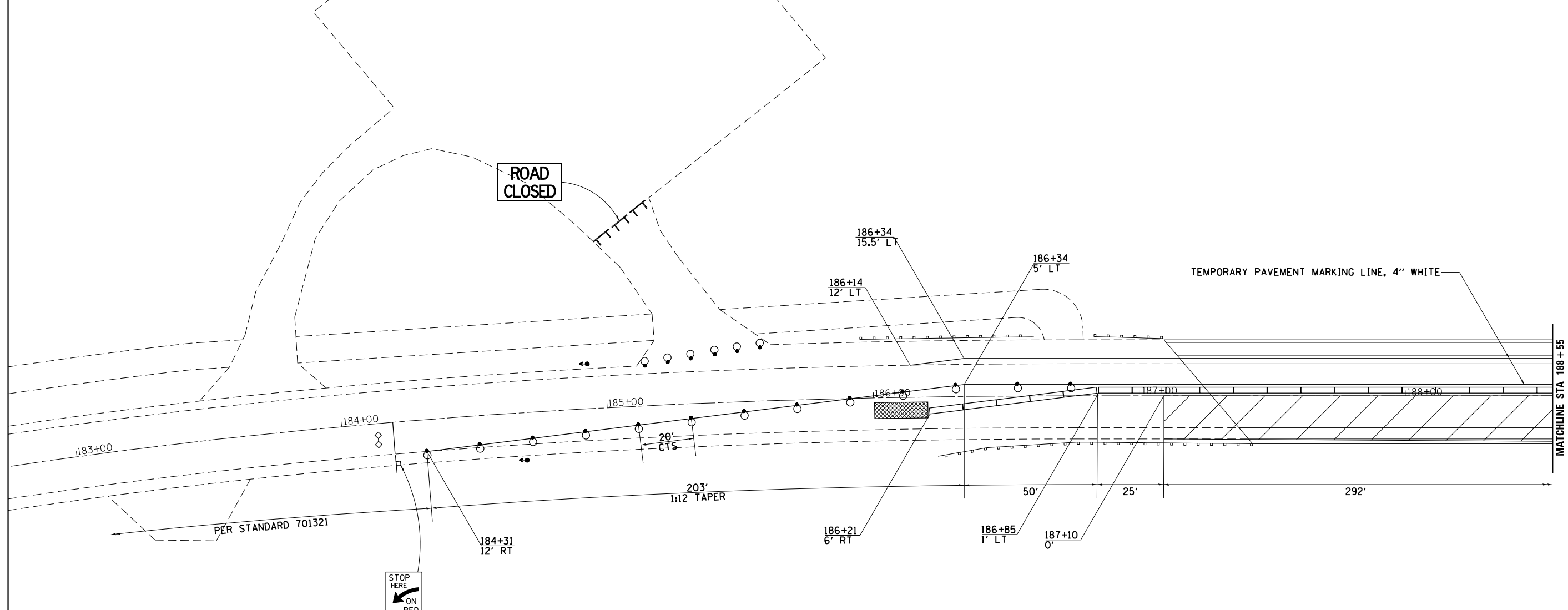
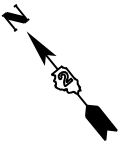

GENERAL NOTES

See Traffic Control and Protection Standard 701321 for details not shown.

This Standard is used where, at any time, any vehicle, equipment, workers, or their activities will encroach on one lane of a bridge. Traffic signals and a positive barrier are required.

Traffic signals shall be operational only when all traffic controls are in place. When traffic signals are not in operation, flaggers shall be used and traffic control shall conform to Standard 701201 or 701206.

Temporary concrete barrier shall be according to Standard 704001.

Existing or temporary pavement markings shall be on both sides of open lane from stop bar to stop bar.

All dimensions are in inches (millimeters) unless otherwise shown.

SYMBOLS	
	Work area
	Sign
	Type III barricade
	Traffic signal
	Detector loops
	Impact attenuator
	Drum with steady burning bi-directional light
	Temporary concrete barrier
	Temporary rumble strip (when specified)
	Double vertical panel (see detail)
	Crystal, bidirectional barrier wall/guardrail marker
	Detectable Pedestrian Channelizing Barricade

FILE NAME =	USER NAME = dosddd	DESIGNED - _____	REVISED - _____
D:\BR\Bos\Winnebago\64K43 Repairs SN 101-0124\CADD\02-sht-cover.dgn		DRAWN - _____	REVISED - _____
Default	PLOT SCALE = 40.0000' / in.	CHECKED - _____	REVISED - _____
	PLOT DATE = Thu Nov 06 10:01:34 2014	DATE - _____	REVISED - _____

**STATE OF ILLINOIS
DEPARTMENT OF TRANSPORTATION**

**TRAFFIC CONTROL PLAN FOR SN 101-0124
STAGE III**

SCALE: _____ SHEET _____ OF _____ SHEETS STA. _____ TO STA. _____

F.A.P. RTE.	SECTION	COUNTY	TOTAL SHEETS	SHEET NO.
734	D2 DECK REPAIR 2015-3	WINNEBAGO	24	10
CONTRACT NO. 64K43			ILLINOIS FED. AID PROJECT	

TRAFFIC CONTROL PLAN FOR SN 101-0124 STAGE III

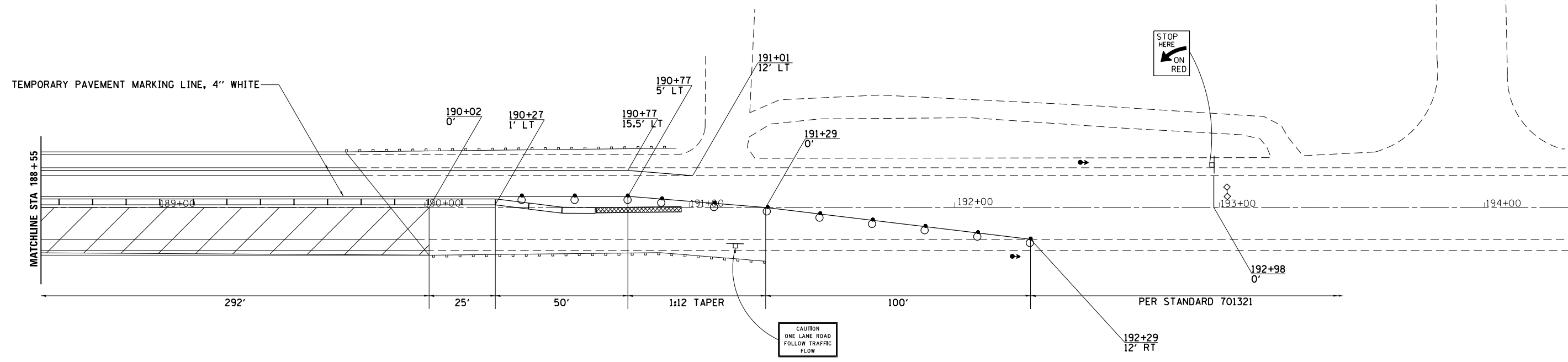
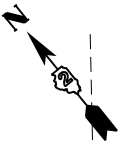

GENERAL NOTES

See Traffic Control and Protection Standard 701321 for details not shown.

This Standard is used where, at any time, any vehicle, equipment, workers, or their activities will encroach on one lane of a bridge. Traffic signals and a positive barrier are required.

Traffic signals shall be operational only when all traffic controls are in place. When traffic signals are not in operation, flaggers shall be used and traffic control shall conform to Standard 701201 or 701206.

Temporary concrete barrier shall be according to Standard 704001.

Existing or temporary pavement markings shall be on both sides of open lane from stop bar to stop bar.

All dimensions are in inches (millimeters) unless otherwise shown.

- SYMBOLS**
- Work area
 - Sign
 - Type III barricade
 - Traffic signal
 - Detector loops
 - Impact attenuator
 - Drum with steady burning bi-directional light
 - Temporary concrete barrier
 - Temporary rumble strip (when specified)
 - Double vertical panel (see detail)
 - Crystal, bidirectional barrier wall/guardrail marker
 - Detectable Pedestrian Channelizing Barricade

FILE NAME =	USER NAME = dosddd	DESIGNED - _____	REVISED - _____	STATE OF ILLINOIS DEPARTMENT OF TRANSPORTATION	TRAFFIC CONTROL PLAN FOR SN 101-0124 STAGE III	F.A.P. RTE.	SECTION	COUNTY	TOTAL SHEETS	SHEET NO.	
0:\BR\008\Winnebago\64K43 Repairs SN	101-0124\CADD\02-sht-cover.dgn	DRAWN - _____	REVISED - _____			734	D2 DECK REPAIR 2015-3	WINNEBAGO	24	11	
Default	PLOT SCALE = 40.0000' / in.	CHECKED - _____	REVISED - _____			CONTRACT NO. 64K43					
	PLOT DATE = Thu Nov 06 10:01:43 2014	DATE - _____	REVISED - _____			ILLINOIS FED. AID PROJECT					

SIDEWALK AND CURB REPAIR DETAILS

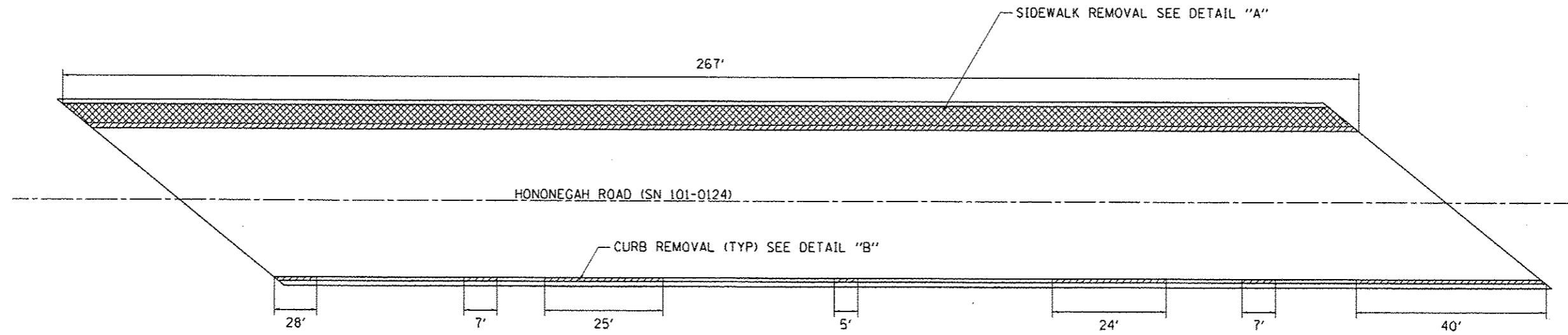

DETAIL "A"
SIDEWALK REPAIR DETAIL

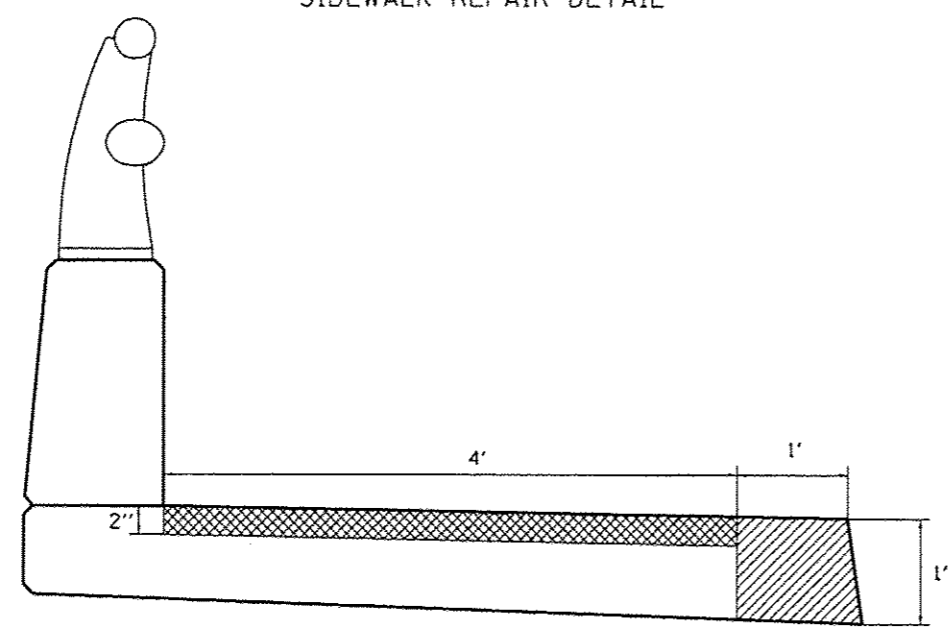

DETAIL "B"
CURB REPAIR DETAIL

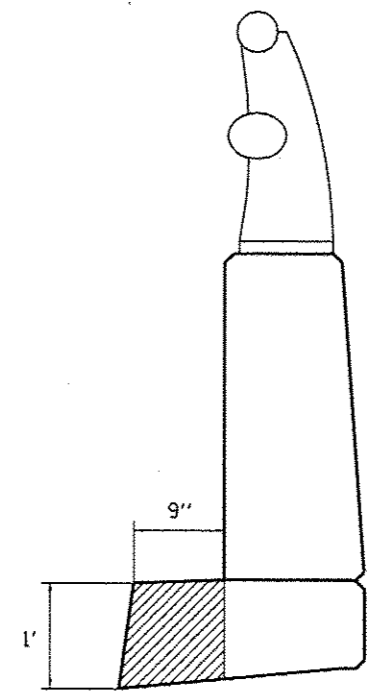

- STRUCTURAL REPAIR OF CONCRETE (DEPTH EQUAL TO OR LESS THAN 5 INCHES) = 1,068 SQ FT
- STRUCTURAL REPAIR OF CONCRETE (DEPTH GREATER THAN 5 INCHES) = 403 SQ FT

FILE NAME :	USER NAME : dswadd	DESIGNED - _____	REVISED - _____	STATE OF ILLINOIS DEPARTMENT OF TRANSPORTATION	SIDEWALK AND CURB REPAIR DETAILS	F.A.P. RTE.:	SECTION:	COUNTY:	TOTAL SHEETS:	SHEET NO.:
D:\BR\Draw\Winnebago\64K43 Repairs SN	11-0124\CADD\02-shr-cover.dgn	DRAWN - _____	REVISED - _____			734	D2 DECK REPAIR 2015-3	WINNEBAGO	24	12
Default	PLOT SCALE = 100,0000 / 1" = 100'	CHECKED - _____	REVISED - _____		SCALE: _____	SHEET _____ OF _____ SHEETS		STA. _____ TO STA. _____		CONTRACT NO. 64K43
	PLOT DATE = Wed Dec 03 10:41:54 2014	DATE - _____	REVISED - _____			ILLINOIS FED. AID PROJECT				

STOP LINE SIGN FOR TEMPORARY SIGNALS

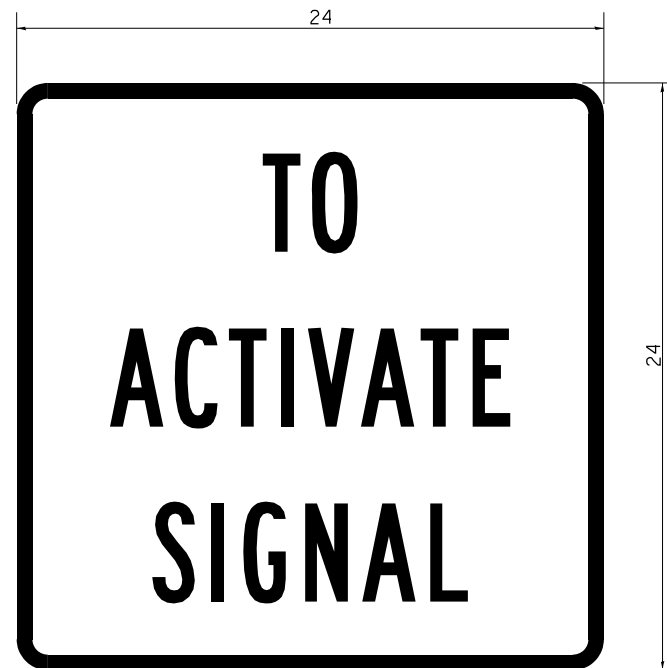

SIZE: 24 x 24
 4 CAPITAL LETTERS - BLACK
 1/2 BORDER - BLACK
 WHITE REFLECTIVE - TYPE AP
 HIGH INTENSITY PRISMATIC SHEETING

GENERAL NOTE:

THIS SIGN SHALL BE INSTALLED AT THE STOP LINE AS DIRECTED BY ENGINEER.

ALL DIMENSIONS ARE IN INCHES UNLESS OTHERWISE NOTED.

REVISED - 10-11-11

STOP LINE SIGN FOR TEMPORARY SIGNALS 99.4

INFORMATIONAL WARNING SIGN (FOR NARROW TRAVEL LANES)

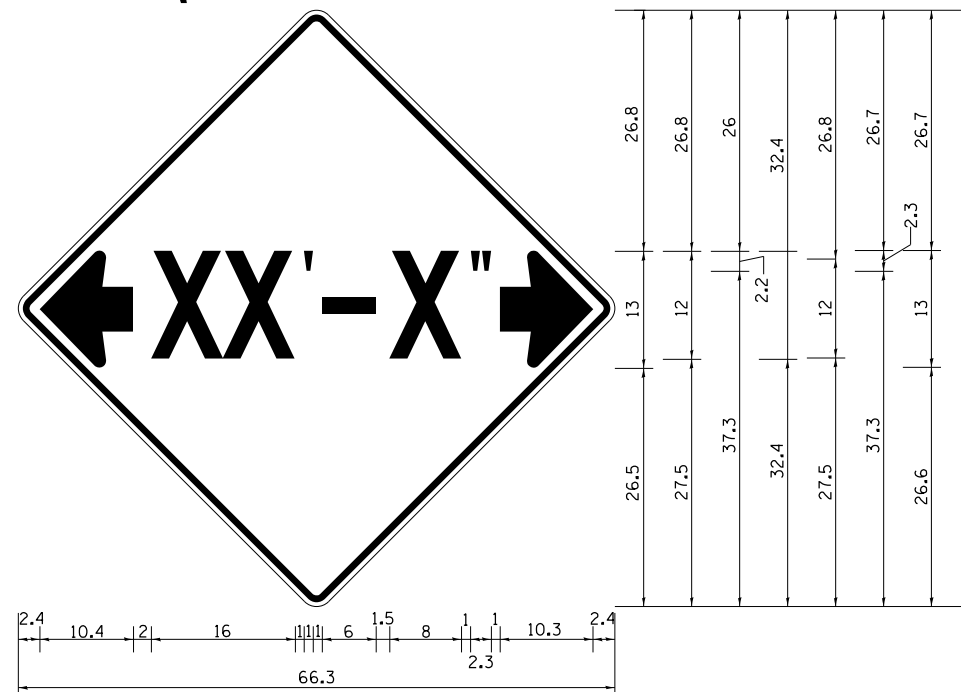

NOTES
 W12-2 - Horizontal Clearance Sign
 48.0" across sides, 1.9" Radius,
 0.8" Border, 0.5" Indent, Black on
 Orange; Standard Arrow Custom
 10.4" X 8.1" 180° Black 11 Inch
 D Series Lettering; Standard Arrow
 Custom 10.4" X 8.1" 0°

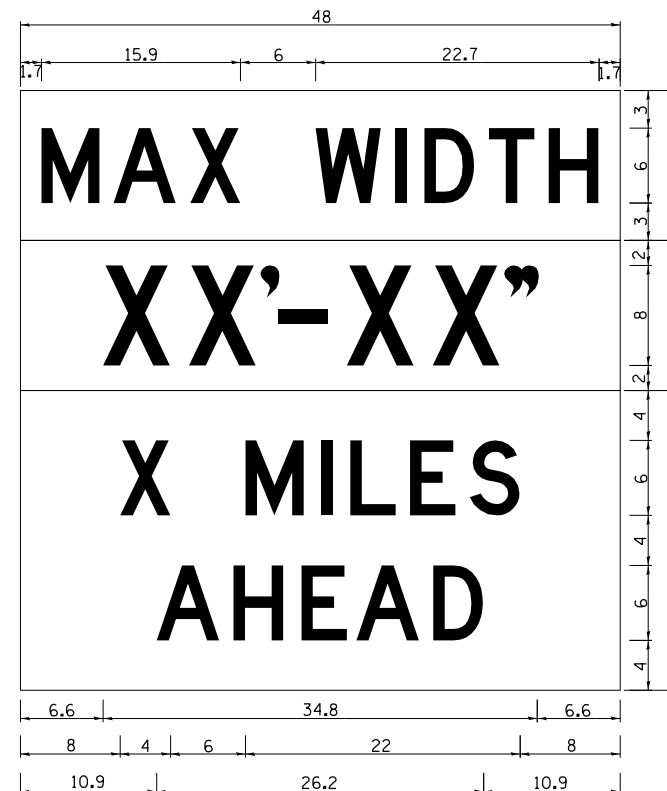

W12-1103 (Width is 8D);
 No border, Black on White;
 [MAX WIDTH] D;

 No border, Black on Orange;
 [XX'-XX''] D;

 No border, Black on White;
 [X MILES] D; [AHEAD] D;

All work to furnish and install these signs shall be included in the cost of the Traffic Control Standards and shall not be paid for separately.

ALL DIMENSIONS ARE IN INCHES UNLESS OTHERWISE NOTED.

REVISED - 5-15-09	REGION 2 / DISTRICT 2 STANDARD			F.A.P. RTE.	SECTION	COUNTY	TOTAL SHEETS	SHEET NO.
REVISED -				734	D2 DECK REPAIR 2015-3	WINNEBAGO	24	13
REVISED -				CONTRACT NO. 64K43				
REVISED -				FED. ROAD DIST. NO. ILLINOIS FED. AID PROJECT				

ENTRANCE SIGN FOR USE WITH TEMPORARY SIGNALS

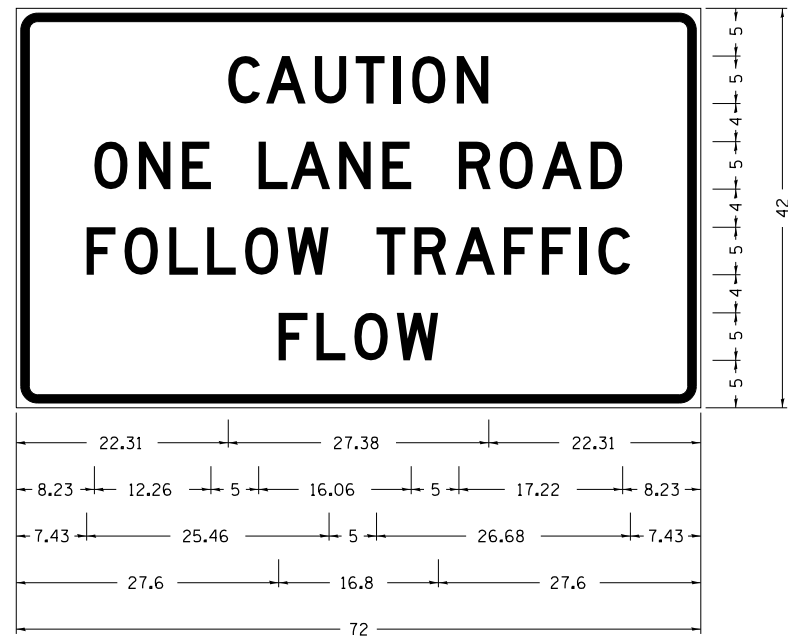

Type AA Fluorescent Orange Sheeting ;
 2.25" Radius, 0.88" Border, 0.50" Indent, Black on Orange;
 [CAUTION] D; [ONE LANE ROAD] D;
 [FOLLOW TRAFFIC] D; [FLOW] D

Table Of Widths And Spaces

22.31	C	3.36	0.62	A	4.18	0.94	U	3.36	0.94	T	3.04	0.94	I	0.78	1.17	O	3.52	1.17	N	3.36	22.31
8.23	O	3.51	1.17	N	3.36	1.18	E	3.04													
5.00	L	3.05	0.31	A	4.18	0.94	N	3.36	1.17	E	3.05										
5.00	R	3.36	0.93	O	3.52	0.94	A	4.18	0.93	D	3.36	8.23									
7.43	F	3.04	0.94	O	3.52	1.17	L	3.04	0.94	L	3.05	0.94	O	3.51	0.94	W	4.37				
5.00	T	3.05	0.94	R	3.36	0.94	A	4.18	0.93	F	3.05	0.94	F	3.04	0.94	I	0.78	1.18	C	3.35	7.43
27.60	F	3.05	0.94	L	3.04	0.94	O	3.52	0.93	W	4.38	27.60									

GENERAL NOTES

THIS SIGN SHALL BE INSTALLED AT ENTRANCES LOCATED BETWEEN THE TEMPORARY SIGNALS AS DIRECTED BY THE ENGINEER.

ALL DIMENSIONS ARE IN INCHES UNLESS OTHERWISE NOTED.

THE COST TO FURNISH, INSTALL AND REMOVE THIS SIGN AT THE REQUIRED LOCATIONS SHALL BE INCLUDED IN THE COST OF TRAFFIC CONTROL AND PROTECTION STANDARD 701321.

ALL DIMENSIONS ARE IN INCHES UNLESS OTHERWISE NOTED.

REVISED - 10-14-11

REVISD -																						
REVISD -																						
REVISD -																						
REVISD -																						
REGION 2 / DISTRICT 2 STANDARD												F.A.P. RTE.	SECTION	COUNTY	TOTAL SHEETS	SHEET NO.						
SCALE: 1/2" = 1'-0"												734	D2 DECK REPAIR 2015-3	WINNEBAGO	24	14						
SHEET NO. OF SHEETS												CONTRACT NO. 64K43										
STA. TO STA.												FED. ROAD DIST. NO. ILLINOIS FED. AID PROJECT										

TYPICAL PAVEMENT MARKINGS

TYPICAL PAVEMENT MARKING FOR FLUSH MEDIAN AT LEFT TURN LANE

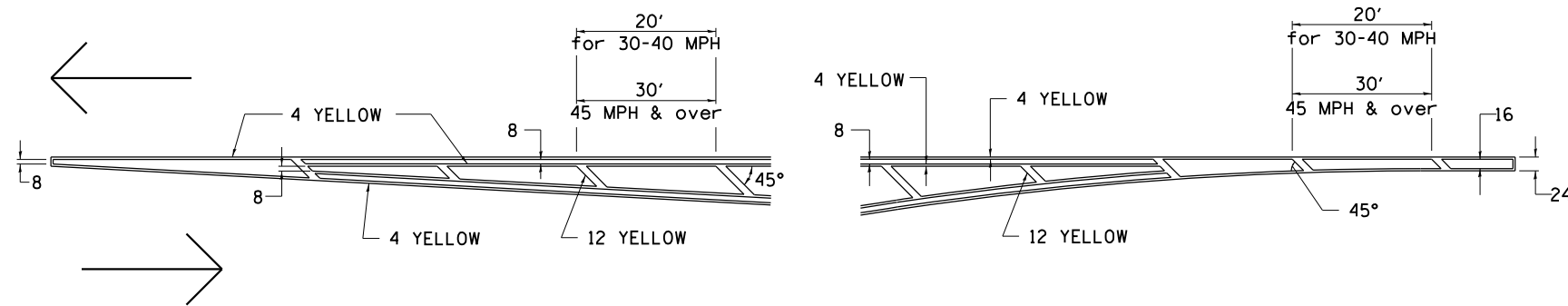

MEDIAN PAVEMENT MARKING

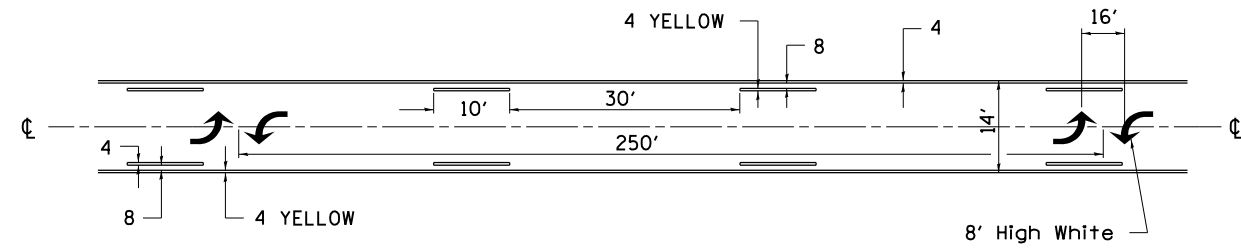

•• ALL DIMENSIONS ARE IN INCHES UNLESS OTHERWISE NOTED.

TYPICAL ISLAND OFFSET SHOULDER WIDTH

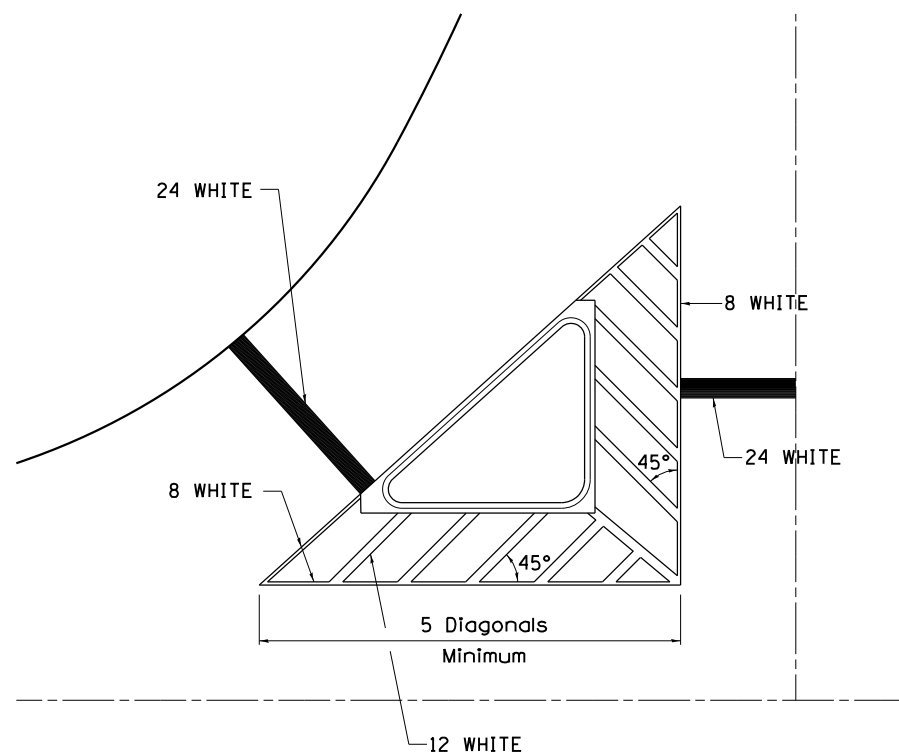

TYPICAL MARKING FOR PAINTED ISLANDS

NOTE:
* 45° TO LOCAL TAN.

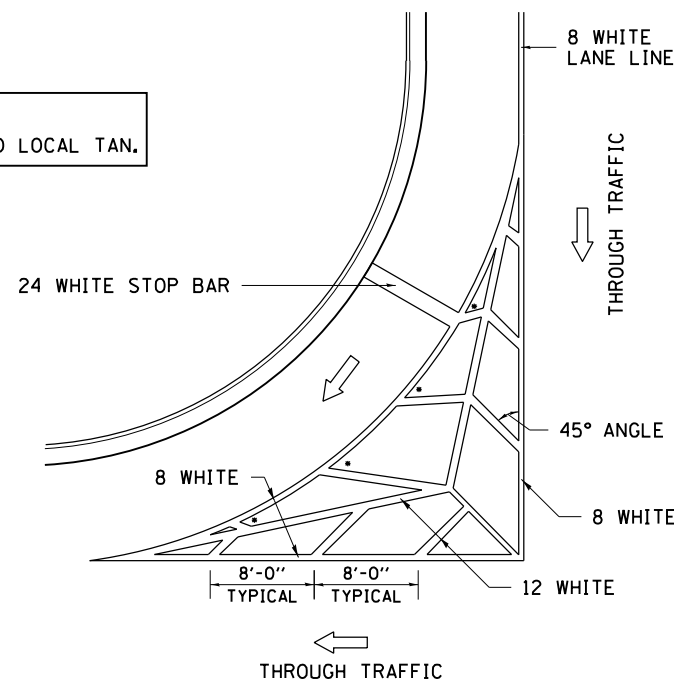

STANDARD CROSSWALK MARKING

See Schedules for Locations

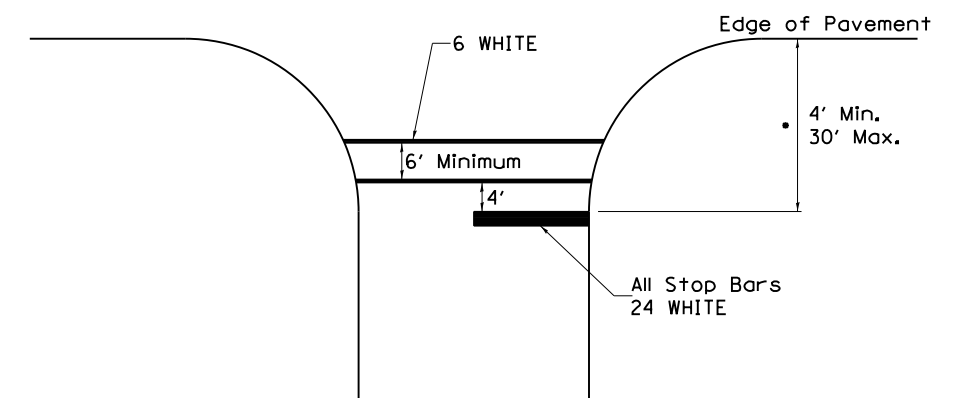

• Distance to the nearest edge of the intersecting roadway in the absence of a marked crosswalk.

FILE NAME =	USER NAME = dossed	DESIGNED -	REVISED - 6-27-14
D:\NBR\Draws\Winnebago\64K43 Repairs SN	101-0124\CADD\02-sht-cover.dgn	DRAWN -	REVISED - 3-05-12
	PLOT SCALE = 100.0000' / 1" =	CHECKED -	REVISED -
	PLOT DATE = Thu Nov 06 10:02:33 2014	DATE -	REVISED -

STATE OF ILLINOIS
DEPARTMENT OF TRANSPORTATION

REGION 2 / DISTRICT 2 STANDARD

SCALE: _____ SHEET NO. ___ OF ___ SHEETS STA. _____ TO STA. _____

F.A.P. RTE.	SECTION	COUNTY	TOTAL SHEETS	SHEET NO.
734	D2 DECK REPAIR 2015-3	WINNEBAGO	24	15
FED. ROAD DIST. NO. - ILLINOIS FED. AID PROJECT			CONTRACT NO. 64K43	

TYPICAL PAVEMENT MARKINGS

ARROW LAYOUT

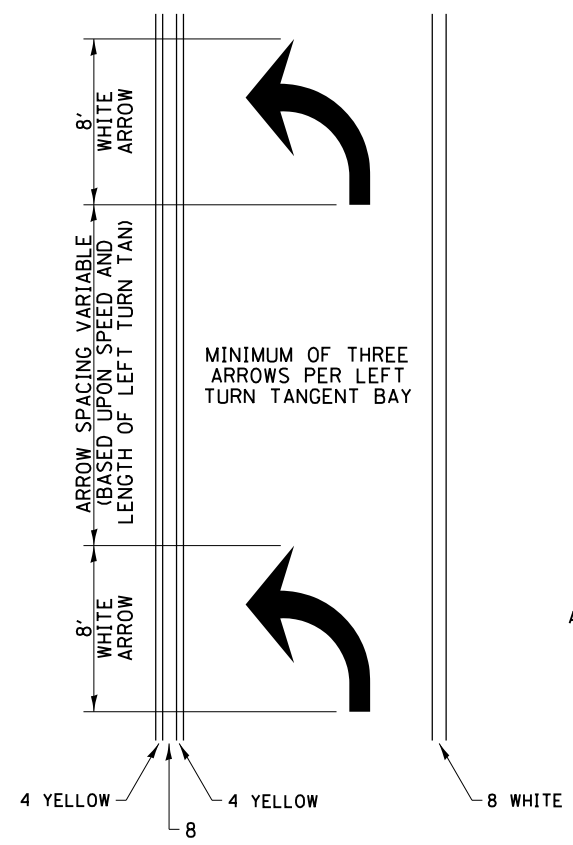

- ◀ ONE-WAY AMBER MARKER
- ◁ ONE-WAY CRYSTAL MARKER
- ◆ TWO-WAY AMBER MARKER

ALL DIMENSIONS ARE IN INCHES UNLESS OTHERWISE NOTED.

TYPICAL PAVEMENT MARKING FOR FLUSH MEDIAN

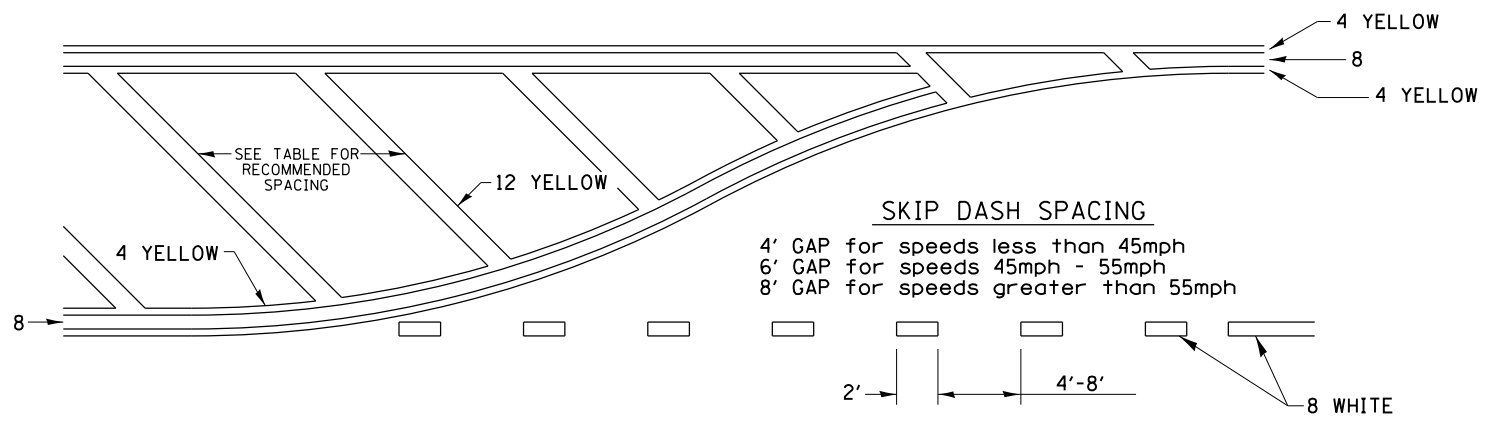

RECOMMENDED SPACING BETWEEN DIAGONALS (IN FEET)

Speed Limit Range	Continuous Median Area	Intersection Channelization	Objects (Islands)
less than 30MPH	50'	15'	10'
30-40MPH	75'	20'	15'
45MPH & over	75'	30'	20'

NOTE: if the spacing recommended in the Table does not permit at least five diagonal lines in the area being marked, the spacing from the next lowest speed range should be used. The recommended spacing is measured parallel to the pavement center line.

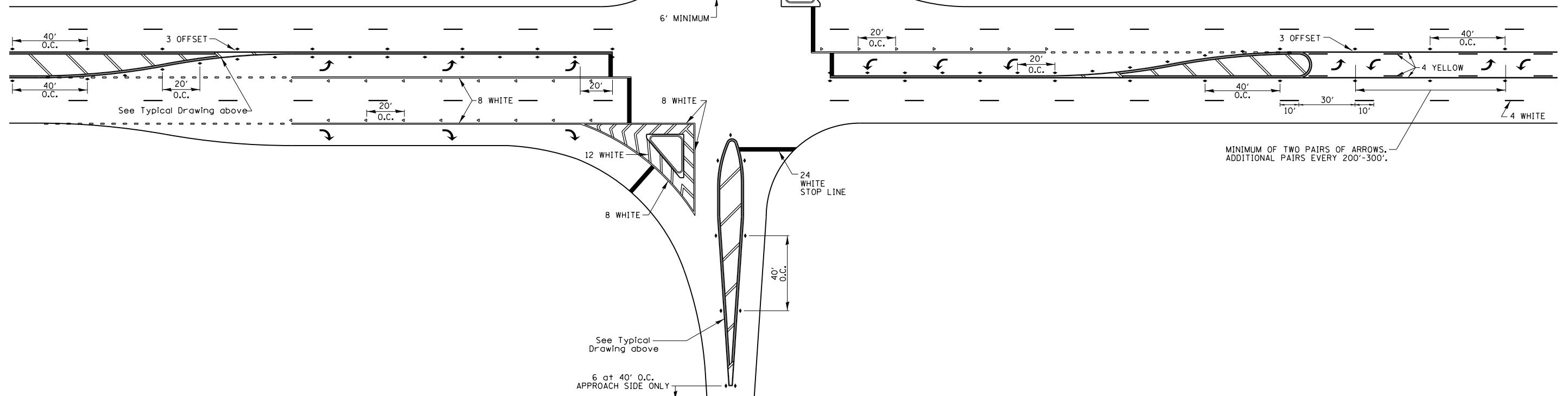

FILE NAME =	USER NAME = dosddd	DESIGNED -	REVISED - 6-27-14	STATE OF ILLINOIS DEPARTMENT OF TRANSPORTATION	REGION 2 / DISTRICT 2 STANDARD		F.A.P. RTE.	SECTION	COUNTY	TOTAL SHEETS	SHEET NO.
D:\BRD\Oss\Winnebago\64K43 Repairs SN	101-0124\CADD\02-sht-cover.dgn	DRAWN -	REVISED - 3-05-12				734	D2 DECK REPAIR 2015-3	WINNEBAGO	24	16
	PLOT SCALE = 100.0000' / 1"	CHECKED -	REVISED -				CONTRACT NO. 64K43				
	PLOT DATE = Thu Nov 06 10:02:39 2014	DATE -	REVISED -				FED. ROAD DIST. NO. - ILLINOIS FED. AID PROJECT				

TYPICAL PAVEMENT MARKINGS

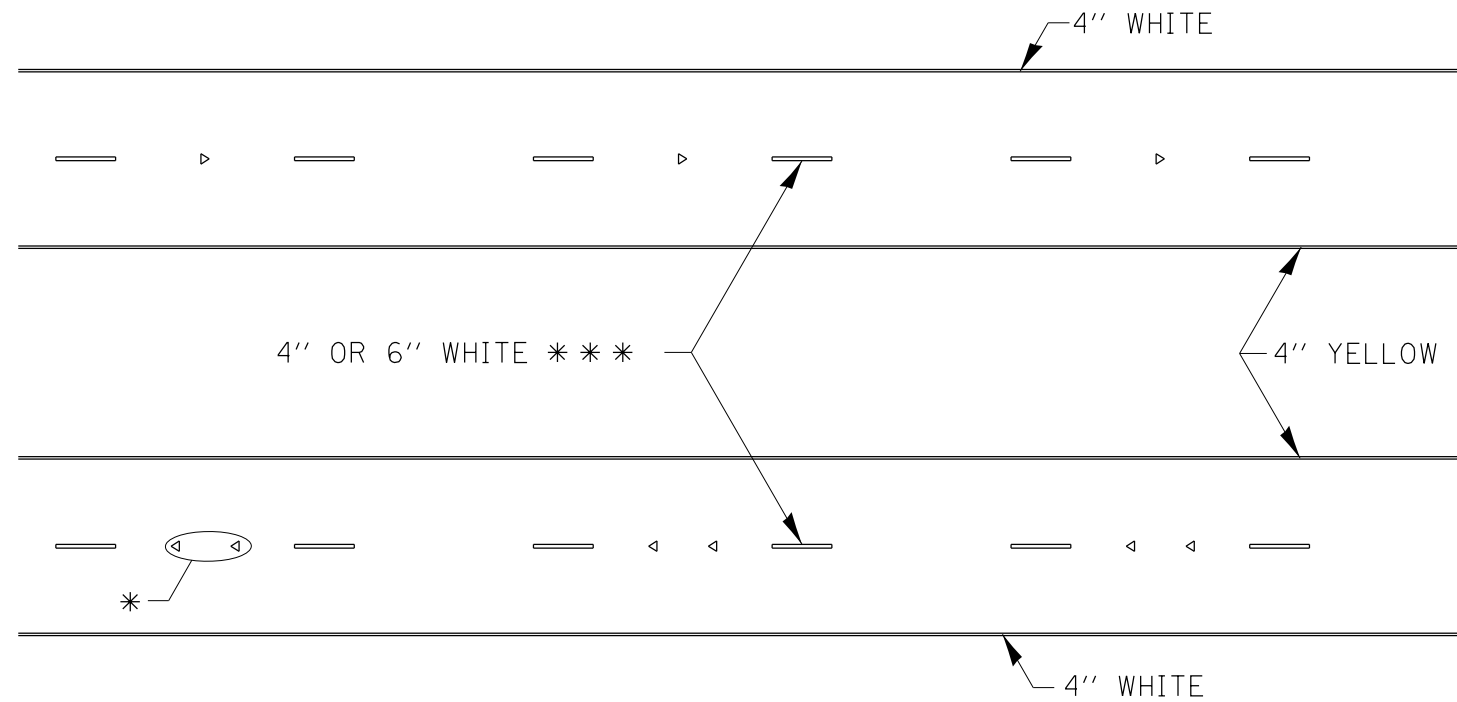

* SEE HIGHWAY STANDARD 781001 FOR SPACING DETAILS.
USE DOUBLE MARKERS WHEN ADT > 20,000.

MULTI-LANE / DIVIDED

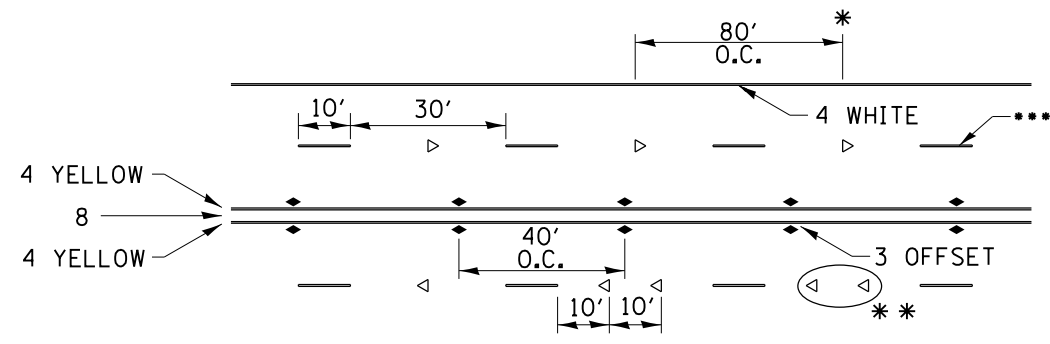

* REDUCE TO 40' O.C. ON CURVES WHERE ADVISORY SPEEDS ARE 10 MPH LOWER THAN POSTED SPEEDS.

** USE DOUBLE MARKERS WHEN ADT ≥ 20,000

*** CENTERLINE SKIP DASH PAVEMENT MARKING SPEED LIMIT LESS THAN 40 MPH USE 4" LINE. SPEED LIMIT 40 MPH AND OVER USE 6" LINE.

MULTI-LANE / UNDIVIDED & ONE WAY

(FOR MULTI-LANE UNDIVIDED HIGHWAYS USE THIS
DETAIL NOT HIGHWAY STANDARD 781001)

TYPICAL PARKING SPACING

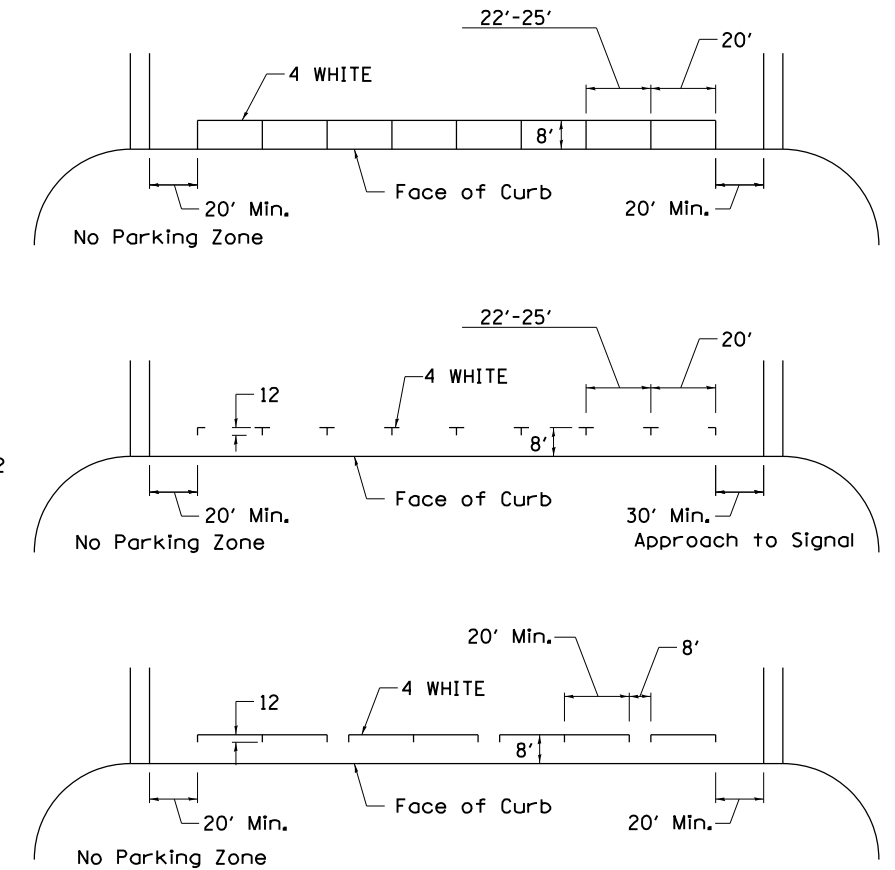

TYPICAL PAVEMENT MARKING FOR TWO LANE SECTION – NO PASSING ZONES

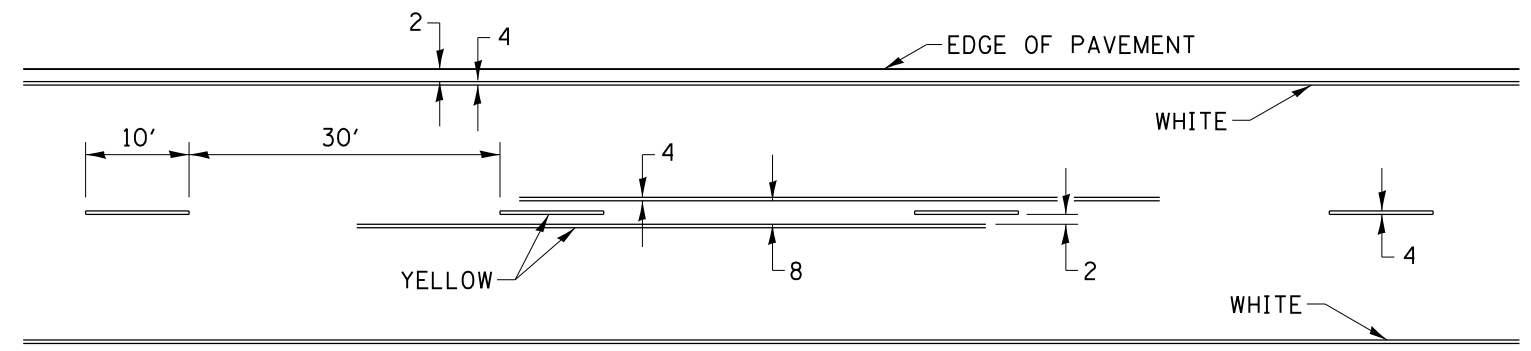

SYMBOLS

FILE NAME =	USER NAME = dosddd	DESIGNED -	REVISED - 6-27-14	STATE OF ILLINOIS DEPARTMENT OF TRANSPORTATION	REGION 2 / DISTRICT 2 STANDARD	F.A.P. RTE.	SECTION	COUNTY	TOTAL SHEETS	SHEET NO.	
D:\BR\Bos\Winnebago\64K43 Repairs SN	101-0124\CADD\02-shr-cover.dgn	DRAWN -	REVISED - 8-27-13			734	D2 DECK REPAIR 2015-3	WINNEBAGO	24	17	
	PLOT SCALE = 100.0000' / 1"	CHECKED -	REVISED - 11-28-12			SCALE: _____ SHEET NO. ___ OF ___ SHEETS STA. _____ TO STA. _____		CONTRACT NO. 64K43			
	PLOT DATE = Thu Nov 06 10:02:46 2014	DATE -	REVISED -			FED. ROAD DIST. NO. - [ILLINOIS] FED. AID PROJECT					

PAINING DETAILS

CENTERLINE SKIP DASH PAVEMENT MARKING WIDTH SHALL BE 4" WHEN THE POSTED SPEED LIMIT IS UNDER 40 MPH AND 6" WHEN THE POSTED SPEED LIMIT IS 40 MPH AND OVER.

EXIT RAMP

NOTE: GORE HATCHING PLACED ONLY WHEN SCHEDULED IN THE PLANS

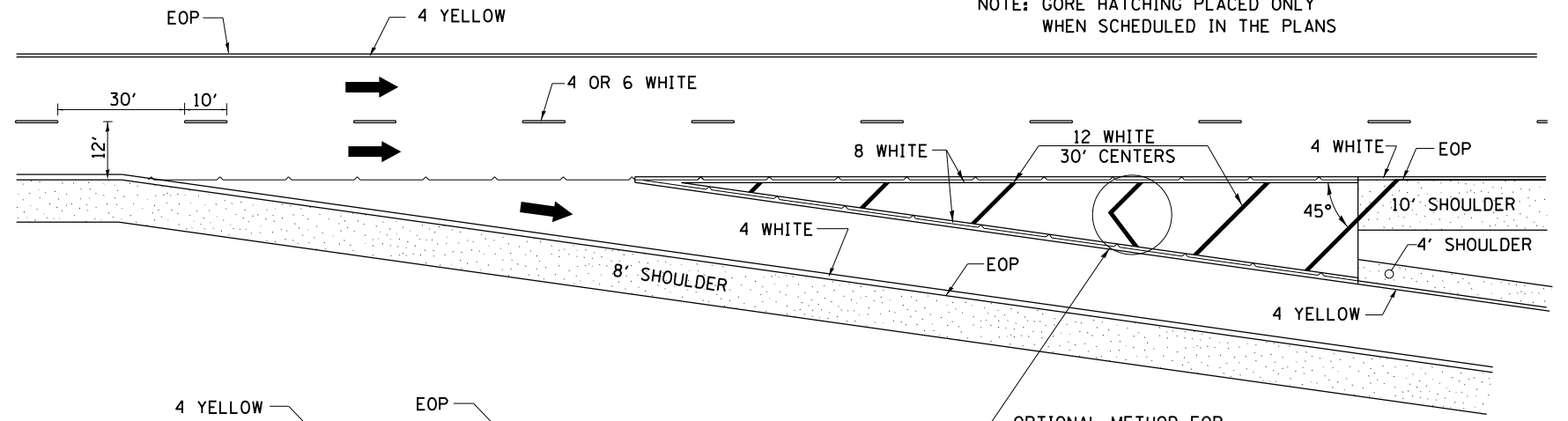

ENTRANCE RAMP

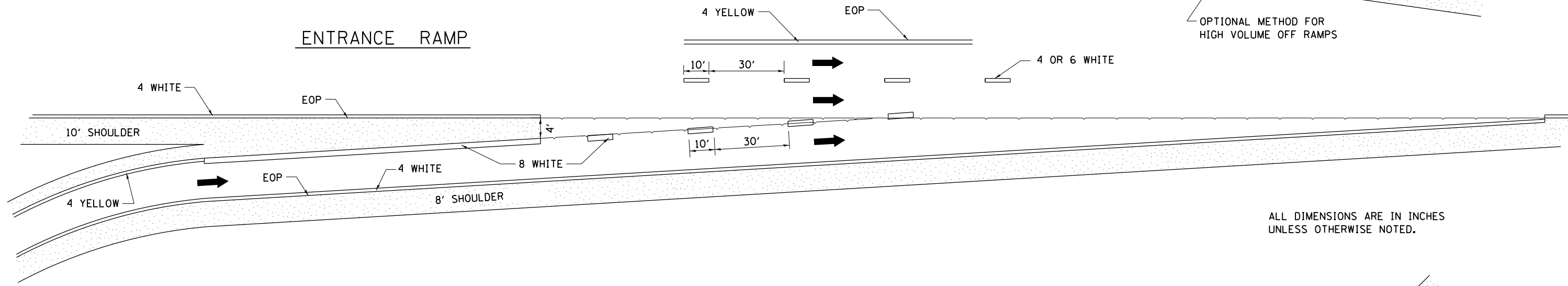

ALL DIMENSIONS ARE IN INCHES UNLESS OTHERWISE NOTED.

CLOVERLEAF

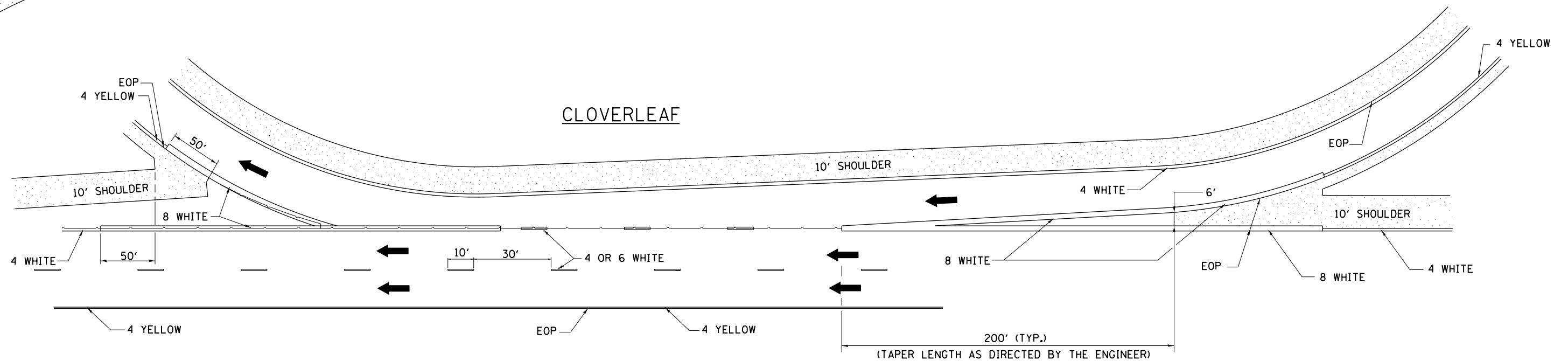

FILE NAME =	USER NAME = dosddd	DESIGNED -	REVISED - 8-27-13
D:\BR\Draws\Winnebago\64K43 Repairs SN	101-0124\CADD\02-sht-cover.dgn	DRAWN -	REVISED - 10-18-11
	PLOT SCALE = 100.0000' / 1"	CHECKED -	REVISED -
	PLOT DATE = Thu Nov 06 10:02:53 2014	DATE -	REVISED -

STATE OF ILLINOIS
DEPARTMENT OF TRANSPORTATION

REGION 2 / DISTRICT 2 STANDARD

SCALE: _____ SHEET NO. ___ OF ___ SHEETS STA. _____ TO STA. _____

F.A.P. RTE.	SECTION	COUNTY	TOTAL SHEETS	SHEET NO.
734	D2 DECK REPAIR 2015-3	WINNEBAGO	24	18
FED. ROAD DIST. NO. - ILLINOIS FED. AID PROJECT			CONTRACT NO. 64K43	

GENERAL NOTES

All structural steel shall conform to AASHTO Classification M-270 Gr. 36, unless otherwise noted. Reinforcement bars designated (E) shall be epoxy coated.

Plan dimensions and details relative to existing plans are subject to nominal construction variations. The Contractor shall field verify existing dimensions and details affecting new construction and make necessary approved adjustments prior to construction or ordering of materials. Such variations shall not be cause for additional compensation for a change in scope of the work, however, the Contractor will be paid for the quantity actually furnished at the unit price bid for the work.

Existing reinforcement bars extending into the removal area shall be cleaned, straightened and incorporated into the new construction. Any reinforcement bars that are damaged during concrete removal shall be replaced with an approved bar splicer or anchorage system. Cost included with Concrete Removal.

Joint openings shall be adjusted according to Article 520.04 of the Standard Specifications when the deck is poured at an ambient temperature other than 50° F.

The deck surface shall have its final finish tined at joint locations according to Article 420.09(e)(1) of the Standard Specifications. Cost included with Concrete Superstructure.

The existing structural steel coating contains lead. The Contractor shall take appropriate precautions to deal with the presence of lead on this project.

Prior to pouring the new concrete deck, all heavy or loose rust, loose mill scale, and other loose or potentially detrimental foreign material shall be removed from the surfaces in contact with concrete. Tightly adhered paint may remain unless otherwise noted. Removal shall be accomplished by methods that will not damage the steel and the cost will be included in the pay item covering removal of the existing concrete.

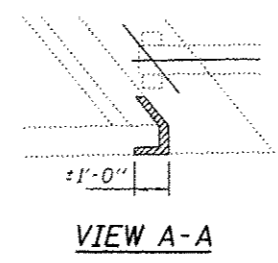
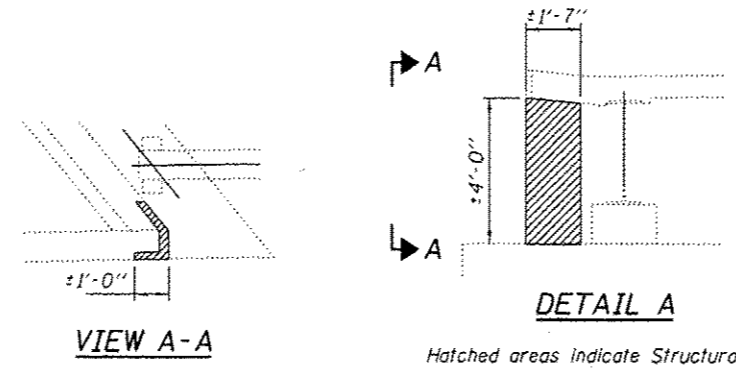
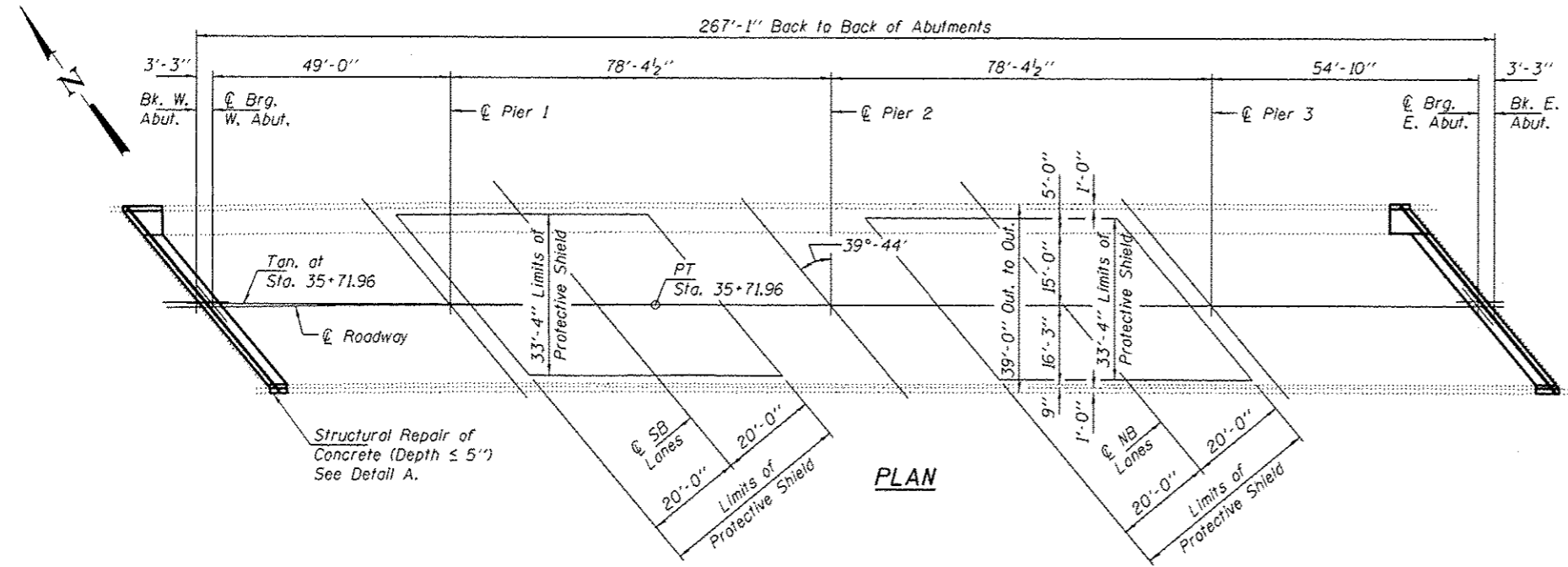
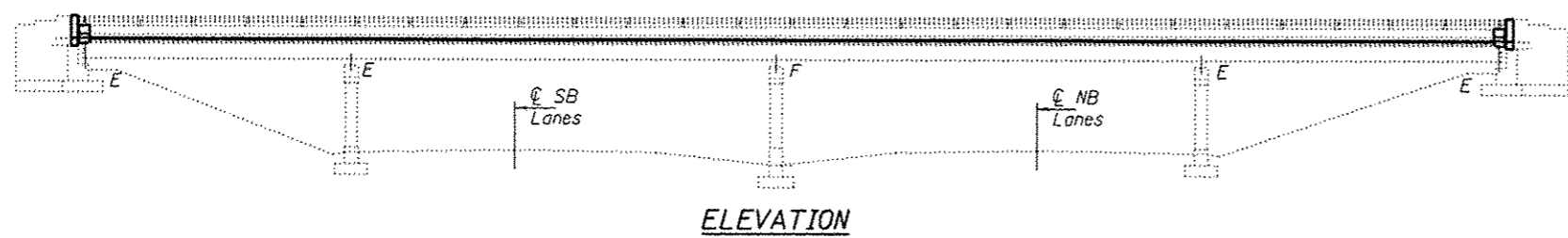

TOTAL BILL OF MATERIAL

ITEM	UNIT	QUANTITY
Concrete Removal	Cu. Yd.	16.2
Concrete Superstructure	Cu. Yd.	16.2
Preformed Joint Strip Seal	Foot	102
Reinforcement Bars, Epoxy Coated	Pound	2340
Bar Splicers	Each	24
Bridge Deck Scarification, 2 1/2"	Sq. Yd.	895
Bridge Deck Latex Concrete Overlay, 2 1/2"	Sq. Yd.	895
* Deck Slab Repair (Full Depth, Type I)	Sq. Yd.	50
* Deck Slab Repair (Full Depth, Type II)	Sq. Yd.	10
Structural Repair of Concrete (Depth ≤ 5")	Sq. Ft.	10.3
Protective Shield	Sq. Yd.	390
Bridge Deck Grooving	Sq. Yd.	837

* Quantities are estimates. Actual location, size and quantity to be determined in the field, by the Engineer.

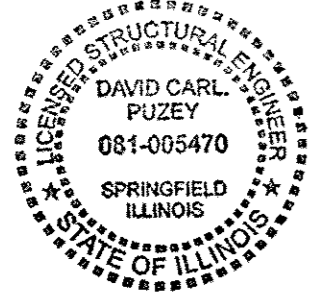

DESIGNED: <i>[Signature]</i>	EXAMINED: <i>[Signature]</i>	DATE: DECEMBER 2, 2014	STATE OF ILLINOIS DEPARTMENT OF TRANSPORTATION	PLAN AND ELEVATION FAU 9680 (HONONEGAH RD OVER FAP 734 (IL 2)) SN 101-0124	F.A.P. RTE. 134	SECTION 02 DECK REPAIR 2015-3	COUNTY WINHABAGO	TOTAL SHEETS 24	SHEET NO. 19
CHECKED: <i>[Signature]</i>	PASSED: <i>[Signature]</i>	REVISED:	SHEET NO. 1 OF 6 SHEETS		CONTRACT NO. 64K43		(ILLINOIS) FED. AID PROJECT		

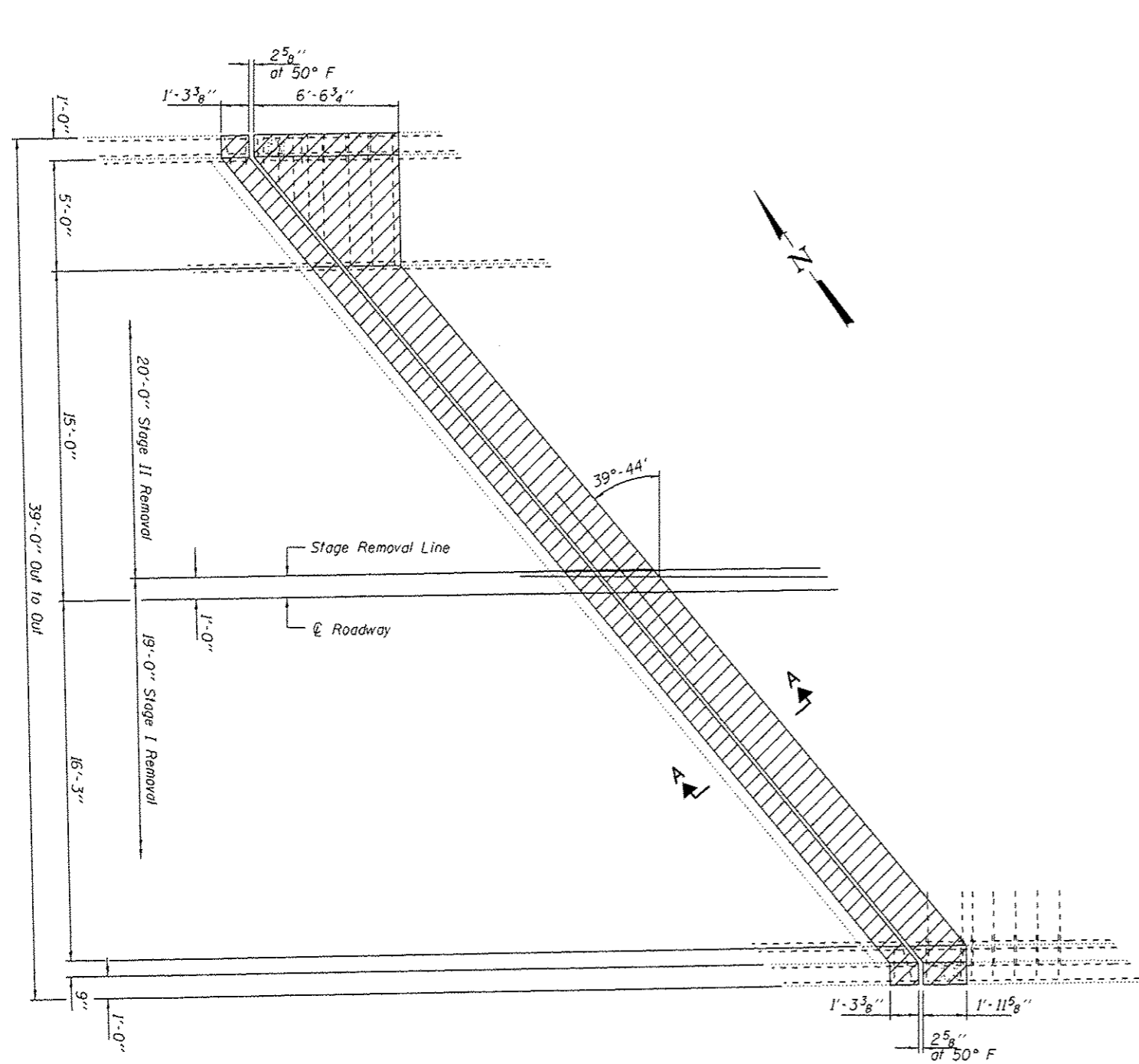

CONCRETE REMOVAL PLAN

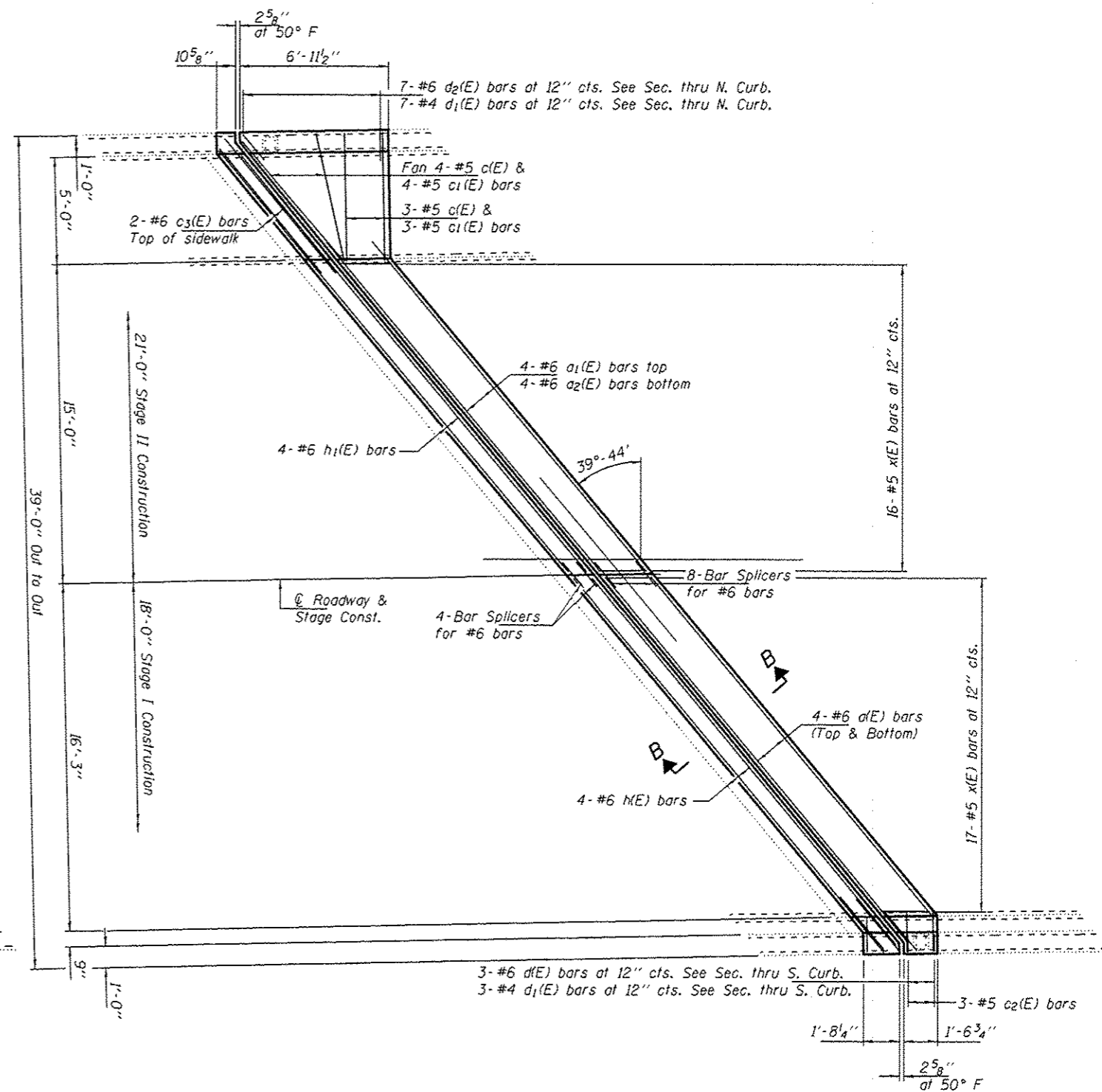

CONCRETE REPLACEMENT PLAN

All transverse dimensions are measured perpendicular to $\text{\textcircled{C}}$ Roadway.
For Sections A-A, B-B, bar details and Bill of Material, see sheet 4 of 6.

DESIGNED <i>TLC</i>	EXAMINED <i>Timothy A. ...</i>	DATE <u>DECEMBER 2, 2014</u>	STATE OF ILLINOIS DEPARTMENT OF TRANSPORTATION		REPAIR DETAILS AT WEST ABUTMENT SN 101-0124		F.A.P. RTE.	SECTION	COUNTY	TOTAL SHEETS	SHEET NO.
CHECKED <i>CCC</i>	PASSED <i>Carl ...</i>	REVISED					134	02 DECK REPAIR 2015-3	WINNEBAGO	24	20
DRAWN <i>baliva</i>	ACTING ENGINEER OF BRIDGES AND STRUCTURES	REVISED	SHEET NO. 2 OF 6 SHEETS		ILLINOIS FED. AID PROJECT		CONTRACT NO. 64K4J				
CHECKED <i>TLC</i>	ACTING ENGINEER OF BRIDGES AND STRUCTURES	REVISED									

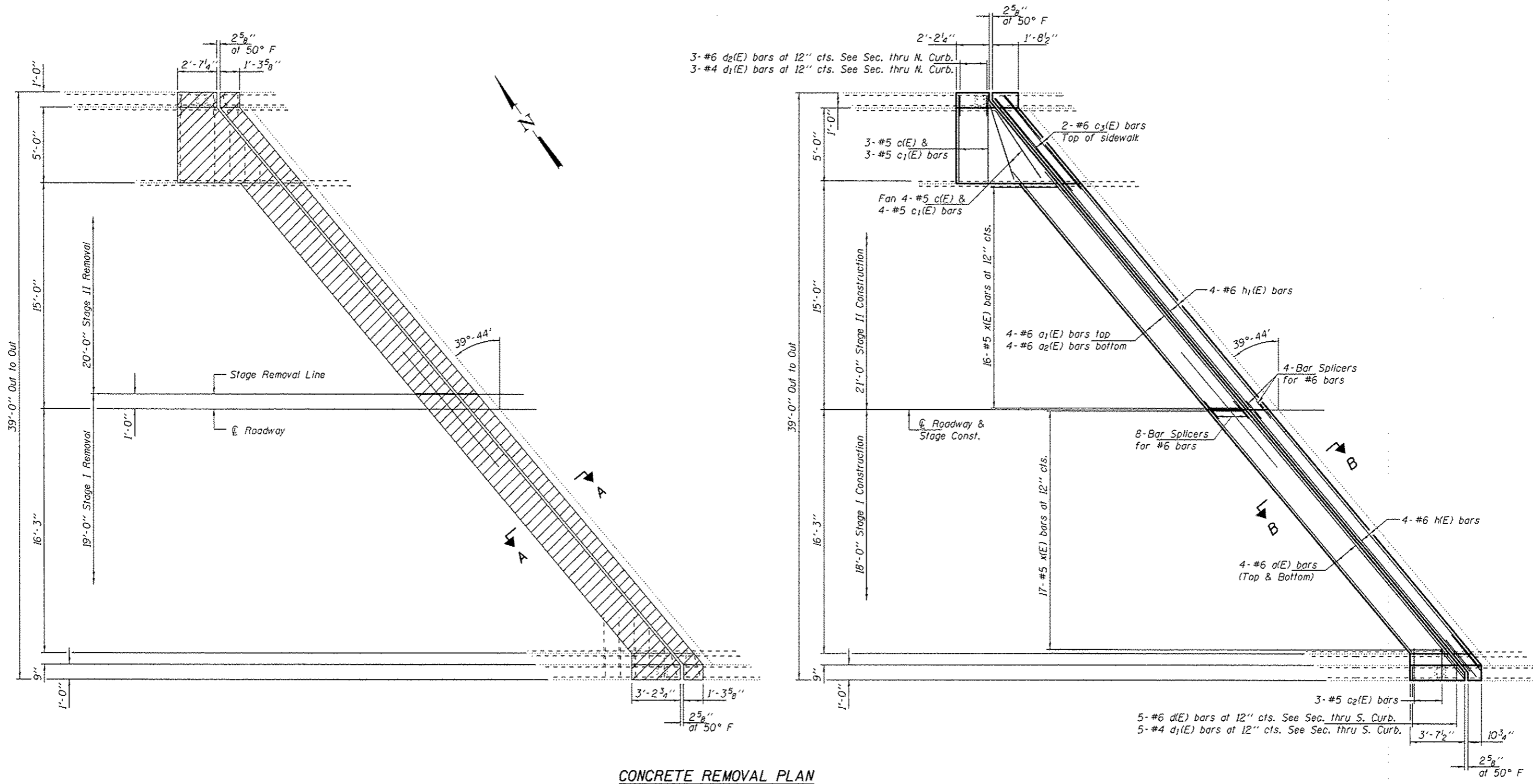

CONCRETE REMOVAL PLAN

For Sections A-A, B-B, bar details and Bill of Material, see sheet 4 of 6.

DESIGNED <i>TLC</i>	EXAMINED <i>Timothy A. ...</i>	DATE <i>DECEMBER 2, 2014</i>	STATE OF ILLINOIS DEPARTMENT OF TRANSPORTATION	REPAIR DETAILS AT EAST ABUTMENT SN 101-0124		F.A.P. RTE.	SECTION	COUNTY	TOTAL SHEETS	SHEET NO.
CHECKED <i>CCC</i>	PASSED <i>Carl ...</i>	REVISED				134	D2 DECK REPAIR 2015-3	WINNABAGO	24	21
DRAWN <i>ballva</i>	REVISED	REVISED				CONTRACT NO. 64K43		ILLINOIS FED. AID PROJECT		
CHECKED <i>TLC</i>	ACTING ENGINEER OF BRIDGES AND STRUCTURES		SHEET NO. 3 OF 6 SHEETS							

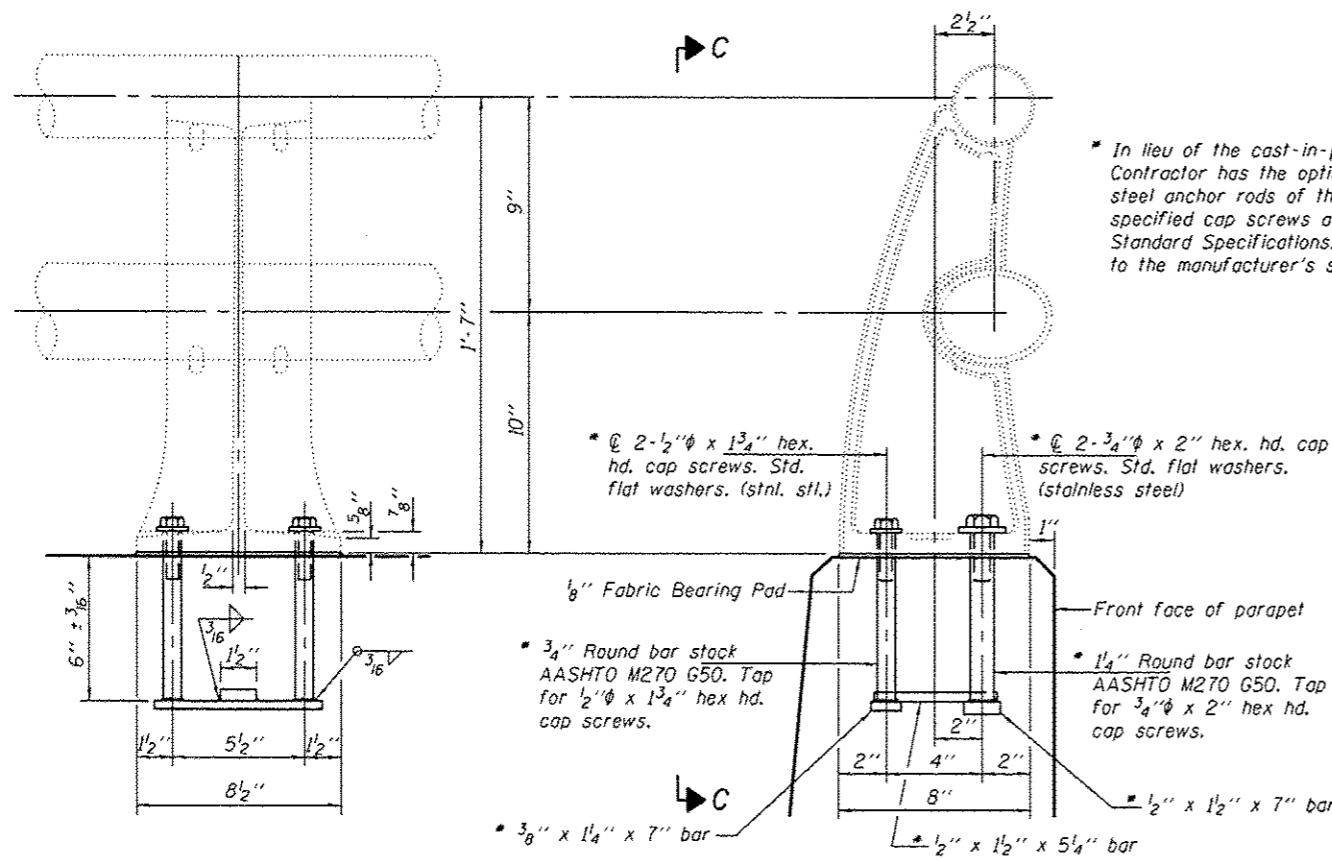

VIEW C-C

RAIL POST DETAILS

SECTION THRU RAIL POST

Approach wearing surface to be removed and replaced by others. For pay items and quantities, see Roadway Plans.

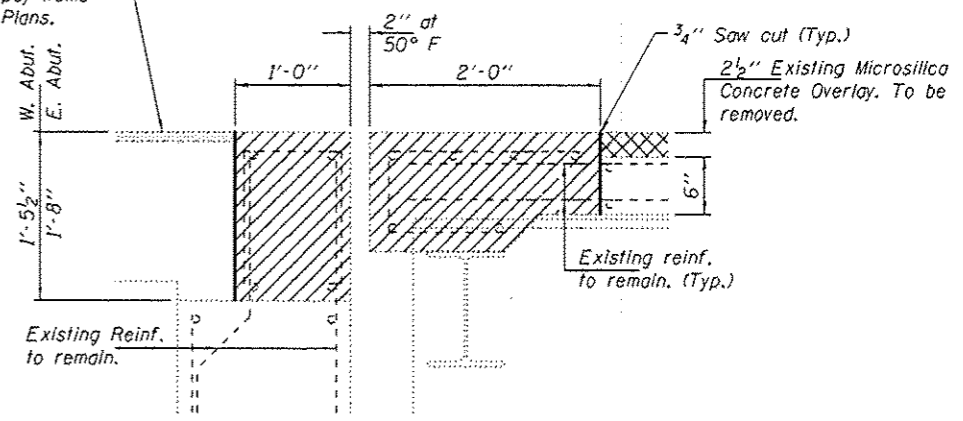

SECTION A-A

(Near Centerline Roadway)
(Dims at RT L's to end of deck)
Hatched areas indicate Concrete Removal
Cross hatched area indicates Bridge Deck Scarification.

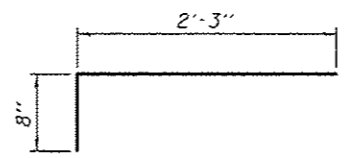

BAR x(E)

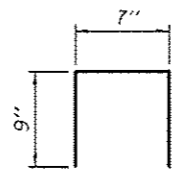

BAR u(E)

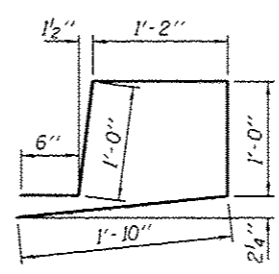

BAR c2(E)

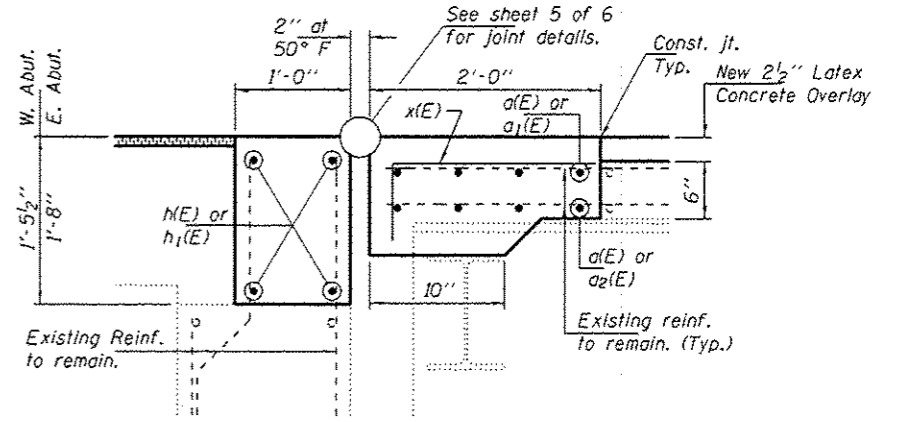

SECTION B-B

(Near Centerline Roadway)
(Dims at RT L's to end of deck)

BILL OF MATERIAL
(2 ABUTMENTS)

Bar	No.	Size	Length	Shape
a(E)	16	#6	22'-0"	—
a1(E)	8	#6	20'-6"	—
a2(E)	8	#6	26'-9"	—
c(E)	14	#5	8'-2"	—
c1(E)	14	#5	6'-4"	—
c2(E)	6	#5	5'-6"	—
c3(E)	4	#5	7'-0"	—
d(E)	8	#6	5'-9"	—
d1(E)	18	#4	2'-6"	—
d2(E)	10	#6	3'-4"	—
h(E)	8	#6	22'-11"	—
h1(E)	8	#6	26'-10"	—
u(E)	8	#5	2'-1"	□
x(E)	66	#5	2'-11"	—
Concrete Removal			Cu. Yd.	16.2
Concrete Superstructure			Cu. Yd.	16.2
Reinforcement Bars, Epoxy Coated			Lbs.	2340

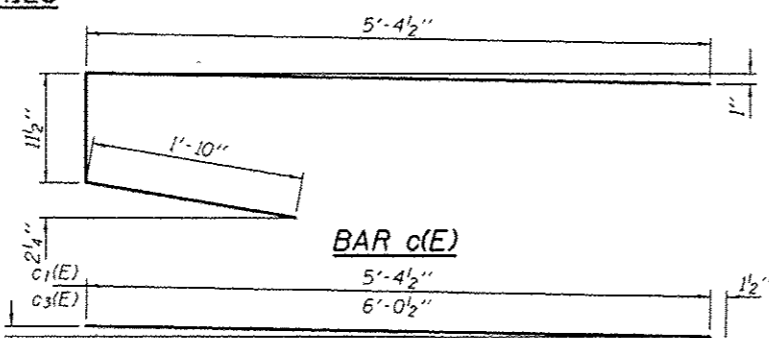

BARS c1(E) & c3(E)

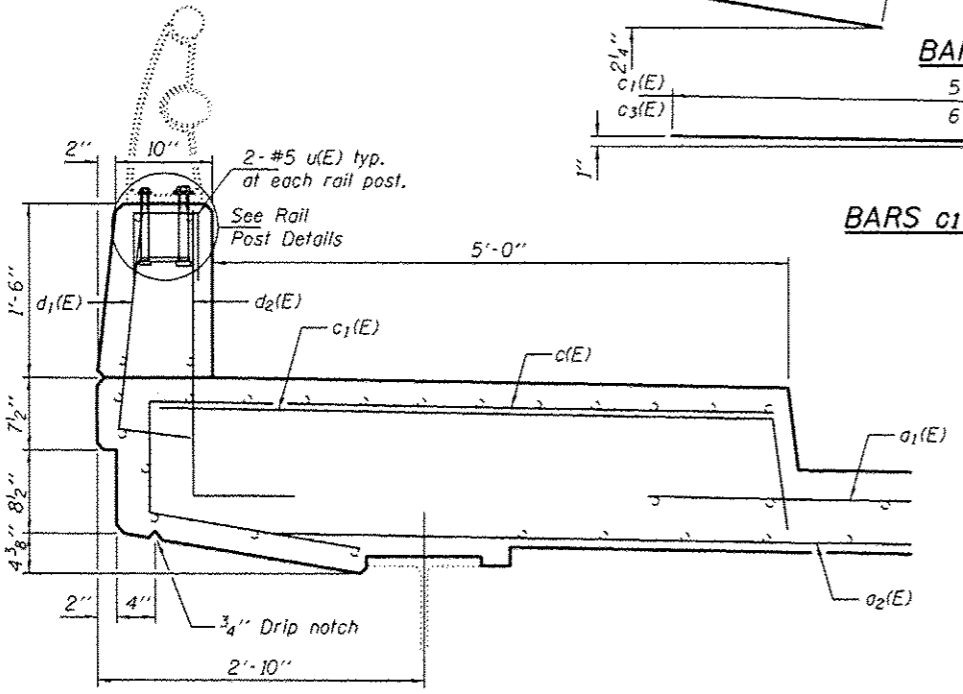

SECTION THRU NORTH CURB
(Looking East)

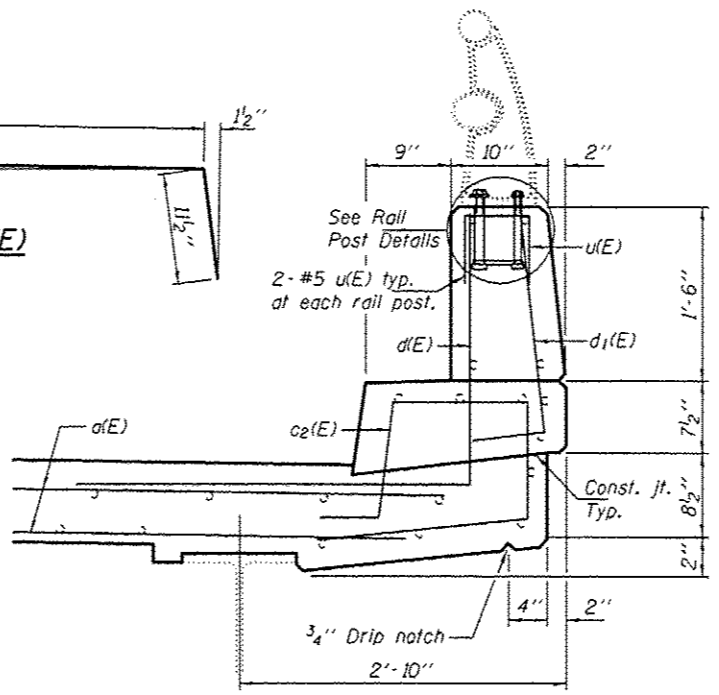

SECTION THRU SOUTH CURB
(Looking East)

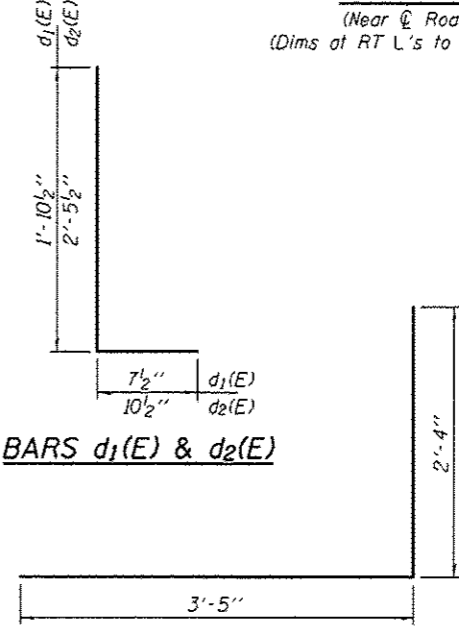

BAR d(E)

DESIGNED TLC
CHECKED CCC
DRAWN baliva
CHECKED TLC

EXAMINED
PASSED
Timothy A. Anzures
ACTING ENGINEER OF STRUCTURAL SERVICES
Carly H. Hays
ACTING ENGINEER OF BRIDGES AND STRUCTURES
DATE: DECEMBER 2, 2014
REVISED
REVISED

STATE OF ILLINOIS
DEPARTMENT OF TRANSPORTATION

REPAIR DETAILS
SN 101-0124
SHEET NO. 4 OF 6 SHEETS

F.A.P. R.T.E. SECTION COUNTY TOTAL SHEETS SHEET NO.
134 02 DECK REPAIR 2015-3 WINABAGO 24 22
CONTRACT NO. 64K43
ILLINOIS FED. AID PROJECT

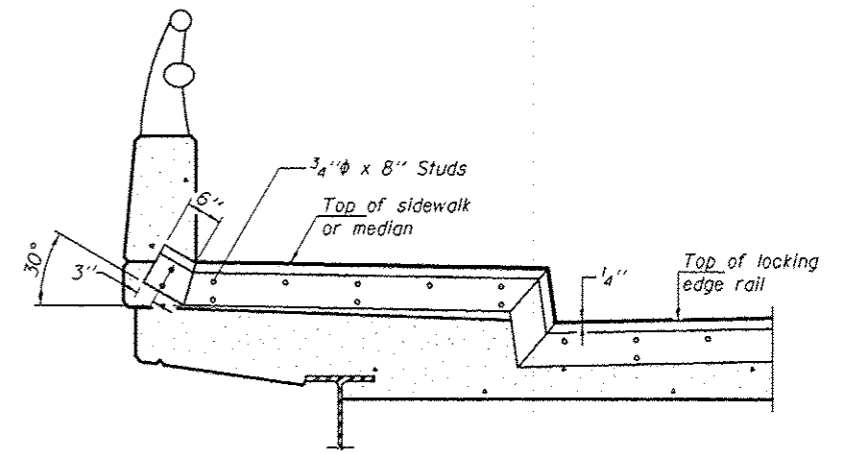
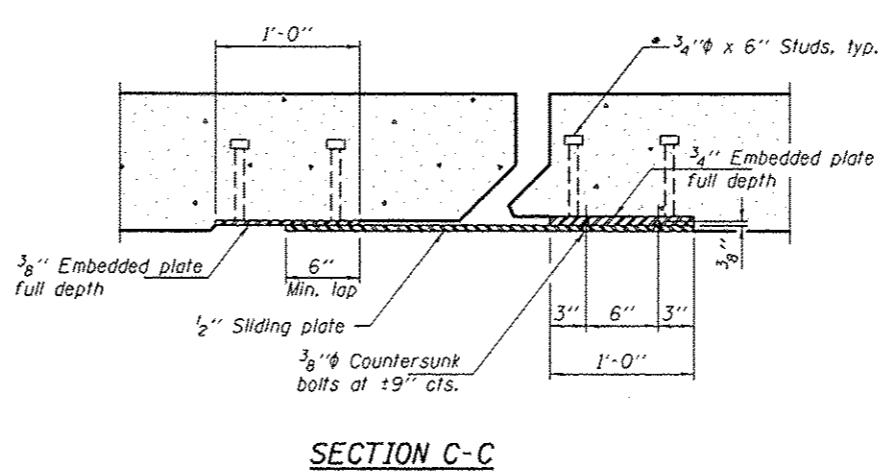
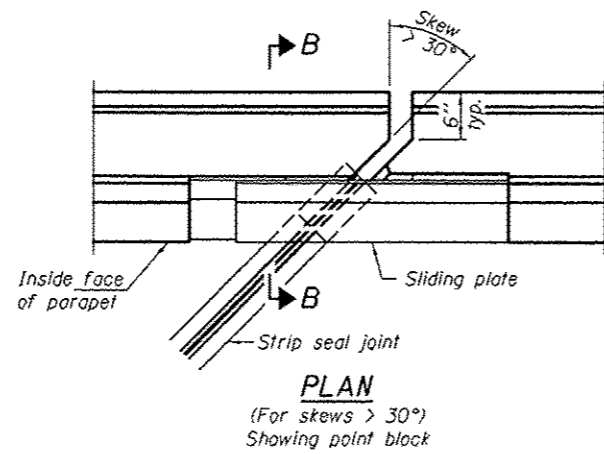
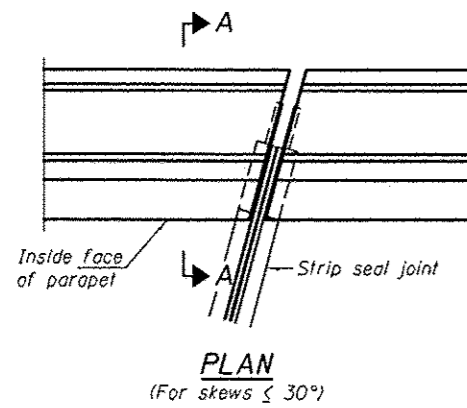

TYPICAL END TREATMENT AT SIDEWALK OR MEDIAN
 Shorter plates with a single row of studs at 12" cts. may be necessary on medians which are shallower than 9". See manufacturer's recommendation.

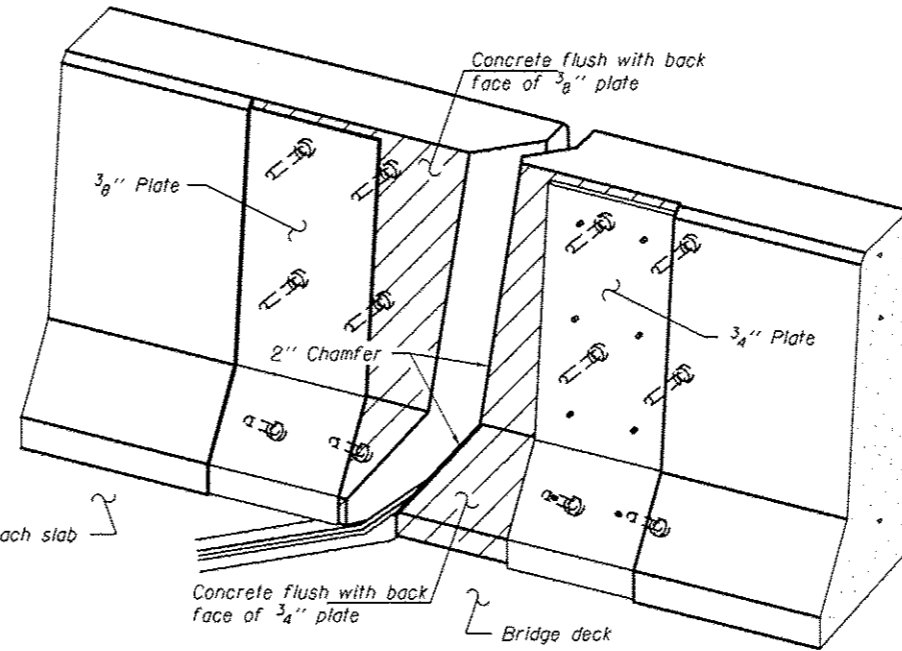
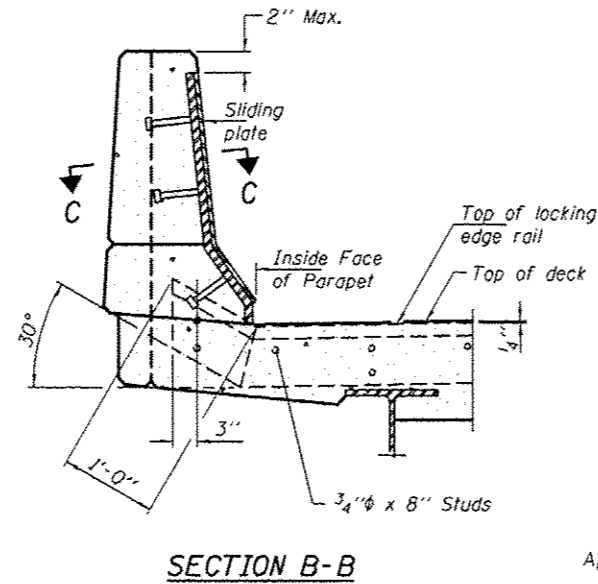
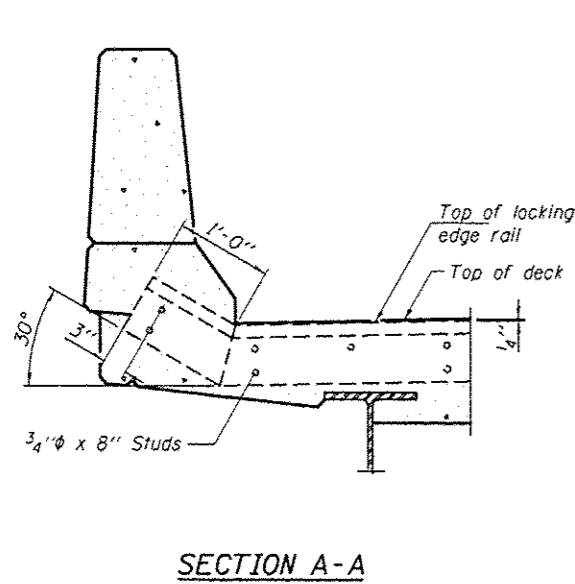

Notes:
 The strip seal shall be made continuous and shall have a minimum thickness of 1/4". The configuration of the strip seal shall match the configuration of the Locking Edge Rails. Open or "webbed" strip seal gland configurations are not permitted. The gland shall be sized for a maximum rated movement of 4 inches.
 The Locking Edge Rails depicted are conceptual only, except for the minimum dimensions shown. The actual configuration of the Locking Edge Rails and matching strip seal may vary from manufacturer to manufacturer. Flanged edge rails will not be allowed. Locking Edge Rails may be spliced at slope discontinuities.
 The manufacturer's recommended installation methods shall be followed.

The joint opening and deck dimensions detailed on the superstructure are based on a rolled rail expansion joint. If the Contractor elects to use the welded rail expansion joint, the opening and deck dimensions shall be modified according to the dimensions detailed on this sheet. Required modifications shall be made at no additional cost to the State.
 All steel components shall be galvanized after fabrication according to Article 520.03 of the Standard Specifications. Maximum space between rail segments shall be 3/16", sealed with a suitable sealant. Joints in rails within 10 ft. of curbs shall be welded.
 Parapet plates and anchorage studs for skews > 30° included in the cost of Preformed Joint Strip Seal.

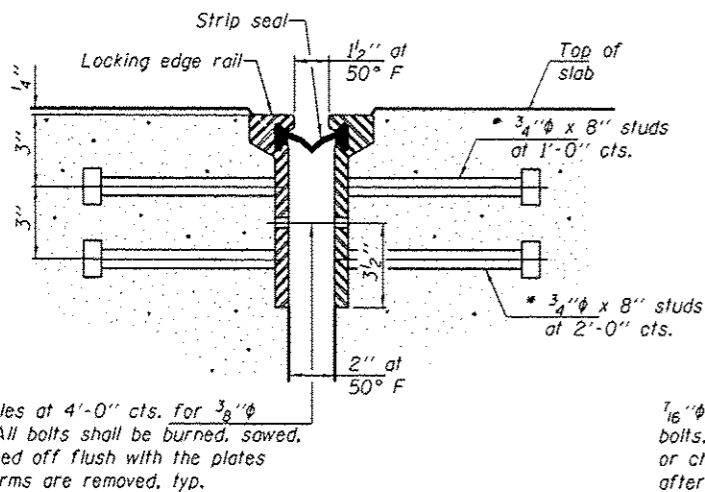

7/16" holes at 4'-0" cts. for 3/8" bolts. All bolts shall be burned, sawed, or chipped off flush with the plates after forms are removed, typ.

SECTION THRU ROLLED RAIL JOINT

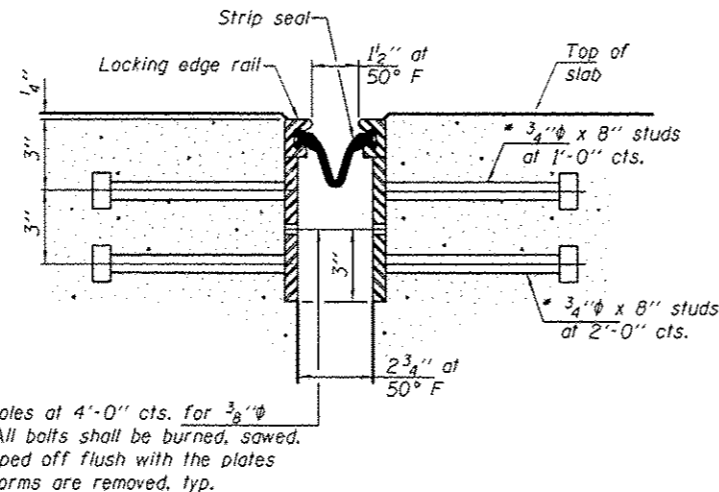

7/16" holes at 4'-0" cts. for 3/8" bolts. All bolts shall be burned, sawed, or chipped off flush with the plates after forms are removed, typ.

SECTION THRU WELDED RAIL JOINT

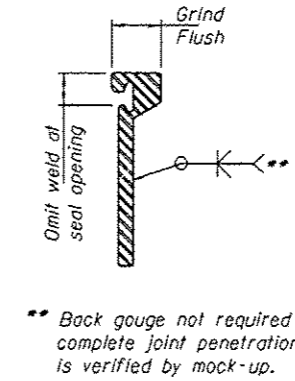
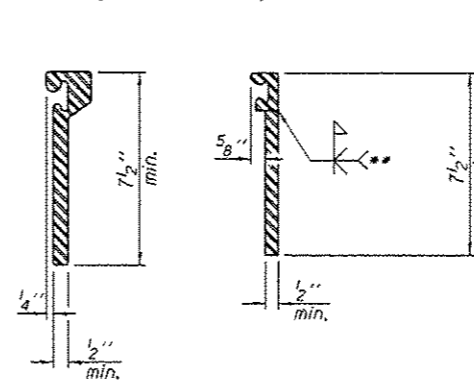

** Back gouge not required if complete joint penetration is verified by mock-up.

ROLLED EXTRUDED RAIL WELDED RAIL

LOCKING EDGE RAIL SPLICE

The inside of the locking edge rail groove shall be free of weld residue. Rolled rail shown, welded rail similar.

LOCKING EDGE RAILS

BILL OF MATERIAL

Item	Unit	Total
Preformed Joint Strip Seal	Foot	102

EJ-SSJ

1-27-12

DESIGNED TLC
 CHECKED CCC
 DRAWN baliva
 CHECKED TLC

EXAMINED
 PASSED
 ACTING ENGINEER OF STRUCTURAL SERVICES
 ACTING ENGINEER OF BRIDGES AND STRUCTURES

DATE DECEMBER 2, 2014
 REVISED
 REVISED

STATE OF ILLINOIS
 DEPARTMENT OF TRANSPORTATION

PREFORMED JOINT STRIP SEAL
 SN 101-0124

SHEET NO. 5 OF 6 SHEETS

F.A.P. RTE.	SECTION	COUNTY	TOTAL SHEETS	SHEET NO.
134	02 DECK REPAIR 2015-3	WINNEBAGO	24	23

CONTRACT NO. 64K43
 ILLINOIS FED. AID PROJECT

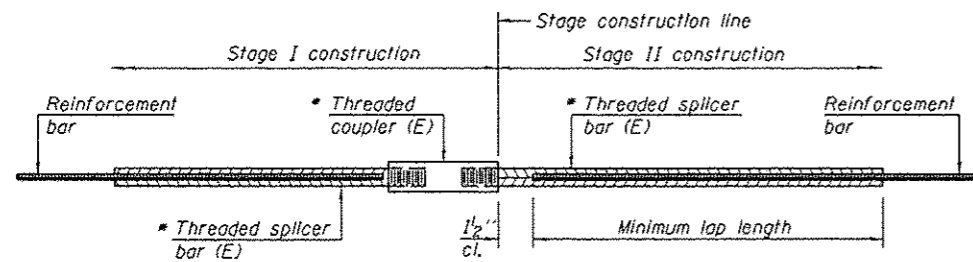

STANDARD BAR SPLICER ASSEMBLY

Minimum Lap Lengths						
Bar size to be spliced	Table 1	Table 2	Table 3	Table 4	Table 5	Table 6
3, 4	1'-5"	1'-11"	2'-1"	2'-4"	2'-7"	2'-11"
5	1'-9"	2'-5"	2'-7"	2'-11"	3'-3"	3'-8"
6	2'-1"	2'-11"	3'-1"	3'-6"	3'-10"	4'-5"
7	2'-9"	3'-10"	4'-2"	4'-8"	5'-2"	5'-10"
8	3'-8"	5'-1"	5'-5"	6'-2"	6'-9"	7'-8"
9	4'-7"	6'-5"	6'-10"	7'-9"	8'-7"	9'-8"

- Table 1: Black bar, 0.8 Class C
- Table 2: Black bar, Top bar lap, 0.8 Class C
- Table 3: Epoxy bar, 0.8 Class C
- Table 4: Epoxy bar, Top bar lap, 0.8 Class C
- Table 5: Epoxy bar, Class C
- Table 6: Epoxy bar, Top bar top, Class C

Threaded splicer bar length = min. lap length + 1/2" + thread length

* Epoxy not required on Bar Splicer Assembly components used in conjunction with black bars.

Location	Bar size	No. assemblies required	Table for minimum lap length
W. Abut.	#6	12	3
E. Abut.	#6	12	3

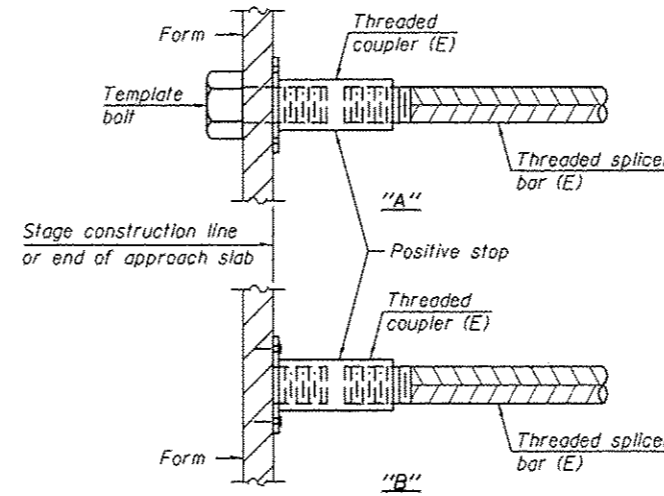

INSTALLATION AND SETTING METHODS

"A" : Set bar splicer assembly by means of a template bolt.
 "B" : Set bar splicer assembly by nailing to wood forms or cementing to steel forms.
 (E) : Indicates epoxy coating.

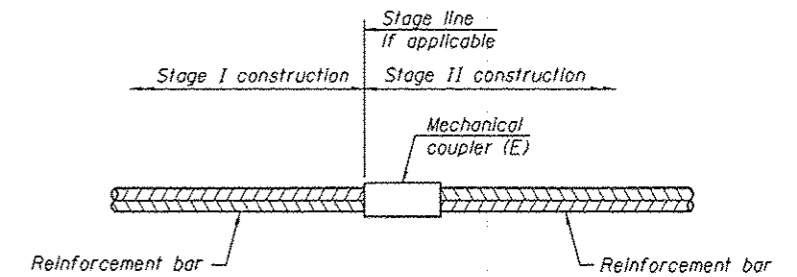

STANDARD MECHANICAL SPLICER

Location	Bar size	No. assemblies required

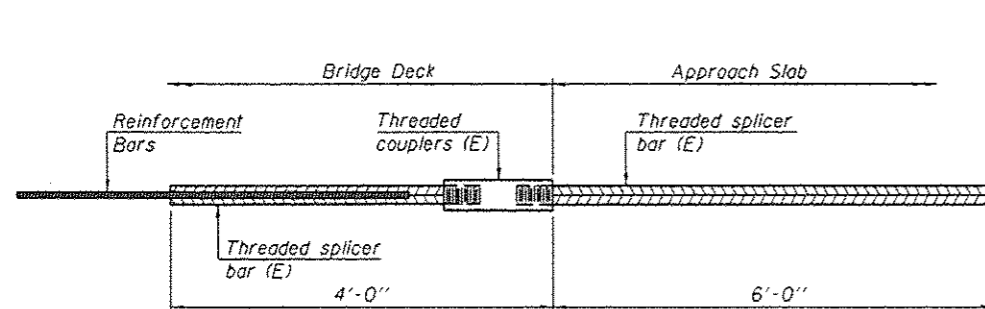

BAR SPLICER ASSEMBLY FOR #5 BAR ON INTEGRAL OR SEMI-INTEGRAL ABUTMENTS

No. required =

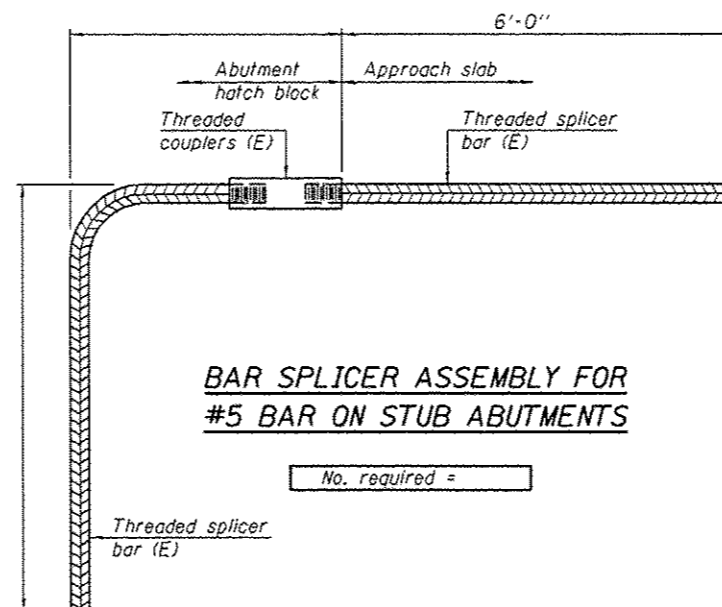

BAR SPLICER ASSEMBLY FOR #5 BAR ON STUB ABUTMENTS

No. required =

NOTES

Splicer bars shall be deformed with threaded ends and have a minimum 60 ksi yield strength.
 All reinforcement shall be lapped and tied to the splicer bars.
 Bar splicer assemblies shall be epoxy coated according to the requirements for reinforcement bars. See Section 508 of the Standard Specifications.
 See approved list of bar splicer assemblies and mechanical splicers for alternatives.

BSD-1 1-27-12