

STATE OF ILLINOIS
DEPARTMENT OF TRANSPORTATION
DIVISION OF HIGHWAYS

**PROPOSED
HIGHWAY PLANS**

VARIOUS ROUTES
SECTION D9 SAFETY 2014-2
PROJECT ACHSIP-0008(994)
CURVE SAFETY IMPROVEMENTS
VARIOUS COUNTIES

C-99-020-14

F.A. RTE.	SECTION	COUNTY	TOTAL SHEETS	SHEET NO.
*	D9 SAFETY 2014-2	**	17	1
ILLINOIS CONTRACT NO. 78396				

• VARIOUS ROUTES
•• VARIOUS COUNTIES

D-99-016-14

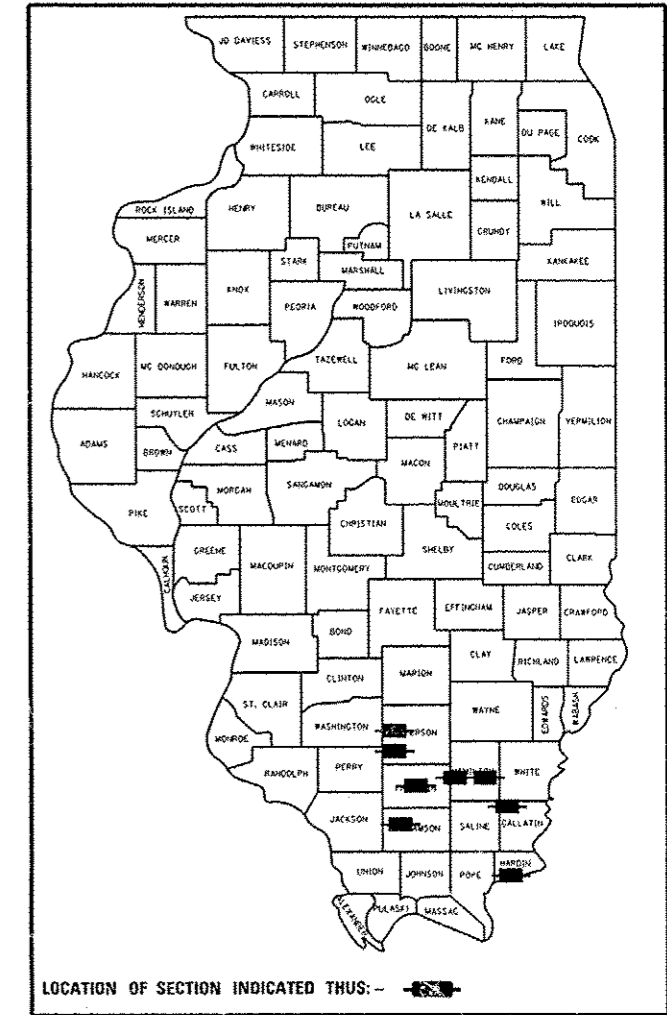

FOR INDEX OF SHEETS, SEE SHEET NO. 3

TOWNSHIPS & PRECINCTS:
Precincts - Crab Orchard, East Rosiclare
Townships - Shiloh, Benton, McClellan,
Knight Prairie, McLeansboro, Omaha.

FOR EQUATION STATIONS, SEE
LOCATION MAPS, SHEETS 11 - 13.

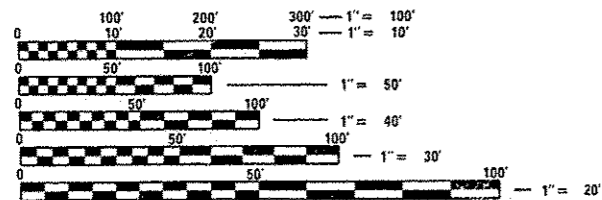

FULL SIZE PLANS HAVE BEEN PREPARED USING STANDARD
ENGINEERING SCALES. REDUCED SIZED PLANS WILL NOT
CONFORM TO STANDARD SCALES. IN MAKING MEASUREMENTS
ON REDUCED PLANS, THE ABOVE SCALES MAY BE USED.

J.U.L.I.E.
JOINT UTILITY LOCATION INFORMATION FOR EXCAVATION
1-800-892-0123
OR 811

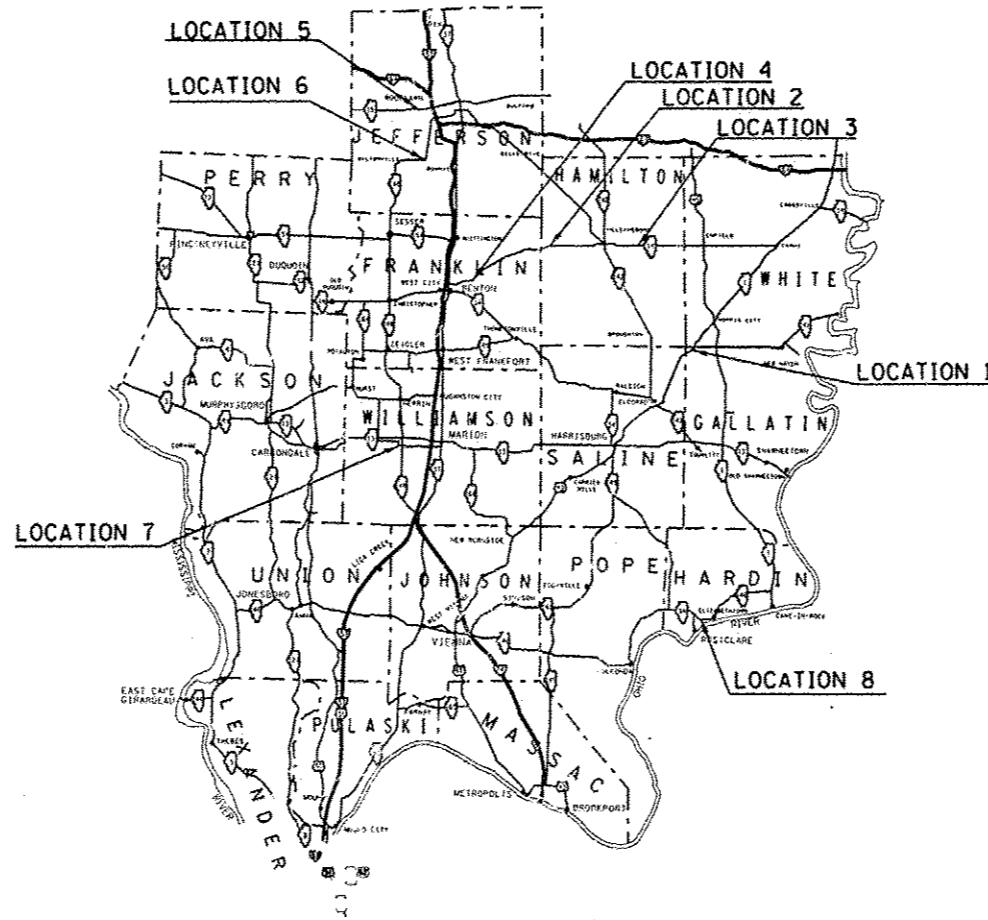

PROJECT ENGINEER - Charles Stein (618) 351-5210
PROJECT MANAGER - Kathi McCord (618) 351-5319

GROSS LENGTH = 47,758 FT. = 9.04 MILE
NET LENGTH = 47,347 FT. = 8.98 MILE

CONTRACT NO. 78396

STATE OF ILLINOIS
DEPARTMENT OF TRANSPORTATION
DIVISION OF HIGHWAYS

SUBMITTED March 18 20 14

Debra L. Keen
DEPUTY DIRECTOR OF HIGHWAYS, REGION ENGINEER

May 9 20 14
John D. Baranzelli, P.E.
ENGINEER OF DESIGN AND ENVIRONMENT

May 9 20 14
Orhan Osman, P.E.
DIRECTOR OF HIGHWAYS, CHIEF ENGINEER

**PRINTED BY THE AUTHORITY
OF THE STATE OF ILLINOIS**

Prepared By: Joe Zlaniewicz
 DISTRICT STUDIES & PLANS ENGINEER

Examined By: [Signature]
 DISTRICT LAND ACQUISITION ENGINEER

Examined By: Carrie Nelson
 DISTRICT PROGRAM DEVELOPMENT ENGINEER

Examined By: Karl Wiley
 DISTRICT OPERATIONS ENGINEER

Examined By: [Signature]
 DISTRICT PROJECT IMPLEMENTATION ENGINEER

Examined By: Daglas J. Murrin
 DISTRICT CONSTRUCTION ENGINEER

Examined By: Bruce Furbles
 DISTRICT MATERIALS ENGINEER

• VARIOUS ROUTES
 ** VARIOUS COUNTIES

FILE NAME *	USER NAME * mcoordk	DESIGNED -	REVISED -	STATE OF ILLINOIS DEPARTMENT OF TRANSPORTATION	SIGNATURE SHEET		F.A. RTE.	SECTION	COUNTY	TOTAL SHEETS	SHEET NO.	
c:\p\work\p\p\mcoordk\0371602\78306-shr-plan.dgn		DRAWN -	REVISED -				•	09 SAFETY 2014-2	**	17	2	
#MODELNAME*	PLOT SCALE * 100.0000 / in.	CHECKED -	REVISED -		SCALE: _____	SHEET _____ OF _____ SHEETS	STA. _____ TO STA. _____	ILLINOIS FED. AID PROJECT				
	PLOT DATE * 2/19/2014	DATE -	REVISED -									

INDEX OF SHEETS

SHEET NO.	DESCRIPTION
1	COVER SHEET
2	SIGNATURE SHEET
3	INDEX OF SHEETS, STANDARDS GENERAL NOTES, MIXTURE REQUIREMENTS
4 - 5	SUMMARY OF QUANTITIES
6	TYPICAL SECTION
7 - 10	SCHEDULES OF QUANTITIES
11	LOCATION MAP OF PROJECTS
12 - 14	INDIVIDUAL LOCATION MAPS & EQUATION STATIONS
15	DETAIL: ENTRANCE & SIDE ROAD DETAIL
16 - 17	DETAIL: LOCATION 4 GUARDRAIL REMOVAL AND REPLACEMENT

STANDARDS

000001-06	STANDARD SYMBOLS, ABBREVIATIONS, AND PATTERNS
482001-02	HMA SHOULDER ADJACENT TO FLEXIBLE PAVEMENT
630001-10	STEEL PLATE BEAM GUARDRAIL
630201-06	PCC/HMA STABILIZATION AT STEEL PLATE BEAM GUARDRAIL
630301-06	SHOULDER WIDENING FOR TYPE 1 (SPECIAL) GUARDRAIL TERMINALS
635006-03	REFLECTOR AND TERMINAL MARKER PLACEMENT
635011-02	REFLECTOR MARKER AND MOUNTING DETAILS
642006	SHOULDER RUMBLE STRIPS, 8 IN.
701001-02	OFF-ROAD OPERATIONS, 2L, 2W, MORE THAN 15' AWAY
701006-05	OFF-ROAD OPERATIONS, 2L, 2W, 15' TO 24" FROM PAVEMENT EDGE
701011-04	OFF-ROAD MOVING OPERATIONS, 2L, 2W, DAY ONLY
701301-04	LANE CLOSURE, 2L, 2W, SHORT TIME OPERATIONS
701306-03	LANE CLOSURE, 2L, 2W, SLOW MOVING OPERATIONS, DAY ONLY FOR SPEEDS \geq 45 MPH
701326-04	LANE CLOSURE, 2L, 2W, PAVEMENT WIDENING, FOR SPEEDS \geq 45 MPH
701901-04	TRAFFIC CONTROL DEVICES
720001-01	SIGN PANEL MOUNTING DETAILS
720006-04	SIGN PANEL ERECTION DETAILS
720011-01	METAL POSTS FOR SIGNS, MARKERS AND DELINEATORS
729001-01	APPLICATIONS OF TYPE A AND B METAL POSTS

GENERAL NOTES

FACTORS USED FOR ESTIMATING PLAN QUANTITIES ARE AS FOLLOWS AND SHALL NOT BE USED FOR THE BASIS OF FINAL QUANTITIES:

ALL HOT- MIX ASPHALT	2.016 TONS/CU. YD.
ALL AGGREGATE	2.05 TONS/CU. YD.
BITUMINOUS MATERIALS:	
ON SHOULDER (TOP LAYER)	0.05 LBS./SQ. FT.
ON SHOULDER (BOTTOM LAYER)	0.025 LBS./SQ. FT.
RIPRAP	1.50 TONS/CU. YD.

THE ALGEBRAIC DIFFERENCE BETWEEN THE PAVEMENT AND SHOULDER SLOPES SHALL NOT EXCEED 8%. THE SHOULDER ON THE OUTSIDE OF SUPERELEVATED CURVES SHALL BE FLATTENED ACCORDINGLY.

THERE ARE NO AVAILABLE WASTE SITES ON THE EXISTING RIGHT OF WAY WITHIN THE PROJECT LIMITS. DISPOSAL WILL BE THE RESPONSIBILITY OF THE CONTRACTOR AND WASTE MUST BE DISPOSED OF IN ACCORDANCE WITH ARTICLE 202.03 OF THE STANDARD SPECIFICATIONS.

STATIONING SHOWN IN THE SCHEDULES IS BASED ON STAMPED STATIONS IN THE EXISTING PAVEMENT AND FROM OLD PLANS. MINOR ADJUSTMENTS MAY BE REQUIRED AS DIRECTED BY THE ENGINEER.

THE EXCAVATED AGGREGATE/EARTH FOR THE PROPOSED SHOULDER SHALL NOT BE WASTED ON THE CONSTRUCTION SITE, UNLESS APPROVAL IS FIRST GIVEN BY THE ENGINEER.

THE HMA SHOULDER SHALL BE 3' OR 4' WIDE AS SHOWN ON THE HMA SHOULDER SCHEDULE. THE SHOULDER SHALL BE AS WIDE AS POSSIBLE THROUGH OUT EACH LOCATION EXCEPT IN LOCATIONS THAT THE EXISTING SHOULDER IS NOT WIDE ENOUGH TO SUSTAIN. IN THESE LOCATIONS THE SHOULDER SHALL BE A MINIMUM OF 2' WIDE. THESE LOCATIONS SHALL BE DETERMINED BY THE ENGINEER. NO EXTRA COMPENSATION WILL BE GIVEN FOR THE VARYING WIDTH. THE HMA SHOULDER WILL BE PAID FOR BY THE SQUARE YARD.

AT LOCATIONS WHERE EXISTING GUTTER OUTLETS ARE NO LONGER IN USE, THEY SHALL BE FILLED WITH THE NEW HMA SHOULDER AND LEFT AS IS. AT LOCATIONS WHERE EXISTING V-CUTTER IS FILLED, BUT TOP LIP IS STILL VISIBLE, IT SHALL BE GROUND OFF AND THE NEW HMA SHOULDER SHALL BE PLACED BEHIND IT AS SHOWN ON THE TYPICALS AND AS DIRECTED BY THE ENGINEER. THE COST OF GRINDING OFF ANY EXISTING V-CUTTER LIP SHALL BE INCLUDED IN THE HMA SHOULDERS, 8".

MIXTURE REQUIREMENTS

LOCATION(S):	HOT-MIX ASPHALT SHOULDERS
MIXTURE USE(S):	HOT-MIX ASPHALT SHOULDERS, N30
AC/PG:	PG58-22
ABR% (MAX):	SEE SPECIAL PROVISION
DESIGN AIR VOIDS:	2.0%, 30 GYRATION DESIGN
MIXTURE COMPOSITION: (GRADATION MIXTURE)	HMA SHOULDER
FRICTION AGGREGATE:	NONE
QUALITY MANAGEMENT PROGRAM:	QC/QA

• VARIOUS ROUTES
•• VARIOUS COUNTIES

FILE NAME *	USER NAME = mcaordkr	DESIGNED -	REVISED -	STATE OF ILLINOIS DEPARTMENT OF TRANSPORTATION	INDEX OF SHEETS, STANDARDS, GENERAL NOTES, MIXTURE REQUIREMENTS	F.A. RTE.	SECTION	COUNTY	TOTAL SHEETS	SHEET NO.
or\p\work\p\stat\mcaordkr\10371602\78396-shr-plan.dgn	DRAWN -	REVISED -	•			09 SAFETY 2014-2	••	17	3	
PLOT SCALE = 1/8"=1'-0"	CHECKED -	REVISED -	CONTRACT NO. 78396							
Default	DATE -	REVISED -	ILLINOIS FED. AID PROJECT							
					SCALE:	SHEET OF SHEETS STA. TO STA.				

SUMMARY OF QUANTITIES

VARIOUS ROUTES
 RURAL
 90% FED.; 10% STATE
 VARIOUS COUNTIES
 CONSTRUCTION TYPE
 CODE 0021

	CODE NUMBER	ITEM DESCRIPTION	UNIT	TOTAL QUANTITY
*	X0327693	HIGH FRICTION SURFACE TREATMENT	SQ YD	16,400
	40600275	BITUMINOUS MATERIALS (PRIME COAT)	POUND	18,379
	20200600	EXCAVATING AND GRADING EXISTING SHOULDERS	UNIT	782
	28100209	STONE RIPRAP, CLASS A5	TON	30
	45100200	CRACK FILLING	POUND	4321
	48203029	HOT-MIX ASPHALT SHOULDERS, 8"	SQ YD	27,224
*	63000001	STEEL PLATE BEAM GUARDRAIL, TYPE A, 6 FOOT POSTS	FOOT	262.5
*	63000025	STEEL PLATE BEAM GUARDRAIL, ATTACHED TO STRUCTURES	FOOT	150
*	63100167	TRAFFIC BARRIER TERMINAL, TYPE 1 (SPECIAL) TANGENT	EACH	12
	63200310	GUARDRAIL REMOVAL	FOOT	850
	64200108	SHOULDER RUMBLE STRIPS, 8 INCH	FOOT	99,233
	67000400	ENGINEER FIELD OFFICE, TYPE A	CAL MO	3
13	67100100	MOBILIZATION	L SUM	1

• SPECIALTY ITEM

• VARIOUS ROUTES
 ** VARIOUS COUNTIES

SUMMARY OF QUANTITIES

VARIOUS ROUTES
 RURAL
 90% FED. ; 10% STATE
 VARIOUS COUNTIES
 CONSTRUCTION TYPE
 CODE 0021

CODE NUMBER	ITEM DESCRIPTION	UNIT	TOTAL QUANTITY
70100460	TRAFFIC CONTROL AND PROTECTION, STANDARD 701306	L SUM	1
70100500	TRAFFIC CONTROL AND PROTECTION, STANDARD 701326	L SUM	1
* 72000100	SIGN PANEL - TYPE 1	SQ FT	528
* 72900100	METAL POST - TYPE A	FOOT	2464
* 78001110	PAINT PAVEMENT MARKING - LINE 4"	FOOT	13,609
* 78200410	GUARDRAIL MARKERS, TYPE A	EACH	24
* 78201000	TERMINAL MARKER - DIRECT APPLIED	EACH	12
78300100	PAVEMENT MARKING REMOVAL	SQ FT	3403

* SPECIALTY ITEM

• VARIOUS ROUTES
 •• VARIOUS COUNTIES

FILE NAME =	USER NAME = c:\ncardkr	DESIGNED -	REVISED -	STATE OF ILLINOIS DEPARTMENT OF TRANSPORTATION	SUMMARY OF QUANTITIES SHEET 2	F.A. RTE.	SECTION	COUNTY	TOTAL SHEETS	SHEET NO.	
e:\pwwork\pedit\ncardkr\0371602\78	RE-ahy-plan.dgn	DRAWN -	REVISED -			•	D9 SAFETY 2014-2	**	17	5	
Default	PLOT SCALE = 1/8" = 1' 0"	CHECKED -	REVISED -			SCALE: SHEET OF SHEETS STA. TO STA.		ILLINOIS FED. AID PROJECT			
	PLOT DATE = 12/8/2014	DATE -	REVISED -			CONTRACT NO. 78396					

TYPICAL FOR HMA SHOULDERS, 8"

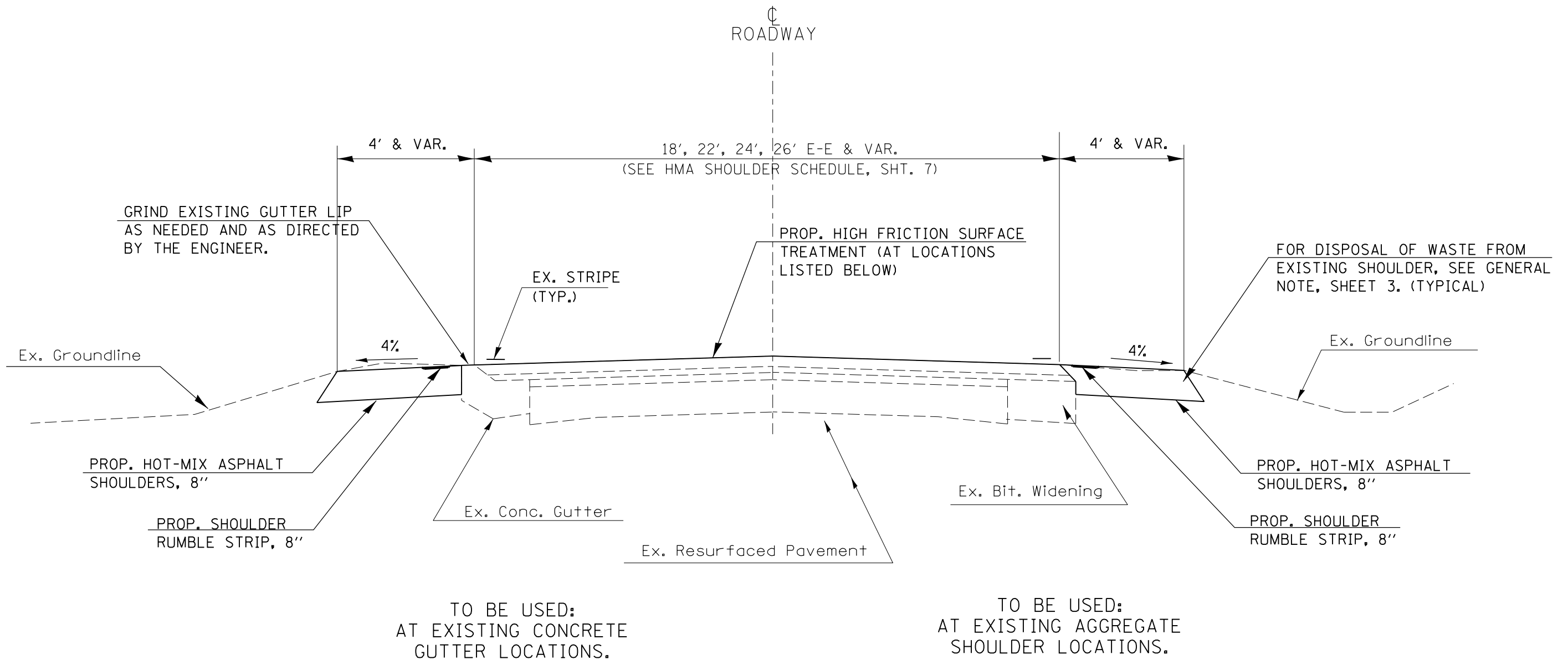

LOCATIONS FOR
HIGH FRICTION SURFACE TREATMENT:
LOCATION 1
LOCATION 6
LOCATION 7
(SEE SCHEDULE, SHT. 10)

• VARIOUS ROUTES
•• VARIOUS COUNTIES

FILE NAME =	USER NAME = mccordkr	DESIGNED -	REVISED -
ei:\pwork\pwork\mccordkr\0371602\78396-sh1-plan.dgn		DRAWN -	REVISED -
Default	PLOT SCALE = 100.0000' / in.	CHECKED -	REVISED -
	PLOT DATE = 12/8/2014	DATE -	REVISED -

STATE OF ILLINOIS
DEPARTMENT OF TRANSPORTATION

TYPICAL SECTION

SCALE: SHEET OF SHEETS STA. TO STA.

F.A. RTE.	SECTION	COUNTY	TOTAL SHEETS	SHEET NO.
•	D9 SAFETY 2014-2	••	17	6
			CONTRACT NO. 78396	
ILLINOIS FED. AID PROJECT				

HMA SHOULDER SCHEDULE

LOCATION STATION TO STATION	EXIST. PAVEMENT LENGTH (INFOR. ONLY) FOOT	EXIST. PAVEMENT WIDTH FOOT	EXIST. AGG./BIT. SHOULDER WIDTH FOOT	HMA SHOULDERS, 8"		BITUMINOUS MATERIALS (PRIME COAT) POUND	SHOULDER RUMBLE STRIPS, 8 INCH FOOT	EXC. & GRADING EX. SHOULDER UNIT	NOTES
				3 FT. SQ YD	4 FT. SQ YD				
LOCATION 1 - US 45 IN GALLATIN CO.									
STA. 802+80.00 TO STA. 826+17.00	2,337	26	2	1,558		1052	4,674	46	
GALLATIN CO TOTALS				1,558	0	1052	4,674	46	
LOCATION 2 - IL 14 IN HAMILTON CO. (NEAR FRANKLIN CO LINE)									
STA. 656+00.00 TO STA. 675+00.00	1,900	26	2		1,689	1140	3,800	38	
LOCATION 3 - IL 14 IN HAMILTON CO. (NEAR MCLEANSBORO)									
STA. 871+00.00 TO STA. 924+33.70 BK	5,334	28	3		4,741	3200	10,667	107	
STA. 924+46.40 AH TO STA. 925+56.00 BK	110	28	3		97	66	219	2	
STA. 14+00.00 AH TO STA. 18+00.00	400	28	3		356	240	800	8	
HAMILTON CO TOTALS				0	6,883	4646	15,487	155	
LOCATION 4 - IL 14 IN FRANKLIN CO. (NEAR BENTON)									
STA. 18+45.00 TO STA. 30+30.80 BK	1,186	24	2	791		534	2,372	24	
STA. 30+32.90 AH TO STA. 49+63.30 BK	1,930	24	2	1,287		869	3,861	39	
STA. 49+62.80 AH TO STA. 78+95.90 BK	2,933	24	2	1,955		1320	5,866	59	
STA. 78+98.46 AH TO STA. 115+27.00	3,629	24	2	2,419		1633	7,257	73	
FRANKLIN CO TOTALS				6,452	0	4355	19,356	195	
LOCATION 5 - IL 15 IN JEFFERSON CO. (WOODLAWN RD. TO DIVERS LN.)									
STA. 1052+50.00 TO STA. 1113+81.50 BK	6,132	28	3				12,263		
STA. 1114+00.00 AH TO STA. 1123+06.60 BK	907	28	3				1,813		
STA. 1135+52.00 AH TO STA. 1151+76.00 BK	1,624	28	3				3,248		
STA. 1151+80.00 AH TO STA. 1163+96.00	1,216	28	3				2,432		
OMIT SN 041-0104: STA. 1163+96 TO STA. 1166+30	-237								
STA. 1166+30.00 TO STA. 1173+90.00	760	28	3				1,520		
LOCATION 6 - IL 148 IN JEFFERSON CO. (WALTONVILLE RD.)									
STA. 194+00.00 TO STA. 231+21.45 BK	3,721	24	3		3,308	2233	11,164	112	NOTE 1
STA. 235+78.70 AH TO STA. 242+00.00	621	24	3		552	373	1,864	19	NOTE 1
JEFFERSON CO TOTALS				0	3,860	2606	34,304	131	
LOCATION 7 - OLD IL 13 IN WILLIAMSON CO. (WEST OF IL 148)									
STA. 498+00.00 TO STA. 524+64.00	2,664	23	2	1,776		1200	5,328	53	
OMIT SN 100-0045: STA. 524+64 TO STA. 525+38	-74								
STA. 525+38.00 TO STA. 534+25.90 BK	888	23	2	592		400	1,776	18	
STA. 534+35.60 AH TO STA. 560+10.50 BK	2,575	23	2	1,717		1159	5,150	52	
STA. 560+51.40 AH TO STA. 582+20.00	2,169	23	2	1,446		976	4,337	43	
WILLIAMSON CO. TOTALS				5,530	0	3734	16,591	166	
LOCATION 8 - IL 146 IN HARDIN CO. (WEST OF ELIZABETHTOWN)									
STA. 187+00.00 TO STA. 225+82.70 BK	3,883	26	3	2588		1747	7,765	78	
STA. 232+71.90 AH TO STA. 238+00.00	528	26	3	352		238	1,056	11	
HARDIN CO. TOTALS				2941	0	1985	8,822	89	
PROJECT TOTAL		47,347			16,481	10,743	18,379	99,233	782
				HMA SHOULDER, 8" TOTAL		27,224			

NOTE 1: AT LOCATION 6 ON IL. 148, THE SHOULDER RUMBLE STRIPS, 8 INCH SHALL BE CONSTRUCTED ON THE CENTERLINE AS WELL AS THE SHOULDER.

NOTE 2: ANY EXISTING GUTTER OUTLETS IN AREA WHERE NEW HMA SHOULDER, 8" IS TO BE CONSTRUCTED SHALL BE FILLED AS DIRECTED BY THE ENGINEER. SEE GENERAL NOTES, SHEET 3.

• VARIOUS ROUTES
• VARIOUS COUNTIES

GUARDRAIL SCHEDULE

LOCATION STATION TO STATION	Existing Length (Inform. Only)	GUARDRAIL REMOVAL	SPBGR TYPE A, 6 FT. POSTS	TRAFFIC BARRIER TERMINAL, TY. 1 SPL. (TANG)	SPBGR ATTACHED TO STRUCTURE	TERMINAL MARKERS - DA	GUARDRAIL MARKERS TY. A	STONE RIPRAP, CLASS A5
	FOOT	FOOT	FOOT	EACH	FOOT	EACH	EACH	TON
LOCATION 4 - IL 14 IN FRANKLIN CO.								
028-7049 (North Side)								
LT 20+50.00				1		1		
LT 20+65.00 TO LT 21+65.00	100	100						
LT 21+00.00 TO LT 21+37.50					37.5		4	
LT 21+92.00				1		1		
028-7049 (South Side)								
RT 20+78.00				1		1		30
RT 21+00.00 TO RT 22+00.00	100	100						
RT 21+28.00 TO RT 21+65.50					37.5		4	
RT 22+16.00				1		1		
028-7051 (North Side)								
LT 34+05.00				1		1		
LT 34+30.00 TO LT 35+20.00	90	90						
LT 34+55.00 TO LT 34+92.50					37.5		4	
LT 35+43.00				1		1		
028-7051 (South Side)								
RT 33+82.00				1		1		
RT 34+00.00 TO RT 34+90.00	90	90						
RT 34+32.00 TO RT 34+69.50					37.5		4	
RT 35+20.00				1		1		
Exist. Guardrail over 18" pipe (North Side)								
LT 103+64.00				1		1		
LT 103+64.00 TO LT 106+34.00	270	270						
LT 104+14.00 TO LT 105+76.50					162.5		4	
LT 106+26.50				1		1		
Exist. Guardrail over 18" pipe (North Side)								
RT 103+64.00				1		1		
RT 103+64.00 TO RT 105+64.00	200	200						
RT 104+14.00 TO RT 105+14.00					100.0		4	
RT 105+64.00				1		1		
PROJECT TOTALS:		850	262.5	12	150.0	12	24	30

NOTE 1: ANY WIDENING AND EXTRA DIRT NECESSARY TO CONSTRUCT THE TYPE 1, SPECIAL (TANGENT) GUARDRAIL TERMINAL SHALL BE INCLUDED IN THE COST OF THE **TRAFFIC BARRIER TERMINAL, TYPE 1 SPECIAL (TANGENT)**.

NOTE 2: STONE RIPRAP, CLASS A5 SHALL BE PLACED AT LOCATION INDICATED AND AS DIRECTED BY THE ENGINEER.

- VARIOUS ROUTES
- VARIOUS COUNTIES

FILE NAME =	USER NAME = mccordkr	DESIGNED -	REVISED -	STATE OF ILLINOIS DEPARTMENT OF TRANSPORTATION	GUARDRAIL SCHEDULE	F.A. RTE.	SECTION	COUNTY	TOTAL SHEETS	SHEET NO.
ei:\pw\work\p1dot\mccordkr\0371602\78396-sh1-plan.dgn		DRAWN -	REVISED -			•	D9 SAFETY 2014-2	••	17	8
Default	PLOT SCALE = 100.0000' / in.	CHECKED -	REVISED -		SCALE:					
	PLOT DATE = 12/8/2014	DATE -	REVISED -		SHEET	OF	SHEETS	STA.	TO	STA.
										ILLINOIS FED. AID PROJECT
										CONTRACT NO. 78396

SIGN SCHEDULE

LOCATION	SIGN ID NO.	DESCRIPTION	SIGN SIZE	AREA PER SIGN	TOTAL SIGN REQUIRED	SIGN PANEL - TYPE 1	METAL POST - TYPE A
				SQ FT	EACH	SQ FT	FOOT
LOCATION 1 - US 45 IN GALLATIN CO.							
STA. 804+00.00 TO STA. 821+00.00	W1-8	CHEVRON ALIGNMENT	18"X24"	3	18	54	252
GALLATIN CO TOTALS						54	252
LOCATION 2 - IL 14 IN HAMILTON CO. (NEAR FRANKLIN CO. LINE)							
STA. 659+50.00 TO STA. 670+00.00	W1-8	CHEVRON ALIGNMENT	18"X24"	3	10	30	140
LOCATION 3 - IL 14 IN HAMILTON CO. (NEAR MCLEANSBORO)							
STA. 908+00.00 TO STA. 924+33.70 BK	W1-8	CHEVRON ALIGNMENT	18"X24"	3	28	84	392
STA. 924+46.40 AH TO STA. 925+00.00	W1-8	CHEVRON ALIGNMENT	18"X24"	3	0	0	0
HAMILTON CO TOTALS						114	532
LOCATION 4 - IL 14 IN FRANKLIN CO. (NEAR BENTON)							
STA. 22+50.00 TO STA. 30+30.00	W1-8	CHEVRON ALIGNMENT	18"X24"	3	10	30	140
FRANKLIN CO TOTALS						30	140
LOCATION 6 - IL 148 IN JEFFERSON CO. (WALTONVILLE RD.)							
STA. 199+00.00 TO STA. 231+21.45 BK	W1-8	CHEVRON ALIGNMENT	18"X24"	3	40	120	560
STA. 235+78.70 AH TO STA. 242+00.00	W1-8	CHEVRON ALIGNMENT	18"X24"	3	8	24	112
JEFFERSON CO TOTALS						144	672
LOCATION 7 - OLD IL 13 IN WILLIAMSON CO. (WEST OF IL 148)							
STA. 498+00.00 TO STA. 502+00.00	W1-8	CHEVRON ALIGNMENT	18"X24"	3	10	30	140
STA. 504+00.00 TO STA. 508+35.00	W1-8	CHEVRON ALIGNMENT	18"X24"	3	10	30	140
STA. 529+00.00 TO STA. 534+25.00	W1-8	CHEVRON ALIGNMENT	18"X24"	3	14	42	196
STA. 555+40.00 TO STA. 560+00.00	W1-8	CHEVRON ALIGNMENT	18"X24"	3	12	36	168
WILLIAMSON CO. TOTALS						138	644
LOCATION 8 - IL 146 IN HARDIN CO. (WEST OF ELIZABETHTOWN)							
STA. 213+00.00 TO STA. 225+82.70	W1-8	CHEVRON ALIGNMENT	18"X24"	3	16	48	224
HARDIN CO. TOTALS						48	224
PROJECT TOTAL						528	2,464

• VARIOUS ROUTES
•• VARIOUS COUNTIES

HIGH FRICTION SURFACE TREATMENT SCHEDULE

LOCATION STATION TO STATION	EXIST. PAVEMENT LENGTH (INFOR. ONLY) FOOT	EXIST. PAVEMENT WIDTH FOOT	HIGH FRICTION SURFACE TREATMENT SQ YD	PAVEMENT MARKING REMOVAL (SEE NOTE 2) SQ FT	PAINT PAVEMENT MARKING - 4"		CRACK FILLING (SEE NOTE 1) POUND
					WHITE	YELLOW	
					FOOT	FOOT	
LOCATION 1 - US 45 IN GALLATIN CO.							
STA. 802+96.00 TO STA. 821+73.00	1,877	26	5422	1,056	3,754	469	1,341
GALLATIN CO TOTALS			5422	1,056	3754	469	1341
LOCATION 6 - IL 148 IN JEFFERSON CO. (WALTONVILLE RD.)							
STA. 203+93.00 TO STA. 231+21.45 BK	2,728	24	7276	1,535	5,456	682	1,949
STA. 235+78.70 AH TO STA. 236+80.00	101	24	270	57	202	25	72
JEFFERSON CO TOTALS			7546	1,592	5,658	707	2021
LOCATION 7 - OLD IL 13 IN WILLIAMSON CO. (WEST OF IL 148)							
STA. 528+44.00 TO STA. 534+25.90 BK	582	23	1487	327	1,164	145	416
STA. 534+35.60 AH TO STA. 535+36.00	100	23	257	56	200	25	72
STA. 554+50.00 TO STA. 560+10.50 BK	561	23	1433	316	1,122	140	400
STA. 560+51.40 AH TO STA. 561+51.00	100	23	255	56	200	25	71
WILLIAMSON CO. TOTALS			3432	755	2,686	335	959
PROJECT TOTAL							
	47,347		16,400	3,403	12,098	1,511	4,321
					13,609		

NOTE 1: CRACK FILLING IS CALCULATED USING 1 LB. OF MATERIAL PER 2.8 LINEAL FOOT. USED 1 STRIP FOR EACH LANE THROUGH THE LENGTH OF THE CURVES, UNLESS OTHERWISE NOTED ON THE PLANS.

NOTE 2: QUANTITIES AT EACH LOCATION INCLUDE EDGE OF PAVEMENT STRIPING AND CENTERLINE STRIPING.

- VARIOUS ROUTES
- VARIOUS COUNTIES

FILE NAME =	USER NAME = mccordkr	DESIGNED -	REVISED -	STATE OF ILLINOIS DEPARTMENT OF TRANSPORTATION	HIGH FRICTION SURFACE TREATMENT SCHEDULE	F.A. RTE.	SECTION	COUNTY	TOTAL SHEETS	SHEET NO.	
ei:\pw\work\p\idot\mccordkr\0371602\78396-sh1-plan.dgn		DRAWN -	REVISED -			•	D9 SAFETY 2014-2	••	17	10	
Default	PLOT SCALE = 100.0000' / in.	CHECKED -	REVISED -			CONTRACT NO. 78396					
	PLOT DATE = 12/8/2014	DATE -	REVISED -			SCALE:	SHEET	OF	SHEETS	STA.	TO
ILLINOIS FED. AID PROJECT											

LOCATION MAP

- LOCATION 1: US 45 IN GALLATIN CO. SOUTH OF IL. 141
- LOCATION 2: IL. 14 IN HAMILTON CO. EAST OF THE FRANKLIN COUNTY LINE.
- LOCATION 3: IL. 14 IN HAMILTON CO. EAST OF MCLEANSBORO.
- LOCATION 4: IL. 14 IN FRANKLIN CO. EAST OF BENTON.
- LOCATION 5: IL. 15 IN JEFFERSON CO. SOUTH OF WOODLAWN.
- LOCATION 6: IL. 148 IN JEFFERSON CO. EAST OF WALTONVILLE.
- LOCATION 7: OLD IL. 13 IN WILLIAMSON CO. WEST OF IL. 148.
- LOCATION 8: IL. 146 IN HARDIN CO. WEST OF ELIZABETHTOWN.

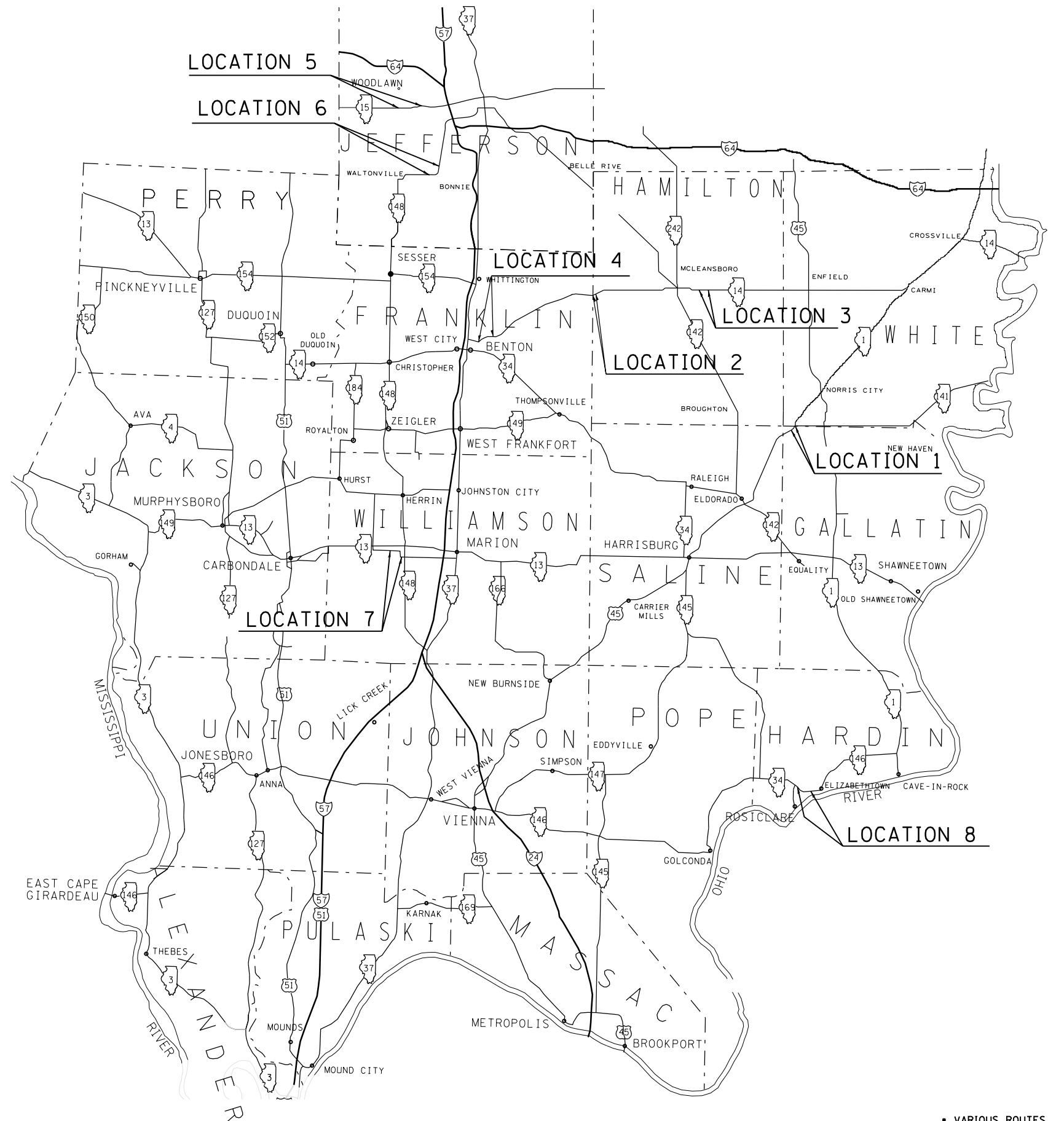

• VARIOUS ROUTES
 •• VARIOUS COUNTIES

FILE NAME =	USER NAME = mccordkr	DESIGNED -	REVISED -
et:\pw\work\p\idot\mccordkr\ad0371602\78396-sh1-plan.dgn		DRAWN -	REVISED -
Default	PLOT SCALE = 100.0000' / in.	CHECKED -	REVISED -
	PLOT DATE = 12/8/2014	DATE -	REVISED -

**STATE OF ILLINOIS
 DEPARTMENT OF TRANSPORTATION**

LOCATION MAP OF PROJECTS

SCALE:	SHEET	OF	SHEETS	STA.	TO	STA.
--------	-------	----	--------	------	----	------

F.A. RTE.	SECTION	COUNTY	TOTAL SHEETS	SHEET NO.
•	D9 SAFETY 2014-2	••	17	11
CONTRACT NO. 78396				
ILLINOIS FED. AID PROJECT				

LOCATION 1
US 45 IN GALLATIN CO.
SOUTH OF IL 141

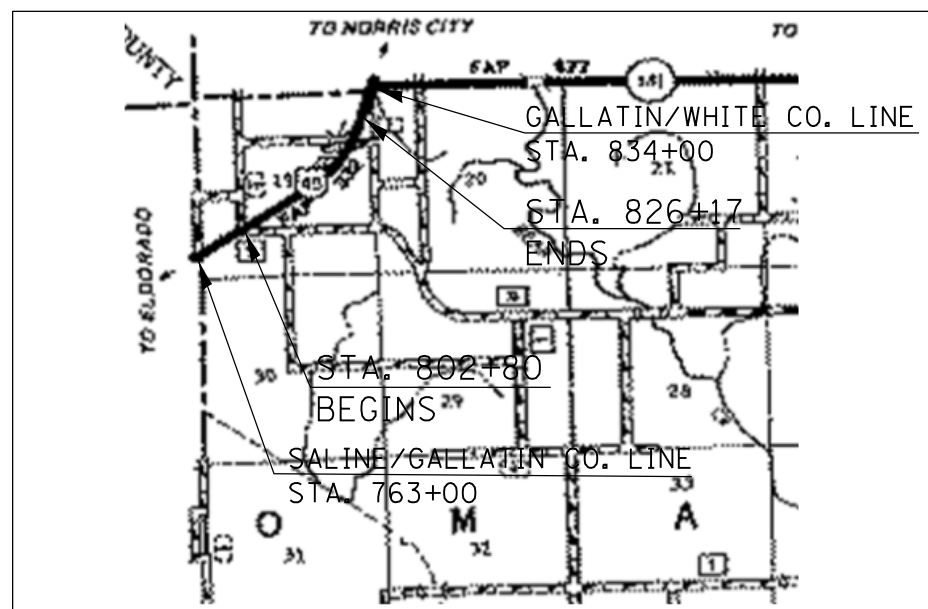

PAY ITEMS:
3' HMA SHOULDERS, 8"
SHOULDER RUMBLE STRIPS, 8 INCH
CHERVRON SIGNS
HIGH FRICTION SURFACE TREATMENT

LOCATION 2
IL. 14 IN HAMILTON CO.
EAST OF FRANKLIN CO. LINE

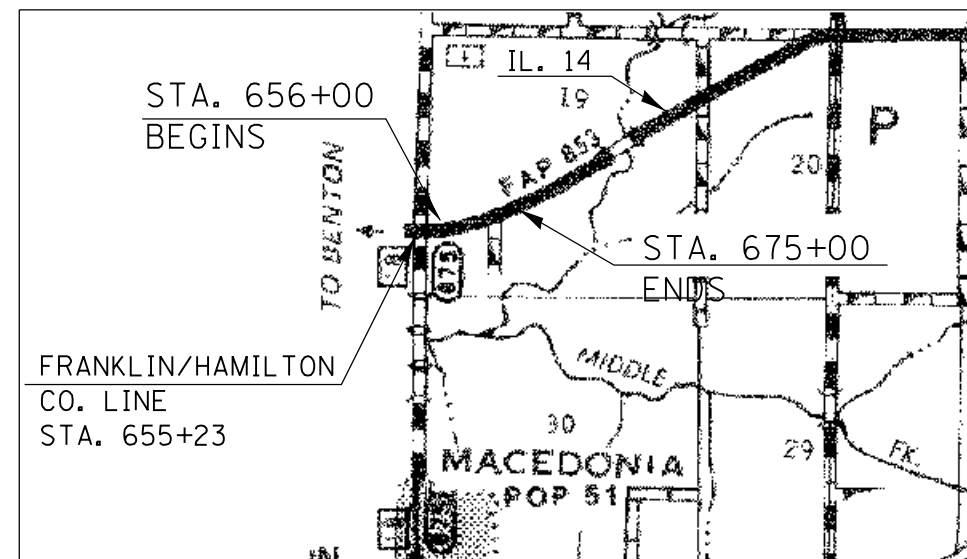

PAY ITEMS:
4' HMA SHOUDERS, 8"
SHOULDER RUMBLE STRIPS, 8 INCH
CHERVRON SIGNS

LOCATION 3
IL. 14 IN HAMILTON CO.
EAST OF MCLEANSBORO

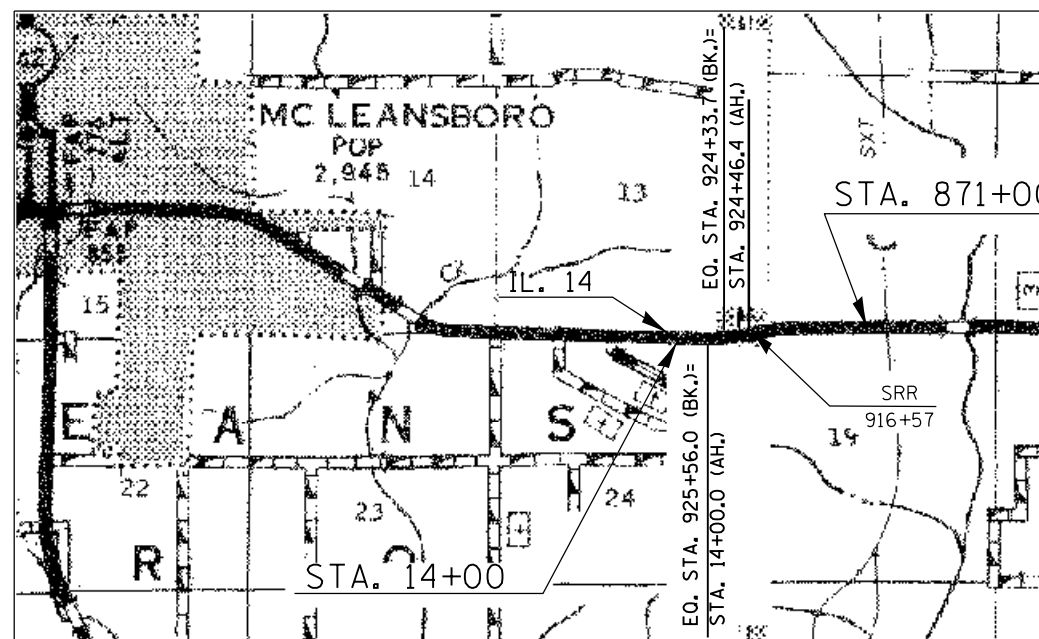

PAY ITEMS:
4' HMA SHOULDER, 8"
SHOULDER RUMBLE STRIPS, 8 INCH
CHEVRON WARNING SIGNS

FILE NAME =	USER NAME = mccordkr	DESIGNED -	REVISED -
et:\pw\work\p1dot\mccordkr\0371602\78396-sh1-plan.dgn		DRAWN -	REVISED -
Default	PLOT SCALE = 100.0000' / in.	CHECKED -	REVISED -
	PLOT DATE = 12/8/2014	DATE -	REVISED -

STATE OF ILLINOIS
DEPARTMENT OF TRANSPORTATION

LOCATION MAPS -
SHEET 1

SCALE: SHEET OF SHEETS STA. TO STA.

F.A. RTE.	SECTION	COUNTY	TOTAL SHEETS	SHEET NO.
	D9 SAFETY 2014-2	**	17	12
			CONTRACT NO. 78396	
ILLINOIS FED. AID PROJECT				

• VARIOUS ROUTES
•• VARIOUS COUNTIES

LOCATION 4
 IL. 14 IN FRANKLIN CO.
 EAST OF BENTON

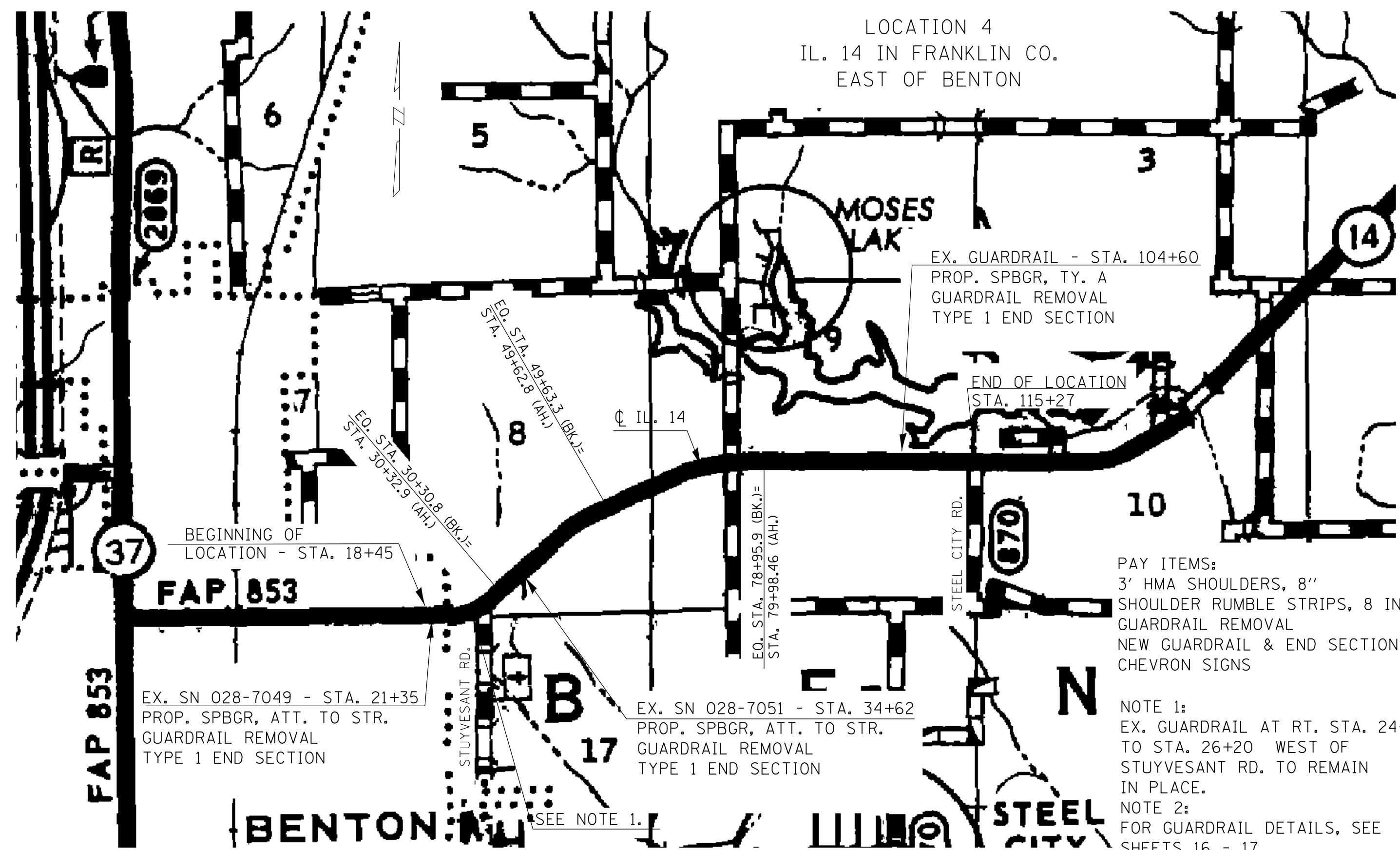

EX. GUARDRAIL - STA. 104+60
 PROP. SPBGR, TY. A
 GUARDRAIL REMOVAL
 TYPE 1 END SECTION

END OF LOCATION
 STA. 115+27

BEGINNING OF
 LOCATION - STA. 18+45

FAP 853

EX. SN 028-7049 - STA. 21+35
 PROP. SPBGR, ATT. TO STR.
 GUARDRAIL REMOVAL
 TYPE 1 END SECTION

EX. SN 028-7051 - STA. 34+62
 PROP. SPBGR, ATT. TO STR.
 GUARDRAIL REMOVAL
 TYPE 1 END SECTION

PAY ITEMS:
 3' HMA SHOULDERS, 8"
 SHOULDER RUMBLE STRIPS, 8 INCH
 GUARDRAIL REMOVAL
 NEW GUARDRAIL & END SECTIONS
 CHEVRON SIGNS

NOTE 1:
 EX. GUARDRAIL AT RT. STA. 24+92
 TO STA. 26+20 WEST OF
 STUYVESANT RD. TO REMAIN
 IN PLACE.
 NOTE 2:
 FOR GUARDRAIL DETAILS, SEE
 SHEETS 16 - 17.

• VARIOUS ROUTES
 •• VARIOUS COUNTIES

FILE NAME =	USER NAME = mccordkr	DESIGNED -	REVISED -
et:\pw\work\p1dot\mccordkr\0371602\78396-sh1-plan.dgn		DRAWN -	REVISED -
Default	PLOT SCALE = 100.0000' / in.	CHECKED -	REVISED -
	PLOT DATE = 12/8/2014	DATE -	REVISED -

STATE OF ILLINOIS
 DEPARTMENT OF TRANSPORTATION

LOCATION MAPS-
 SHEET 2

SCALE: SHEET OF SHEETS STA. TO STA.

F.A. RTE.	SECTION	COUNTY	TOTAL SHEETS	SHEET NO.
•	D9 SAFETY 2014-2	••	17	13
				CONTRACT NO. 78396
ILLINOIS FED. AID PROJECT				

LOCATION 5
IL. 15 IN JEFFERSON CO.
SOUTH OF WOODLAWN

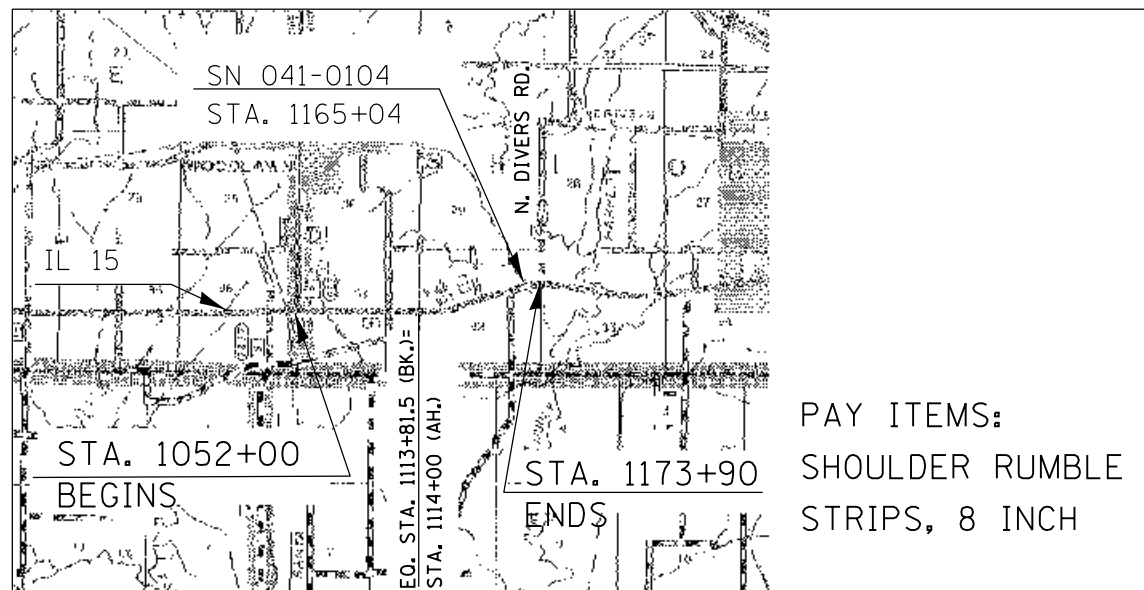

LOCATION 6
IL 148 IN JEFFERSON CO.
EAST OF WALTONVILLE

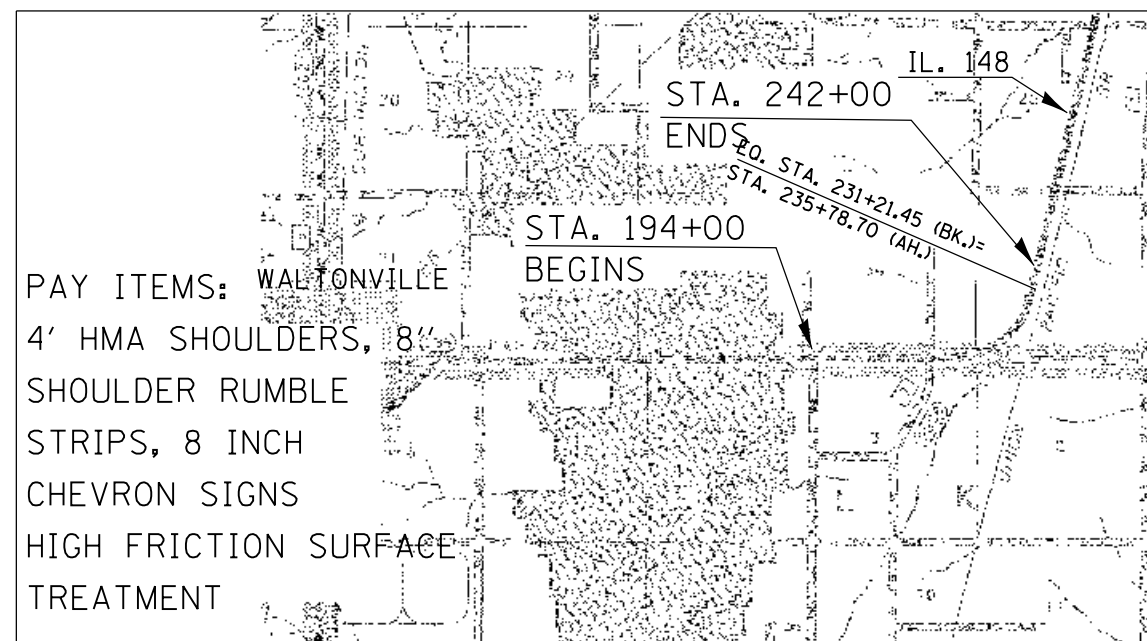

LOCATION 7
OLD IL. 13 IN WILLIAMSON CO.
WEST OF IL 148

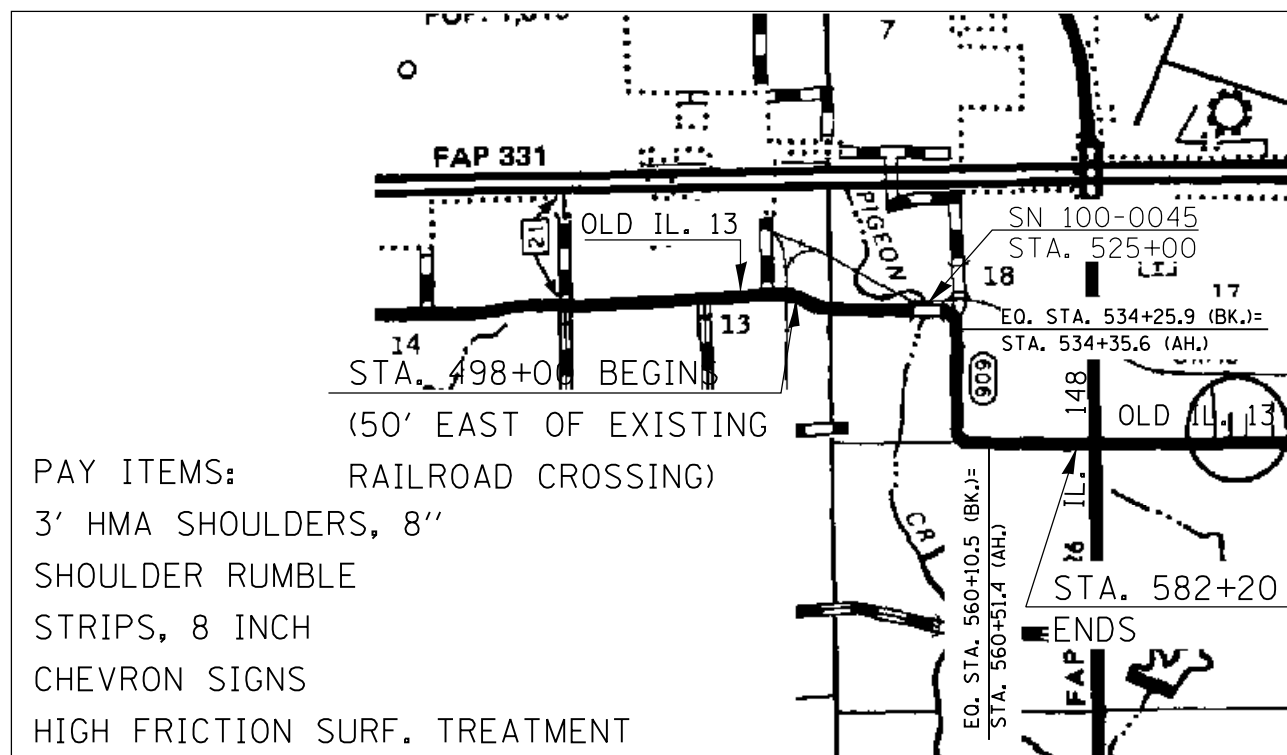

LOCATION 8
IL 146 IN HARDIN CO.
WEST OF ELIZABETHTOWN

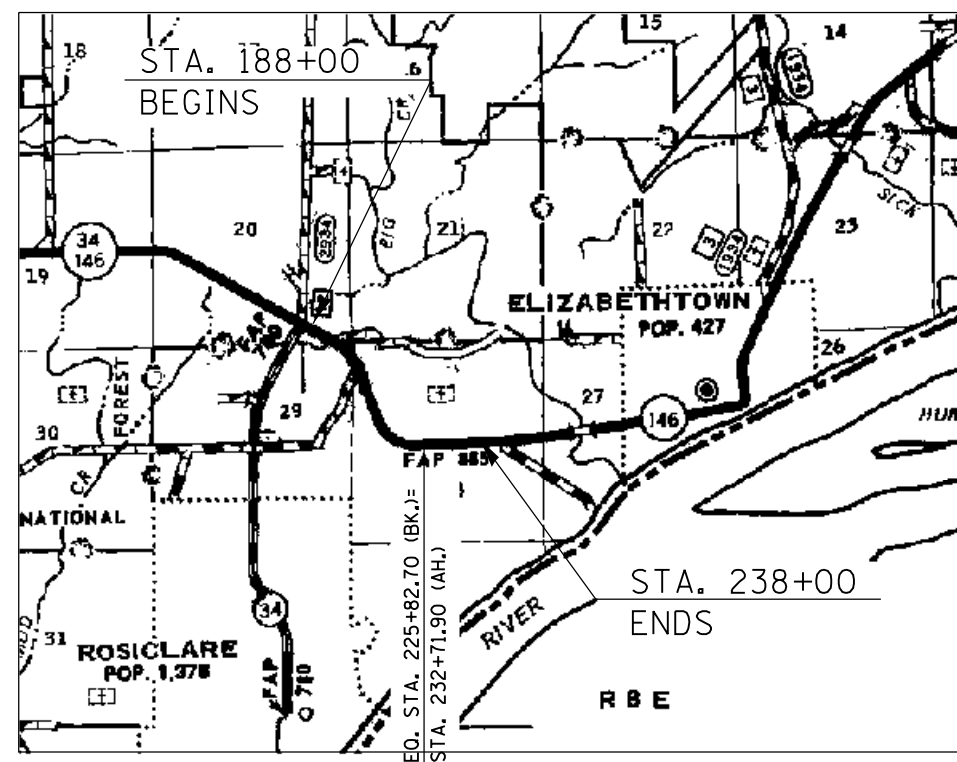

PAY ITEMS:
3' HMA SHOULDERS, 8"
SHOULDER RUMBLE
STRIPS, 8 INCH
CHEVRON SIGNS

• VARIOUS ROUTES
•• VARIOUS COUNTIES

FILE NAME =	USER NAME = mccordkr	DESIGNED -	REVISED -
et:\pw\work\p\dot\mccordkr\0371602\78396-sh1-plan.dgn		DRAWN -	REVISED -
Default	PLOT SCALE = 100.0000' / in.	CHECKED -	REVISED -
	PLOT DATE = 12/8/2014	DATE -	REVISED -

STATE OF ILLINOIS
DEPARTMENT OF TRANSPORTATION

LOCATION MAPS -
SHEET 3

SCALE: SHEET OF SHEETS STA. TO STA.

F.A. RTE.	SECTION	COUNTY	TOTAL SHEETS	SHEET NO.
•	D9 SAFETY 2014-2	••	17	14
CONTRACT NO. 78396				
ILLINOIS FED. AID PROJECT				

ENTRANCE AND SIDE ROAD DETAILS

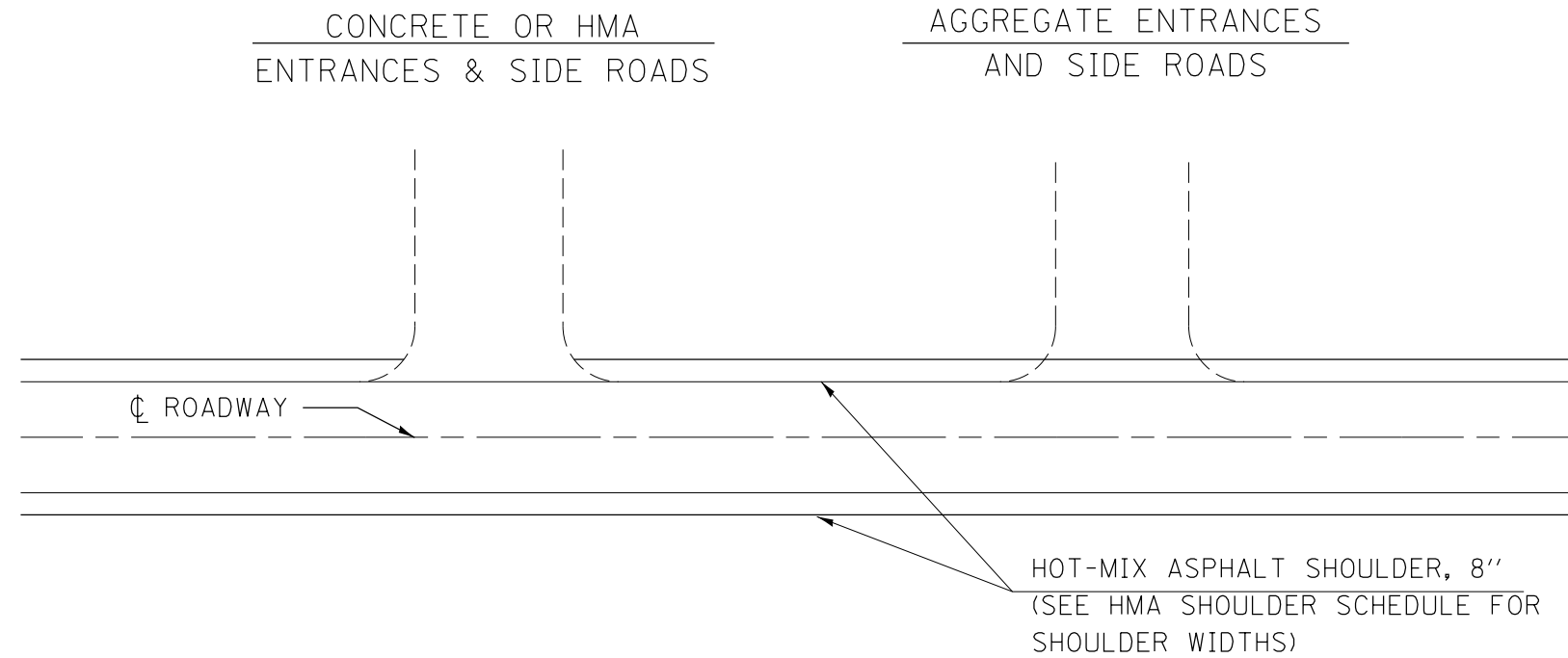

GENERAL NOTES

1. CONSTRUCT HOT-MIX ASPHALT SHOULDER THROUGH AGGREGATE ENTRANCE OR SIDE ROADS. IF THE ENTRANCE OR SIDE ROAD IS CONCRETE OR HMA, THEN PLACE SHOULDER UP TO EDGE OF THE ENTRANCE OR SIDE ROAD PAVEMENT.
2. THE MATERIAL THAT IS REMOVED TO PLACE THE SHOULDER SHALL BE WASTED ON THE FORESLOPE AND GRADED BACK TO THE EDGE OF THE PROPOSED SHOULDER. DO NOT PLACE WASTE MATERIAL ONTO EXISTING ENTRANCES, SIDE ROADS OR ON MAINTAINED LAWNS.

• VARIOUS ROUTES
•• VARIOUS COUNTIES

FILE NAME =	USER NAME = mccordkr	DESIGNED -	REVISED -	STATE OF ILLINOIS DEPARTMENT OF TRANSPORTATION	ENTRANCE AND SIDE ROAD DETAILS	F.A. RTE.	SECTION	COUNTY	TOTAL SHEETS	SHEET NO.	
ci:\pw\work\p\dot\mccordkr\0371602\78396-sh1-plan.dgn		DRAWN -	REVISED -			•	D9 SAFETY 2014-2	••	17	15	
Default	PLOT SCALE = 100.0000' / in.	CHECKED -	REVISED -			CONTRACT NO. 78396					
	PLOT DATE = 12/8/2014	DATE -	REVISED -			SCALE:	SHEET OF SHEETS	STA. TO STA.	ILLINOIS FED. AID PROJECT		

GUARDRAIL DETAILS FOR LOCATION 4

SN 028-7049
STA. 21+35
6' X 12' BOX
USE STD. 630101

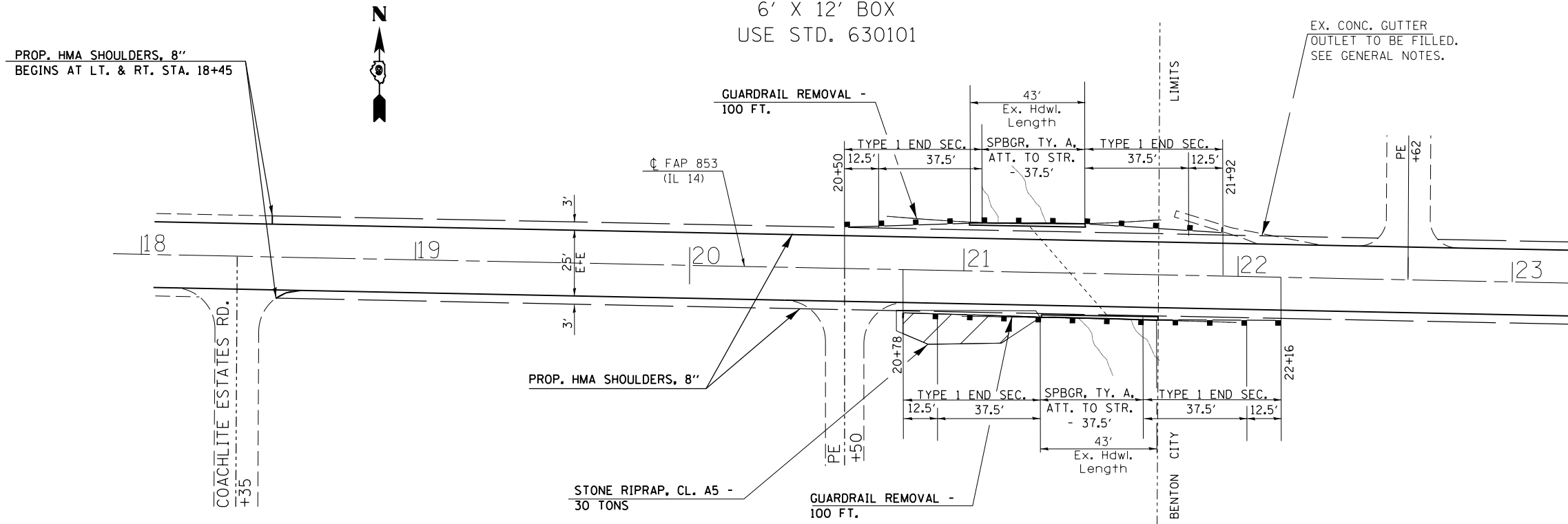

SN 028-7051
STA. 34+62
6' X 12' BOX
USE STD. 630101

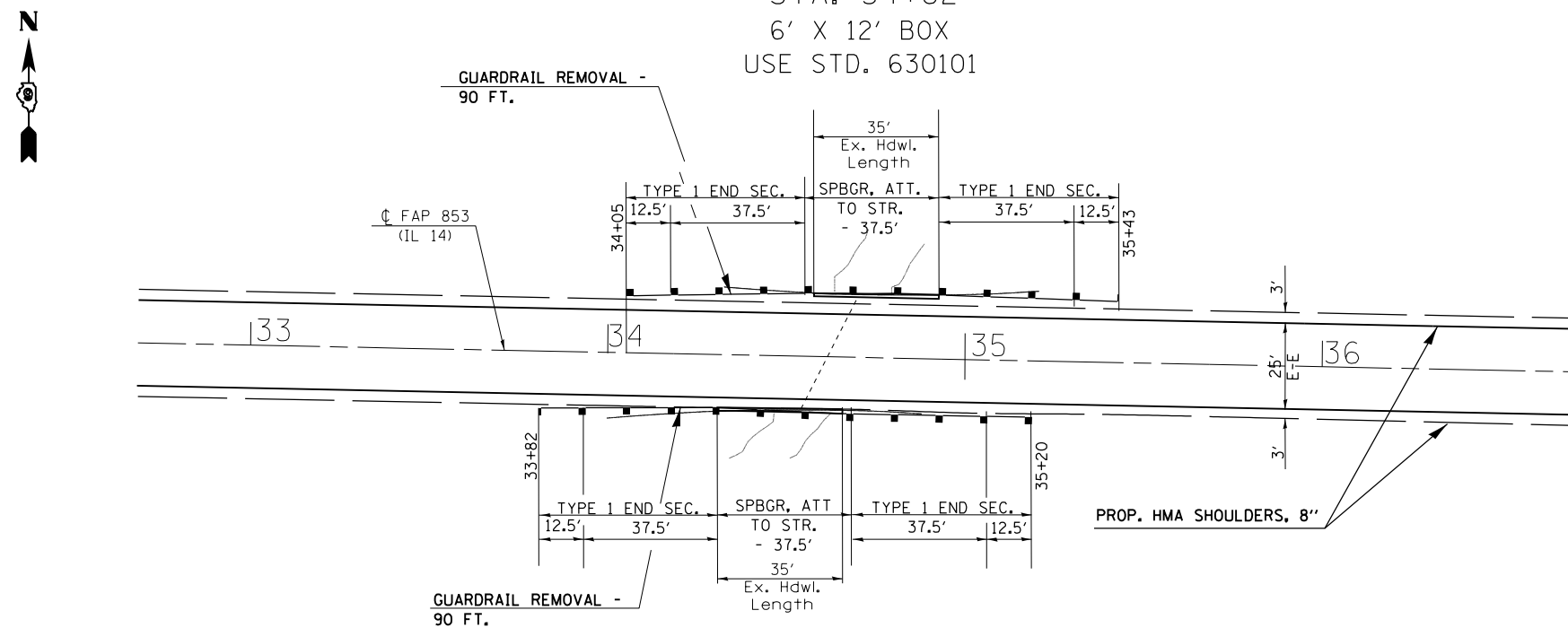

FILE NAME =	USER NAME = mccordkr	DESIGNED -	REVISED -
ei:\pw\work\p1dot\mccordkr\0371602\78396-sh1-plan.dgn		DRAWN -	REVISED -
Default	PLOT SCALE = 100.0000' / in.	CHECKED -	REVISED -
	PLOT DATE = 12/8/2014	DATE -	REVISED -

**STATE OF ILLINOIS
DEPARTMENT OF TRANSPORTATION**

**LOCATION 4 GUARDRAIL DETAILS -
SN 028-7049 & SN 028-7051**

SCALE: SHEET OF SHEETS STA. TO STA.

F.A. RTE.	SECTION	COUNTY	TOTAL SHEETS	SHEET NO.
•	D9 SAFETY 2014-2	••	17	16
			CONTRACT NO. 78396	
ILLINOIS FED. AID PROJECT				

• VARIOUS ROUTES
•• VARIOUS COUNTIES

**GUARDRAIL DETAILS
FOR LOCATION 4**

STA. 104+60
Ex. 18" PCC Pipe
USE STD. 630101

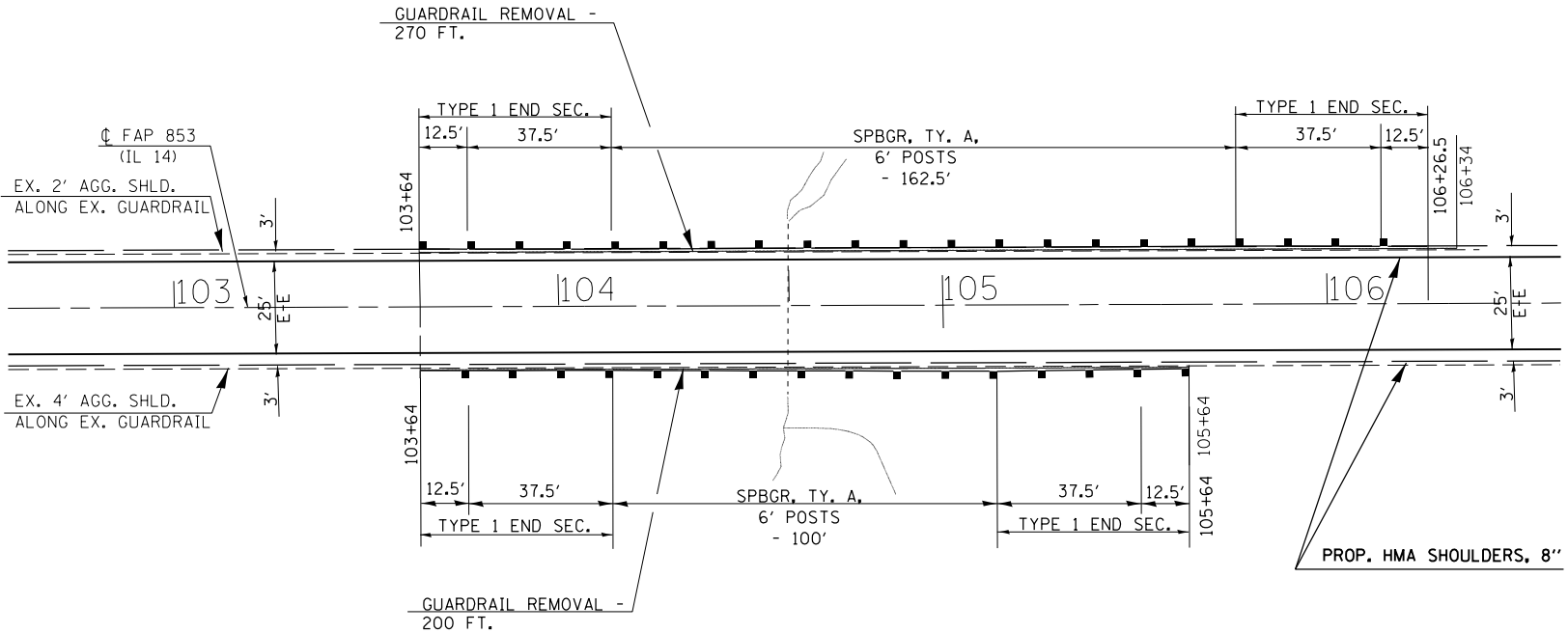

- VARIOUS ROUTES
- VARIOUS COUNTIES

FILE NAME =	USER NAME = mccordkr	DESIGNED -	REVISED -
e:\pwwork\pwwork\mccordkr\10371602\78396-sh1-plan.dgn		DRAWN -	REVISED -
Default	PLOT SCALE = 100.0000' / in.	CHECKED -	REVISED -
	PLOT DATE = 12/8/2014	DATE -	REVISED -

**STATE OF ILLINOIS
DEPARTMENT OF TRANSPORTATION**

LOCATION 4 GUARDRAIL DETAILS - STA. 104 + 60			
SCALE:	SHEET	OF	SHEETS
	STA.	TO	STA.

F.A. RTE.	SECTION	COUNTY	TOTAL SHEETS	SHEET NO.
•	D9 SAFETY 2014-2	••	17	17
			CONTRACT NO. 78396	
ILLINOIS FED. AID PROJECT				