

SUMMARY OF QUANTITIES			URBAN TOTAL QUANTITIES	CONSTRUCTION TYPE CODE				
CODE NO	ITEM	UNIT		BRIDGE 0013 80% FED 20% STATE				
* 78100100	RAISED REFLECTIVE PAVEMENT MARKER	EACH	20	20				
* 78100300	REPLACEMENT REFLECTOR	EACH	77	77				
* 78200011	BARRIER WALL REFLECTORS, TYPE C	EACH	6	6				
78300200	RAISED REFLECTIVE PAVEMENT MARKER REMOVAL	EACH	26	26				
X0326766	CLEAN & RESEAL RELIEF JOINT	FOOT	58.5	58.5				
X0327980	PAVEMENT MARKING REMOVAL - WATER BLASTING	SO FT	1106	1106				
X7010216	TRAFFIC CONTROL AND PROTECTION, (SPECIAL)	L SUM	1	1				
X7030005	TEMPORARY PAVEMENT MARKING REMOVAL	SO FT	1409	1409				
Z0001800	APPROACH SLAB REPAIR (PARTIAL DEPTH)	SO YD	19	19				
Z0004562	COMBINATION CONCRETE CURB AND GUTTER REMOVAL AND REPLACEMENT	FOOT	52	52				
Z0006012	BRIDGE DECK LATEX CONCRETE OVERLAY, 2 1/4 INCHES	SO YD	336	336				
Z0012130	BRIDGE DECK SCARIFICATION 3/4"	SO YD	360	360				

SUMMARY OF QUANTITIES			URBAN TOTAL QUANTITIES	CONSTRUCTION TYPE CODE				
CODE NO	ITEM	UNIT		BRIDGE 0013 80% FED 20% STATE				
Z0012754	STRUCTURAL REPAIR OF CONCRETE (DEPTH EQUAL TO OR LESS THAN 5 INCHES)	SO FT	464	464				
Z0016002	DECK SLAB REPAIR (FULL DEPTH, TYPE II)	SO YD	1	1				
Z0030850	TEMPORARY INFORMATION SIGNING	SO FT	102.8	102.8				
Z0041895	POLYMER CONCRETE	CU FT	3.2	3.2				
Z0001905	STRUCTURAL STEEL REPAIR	POUND	43	43				
Z00113798	CONSTRUCTION LAYOUT	L SUM	1	1				

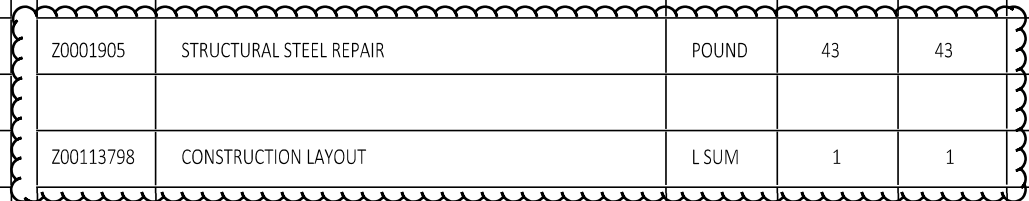

REV. - MS

△ REV. 2-21-2020

*- SPECIALITY ITEM

FILE NAME =	USER NAME = khamms	DESIGNED -	REVISED -
pw:\planroom\dtd\111\mof.gov\FW1001\Documents\VDOT\Offices\District\Projects\DI\961\CADData\Design\DI\961-sh-S	DRAWN -	CHECKED -	REVISED -
	PLOT SCALE = 100,0000' / 1in	DATE -	REVISED -
	PLOT DATE = 12/13/2019		

STATE OF ILLINOIS
DEPARTMENT OF TRANSPORTATION

SUMMARY OF QUANTITIES
SCALE: SHEET NO. OF SHEETS STA. TO STA.

F.A.U. RTE.	SECTION	COUNTY	TOTAL SHEETS	SHEET NO.
3512	5835-1-B-1-1	COOK	31	4
CONTRACT NO. 60M90			FED. ROAD DIST. NO. 1 ILLINOIS FED. AID PROJECT	

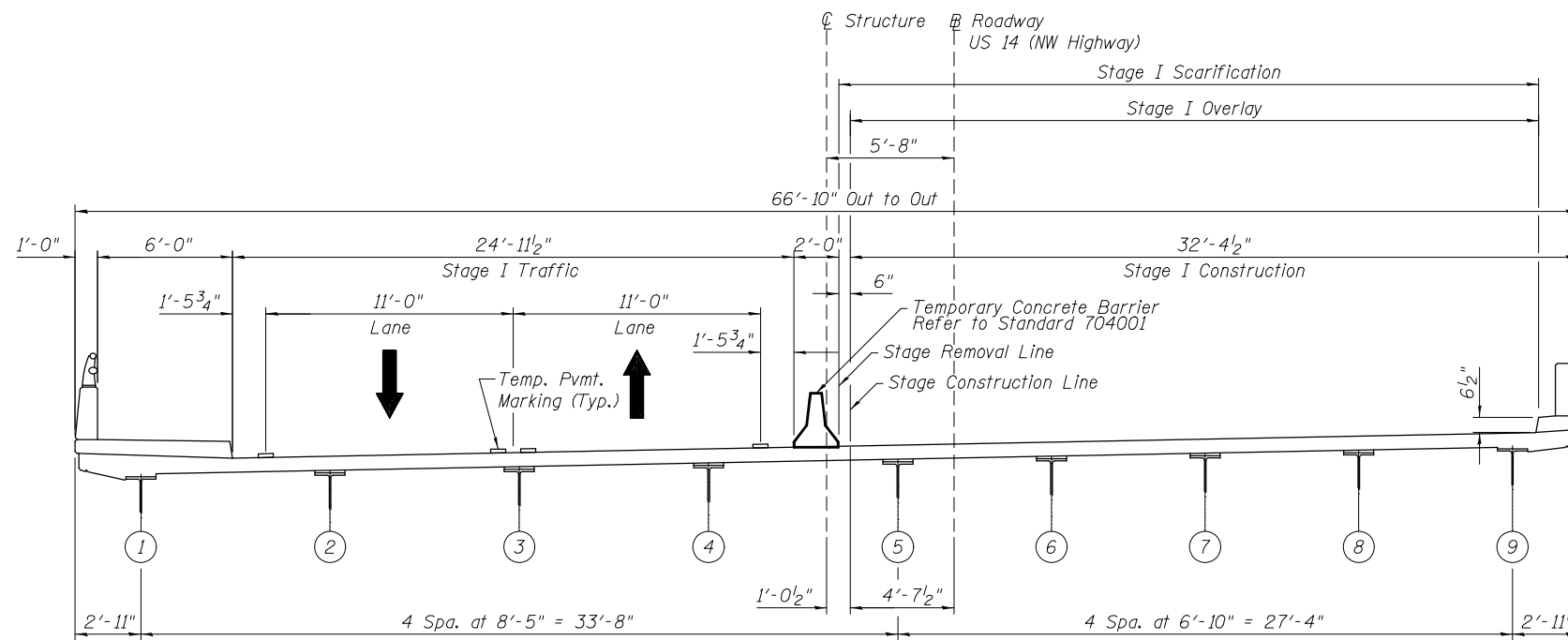

STAGE I CROSS SECTION
Looking East

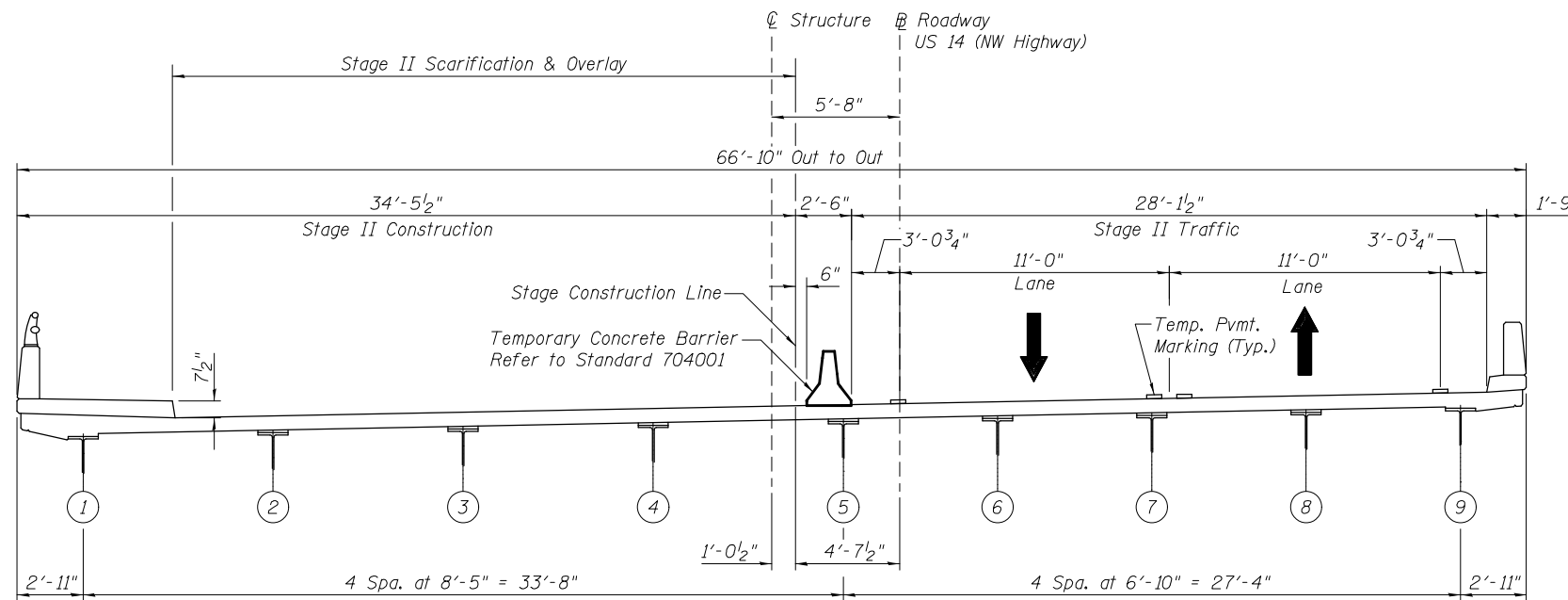

STAGE II CROSS SECTION
Looking East

TOTAL BILL OF MATERIAL

ITEM DESCRIPTION	UNIT	QUANTITY
Bituminous Materials (Tack Coat)	Pound	308
Hot-Mix Asphalt Surface Course Mix "D", N70	Ton	58
Portland Cement Concrete Sidewalk, 5"	Sq. Ft.	300
Sidewalk Removal	Sq. Ft.	300
Concrete Removal	Cu. Yd.	9.2
Concrete Superstructure	Cu. Yd.	10.4
Bridge Deck Grooving	Sq. Yd.	360
Protective Shield	Sq. Yd.	422
Protective Coat	Sq. Yd.	782
Reinforcement Bars, Epoxy Coated	Pound	1,380
Bar Splicers	Each	8
Preformed Joint Strip Seal	Foot	138
Clean and Reseal Relief Joint	Foot	58.5
Approach Slab Repairs (Partial Depth)	Sq. Yd.	19
Deck Slab Repair (Full Depth, Type II)	Sq. Yd.	1
Bridge Deck Latex Concrete Overlay 2 1/4"	Sq. Yd.	366
Bridge Deck Scarification 3/4"	Sq. Yd.	366
Structural Repair of Concrete (Depth Equal to or Less Than 5")	Sq. Ft.	464
Combination Curb and Gutter Removal and Replacement	Foot	52
Polymer Concrete	Cu. Ft.	3.2
Structural Steel Repairs	Pound	42.5

Notes:

The exact number, location, and spacing of all signs and traffic control devices may be adjusted to fit field conditions as directed by the Engineer.
The Contractor will be required to provide and maintain access to all private drives and commercial property during the construction period.
Signing shall be provided for all driveway entrances per District Detail TC-26.

REV. 2-21-2020

DESIGNED - CCC	EXAMINED - <i>Timothy A. ...</i>	DATE - January 31, 2020
CHECKED - ATH	PASSED - <i>Carl ...</i>	REVISED 02/11/2020 VHV
DRAWN - Venkat Reddy		REVISED -
CHECKED - CCC ATH		

STATE OF ILLINOIS
DEPARTMENT OF TRANSPORTATION

STAGE CONSTRUCTION DETAILS
SN 016 - 0236

F.A.U. RTE.	SECTION	COUNTY	TOTAL SHEETS	SHEET NO.
3512	5835-1-B-I-1	COOK	31	13
CONTRACT NO. 60M90				
ILLINOIS FED. AID PROJECT				

SHEET NO. 2 OF 12 SHEETS