

STATE OF ILLINOIS
DEPARTMENT OF TRANSPORTATION

F.A.I. RTE.	SECTION	COUNTY	TOTAL SHEETS	SHEET NO.
57	D-7 BRIDGE REPAIRS 2020-5	COLES	20	1
		ILLINOIS	CONTRACT NO. 74969	

D-97-045-20

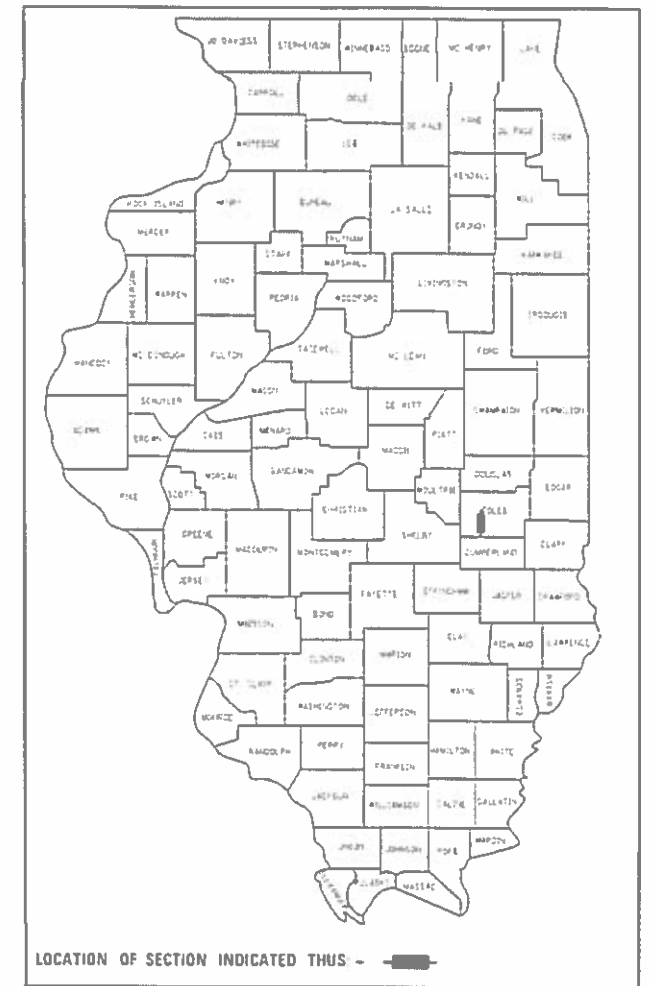

FOR INDEX OF SHEETS, SEE SHEET NO. 2

ADT = 10,200 (2017)

PROPOSED HIGHWAY PLANS

F.A.I. ROUTE 57 (I 57)
SECTION D-7 BRIDGE REPAIRS 2020-5
BRIDGE REPAIRS
COLES COUNTY

C-97-049-20

PROJECT LOCATION:
STRUCTURE *015-0001 &
STRUCTURE *015-0002

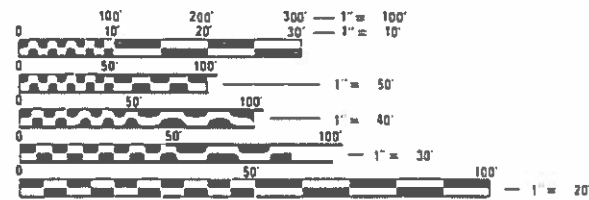
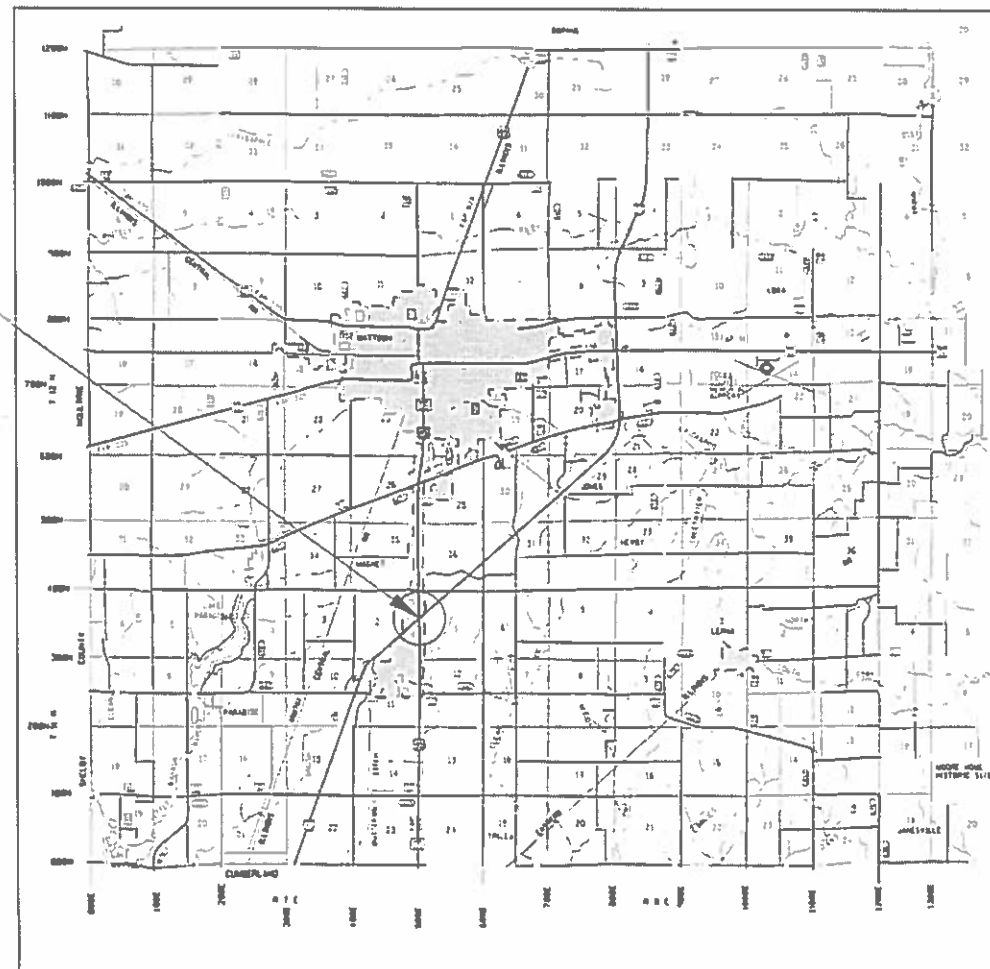

FULL SIZE PLANS HAVE BEEN PREPARED USING STANDARD ENGINEERING SCALES. REDUCED SIZED PLANS WILL NOT CONFORM TO STANDARD SCALES. IN MAKING MEASUREMENTS ON REDUCED PLANS THE ABOVE SCALES MAY BE USED.

J.U.L.I.E.
JOINT UTILITY LOCATION INFORMATION FOR EXCAVATION
1-800-892-0123
OR 811

PROJECT ENGINEER: TOM RONAN
PROJECT MANAGER: BRANDON HEMMEN
PHONE: (217)-342-8320
CONTRACT NO. 74969

GROSS LENGTH = 245 FT. = 0.05 MILE
NET LENGTH = 245 FT. = 0.05 MILE

STATE OF ILLINOIS
DEPARTMENT OF TRANSPORTATION

SUBMITTED DECEMBER 20 2019
Jeffrey P. Myer
REGIONAL ENGINEER

Jan 31 2020
EA. ETS
ENGINEER OF DESIGN AND ENVIRONMENT

Jan 31 2020
Germant, Jan
DIRECTOR OF HIGHWAYS PROJECT IMPLEMENTATION

PRINTED BY THE AUTHORITY
OF THE STATE OF ILLINOIS

INDEX OF SHEETS

SHEET NO.	ITEM
1	COVER SHEET
2	INDEX OF SHEETS AND GENERAL NOTES
3	SUMMARY OF QUANTITIES
4	TYPICAL SECTIONS
5-6	SCHEDULE OF QUANTITIES
7	PLAN SHEET
8	TEMPORARY PAVEMENT MARKING DETAIL
9-11	STAGE I TRAFFIC CONTROL
12-14	STAGE II TRAFFIC CONTROL
15-20	STRUCTURE REPAIR PLANS

THE FOLLOWING STANDARDS ARE A PART OF THESE PLANS AND ARE INCLUDED AFTER SHEET NO. 20:

STD. NO.	DESCRIPTION
000001-07	STANDARD SYMBOLS, ABBREVIATIONS AND PATTERNS
001001-02	AREAS OF REINFORCEMENT BARS
001006	DECIMAL OF AN INCH AND OF A FOOT
420701-03	PAVEMENT WELDED WIRE REINFORCEMENT
642001-02	SHOULDER RUMBLE STRIPS, 16 IN.
701001-02	OFF-ROAD OPERATIONS, 2L, 2W, MORE THAN 15' AWAY
701006-05	OFF-ROAD OPERATIONS, 2L, 2W, 15' TO 24" FROM PAVEMENT EDGE
701101-05	OFF-ROAD OPERATIONS, MULTI-LANE, 15' TO 24" FROM PAVEMENT EDGE
701106-02	OFF-ROAD OPERATIONS, MULTI-LANE, MORE THAN 15' AWAY
701400-09	APPROACH TO LANE CLOSURE, FREEWAY/EXPRESSWAY
701401-12	LANE CLOSURE, FREEWAY/EXPRESSWAY
701402-12	LANE CLOSURE, FREEWAY/EXPRESSWAY, WITH BARRIER
701426-09	LANE CLOSURE, MULTI-LANE, INTERMITTENT OR MOVING OPER., FOR SPEEDS >= 45 MPH
701601-09	URBAN LANE CLOSURE, MULTILANE, 1W OR 2W WITH NONTRAVERSABLE MEDIAN
701901-08	TRAFFIC CONTROL DEVICES
704001-08	TEMPORARY CONCRETE BARRIER
780001-05	TYPICAL PAVEMENT MARKINGS

GENERAL NOTES

THIS PROJECT IS LOCATED ON FAI 57 IN COLES COUNTY SOUTH OF MATTOON AT STRUCTURE NUMBERS 015-0001 AND 015-0002. THE WORK INCLUDED IN SECTION D-7 BRIDGE REPAIRS 2020-5 CONSISTS OF PCC BASE COURSE, BRIDGE EXPANSION JOINT REPLACEMENT, TRAFFIC CONTROL, PAVEMENT MARKING, AND ANY OTHER WORK NECESSARY TO COMPLETE THE SECTION.

PLAN DIMENSIONS AND DETAILS RELATIVE TO THE EXISTING STRUCTURES HAVE BEEN TAKEN FROM EXISTING PLANS AND ARE SUBJECT TO NOMINAL CONSTRUCTION VARIATIONS. IT SHALL BE THE CONTRACTORS RESPONSIBILITY TO VERIFY DIMENSIONS AND DETAILS IN THE FIELD AND MAKE NECESSARY APPROVED ADJUSTMENTS PRIOR TO CONSTRUCTION OR ORDERING OF MATERIAL. SUCH VARIATIONS SHALL NOT BE CAUSE FOR ADDITIONAL COMPENSATION FOR A CHANGE IN THE SCOPE OF THE WORK. THE CONTRACTOR WILL BE PAID FOR THE QUANTITY FURNISHED AT THE UNIT PRICE BID FOR THE WORK.

THE SAW CUT REQUIRED FOR THE PAVED SHOULDER REMOVAL SHALL BE INCLUDED IN THE COST OF PAVED SHOULDER REMOVAL AND NO ADDITIONAL COMPENSATION WILL BE ALLOWED. ANY EXCAVATION NECESSARY FOR CONSTRUCTION OF THE PCC BASE COURSE WIDENING, 10" SHALL BE INCLUDED IN THE COST OF THE PCC BASE COURSE, 10" AND NO ADDITIONAL COMPENSATION SHALL BE ALLOWED.

FILE NAME =	USER NAME = steffenmk	DESIGNED -	REVISED -	STATE OF ILLINOIS DEPARTMENT OF TRANSPORTATION	INDEX OF SHEETS AND GENERAL NOTES				F.A.I. RTE.	SECTION	COUNTY	TOTAL SHEETS	SHEET NO.
pw:\planroom.dot.illinois.gov\PIDOT\Documents\IDOT Offices\District 7\Projects\74969\DRAWING\CADsheets\0774969-sht-gennote.dwg		CHECKED -	REVISED -		57	D-7 BRIDGE REPAIRS 2020-5	COLES	20	2				
Default	PLOT SCALE = 100.0000' / in.	DATE -	REVISED -		SCALE: N/A SHEET 1 OF 1 SHEETS STA. TO STA.				CONTRACT NO. 74969				
	PLOT DATE = 12/20/2019				ILLINOIS FED. AID PROJECT								

SUMMARY OF QUANTITIES			TOTAL QUANTITIES	CONSTRUCTION TYPE CODE		
CODE NO	ITEM	UNIT		0047 SN 015-0001	0047 SN 015-0002	
35300500	PORTLAND CEMENT CONCRETE BASE COURSE 10"	SO YD	1386	693	693	
42000060	WELDED WIRE REINFORCEMENT	SO YD	1386	693	693	
44004250	PAVED SHOULDER REMOVAL	SO YD	1386	693	693	
50102400	CONCRETE REMOVAL	CU YD	42.3	21.2	21.1	
50300255	CONCRETE SUPERSTRUCTURE	CU YD	42.4	21.2	21.2	
50300300	PROTECTIVE COAT	SO YD	119	59.5	59.5	
50800205	REINFORCEMENT BARS, EPOXY COATED	POUND	4760	2380	2380	
50800515	BAR SPLICERS	EACH	64	32	32	
52000110	PREFORMED JOINT STRIP SEAL	FOOT	212	106	106	
64200116	SHOULDER RUMBLE STRIPS, 16 INCH	FOOT	1539	770	769	
67100100	MOBILIZATION	L SUM	1	0.5	0.5	
70100207	TRAFFIC CONTROL AND PROTECTION, STANDARD	EACH	2	1	1	
	701402					
70100800	TRAFFIC CONTROL AND PROTECTION, STANDARD	L SUM	1	0.5	0.5	
	701401					

SUMMARY OF QUANTITIES			TOTAL QUANTITIES	CONSTRUCTION TYPE CODE		
CODE NO	ITEM	UNIT		0047 SN 015-0001	0047 SN 015-0002	
70102630	TRAFFIC CONTROL AND PROTECTION, STANDARD	L SUM	1	0.5	0.5	
	701601					
70103815	TRAFFIC CONTROL SURVEILLANCE	CAL DA	6	3	3	
70107007	PAVEMENT MARKING BLACKOUT TAPE, 7"	FOOT	1449	725	724	
70107025	CHANGEABLE MESSAGE SIGN	CAL DA	28	14	14	
70300100	SHORT TERM PAVEMENT MARKING	FOOT	88	44	44	
70300150	SHORT TERM PAVEMENT MARKING REMOVAL	SO FT	874	437	437	
70400100	TEMPORARY CONCRETE BARRIER	FOOT	925	462.5	462.5	
70400200	RELOCATE TEMPORARY CONCRETE BARRIER	FOOT	850	425	425	
70600250	IMPACT ATTENUATORS, TEMPORARY (NON-REDIRECTIVE), TEST LEVEL 3	EACH	2	1	1	
70600350	IMPACT ATTENUATORS, RELOCATE (NON-REDIRECTIVE), TEST LEVEL 3	EACH	2	1	1	
Z0005010	HOT-MIX ASPHALT FOR PATCHING POTHOLES (COLD MIX)	TON	1	0.5	0.5	

FILE NAME =	USER NAME = steffenmk	DESIGNED -	REVISED -
p:\planroom.dot.illinois.gov\PIDOT\Documents\IDOT Offices\District 7\Projects\74969\DRAWN\CADsheets\0774969-sht-500.dgn		CHECKED -	REVISED -
Default	PLOT SCALE = 100.0000' / 1in.	DATE -	REVISED -
	PLOT DATE = 12/20/2019		

**STATE OF ILLINOIS
DEPARTMENT OF TRANSPORTATION**

SUMMARY OF QUANTITIES

SCALE: N/A SHEET 1 OF 3 SHEETS STA. TO STA.

F.A.I. RTE.	SECTION	COUNTY	TOTAL SHEETS	SHEET NO.
57	D7 BRIDGE REPAIRS 2020-5	COLES	20	3
ILLINOIS FED. AID PROJECT			CONTRACT NO. 74969	

EXISTING TYPICAL CROSS SECTION

STA. 500+93 TO STA. 508+82 (NB)
STA. 503+10 TO STA. 510+99 (SB)

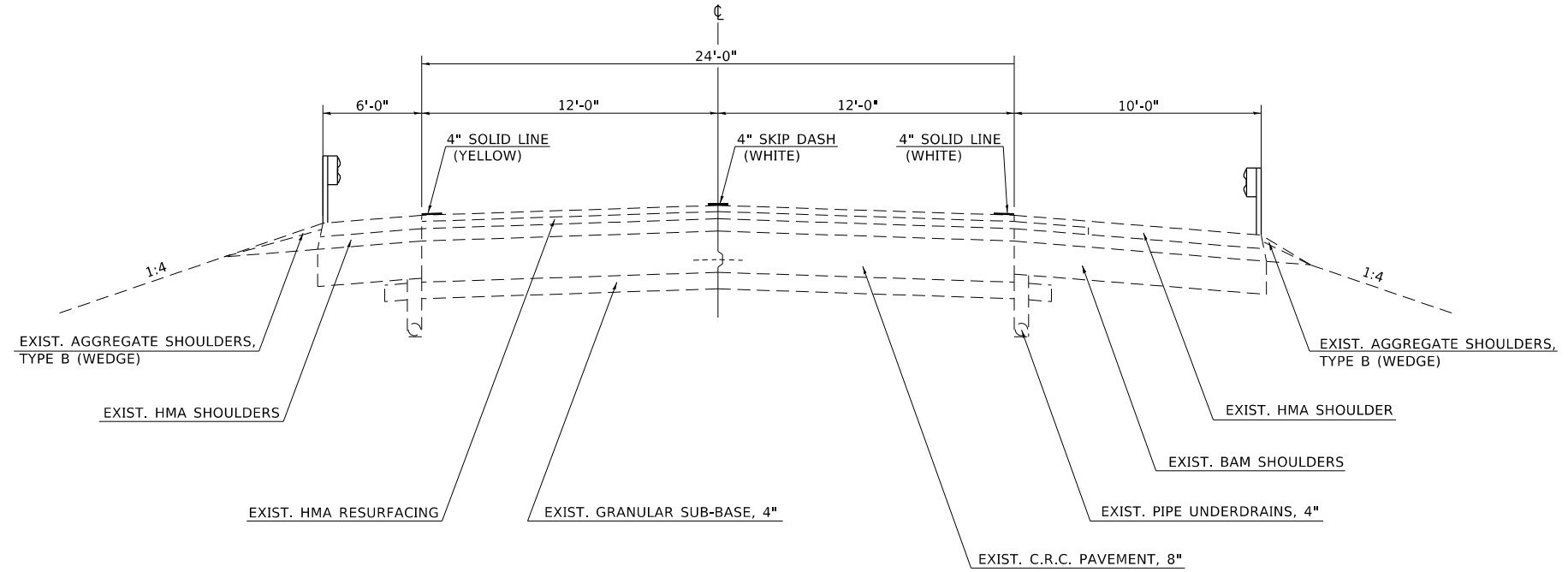

NOTE: NOT TO SCALE

PROPOSED TYPICAL CROSS SECTION

STA. 500+93 TO STA. 508+82 (NB)
STA. 503+10 TO STA. 510+99 (SB)

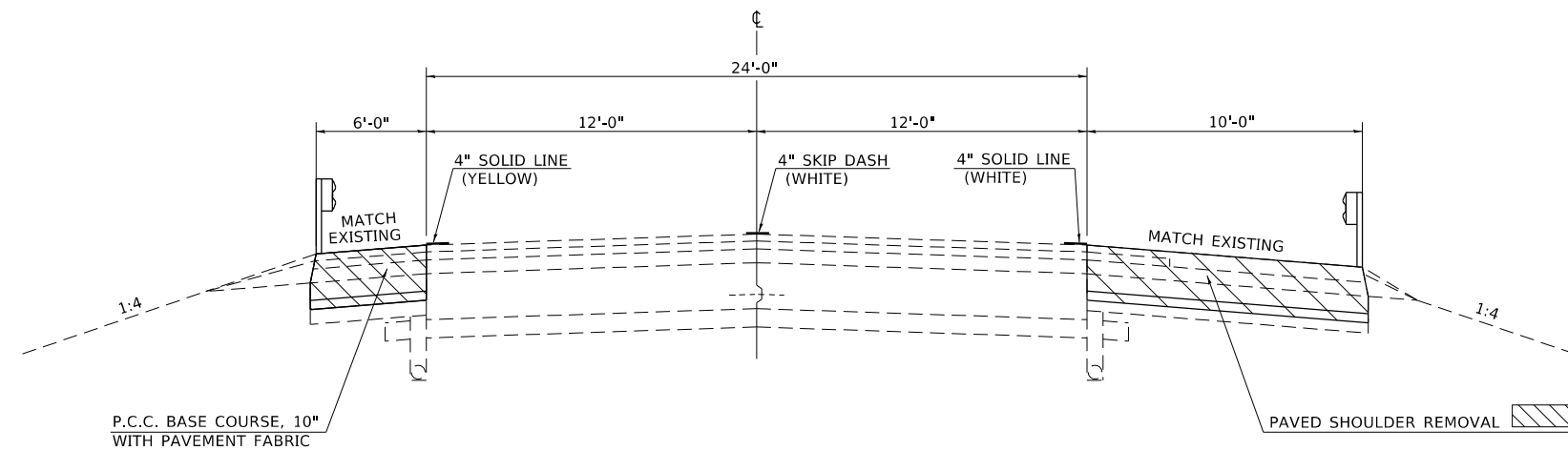

NOTE: NOT TO SCALE

MODEL: Default
 FILE: \\nrcs-pub\pub\harcross\dat\illinois\pwr\DOT\Documents\DOT_Offices\Illinet\7\Projects\74969\CADD\Drawings\74969-sht-typlc-1.dgn

USER NAME = steffenmk	DESIGNED -	REVISED -
	DRAWN -	REVISED -
PLOT SCALE = 100.0000' / in.	CHECKED -	REVISED -
PLOT DATE = 12/20/2019	DATE -	REVISED -

STATE OF ILLINOIS
DEPARTMENT OF TRANSPORTATION

TYPICAL CROSS SECTIONS

SCALE: SHEET OF SHEETS STA. TO STA.

F.A.J. RTE.	SECTION	COUNTY	TOTAL SHEETS	SHEET NO.
57	D-7 BRIDGE REPAIRS 2020-5	COLES	20	4
CONTRACT NO. 74969				
ILLINOIS FED. AID PROJECT				

WIDENING SCHEDULE

STATION TO STATION	PORTLAND CEMENT CONCRETE BASE COURSE, 10"	WELDED WIRE REINFORCEMENT	PAVED SHOULDER REMOVAL	SHOULDER RUMBLE STRIPS, 16"
	SQ YD	SQ YD	SQ YD	FOOT
NB				
501+71 TO 503+96	250.0	250.0	250.0	225.0
507+01 TO 508+81	200.0	200.0	200.0	180.0
502+13 TO 504+21	138.7	138.7	138.7	208.0
507+25 TO 508+82	104.7	104.7	104.7	157.0
NORTH BOUND TOTALS				
	693.3	693.3	693.3	770.0
SB				
503+10 TO 504+67	104.7	104.7	104.7	157.0
507+72 TO 509+80	138.7	138.7	138.7	208.0
503+13 TO 504+91	197.8	197.8	197.8	178.0
507+96 TO 510+22	251.1	251.1	251.1	226.0
SOUTH BOUND TOTALS				
	692.2	692.2	692.2	769.0
TOTAL				
	1386	1386	1386	1539

TRAFFIC CONTROL DEVICES

STATION TO STATION	TEMPORARY CONCRETE BARRIER	RELOCATE TEMPORARY CONCRETE BARRIER	IMPACT ATTENUATORS, TEMPORARY (NON-REDIRECTIVE), TEST LEVEL 3	IMPACT ATTENUATORS, RELOCATE (NON-REDIRECTIVE), TEST LEVEL 3
	FOOT	FOOT	EACH	EACH
STAGE I				
NB				
NB 502+37 TO 504+02	162.5	-	1	-
NB 504+02 TO 507+02	300.0	-	-	-
SB				
SB 504+91 TO 507+91	300.0	-	-	-
SB 507+91 TO 509+55	162.5	-	1	-
STAGE II				
NB				
NB 502+79 TO 504+04	-	125.0	-	1
NB 504+04 TO 507+04	-	300.0	-	-
SB				
SB 504+89 TO 507+89	-	300.0	-	-
SB 507+89 TO 509+14	-	125.0	-	1
TOTALS				
	925	850	2	2

PAVEMENT MARKING SCHEDULE

STATION	TO	STATION	PAVEMENT MARKING BLACKOUT TAPE, 7"	SHORT TERM PAVEMENT MARKING	SHORT TERM PAVEMENT MARKING REMOVAL
			FOOT	FOOT	SQ FT
NB					
487+20	TO	502+20	375.0	-	218.8
502+20	TO	504+08	47.0	20.0	34.1
504+08	TO	504+38	7.5	4.0	5.7
504+38	TO	506+83	245.0	0.0	142.9
506+83	TO	507+13	7.5	4.0	5.7
507+13	TO	508+82	42.3	16.0	29.8
NORTH BOUND TOTALS			724.3	44.0	437.0
SB					
503+10	TO	504+78	42.0	16.0	29.8
504+78	TO	505+08	7.5	4.0	5.7
505+08	TO	507+53	245.0	0.0	142.9
507+53	TO	507+83	7.5	4.0	5.7
507+83	TO	509+72	47.3	20.0	34.2
509+72	TO	524+72	375.0	-	218.8
SOUTH BOUND TOTALS			724.3	44.0	437.1
TOTAL			1449	88	874

MODEL: Default
 FILE: \\msc01\pub\baronm.dwg
 PROJECT: \\msc01\pub\baronm.dwg
 OFFICE: \\msc01\pub\baronm.dwg
 DATE: 12/20/2019

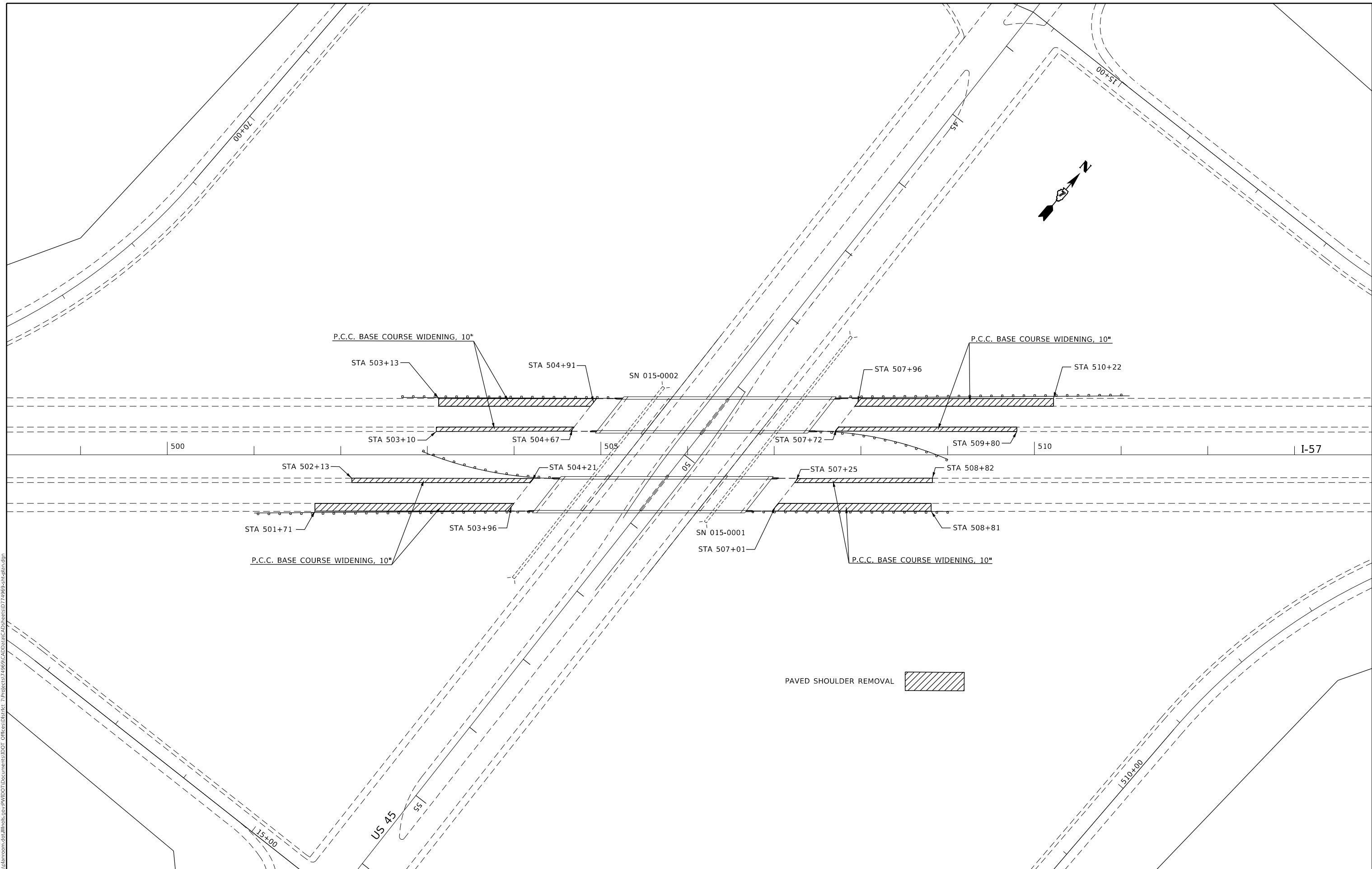

USER NAME = steffemk	DESIGNED -	REVISED -
	DRAWN -	REVISED -
PLOT SCALE = 100.0000' / in.	CHECKED -	REVISED -
PLOT DATE = 12/20/2019	DATE -	REVISED -

STATE OF ILLINOIS
DEPARTMENT OF TRANSPORTATION

PLAN	
SCALE:	SHEET OF SHEETS STA. TO STA.

F.A.J. RTE.	SECTION	COUNTY	TOTAL SHEETS	SHEET NO.
57	D-7 BRIDGE REPAIRS 2020-5	COLES	20	7
CONTRACT NO. 74969				
ILLINOIS FED. AID PROJECT				

TEMPORARY PAVEMENT MARKING DETAIL
 NBL LOOKING NORTH & SBL LOOKING SOUTH

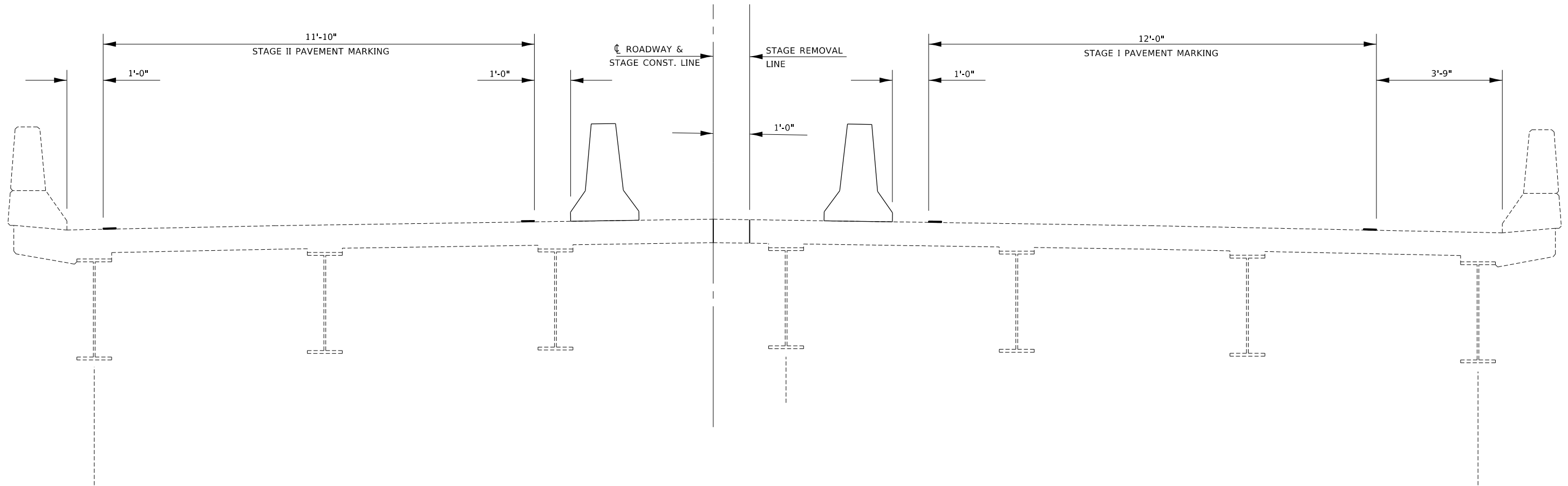

NOTE:
 ALL TEMPORARY PAVEMENT MARKING AND ITS REMOVAL
 SHALL BE INCLUDED IN THE COST OF TRAFFIC CONTROL
 AND PROTECTION, STANDARD 701402

NOTE: NOT TO SCALE

MODEL: Default
 FILE: h:\m\c\p\pub\baronm.d\at\illinois.gov\PI\DOT\Documents\DOT_Offices\District_7\Projects\74969\CADD\Drawings\74969-std-plan.dgn

USER NAME = steffenmk	DESIGNED -	REVISED -
	DRAWN -	REVISED -
PLOT SCALE = 100.0000 ' / in.	CHECKED -	REVISED -
PLOT DATE = 12/20/2019	DATE -	REVISED -

STATE OF ILLINOIS
 DEPARTMENT OF TRANSPORTATION



TEMPORARY PAVEMENT MARKING DETAIL

SCALE: SHEET OF SHEETS STA. TO STA.

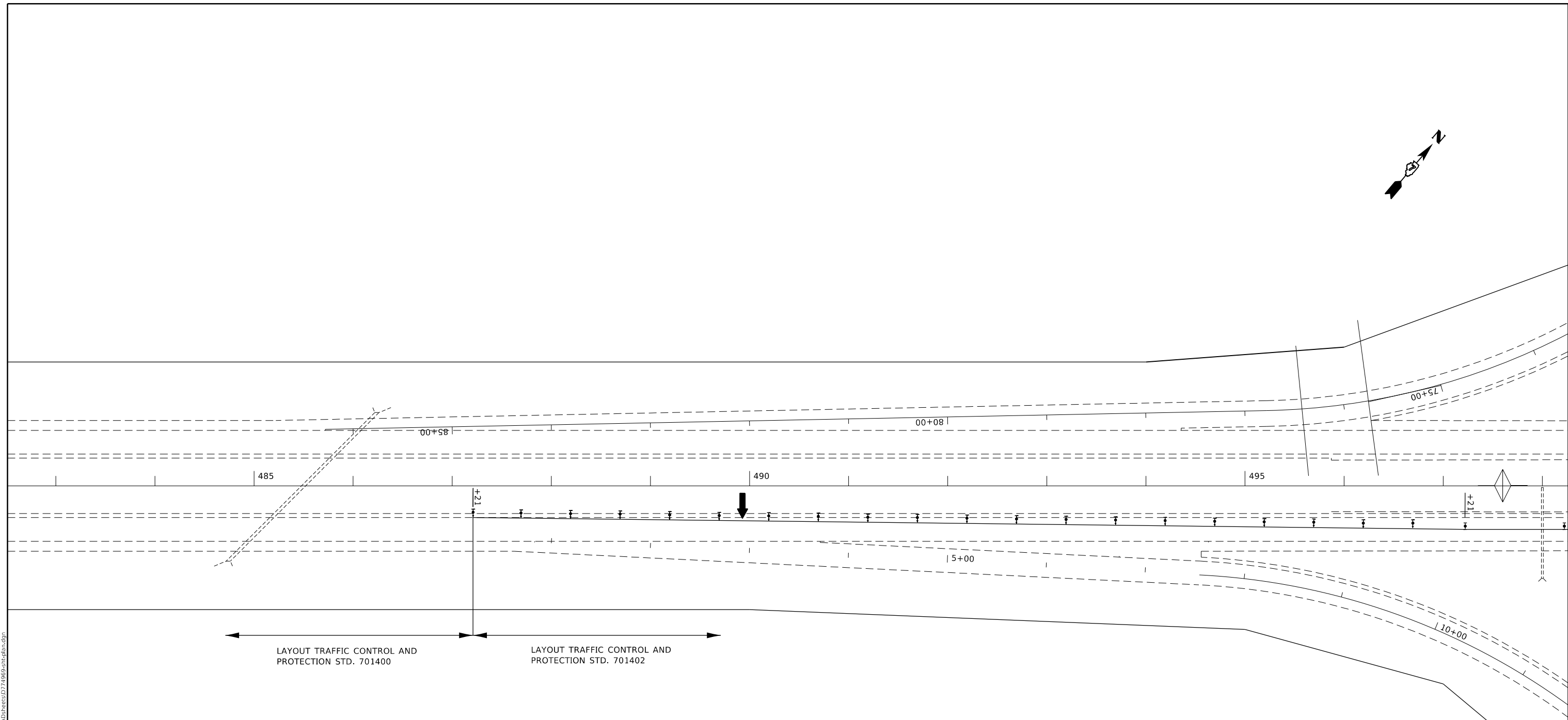
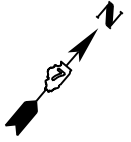
F.A.J. RTE.	SECTION	COUNTY	TOTAL SHEETS	SHEET NO.
57	D-7 BRIDGE REPAIRS 2020-5	COLES	20	8
CONTRACT NO. 74969				
ILLINOIS		FED. AID PROJECT		



LEGEND

-  DIRECTIONAL INDICATOR BARRICADE W/STEADY BURN MONODIRECTIONAL LIGHT
-  TYPE II BARRICADE DRUM OR VERTICAL BARRICADE W/STEADY BURN MONODIRECTIONAL LIGHT
-  ARROW BOARD

MODEL: Default
 FILE: \\nrcs-pub\pub\rooms\dat\illinois\pwr\WIDOT\Documents\DOT_Offices\District_7\Projects\74969\CADD\Drawings\74969-std\plan.dgn

USER NAME = steffenmk	DESIGNED -	REVISED -
	DRAWN -	REVISED -
PLOT SCALE = 100.0000' / in.	CHECKED -	REVISED -
PLOT DATE = 12/20/2019	DATE -	REVISED -

**STATE OF ILLINOIS
DEPARTMENT OF TRANSPORTATION**



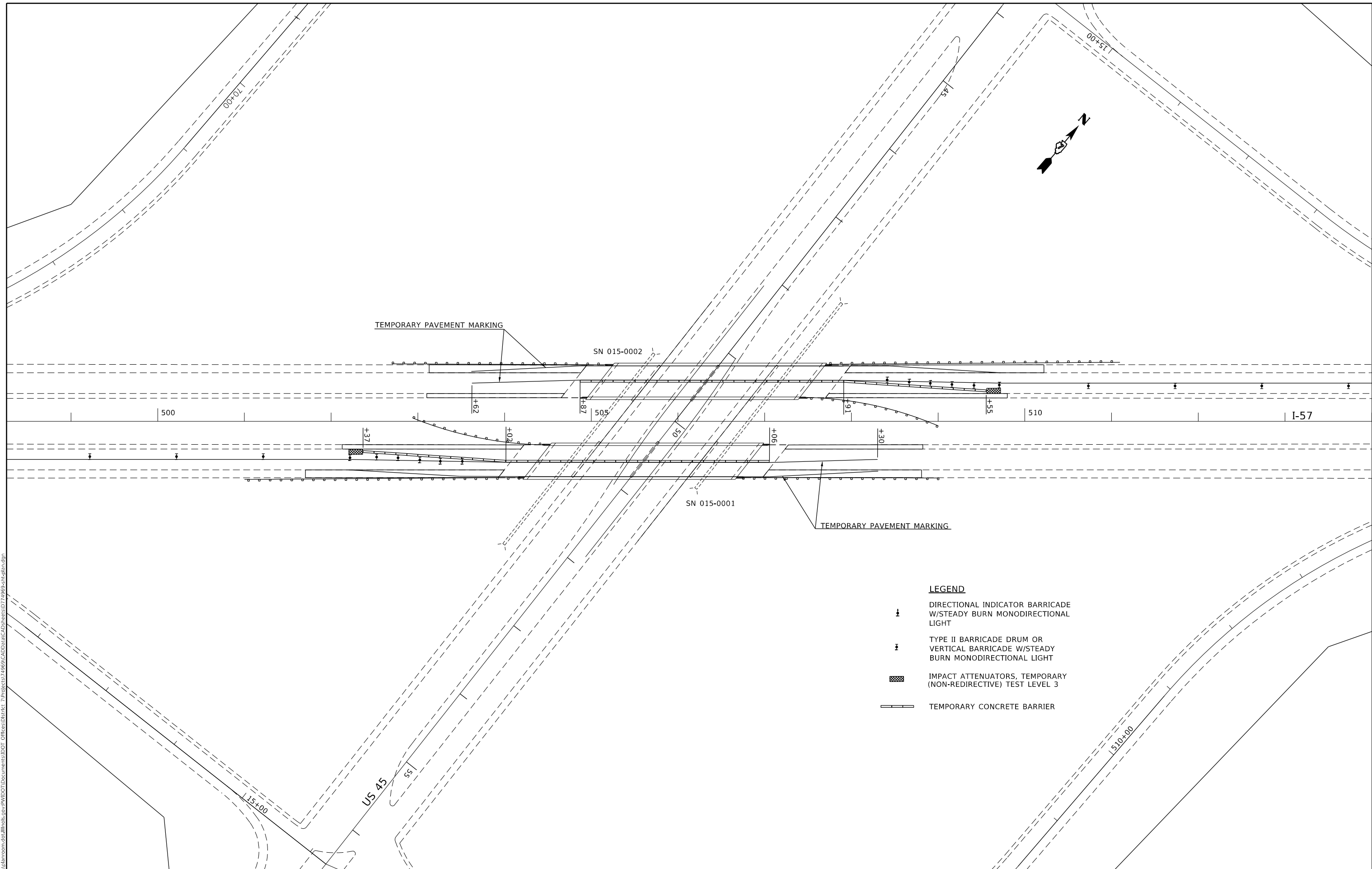

STAGE I TRAFFIC CONTROL			
SCALE:	SHEET	OF	SHEETS
	STA.	TO	STA.

F.A.J. RTE.	SECTION	COUNTY	TOTAL SHEETS	SHEET NO.
57	D-7 BRIDGE REPAIRS 2020-5	COLES	20	9
ILLINOIS FED. AID PROJECT			CONTRACT NO. 74969	

MODEL: Default
 FILE: h:\m\c\p\suplanroom.d\at\illinois.gov\PIWDOT\Documents\DOT_Offices\District 7\Projects\74969\CADD\DATA\CAD\chests\074969-sht-plan.dgn



LEGEND

-  DIRECTIONAL INDICATOR BARRICADE W/STEADY BURN MONODIRECTIONAL LIGHT
-  TYPE II BARRICADE DRUM OR VERTICAL BARRICADE W/STEADY BURN MONODIRECTIONAL LIGHT
-  IMPACT ATTENUATORS, TEMPORARY (NON-REDIRECTIVE) TEST LEVEL 3
-  TEMPORARY CONCRETE BARRIER

USER NAME = steffemk	DESIGNED -	REVISED -
	DRAWN -	REVISED -
PLOT SCALE = 100.0000' / in.	CHECKED -	REVISED -
PLOT DATE = 12/20/2019	DATE -	REVISED -

**STATE OF ILLINOIS
 DEPARTMENT OF TRANSPORTATION**

STAGE I TRAFFIC CONTROL

SCALE: SHEET OF SHEETS STA. TO STA.

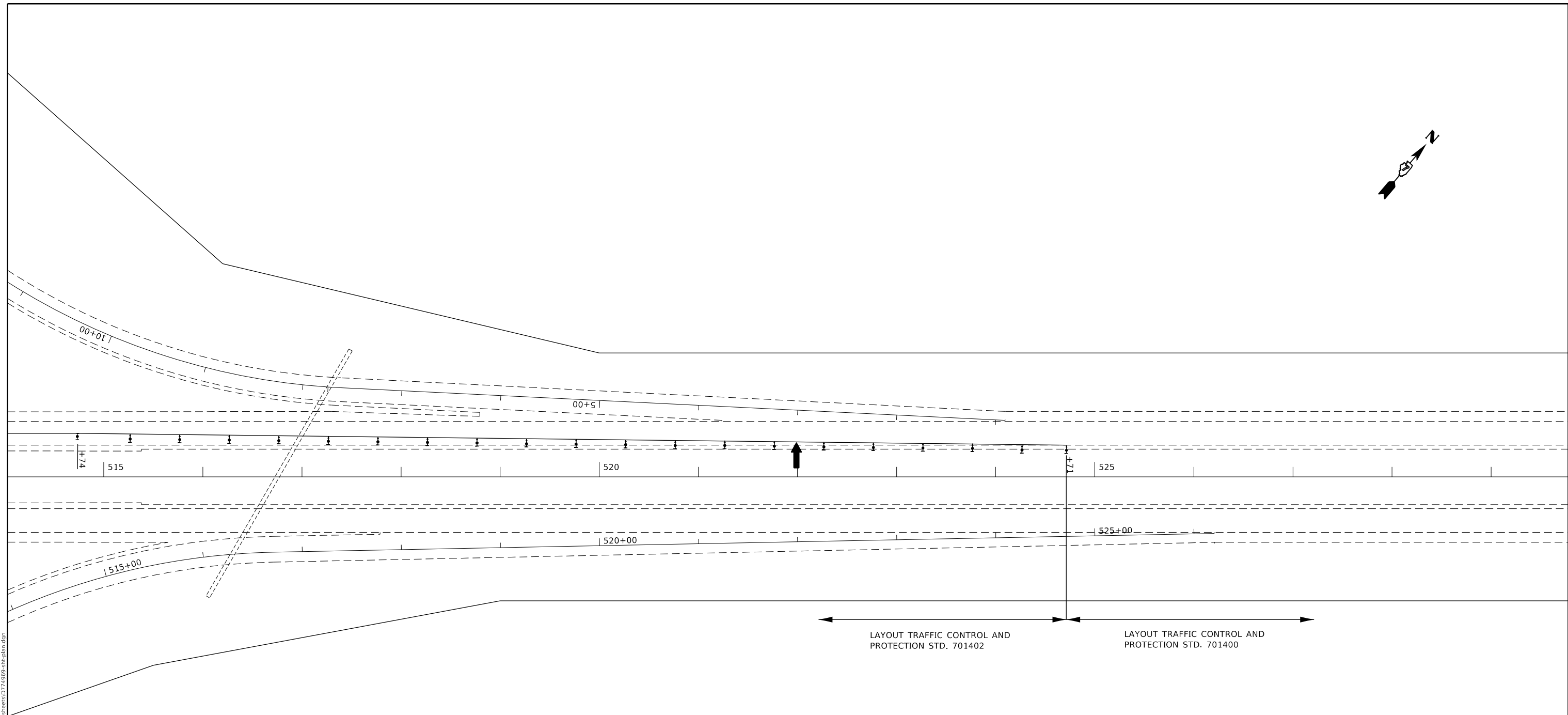
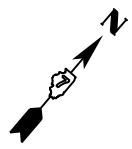

F.A.J. RTE.	SECTION	COUNTY	TOTAL SHEETS	SHEET NO.
57	D-7 BRIDGE REPAIRS 2020-5	COLES	20	10
ILLINOIS FED. AID PROJECT			CONTRACT NO. 74969	



← LAYOUT TRAFFIC CONTROL AND PROTECTION STD. 701402

→ LAYOUT TRAFFIC CONTROL AND PROTECTION STD. 701400

LEGEND

-  DIRECTIONAL INDICATOR BARRICADE W/STEADY BURN MONODIRECTIONAL LIGHT
-  TYPE II BARRICADE DRUM OR VERTICAL BARRICADE W/STEADY BURN MONODIRECTIONAL LIGHT
-  ARROW BOARD

MODEL: Default
 FILE: \\nlsr01\pub\baronm.dwg
 ILLINOIS STATE ROAD & TRANSPORTATION DEPARTMENT
 PROJECT: 74969
 SHEET: 11 OF 20
 DATE: 12/20/2019

USER NAME = steffenmk	DESIGNED -	REVISED -
	DRAWN -	REVISED -
PLOT SCALE = 100.0000' / in.	CHECKED -	REVISED -
PLOT DATE = 12/20/2019	DATE -	REVISED -

**STATE OF ILLINOIS
DEPARTMENT OF TRANSPORTATION**

STAGE I TRAFFIC CONTROL

SCALE: SHEET OF SHEETS STA. TO STA.

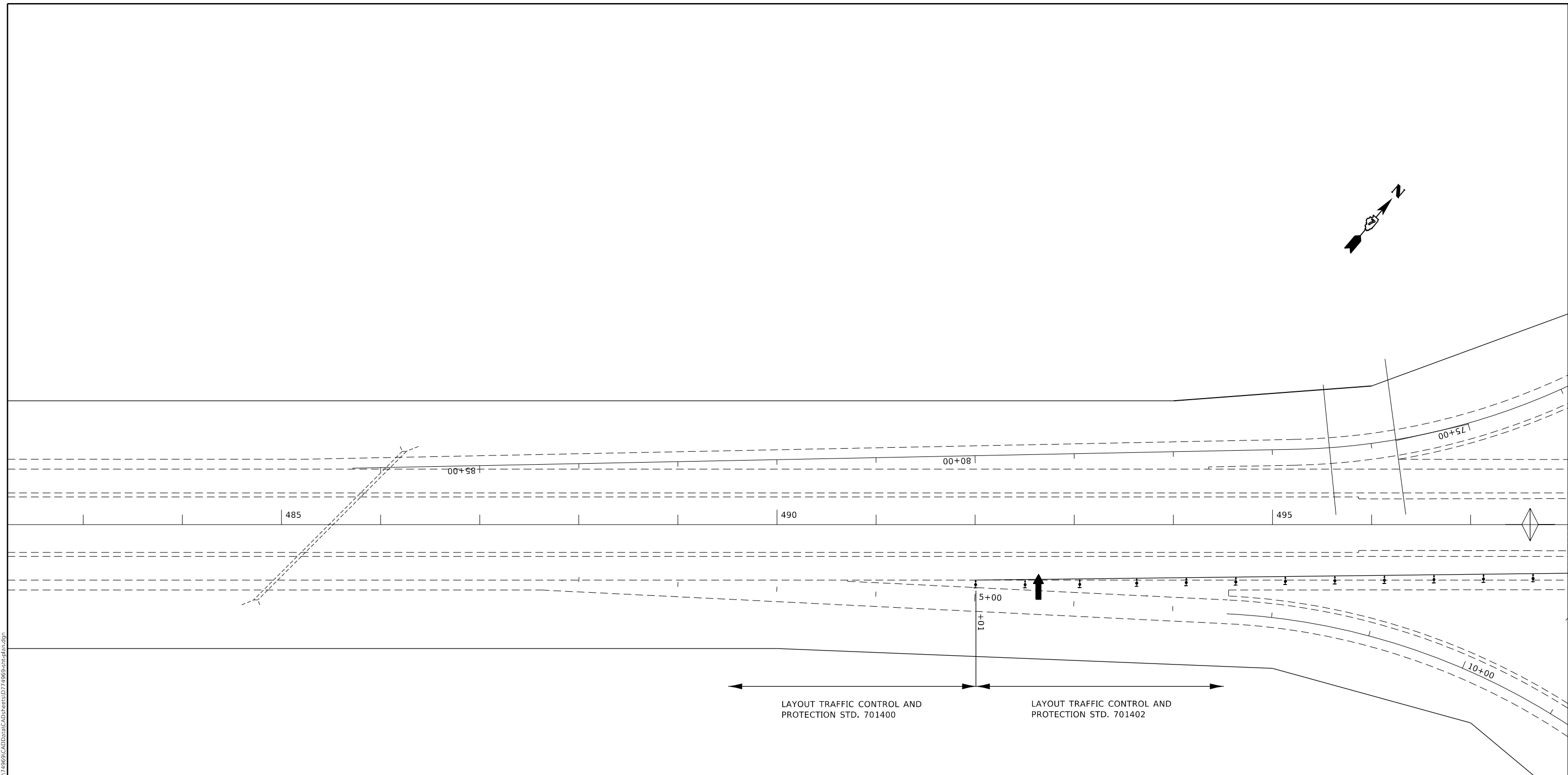
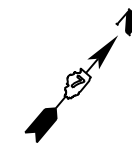

F.A.J. RTE.	SECTION	COUNTY	TOTAL SHEETS	SHEET NO.
57	D-7 BRIDGE REPAIRS 2020-5	COLES	20	11
ILLINOIS FED. AID PROJECT			CONTRACT NO. 74969	



LAYOUT TRAFFIC CONTROL AND PROTECTION STD. 701400

LAYOUT TRAFFIC CONTROL AND PROTECTION STD. 701402

LEGEND

-  DIRECTIONAL INDICATOR BARRICADE W/STEADY BURN MONODIRECTIONAL LIGHT
-  ARROW BOARD

MODEL: Default
 FILE: \\nlsdc-pub\pub\room\dat\illinois\pwr\WIDOT\Documents\DOT_Offices\Dir\ctc_7\Project\74969\CAAD\shc\shc.dgn

USER NAME = steffenmk	DESIGNED -	REVISED -
	DRAWN -	REVISED -
PLOT SCALE = 100.0000 ' / in.	CHECKED -	REVISED -
PLOT DATE = 12/20/2019	DATE -	REVISED -

**STATE OF ILLINOIS
DEPARTMENT OF TRANSPORTATION**

STAGE II TRAFFIC CONTROL

SCALE: SHEET OF SHEETS STA. TO STA.

F.A.J. RTE.	SECTION	COUNTY	TOTAL SHEETS	SHEET NO.
57	D-7 BRIDGE REPAIRS 2020-5	COLES	20	12
ILLINOIS FED. AID PROJECT			CONTRACT NO. 74969	

MODEL: Default
 FILE: h:\mhc\p\suplanroom.d\illinois.gov\PIWIDOT\Documents\DOT_Offices\IDirect_7\Projects\74969\CADD\DATA\CAD\sheets\ID74969-shc-plan.dgn

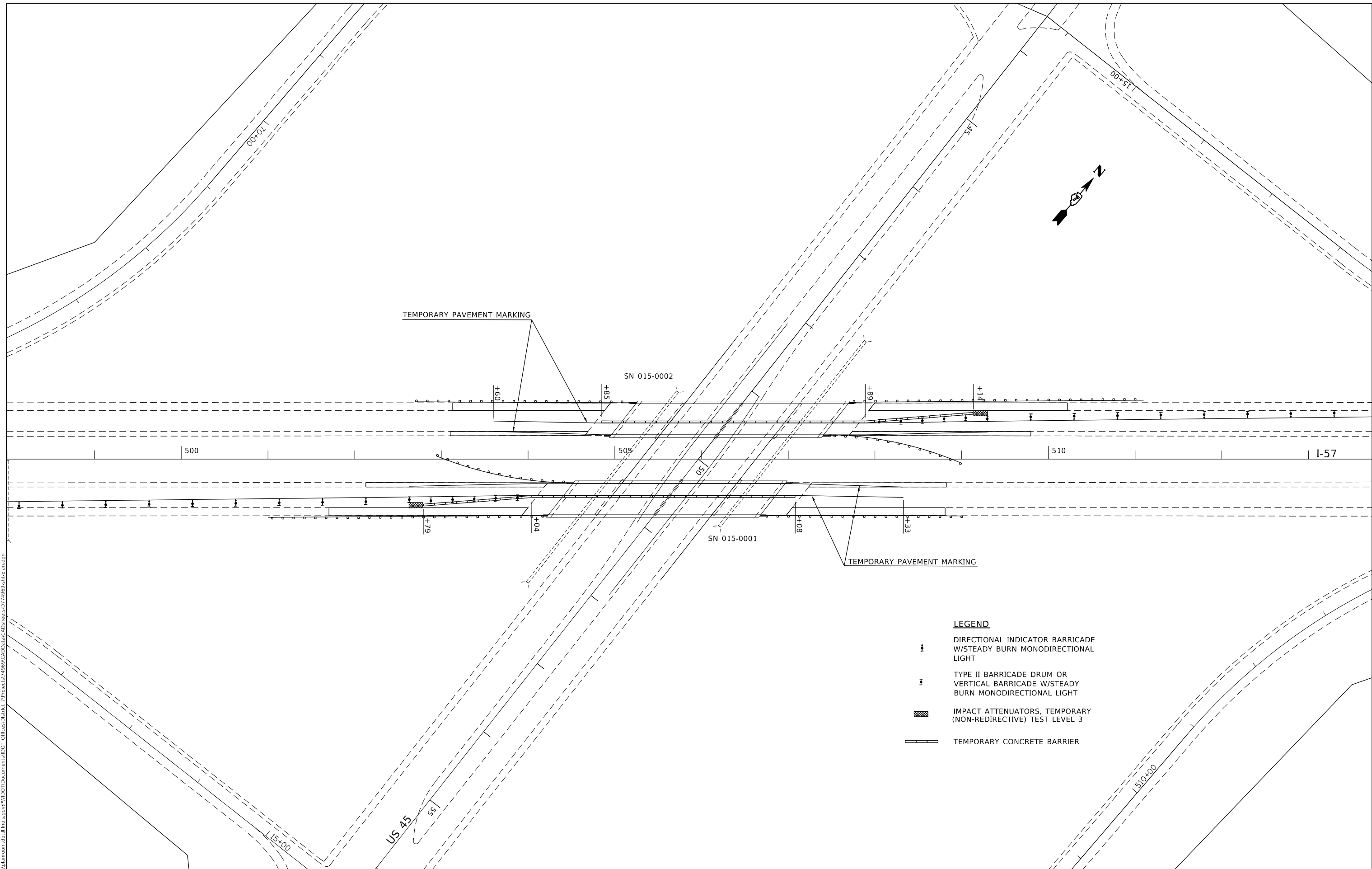

LEGEND

- DIRECTIONAL INDICATOR BARRICADE W/STEADY BURN MONODIRECTIONAL LIGHT
- TYPE II BARRICADE DRUM OR VERTICAL BARRICADE W/STEADY BURN MONODIRECTIONAL LIGHT
- IMPACT ATTENUATORS, TEMPORARY (NON-REDIRECTIVE) TEST LEVEL 3
- TEMPORARY CONCRETE BARRIER

USER NAME = steffemk	DESIGNED -	REVISD -
	DRAWN -	REVISD -
PLOT SCALE = 100.0000 ' / in.	CHECKED -	REVISD -
PLOT DATE = 12/20/2019	DATE -	REVISD -



**STATE OF ILLINOIS
 DEPARTMENT OF TRANSPORTATION**

STAGE II TRAFFIC CONTROL

SCALE: SHEET OF SHEETS STA. TO STA.

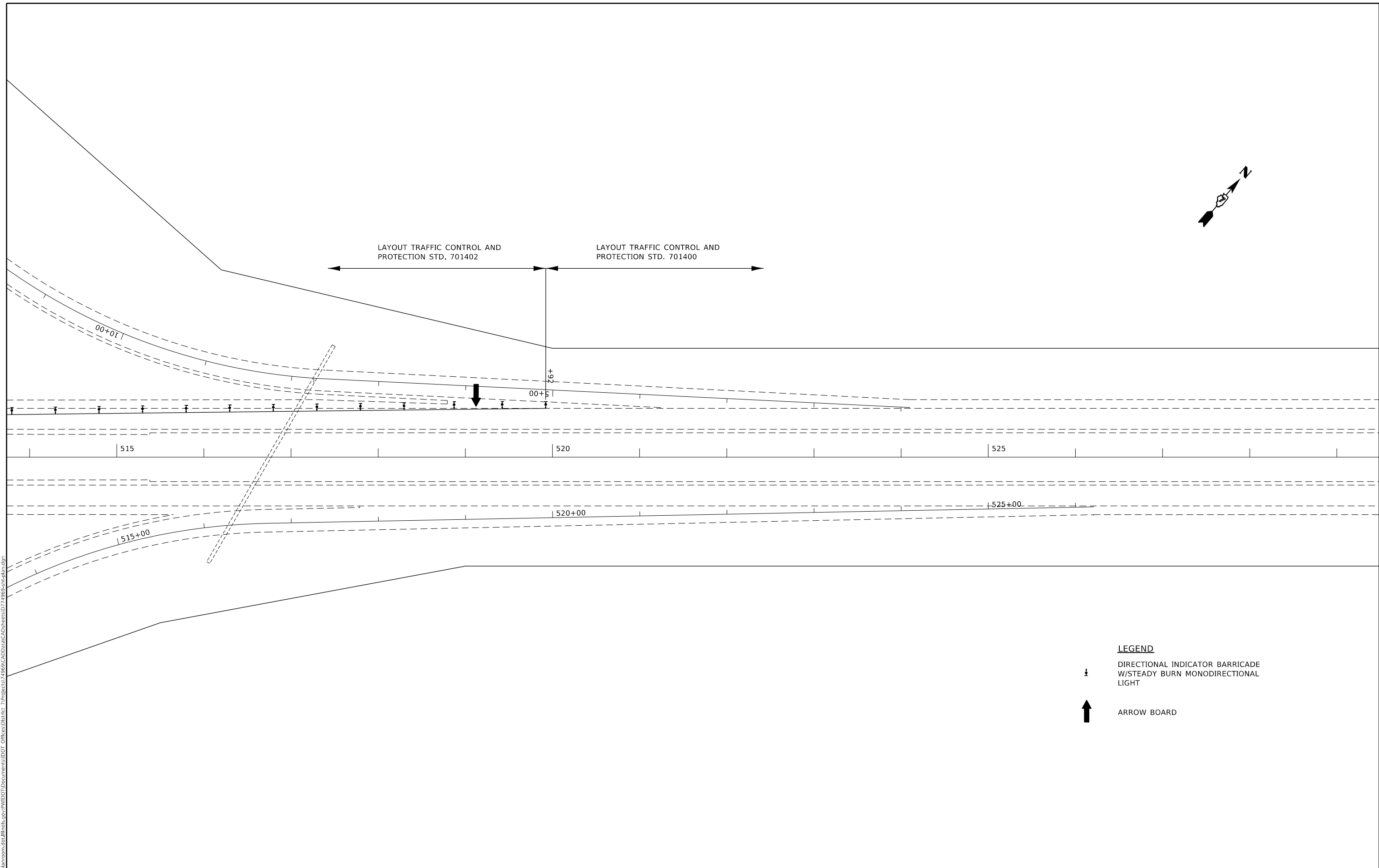
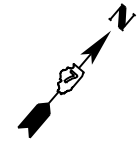
F.A.J. RTE.	SECTION	COUNTY	TOTAL SHEETS	SHEET NO.
57	D-7 BRIDGE REPAIRS 2020-5	COLES	20	13
CONTRACT NO. 74969				
ILLINOIS FED. AID PROJECT				



- LEGEND**
-  DIRECTIONAL INDICATOR BARRICADE W/STEADY BURN MONODIRECTIONAL LIGHT
 -  ARROW BOARD

MODEL: Default
 FILE: \\blm1c:\pub\blmroom\dat\illinois\pwr\DOT\Documents\DOT_Offices\Director_7\Projects\74969\CADD\data\CAD\Sheets\174969-std\plan.dgn

USER NAME = steffenmk	DESIGNED -	REVISED -
	DRAWN -	REVISED -
PLOT SCALE = 100.0000' / in.	CHECKED -	REVISED -
PLOT DATE = 12/20/2019	DATE -	REVISED -

**STATE OF ILLINOIS
DEPARTMENT OF TRANSPORTATION**

STAGE II TRAFFIC CONTROL				
SCALE:	SHEET	OF	SHEETS	STA. TO STA.

F.A.J. RTE.	SECTION	COUNTY	TOTAL SHEETS	SHEET NO.
57	D-7 BRIDGE REPAIRS 2020-5	COLES	20	14
ILLINOIS FED. AID PROJECT			CONTRACT NO. 74969	

The existing four-span, continuous steel multi-beam dual structures carry I-57 over US-45. Existing S.N. 015-0001(NB) & 015-0002(SB) were built in 1963 as FAI Rte. 57, Section 15-22HB. The structures were reconstructed with new bridge decks in 2000 as section (15-22HB,VB-1,HB-5)BR.

The proposed project consists of replacement of existing expansion joints with new strip seal joint assemblies, and other associated work.

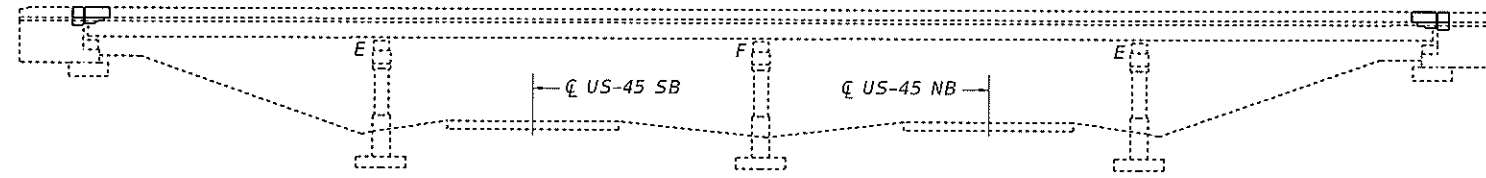

ELEVATION

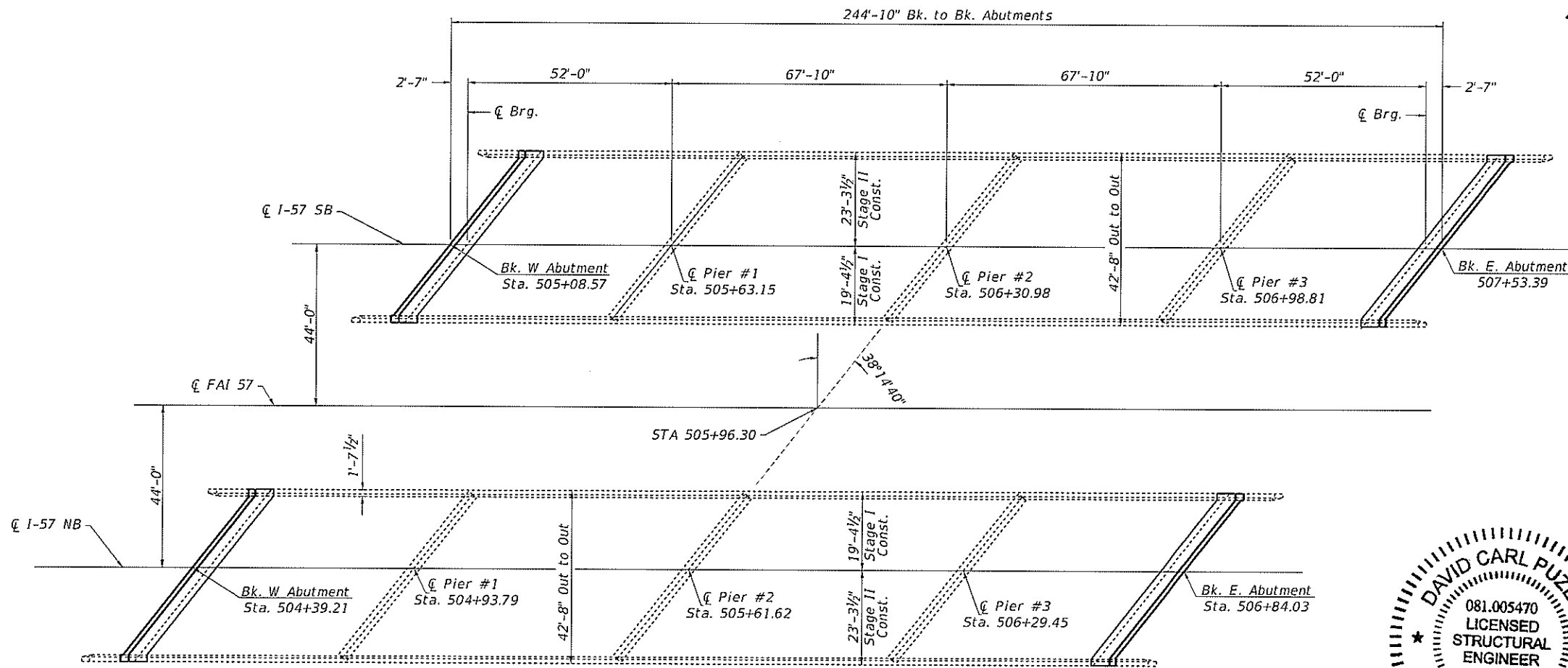

PLAN

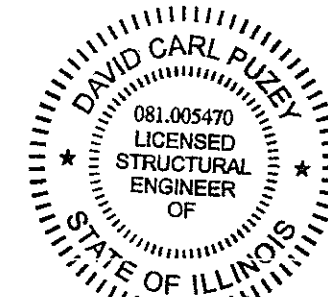
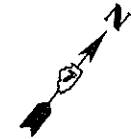

David Carl Puzey 4/27/2020
Expires 11/30/2020

MODEL: Default
 PLOT DATE: 12/20/2019
 PLOT SCALE: 1/8" = 100.0000' / 1 in.
 CHECKED: D. Macklin
 DATE: 12/3/2019
 DESIGNED: T. Walk
 DRAWN: T. Walk
 REVISIONS: D. Macklin
 USER: steffewrk
 PROJECT: 174969-CA02Data2-015-0002(SB) sheets 0774969-015-0002(SB).dgn

USER NAME = steffewrk PLOT SCALE = 1/8" = 100.0000' / 1 in. PLOT DATE = 12/20/2019			DESIGNED - T. Walk DRAWN - T. Walk CHECKED - D. Macklin DATE - 12/3/2019			REVISED - D. Macklin REVISED - REVISED - REVISED -			STATE OF ILLINOIS DEPARTMENT OF TRANSPORTATION			GENERAL PLAN AND ELEVATION STRUCTURE NO. 015-0001(NB) & 015-0002(SB)			F.A.I. RTE. 57		SECTION D7 BRIDGE REPAIRS 2020-5		COUNTY COLES		TOTAL SHEETS 20		SHEET NO. 15	
SCALE:			SHEET 1 OF 6 SHEETS			STA. TO STA.			ILLINOIS			FED. AID PROJECT			CONTRACT NO. 74969									

GENERAL NOTES

Plan dimensions and details relative to existing plans are subject to nominal construction variations. The Contractor shall field verify existing dimensions and details affecting new construction and make necessary approved adjustments prior to construction or ordering of materials. Such variations shall not be cause for additional compensation for a change in scope of the work, however, the Contractor will be paid for the quantity actually furnished at the unit price bid for the work.

Reinforcement Bars designated (E) shall be epoxy coated.

Existing reinforcement bars extending into the removal area shall be cleaned, straightened and incorporated into the new construction. Any reinforcement bars that are damaged during concrete removal operations shall be replaced using an approved bar splicer or anchorage system. Cost included with CONCRETE REMOVAL.

Joint openings shall be adjusted according to Article 520.04 of the Standard Specifications when the deck is poured at an ambient temperature other than 50°F.

Protective Coat to be applied to areas of new concrete only.

Prior to pouring the new concrete deck, all heavy or loose rust, loose mill scale, and other loose or potentially detrimental foreign material shall be removed from the surfaces in contact with concrete. Tightly adhered paint may remain unless otherwise noted. Removal shall be accomplished by methods that will not damage the steel and the cost will be included in the pay item covering removal of the existing concrete.

The Name Plate shall be removed from the existing wingwall and embedded into the new wingwall concrete at approximately the same location. This work and all materials shall be included in the contract unit price for Concrete Superstructure.

BILL OF MATERIAL
STRUCTURE 015-0001 & 015-0002

ITEM	UNIT	QUANTITY
Concrete Removal	Cu. Yd.	42.3
Concrete Superstructure	Cu. Yd.	42.4
Reinforcement Bars, Epoxy Coated	Pound	4760
Bar Splicers	Each	64
Performed Joint Strip Seal	Feet	212
Protective Coat	Sq. Yd.	119

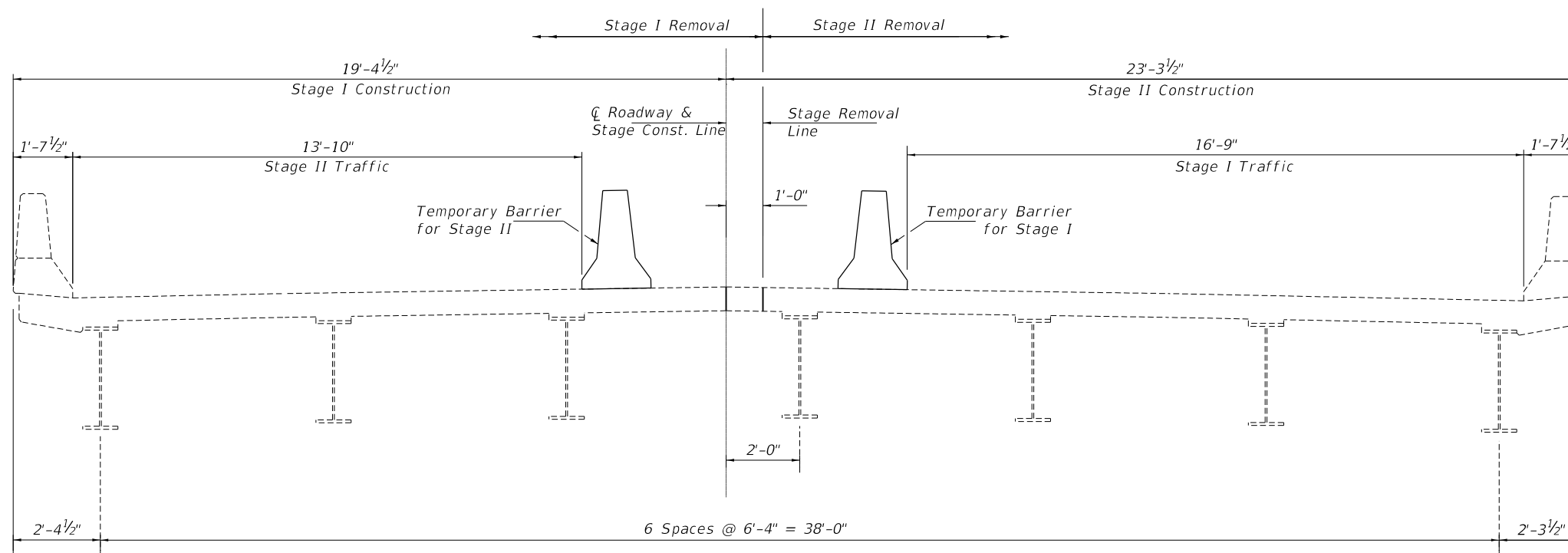

STAGE CONSTRUCTION DETAIL
NBL Looking North & SBL Looking South

MODEL: Default
FILE: Nblsbc_PlanSubplanroom.dwg
I:\Projects\74969\CADD\Drawings\15-0001\15-0002_Repairs.dwg

USER NAME = Default	DESIGNED - T. Walk	REVISED - D. Macklin
	DRAWN - T. Walk	REVISED - _____
PLOT SCALE = 100.0000' / in.	CHECKED - D. Macklin	REVISED - _____
PLOT DATE = 1/27/2020	DATE - 12/3/2019	REVISED - _____

STATE OF ILLINOIS
DEPARTMENT OF TRANSPORTATION

GENERAL NOTES AND BILL OF MATERIALS			
STRUCTURE NO. 015-0001(NB) & 015-0002(SB)			
SCALE: _____	SHEET 2 OF 6 SHEETS	STA. _____ TO STA. _____	

F.A.I. RTE.	SECTION	COUNTY	TOTAL SHEETS	SHEET NO.
57	D7 BRIDGE REPAIRS 2020-5	COLES	20	16
				CONTRACT NO. 74969
				ILLINOIS FED. AID PROJECT

MODEL: Default
 FILE: Abutment_ExpansionJointReplacementDetails.rvt
 PROJECT: 74969/CADD/AbutmentExpansionJointReplacementDetails.rvt
 OFFICE: J:\Projects\74969\CADD\AbutmentExpansionJointReplacementDetails.rvt
 DATE: 1/27/2020

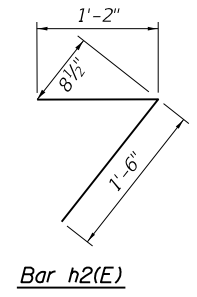
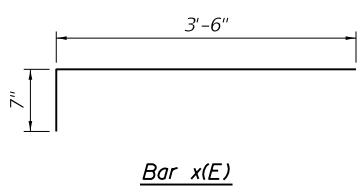
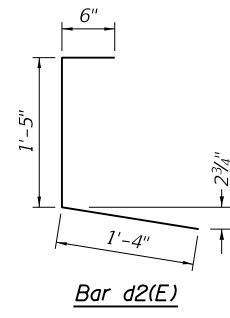
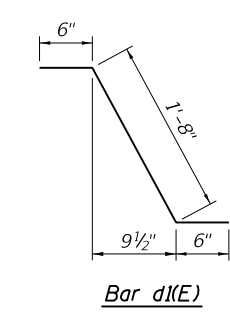
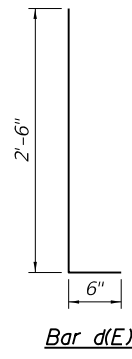
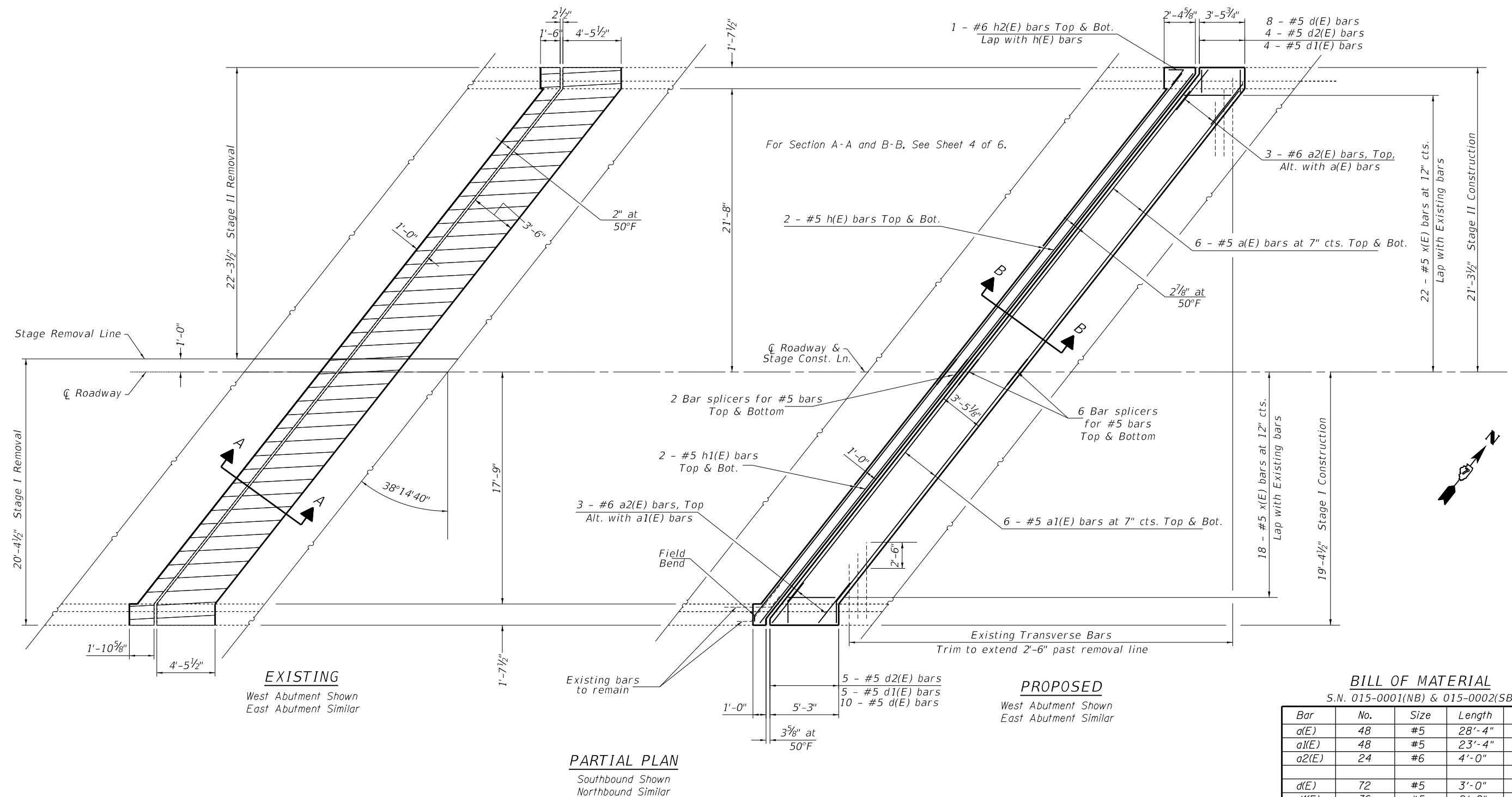

BILL OF MATERIAL
 S.N. 015-0001(NB) & 015-0002(SB)

Bar	No.	Size	Length	Shape
a(E)	48	#5	28'-4"	—
a1(E)	48	#5	23'-4"	—
a2(E)	24	#6	4'-0"	—
d(E)	72	#5	3'-0"	┌
d1(E)	36	#5	2'-8"	┌
d2(E)	36	#5	3'-3"	┌
h(E)	16	#5	28'-10"	—
h1(E)	16	#5	24'-3"	—
h2(E)	8	#5	2'-8"	7
x(E)	160	#5	4'-1"	┌

ITEM	UNIT	QUANTITY
CONCRETE REMOVAL	CU YD	42.3
CONCRETE SUPERSTRUCTURE	CU YD	42.4
REINFORCEMENT BARS (EPOXY COATED)	POUND	4760

USER NAME = Default	DESIGNED - T. Walk	REVISED - D. Macklin
DRAWN - T. Walk	REVISIONS -	
PLOT SCALE = 100.0000' / in.	CHECKED - D. Macklin	REVISIONS -
PLOT DATE = 1/27/2020	DATE - 12/3/2019	REVISIONS -

**STATE OF ILLINOIS
 DEPARTMENT OF TRANSPORTATION**

**EXPANSION JOINT REPLACEMENT DETAILS
 STRUCTURE NO. 015-0001(NB) & 015-0002(SB)**

SCALE: _____ SHEET 3 OF 6 SHEETS STA. _____ TO STA. _____

F.A.I. RTE.	SECTION	COUNTY	TOTAL SHEETS	SHEET NO.
57	D7 BRIDGE REPAIRS 2020-5	COLES	20	17
CONTRACT NO. 74969				
ILLINOIS FED. AID PROJECT				

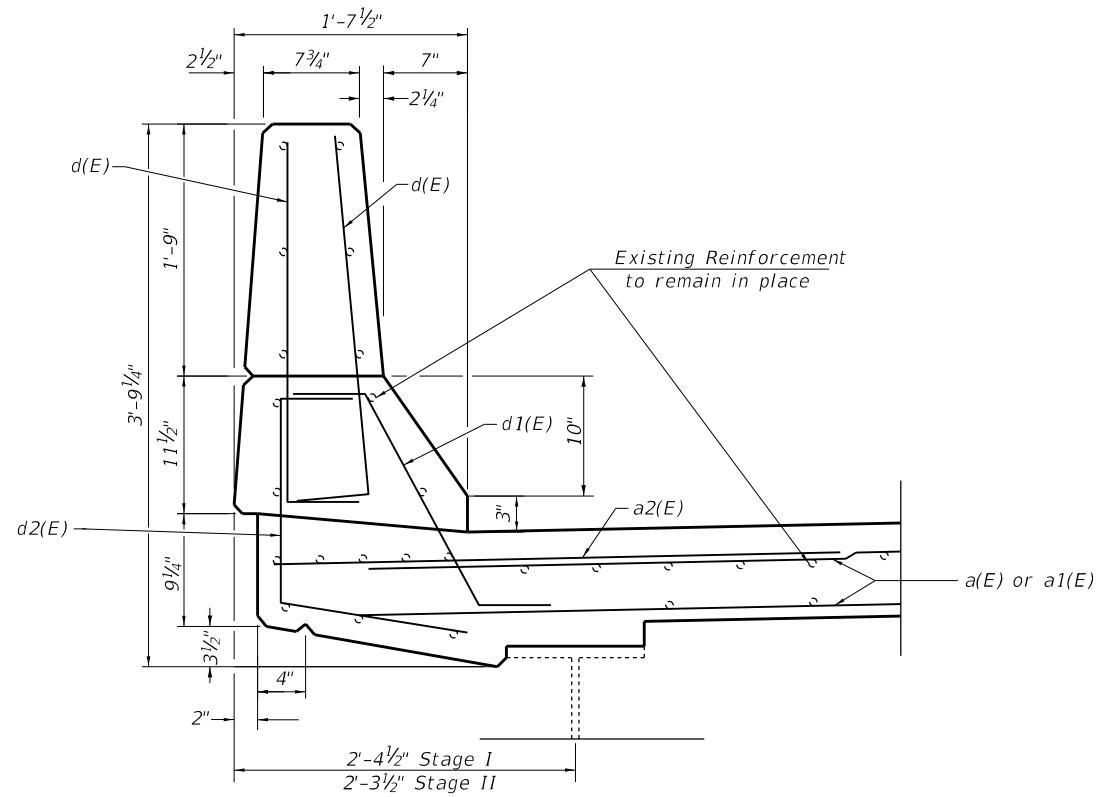

SECTION THRU PARAPET

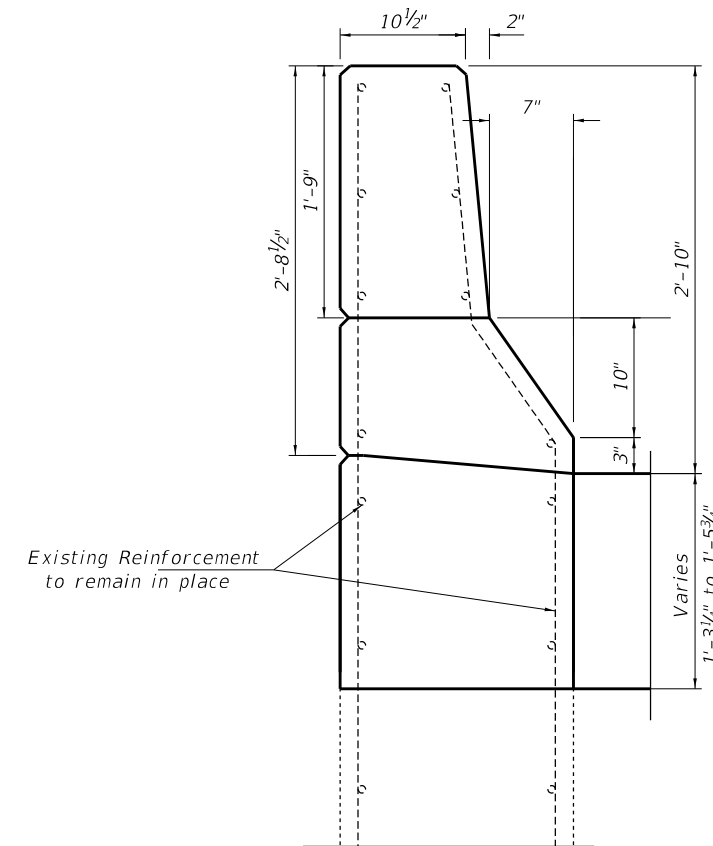

SECTION THRU WING WALL

Hatching Indicates Removal

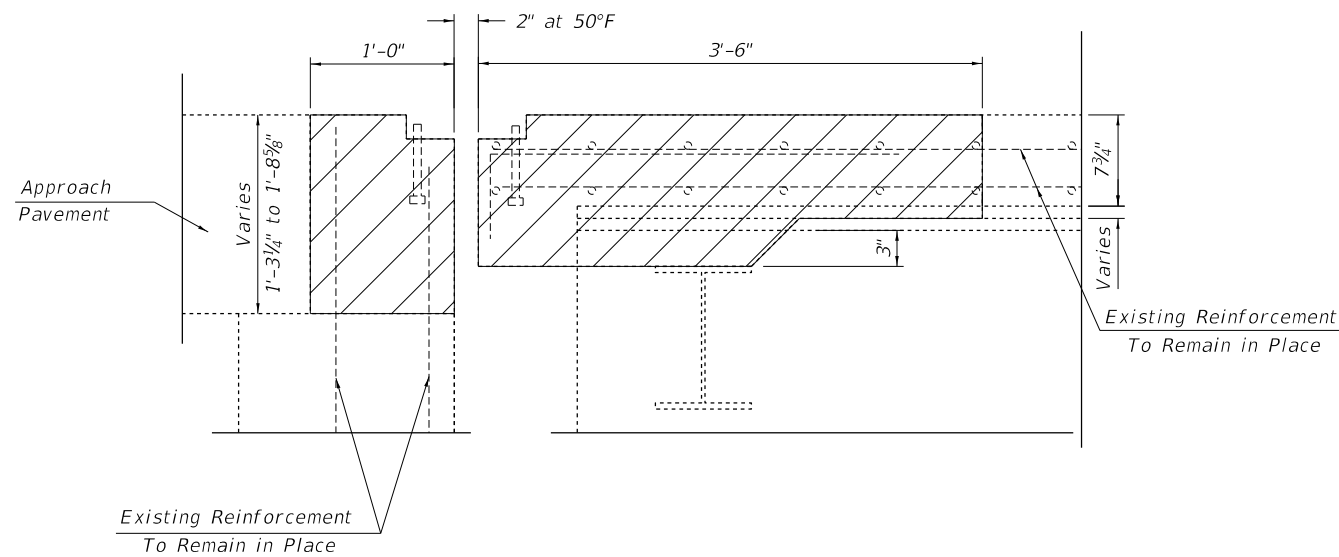

SECTION A-A
(Dimensions at RT Angles to end of deck)

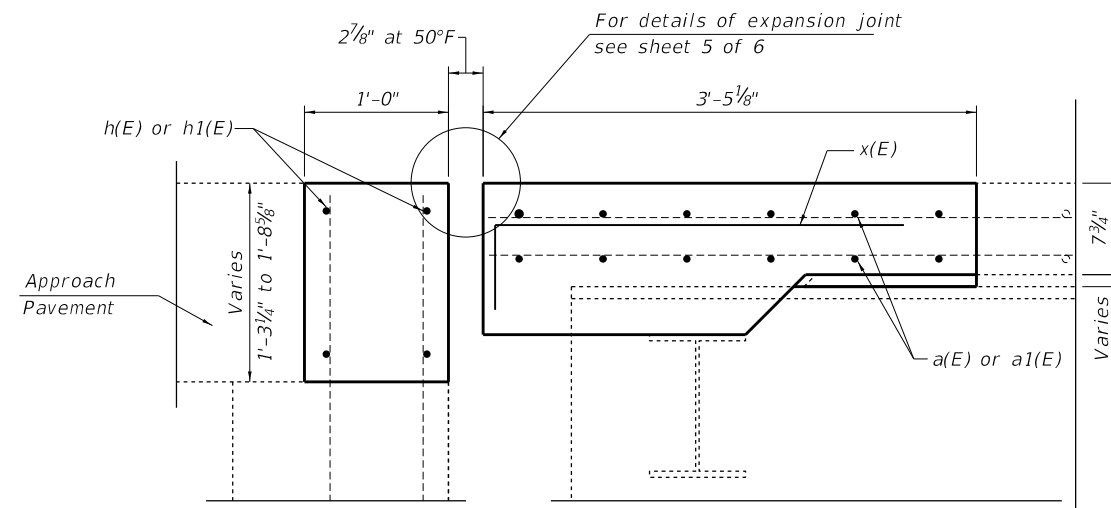

SECTION B-B
(Dimensions at RT Angles to end of deck)

MODEL: Default
FILE: h:\m\c\pub\harcourt\dat\illinois\pwr\DOT\Documents\DOT_Offices\Illinet\7\Projects\74969\CADD\data\CADD\sheet\074969-shc-blan.dgn

USER NAME = stefhenk	DESIGNED - T. Walk	REVISED - D. Macklin
PLOT SCALE = 100.0000' / in.	DRAWN - T. Walk	REVISED -
PLOT DATE = 12/20/2019	CHECKED - D. Macklin	REVISED -
	DATE - 12-3-2019	REVISED -

**STATE OF ILLINOIS
DEPARTMENT OF TRANSPORTATION**

**EXPANSION JOINT REPLACEMENT DETAILS
STRUCTURE NO. 015-0001(NB) & 015-0002(SB)**

SCALE: SHEET 4 OF 6 SHEETS STA. TO STA.

F.A.I. RTE.	SECTION	COUNTY	TOTAL SHEETS	SHEET NO.
57	D7 BRIDGE REPAIRS 2020-5	COLES	20	18
ILLINOIS FED. AID PROJECT			CONTRACT NO. 74969	

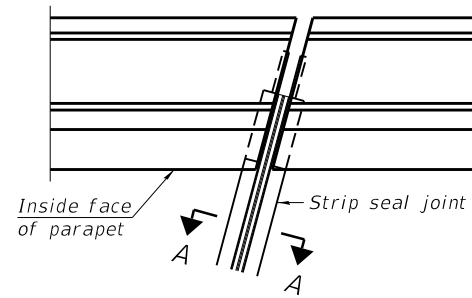

FOR SKEWS $\leq 30^\circ$

PLAN AT PARAPET

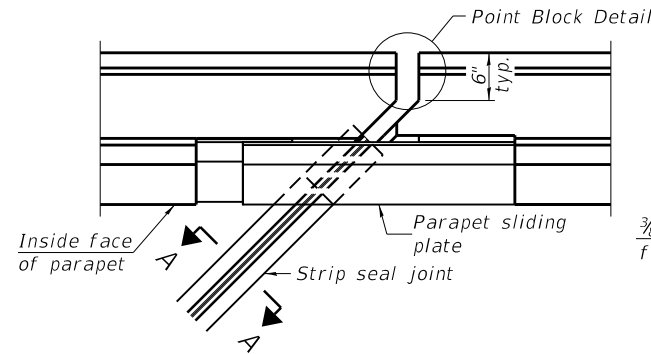

FOR SKEWS $> 30^\circ$

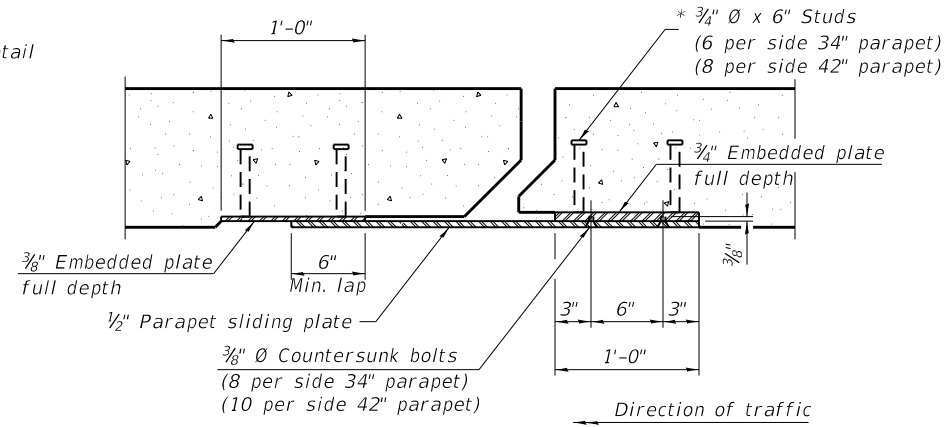

SECTION B-B

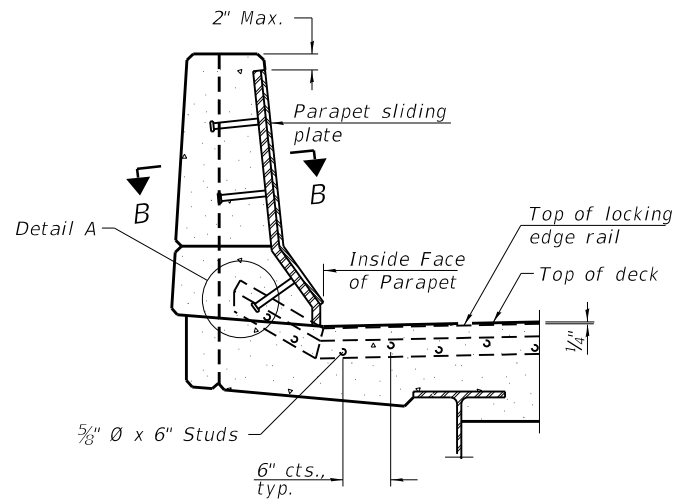

ELEVATION AT PARAPET

(Skews $> 30^\circ$ shown. Skews $\leq 30^\circ$ similar except as shown in plan view.)

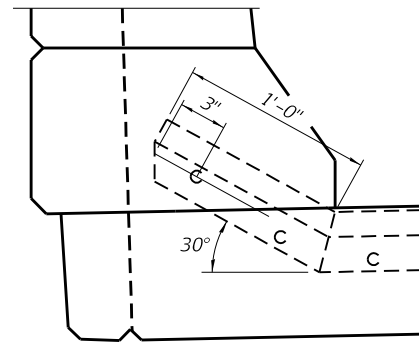

DETAIL A

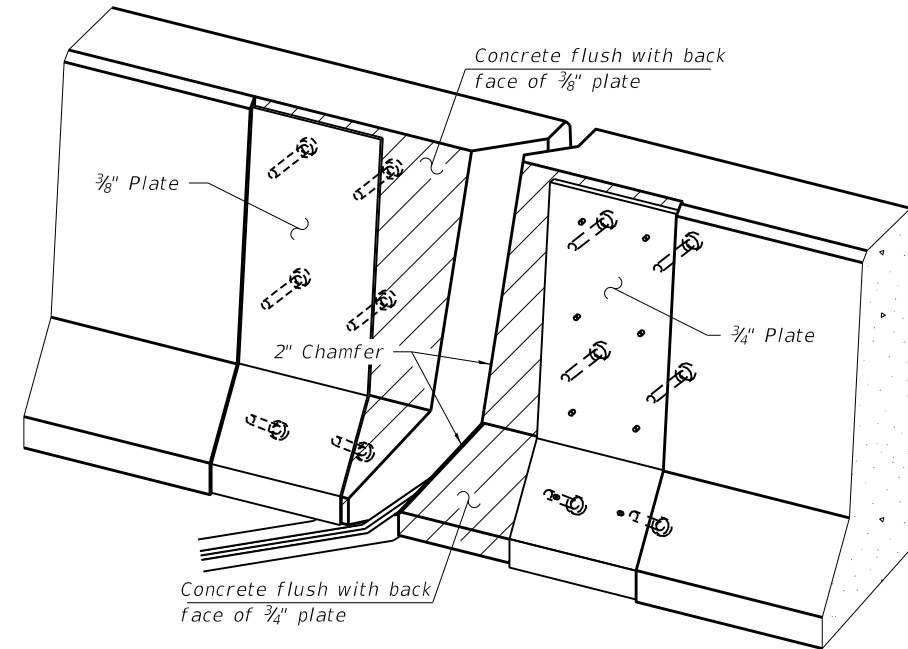

TRIMETRIC VIEW
(Showing embedded plates only)

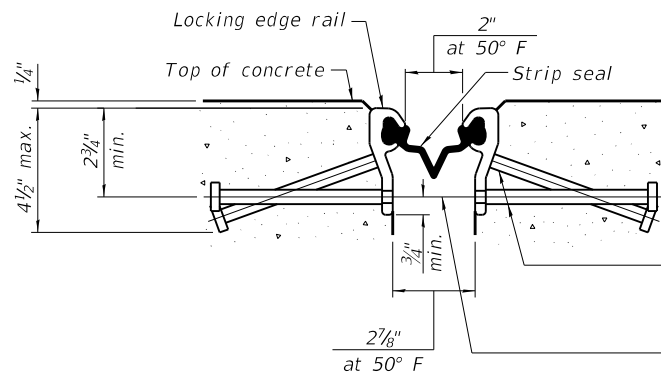

SHOWING ROLLED RAIL JOINT

* $5/8$ " ϕ x 6" studs @ 6" cts. (alternate angled/bent studs with horizontal studs)

$3/8$ " ϕ threaded rods in $7/16$ " ϕ holes at ± 4 "-0" cts. for holding the proper joint opening based on the temperature during the deck pour. Place to miss studs. All rods shall be burned, or sawed off flush with the plates after concrete is set.

SECTION A-A

* Granular or solid flux filled headed studs conforming to Article 1006.32 of the Std. Specs., automatically end welded.

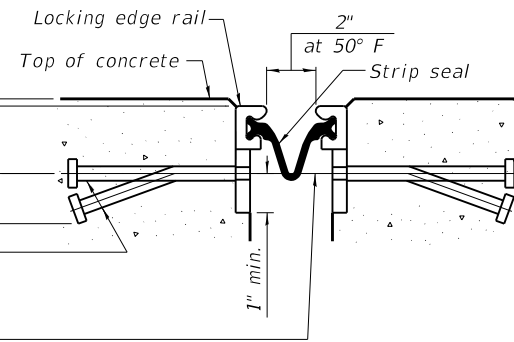

SHOWING WELDED RAIL JOINT

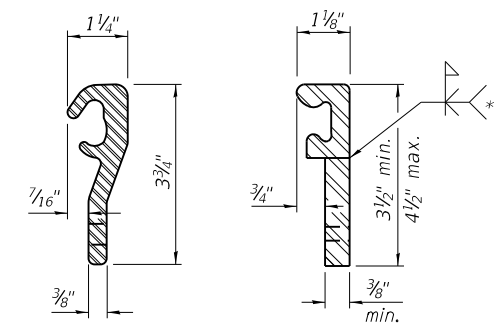

ROLLED (EXTRUDED) RAIL
WELDED RAIL

LOCKING EDGE RAILS

** Back gouge not required if complete joint penetration is verified by mock-up.

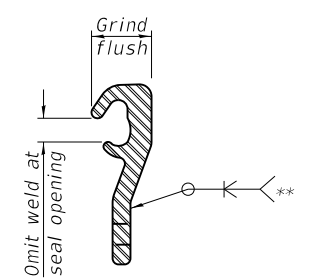

LOCKING EDGE RAIL SPLICE

The inside of the locking edge rail groove shall be free of weld residue. Rolled rail shown, welded rail similar.

BILL OF MATERIAL

Item	Unit	Total
Preformed Joint Strip Seal	Foot	212

MODEL: Default
FILE: \\msbpc-prod\pub\baroncom.dta\illinois\spc\PROJECTS\74969\CADD\DATA\CAD\sheet\0774969-sht-plan.dgn
PROJECT: 74969\CADD\DATA\CAD\sheet\0774969-sht-plan.dgn

EJ-SS

8-11-17

USER NAME = steffnmk	DESIGNED - T. Walk	REVISED -
PLOT SCALE = 100,0000' / in.	DRAWN - D. Macklin	REVISED -
PLOT DATE = 12/20/2019	CHECKED - D. Macklin	REVISED -
	DATE - 12/3/2019	REVISED -

STATE OF ILLINOIS
DEPARTMENT OF TRANSPORTATION

PREFORMED JOINT STRIP SEAL
STRUCTURE NO. 015-0001(NB) & 015-0002(SB)

SCALE: SHEET 5 OF 6 SHEETS STA. TO STA.

F.A.I. RTE.	SECTION	COUNTY	TOTAL SHEETS	SHEET NO.
57	D7 BRIDGE REPAIRS 2020-5	COLES	20	19
				CONTRACT NO. 74969
		ILLINOIS	FED. AID PROJECT	

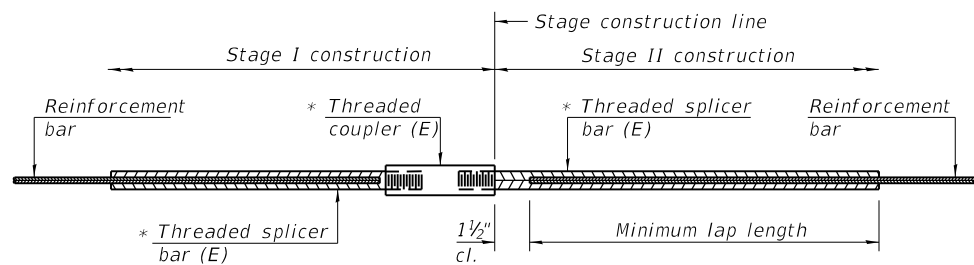

STANDARD BAR SPLICER ASSEMBLY

Threaded splicer bar length = min. lap length + 1 1/2" + thread length

* Epoxy not required on Bar Splicer Assembly components used in conjunction with black bars.

Location	Bar size	No. assemblies required	Minimum lap length
Deck	#5	48	3'-6"
Hatch Block	#5	16	3'-6"

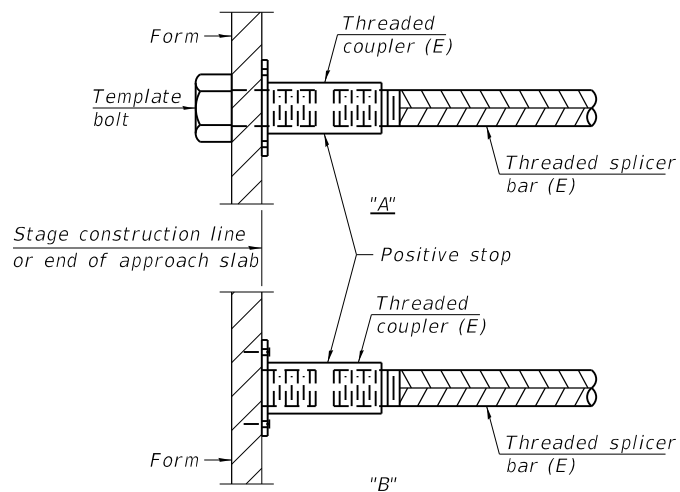

INSTALLATION AND SETTING METHODS

"A" : Set bar splicer assembly by means of a template bolt.
 "B" : Set bar splicer assembly by nailing to wood forms or cementing to steel forms.
 (E) : Indicates epoxy coating.

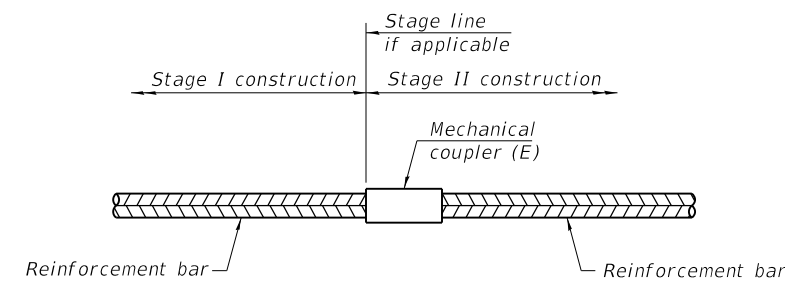

STANDARD MECHANICAL SPLICER

Location	Bar size	No. assemblies required

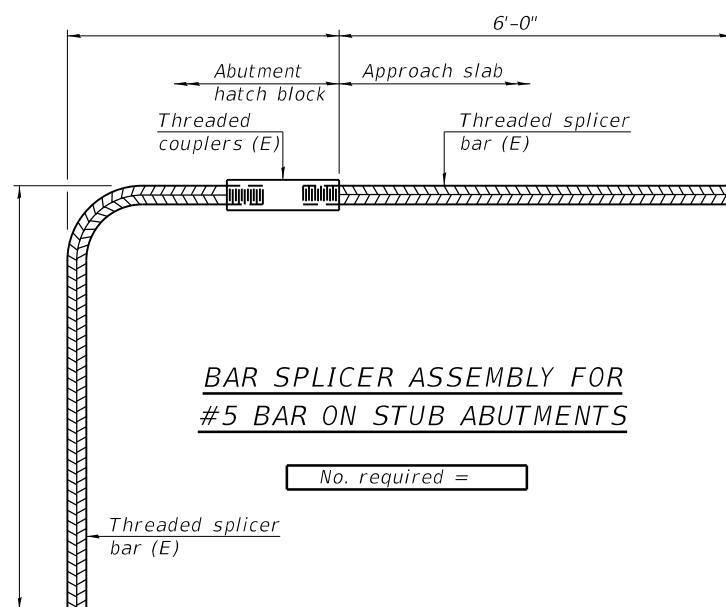

BAR SPLICER ASSEMBLY FOR #5 BAR ON STUB ABUTMENTS

No. required =

NOTES

Splicer bars shall be deformed with Threaded ends and have a minimum 60 ksi yield strength.
 All reinforcement shall be lapped and tied to the splicer bars.
 Bar splicer assemblies shall be epoxy coated according to the requirements for reinforcement bars. See Section 508 of the Standard Specifications.
 See approved list of bar splicer assemblies and mechanical splicers for alternatives.

BSD-1

2-17-2017

MODEL: Default
 FILE: A:\msc\p\pub\barroom.dwg
 PLOT DATE: 12/20/2019
 PROJECT: 74969
 SHEET: 6 OF 6

USER NAME = steffemk	DESIGNED - T. Walk	REVISED -
	DRAWN - D. Macklin	REVISED -
PLOT SCALE = 100.0000' / in.	CHECKED - D. Macklin	REVISED -
PLOT DATE = 12/20/2019	DATE - 12/3/2019	REVISED -

**STATE OF ILLINOIS
DEPARTMENT OF TRANSPORTATION**

**BAR SPLICER ASSEMBLY AND MECHANICAL SPLICER DETAILS
STRUCTURE NO. 015-0001(NB) & 015-0002(SB)**

SCALE: SHEET 6 OF 6 SHEETS STA. TO STA.

F.A.I. RTE.	SECTION	COUNTY	TOTAL SHEETS	SHEET NO.
57	D7 BRIDGE REPAIRS 2020-5	COLES	20	20
CONTRACT NO. 74969			ILLINOIS FED. AID PROJECT	