

MATCH LINE STA. 2062+00

MATCH LINE STA. 2076+00

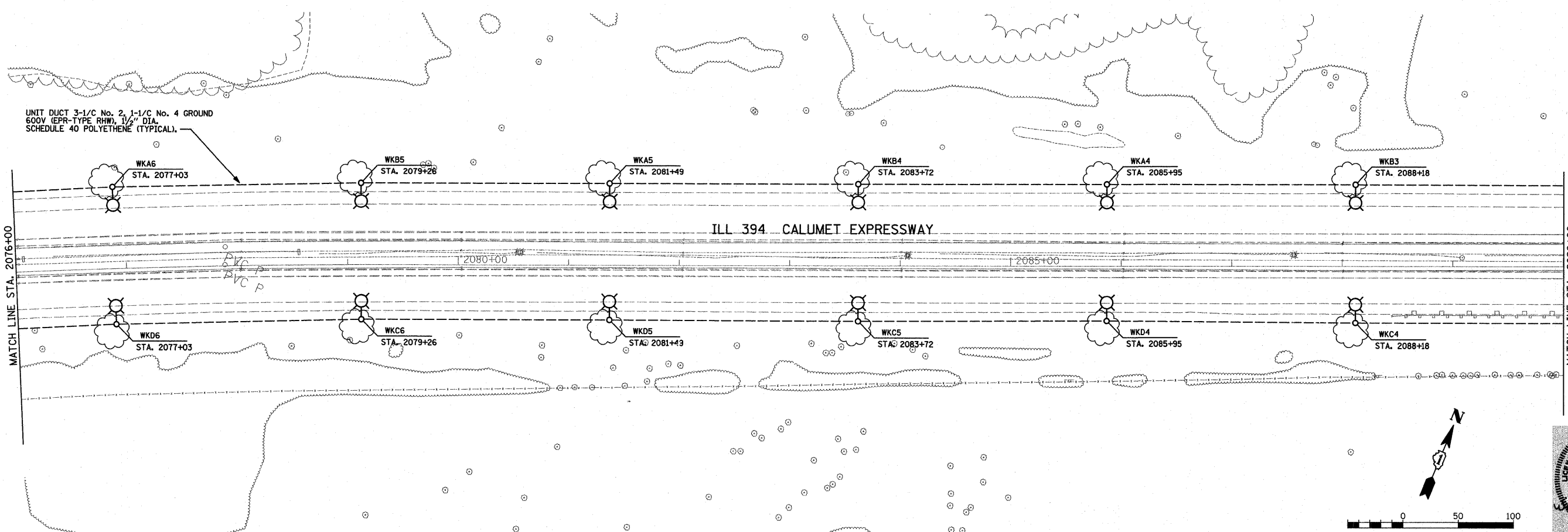
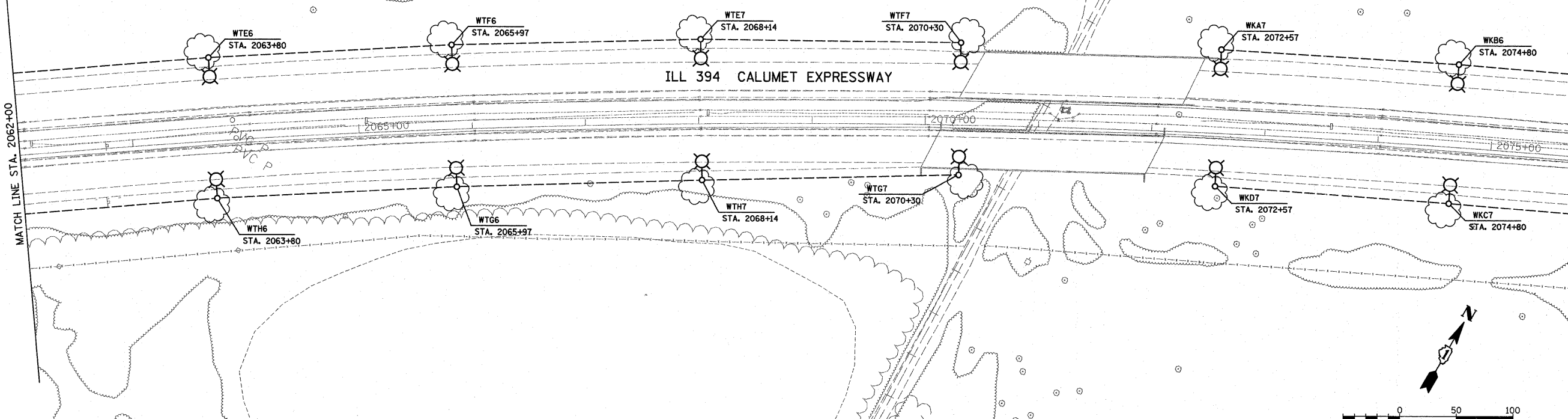

UNIT DUCT 3-1/C No. 2, 1-1/C No. 4 GROUND 600V (EPR-TYPE RHW), 1/2" DIA. SCHEDULE 40 POLYETHENE (TYPICAL).

I:\jobs\2006\20063028-39\cadd\elec\tr\calum.dgn 2/8/2008 2:53:26 PM



USER NAME = #USER#
 PLOT SCALE = #SCALE#
 PLOT DATE = 2/8/2008

DESIGNED -	BDB/CMP	REVISED -	
DRAWN -	JCC	REVISED -	
CHECKED -	BDB	REVISED -	
DATE -	12-31-07	REVISED -	

**STATE OF ILLINOIS
DEPARTMENT OF TRANSPORTATION**

**IL 394 SAFETY IMPROVEMENTS - GOODNOW ROAD TO BURRVILLE ROAD
LIGHTING PLAN**

SCALE: 1" = 50' SHEET NO. 35 OF 53 SHEETS STA. 2062+00 TO STA. 2090+00

F.A.P. RTE.	SECTION	COUNTY	TOTAL SHEETS	SHEET NO.
332	2007-044 I	WILL & COOK	53	35
FED. ROAD DIST. NO.		ILLINOIS FED. AID PROJECT		

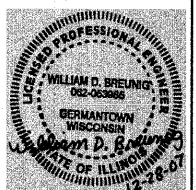

Rev. Sheet 2-14-08