

F.A.I. RTE.	SECTION	COUNTY	TOTAL SHEETS	SHEET NO.
55	2007-046 I	COOK	24	1
FED. ROAD DIST. NO. 1	ILLINOIS	CONTRACT NO.	60D36	

STATE OF ILLINOIS  
DEPARTMENT OF TRANSPORTATION  
DIVISION OF HIGHWAYS

**PROPOSED  
HIGHWAY PLANS**

F.A.I. ROUTE 55 ( I-55 / STEVENSON EXPWY )  
WILLOW SPRINGS ROAD TO CALIFORNIA AVENUE

SECTION: 2007-046 I  
SHOULDER RUMBLE STRIPS

PROJECT: *ACHSIP-055-7(275)280*  
COOK COUNTY  
C-91-008-08

FOR INDEX OF SHEETS, SEE SHEET NO.

PROJECT IS LOCATED IN THE CITY OF CHICAGO AND THE VILLAGES OF STICKNEY, FOREST VIEW, SUMMIT, BEDFORD PARK, HODGKINS, AND COUNTRYSIDE

D-91-008-08

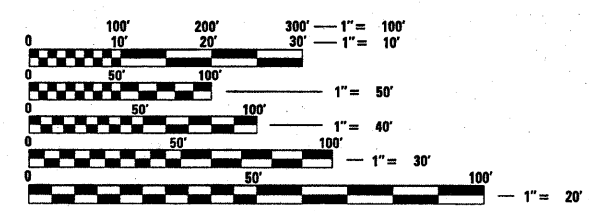
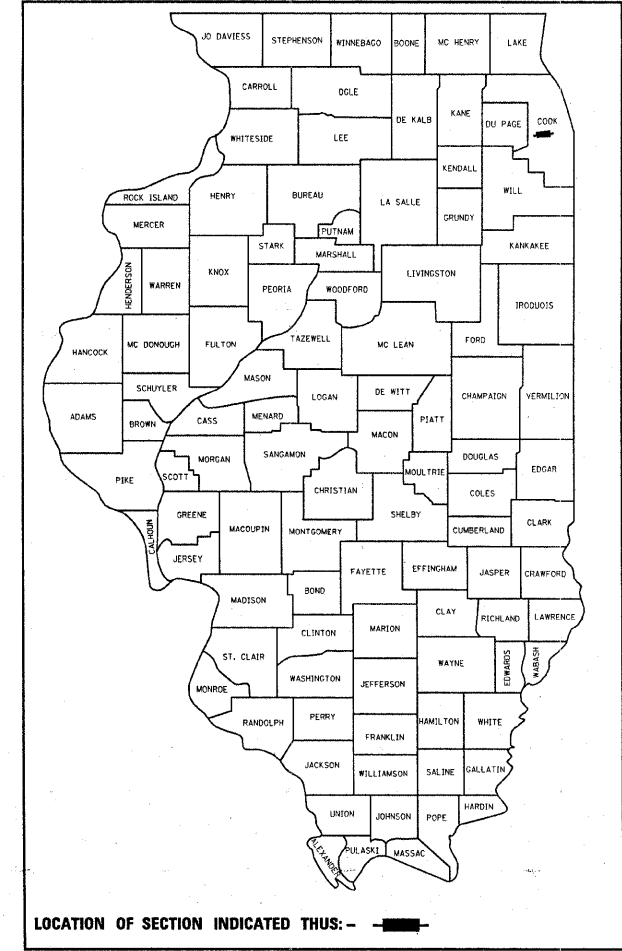

FULL SIZE PLANS HAVE BEEN PREPARED USING STANDARD ENGINEERING SCALES. REDUCED SIZED PLANS WILL NOT CONFORM TO STANDARD SCALES. IN MAKING MEASUREMENTS ON REDUCED PLANS, THE ABOVE SCALES MAY BE USED.

J.U.L.I.E.  
JOINT UTILITY LOCATION INFORMATION FOR EXCAVATION  
1-800-892-0123  
OR 811

OMMISSIONS:

- STA. 1235+18 TO STA. 1268+14
- STA. 1362+31 TO STA. 1365+32
- STA. 1427+14 TO STA. 1433+13
- STA. 1632+38 TO STA. 1633+99
- STA. 1646+20 TO STA. 1647+91
- STA. 1746+66 TO STA. 1748+34
- STA. 1775+32 TO STA. 1777+22

PROJECT BEGINS  
STA. 1175+73

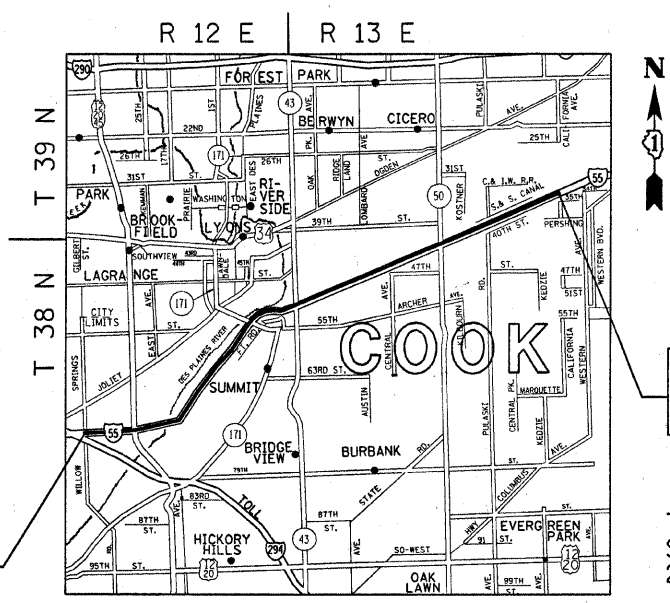

PROJECT ENDS  
STA. 1780+00

TRAFFIC DATA  
SPEED LIMIT: 55 MPH  
2005 ADT: 176,900

PROJECT ENGINEER: ANA ABREU (847) 705-4586  
PROJECT MANAGER: KEN ENG (847) 705-4247

CONTRACT NO. 60D36

GROSS LENGTH OF PROJECT = 60,427 FEET (11.4 MILES)  
NET LENGTH OF PROJECT = 55,541 FEET (10.5 MILES)

STATE OF ILLINOIS  
DEPARTMENT OF TRANSPORTATION  
DIVISION OF HIGHWAYS

SUBMITTED *December 192007*

*Diane O'Keefe*  
DEPUTY DIRECTOR OF HIGHWAYS, REGION ENGINEER

*February 1, 2008*  
*Eric E. Horn*  
Interim ENGINEER OF DESIGN AND ENVIRONMENT

*February 1, 2008*  
*Christine M. Reed*  
DIRECTOR OF HIGHWAYS, CHIEF ENGINEER

**PRINTED BY THE AUTHORITY  
OF THE STATE OF ILLINOIS**