

F.A.S. RTE.	SECTION	COUNTY	TOTAL SHEETS	SHEET NO.
2320	113X-N	WILL	133	98
STA.		TO STA.		
FED. ROAD DIST. NO. 1		ILLINOIS	FED. AID PROJECT	

TIME: 4:31:23 PM

DATE: 7/18/2007

FILENAME: S:\06\851-900\851\071\Micros\Sheets\Lighting control.dgn

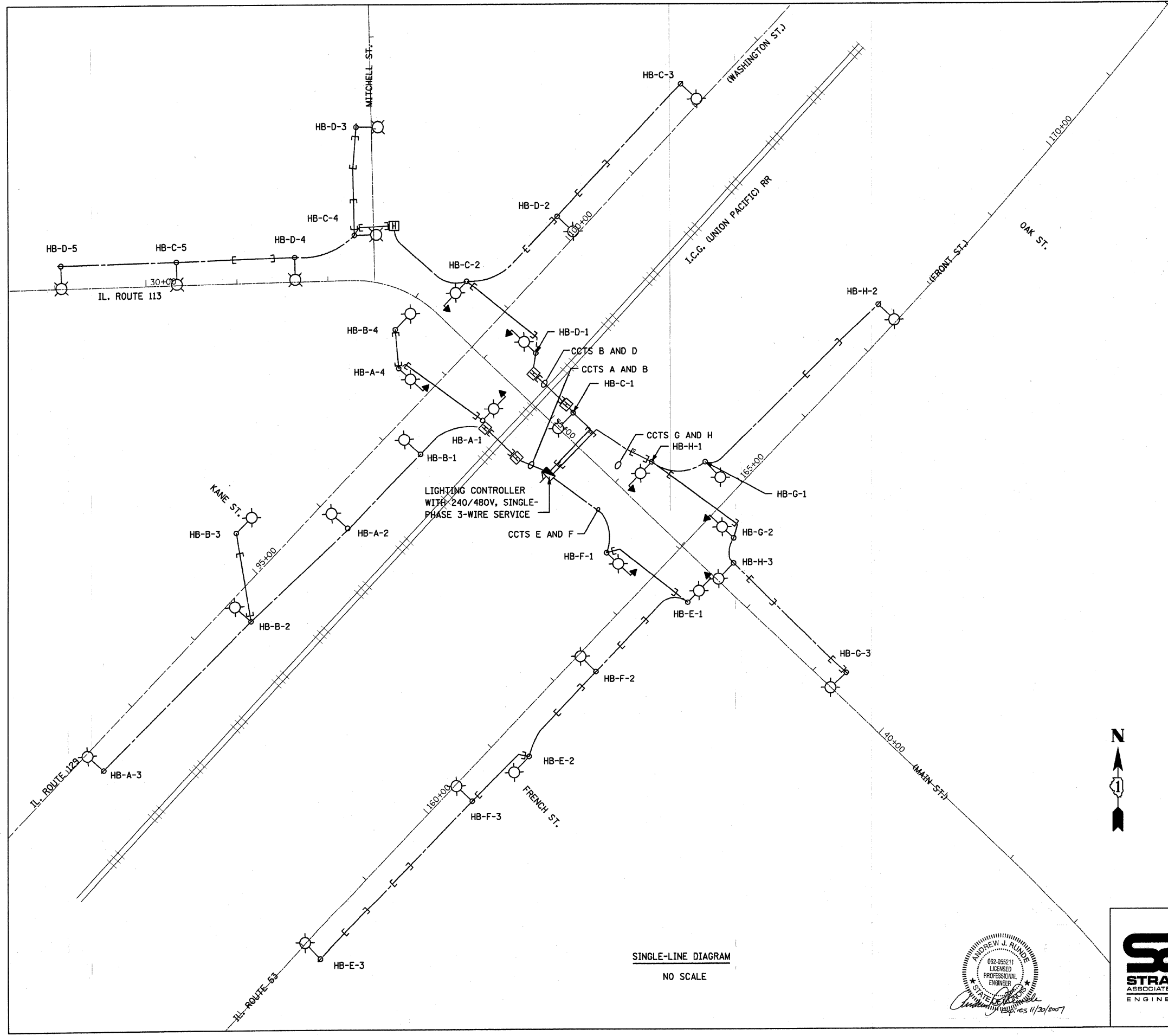

SINGLE-LINE DIAGRAM  
NO SCALE

LEGEND

- PROPOSED LIGHT UNIT AND POLE, SINGLE ARM  
47.5' M.H., 12' M.A., 310 WATT
- PROPOSED LIGHT UNIT COMBINATION TRAFFIC SIGNAL POLE, 45' M.H., 12 M.A., 310 WATT
- PROPOSED SINGLE DOOR, CONSOLE TYPE CONTROLLER
- 
- 
- HANDHOLE

CIRCUIT	RED PHASE LOAD (WATTS)	BLACK PHASE LOAD (WATTS)
A	1520	
B		1520
C	1900	
D		1900
E	1140	
F		1140
G	1140	
H		1140
TOTALS	5700	5700

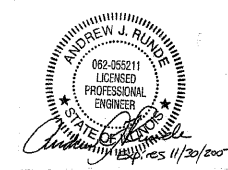

REVISIONS	
NAME	DATE

ILLINOIS DEPARTMENT OF TRANSPORTATION CITY OF BRAIDWOOD, ILLINOIS	
LIGHTING SINGLE LINE	
SCALE: VERT. HORIZ. DATE 7/18/2007	DRAWN BY MAG CHECKED BY AJR