

F.A.P. RTE.	SECTION	COUNTY	TOTAL SHEETS	SHEET NO.
308	108B,108-1,108-2R	ROCK ISLAND	210	51
STA. 1455+00.00		TO STA. 1485+00.00		
FED. ROAD DIST. NO. 2 ILLINOIS FED. AID PROJECT				

STAGE 1

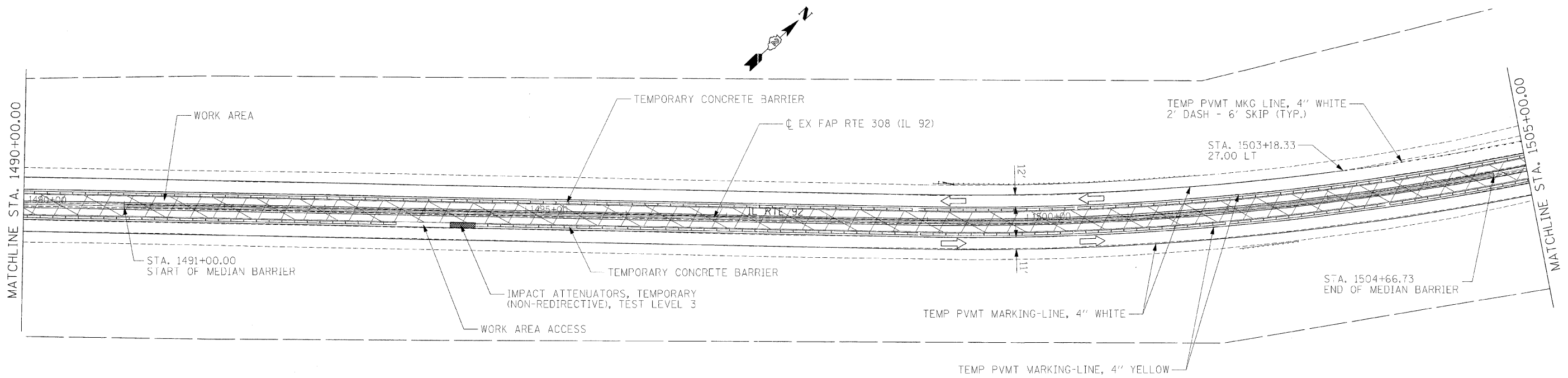

STAGE 1

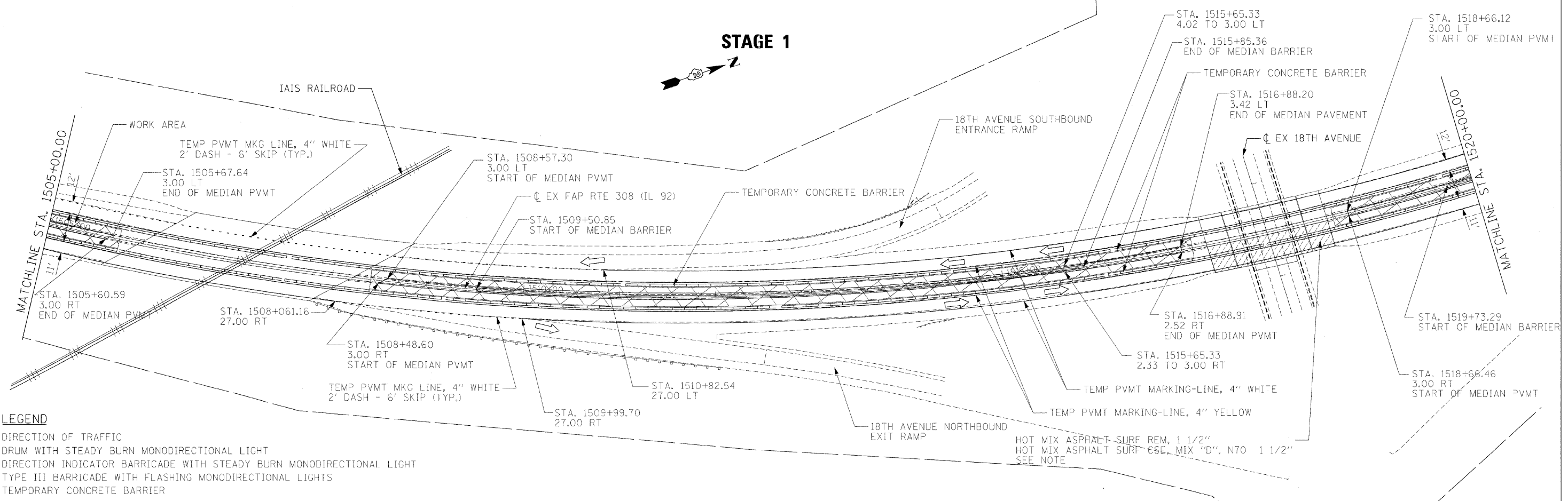

LEGEND

- ➔ DIRECTION OF TRAFFIC
- ⊙ DRUM WITH STEADY BURN MONODIRECTIONAL LIGHT
- ⚡ DIRECTION INDICATOR BARRICADE WITH STEADY BURN MONODIRECTIONAL LIGHT
- ⚡ TYPE III BARRICADE WITH FLASHING MONODIRECTIONAL LIGHTS
- ▬ TEMPORARY CONCRETE BARRIER

HOT MIX ASPHALT SURF REM, 1 1/2"
HOT MIX ASPHALT SURF 6SE, MIX "D", N70 1 1/2"
SEE NOTE

PLOT DATE = 04/25/15
FILE NAME = 1505-51.DWG
PLOT SCALE = 1"=40'
USER NAME = RUSERS