

F.A.P. RTE.	SECTION	COUNTY	TOTAL SHEETS	SHEET NO.
308	11HB/HB-1,VB/HB-2/R	ROCK ISLAND	210	53
STA. 1455+00.00		TO STA. 1485+00.00		
FED. ROAD DIST. NO. 2		ILLINOIS	FED. AID PROJECT	

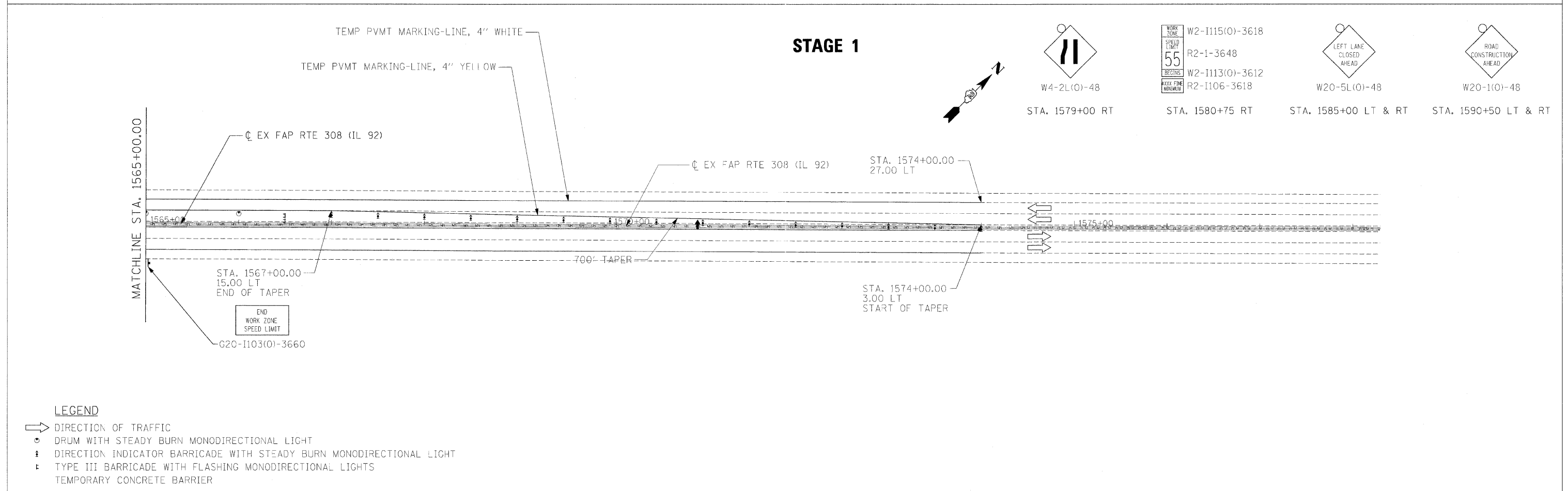
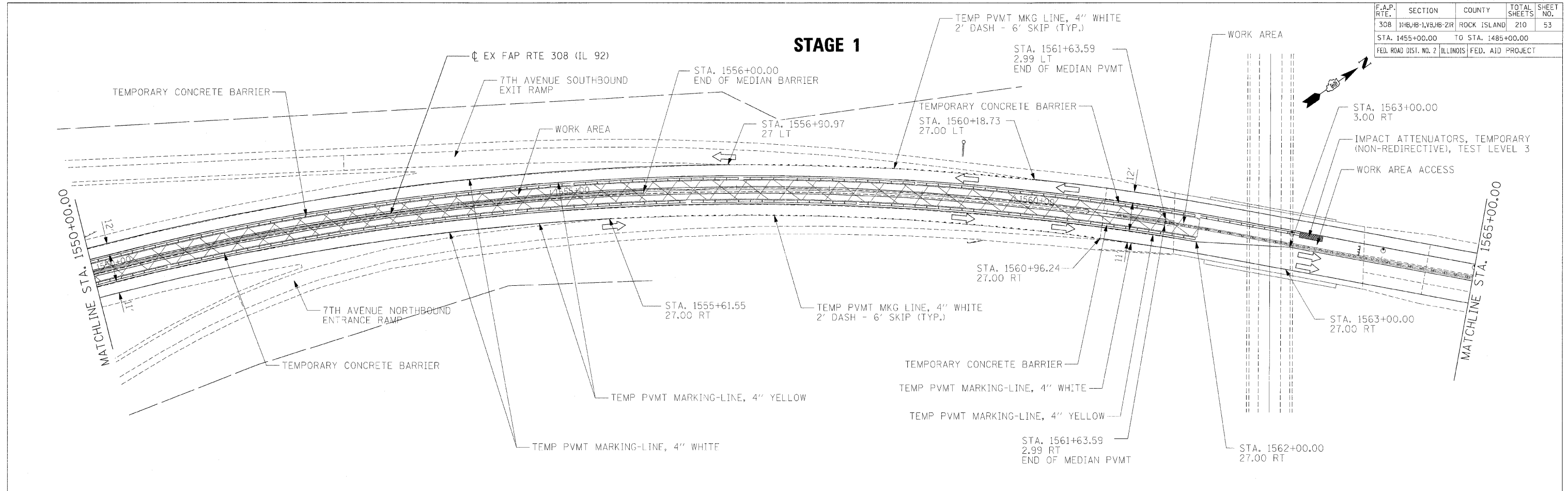

PLOT DATE = 04/25/18  
 FILE NAME = 041818  
 PLOT SCALE = 1/8"=1'-0"  
 USER NAME = JGIBSON

- LEGEND**
- ➔ DIRECTION OF TRAFFIC
  - ⊙ DRUM WITH STEADY BURN MONODIRECTIONAL LIGHT
  - ⚡ DIRECTION INDICATOR BARRICADE WITH STEADY BURN MONODIRECTIONAL LIGHT
  - ⚡ TYPE III BARRICADE WITH FLASHING MONODIRECTIONAL LIGHTS
  - ▬ TEMPORARY CONCRETE BARRIER