

F.A.P. RTE.	SECTION	COUNTY	TOTAL SHEETS	SHEET NO.
308	1 00B/1B/2B/2R	ROCK ISLAND	210	59
STA. 1555+65.00 TO STA. 1562+35.00				
FED. ROAD DIST. NO. 2 ILLINOIS FED. AID PROJECT				

**STAGE 3**

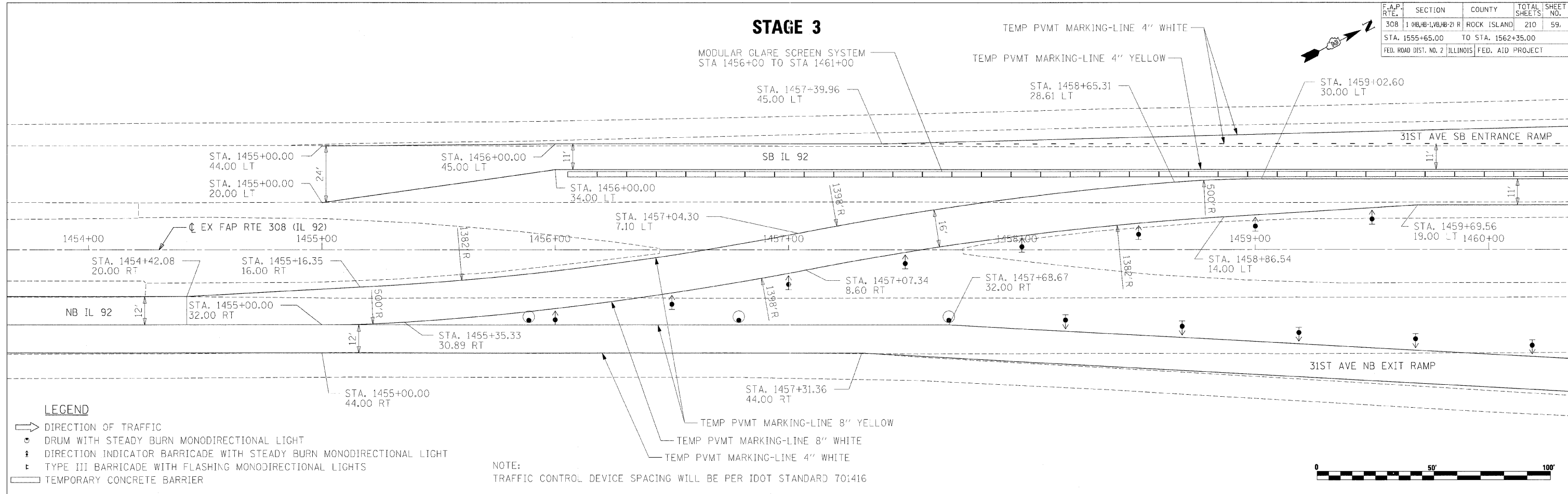

**LEGEND**

- ➔ DIRECTION OF TRAFFIC
- DRUM WITH STEADY BURN MONODIRECTIONAL LIGHT
- ⚡ DIRECTION INDICATOR BARRICADE WITH STEADY BURN MONODIRECTIONAL LIGHT
- ⚡ TYPE III BARRICADE WITH FLASHING MONODIRECTIONAL LIGHTS
- ▬ TEMPORARY CONCRETE BARRIER

NOTE:  
TRAFFIC CONTROL DEVICE SPACING WILL BE PER IDOT STANDARD 701416

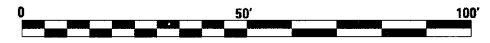

**STAGE 3**

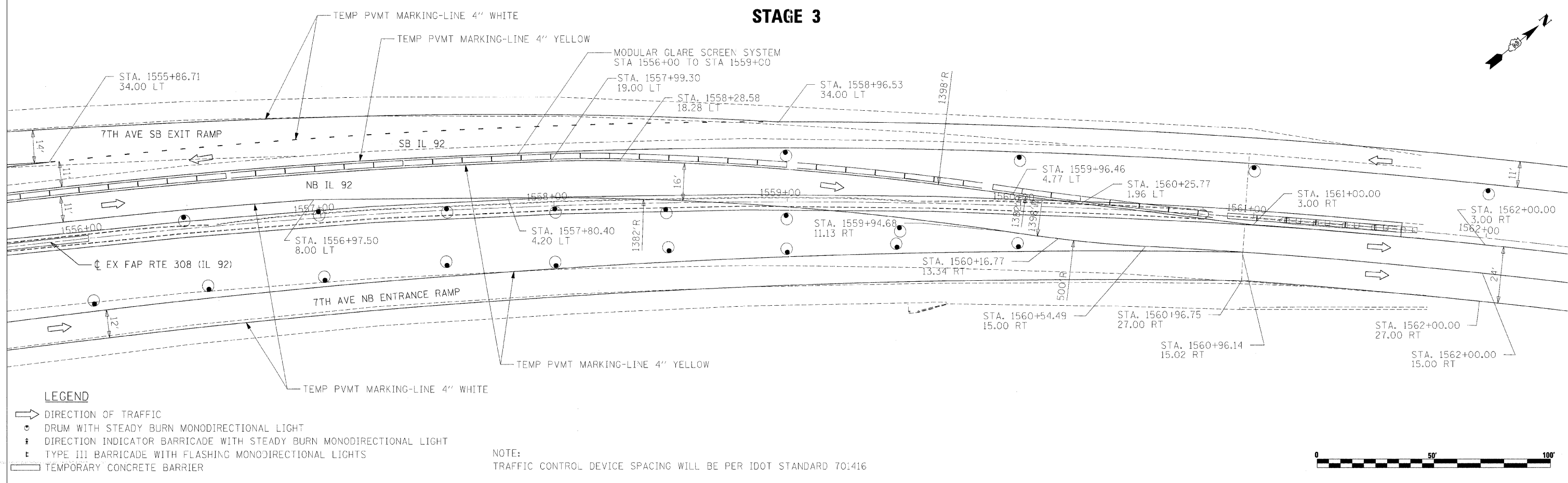

**LEGEND**

- ➔ DIRECTION OF TRAFFIC
- DRUM WITH STEADY BURN MONODIRECTIONAL LIGHT
- ⚡ DIRECTION INDICATOR BARRICADE WITH STEADY BURN MONODIRECTIONAL LIGHT
- ⚡ TYPE III BARRICADE WITH FLASHING MONODIRECTIONAL LIGHTS
- ▬ TEMPORARY CONCRETE BARRIER

NOTE:  
TRAFFIC CONTROL DEVICE SPACING WILL BE PER IDOT STANDARD 701416

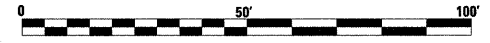

PLOT DATE = 8/20/15  
FILE NAME = 8/15/15  
SCALE = 1/8"=1'-0"  
USER NAME = RUSSELL