

F.A.P. RTE.	SECTION	COUNTY	TOTAL SHEETS	SHEET NO.
308	11B,1B-1,VB,1B-2R	ROCK ISLAND	210	60
STA. 1460+00.00		TO STA. 1490+00.00		
FED. ROAD DIST. NO. 2		ILLINOIS	FED. AID PROJECT	

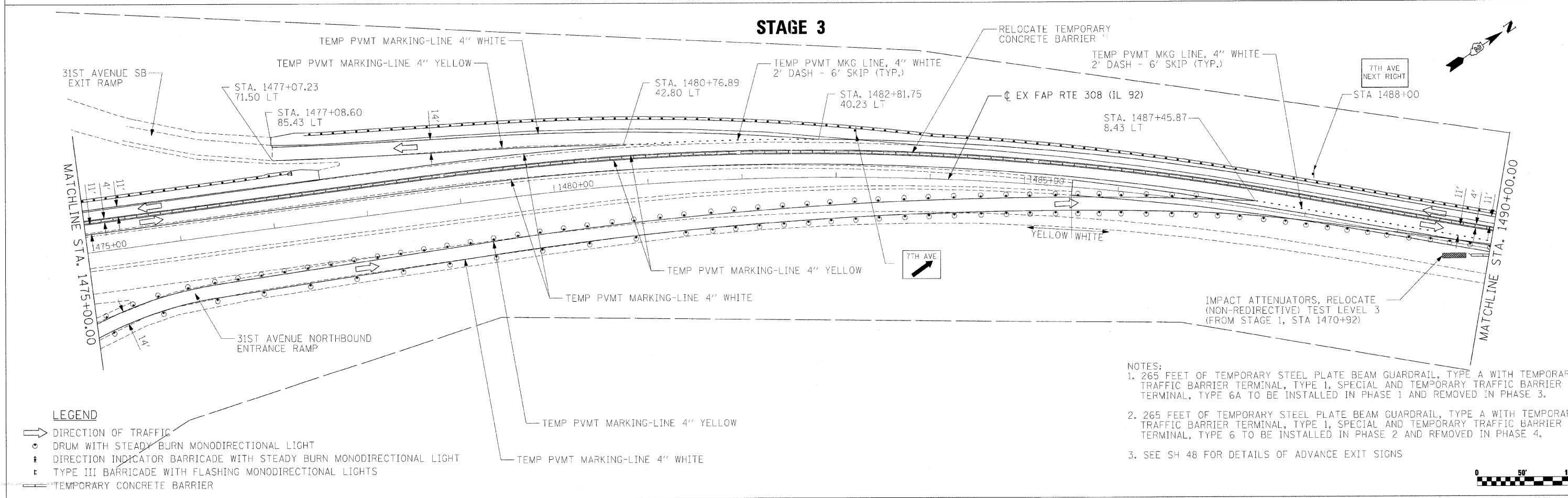
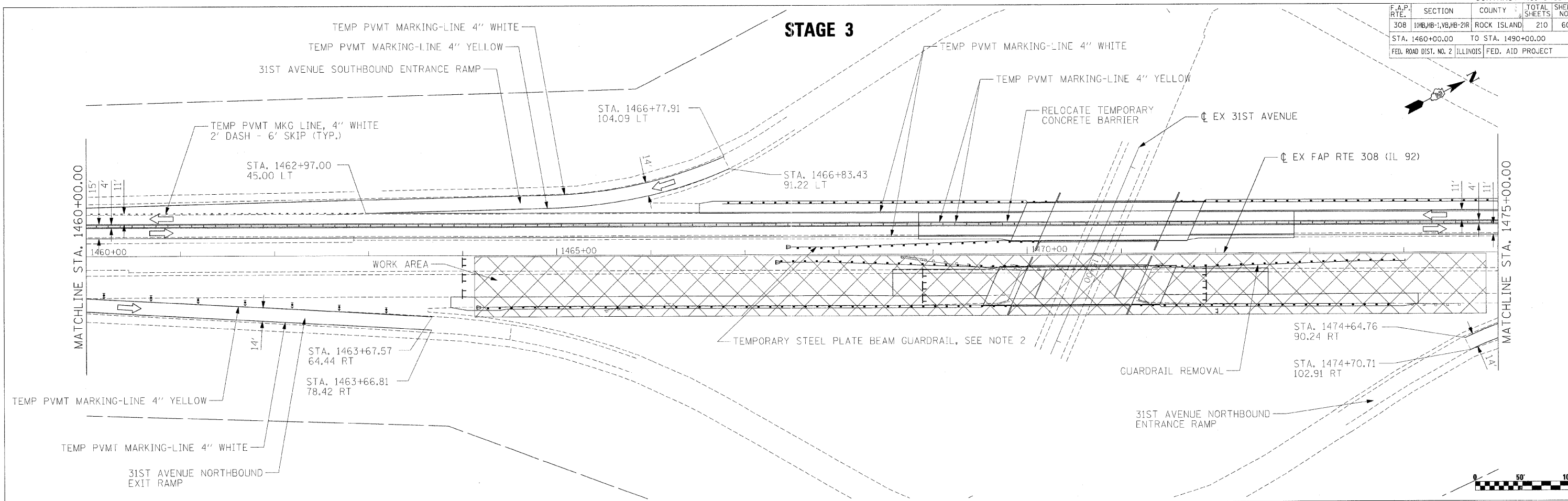

- NOTES:
- 265 FEET OF TEMPORARY STEEL PLATE BEAM GUARDRAIL, TYPE A WITH TEMPORARY TRAFFIC BARRIER TERMINAL, TYPE 1, SPECIAL AND TEMPORARY TRAFFIC BARRIER TERMINAL, TYPE 6A TO BE INSTALLED IN PHASE 1 AND REMOVED IN PHASE 3.
 - 265 FEET OF TEMPORARY STEEL PLATE BEAM GUARDRAIL, TYPE A WITH TEMPORARY TRAFFIC BARRIER TERMINAL, TYPE 1, SPECIAL AND TEMPORARY TRAFFIC BARRIER TERMINAL, TYPE 6 TO BE INSTALLED IN PHASE 2 AND REMOVED IN PHASE 4.
 - SEE SH 48 FOR DETAILS OF ADVANCE EXIT SIGNS

PLOT DATE = 00/00/00
 FILE NAME = 01/11/00
 PLOT SCALE = 1/8"=1'-0"
 USER NAME = MUSER0

- LEGEND
- DIRECTION OF TRAFFIC
 - DRUM WITH STEADY BURN MONODIRECTIONAL LIGHT
 - DIRECTION INDICATOR BARRICADE WITH STEADY BURN MONODIRECTIONAL LIGHT
 - TYPE III BARRICADE WITH FLASHING MONODIRECTIONAL LIGHTS
 - TEMPORARY CONCRETE BARRIER