

| F.A.P. RTE. | SECTION | COUNTY | TOTAL SHEETS | SHEET NO. |
|---|--|-------------|--------------|-----------|
| 308 | 148B,148C,148D,148E,148F,148G,148H,148I,148J,148K,148L,148M,148N,148O,148P,148Q,148R,148S,148T,148U,148V,148W,148X,148Y,148Z | ROCK ISLAND | 210 | 61 |
| STA. 1490+00.00 TO STA. 1520+00.00 | | | | |
| FED. ROAD DIST. NO. 2 ILLINOIS FED. AID PROJECT | | | | |

STAGE 3

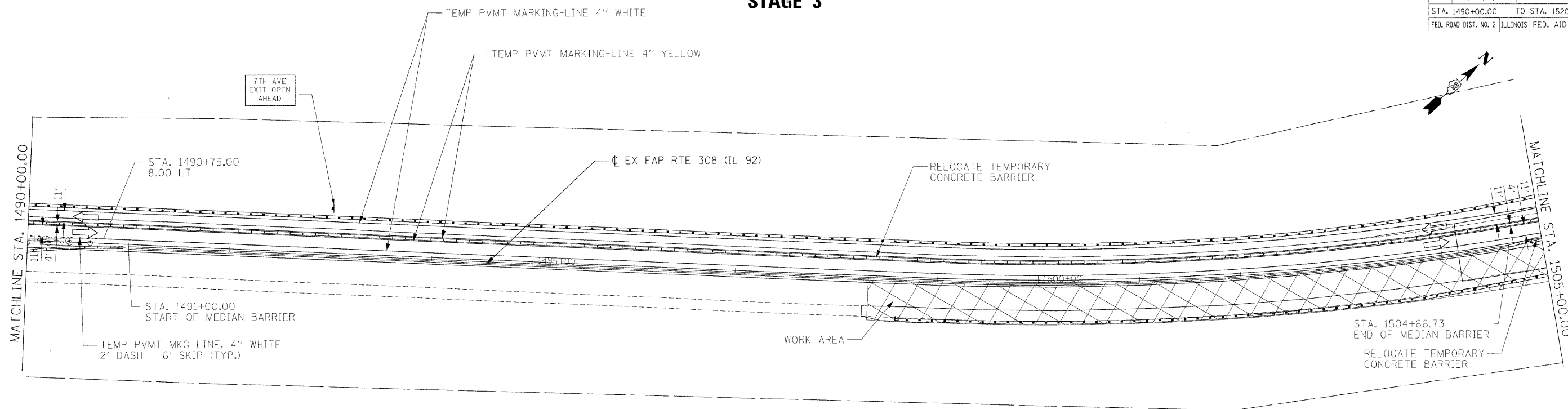

NOTE: SEE SH 48 FOR DETAILS OF ADVANCE EXIT SIGNS

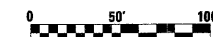

STAGE 3

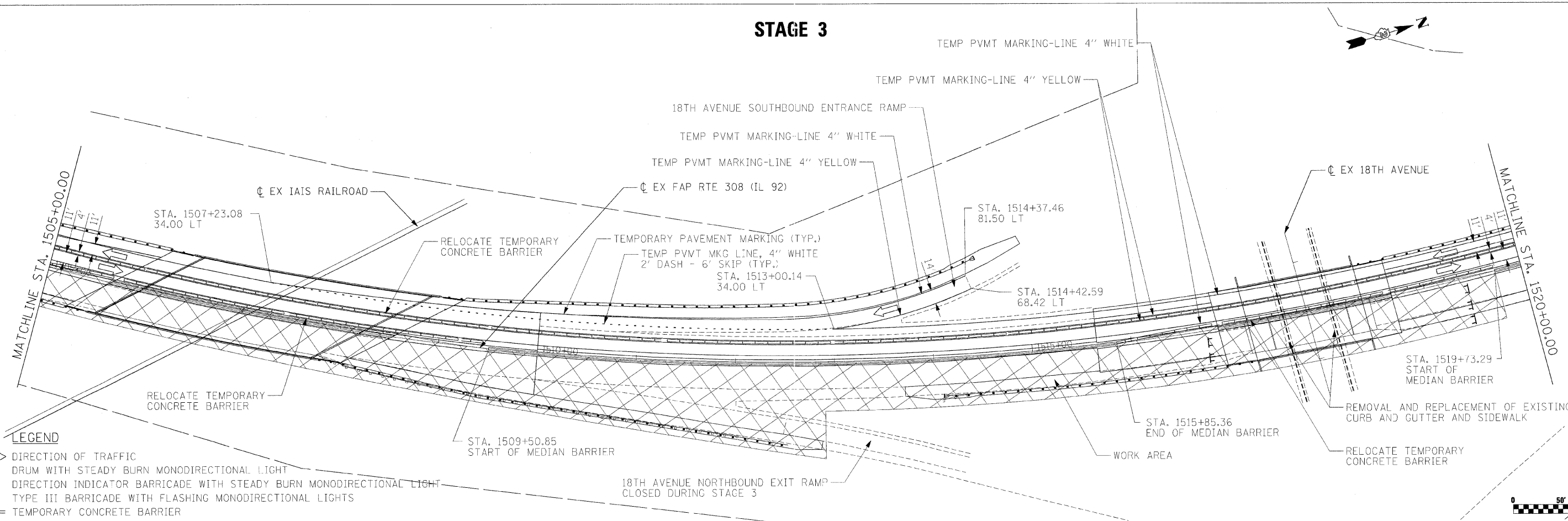

LEGEND

- DIRECTION OF TRAFFIC
- DRUM WITH STEADY BURN MONODIRECTIONAL LIGHT
- DIRECTION INDICATOR BARRICADE WITH STEADY BURN MONODIRECTIONAL LIGHT
- TYPE III BARRICADE WITH FLASHING MONODIRECTIONAL LIGHTS
- TEMPORARY CONCRETE BARRIER

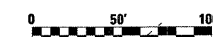

PLOT DATE = 08/18/05
 FILE NAME = 081105
 PLOT SCALE = 1/8"=1'-0"
 USER NAME = JROBERT