

F.A.P. RTE.	SECTION	COUNTY	TOTAL SHEETS	SHEET NO.
308	10B,10B-1,10B,10B-2R	ROCK ISLAND	210	72
STA. 1510+00		TO STA. 1525+00		
FED. ROAD DIST. NO. 2		ILLINOIS		FED. AID PROJECT

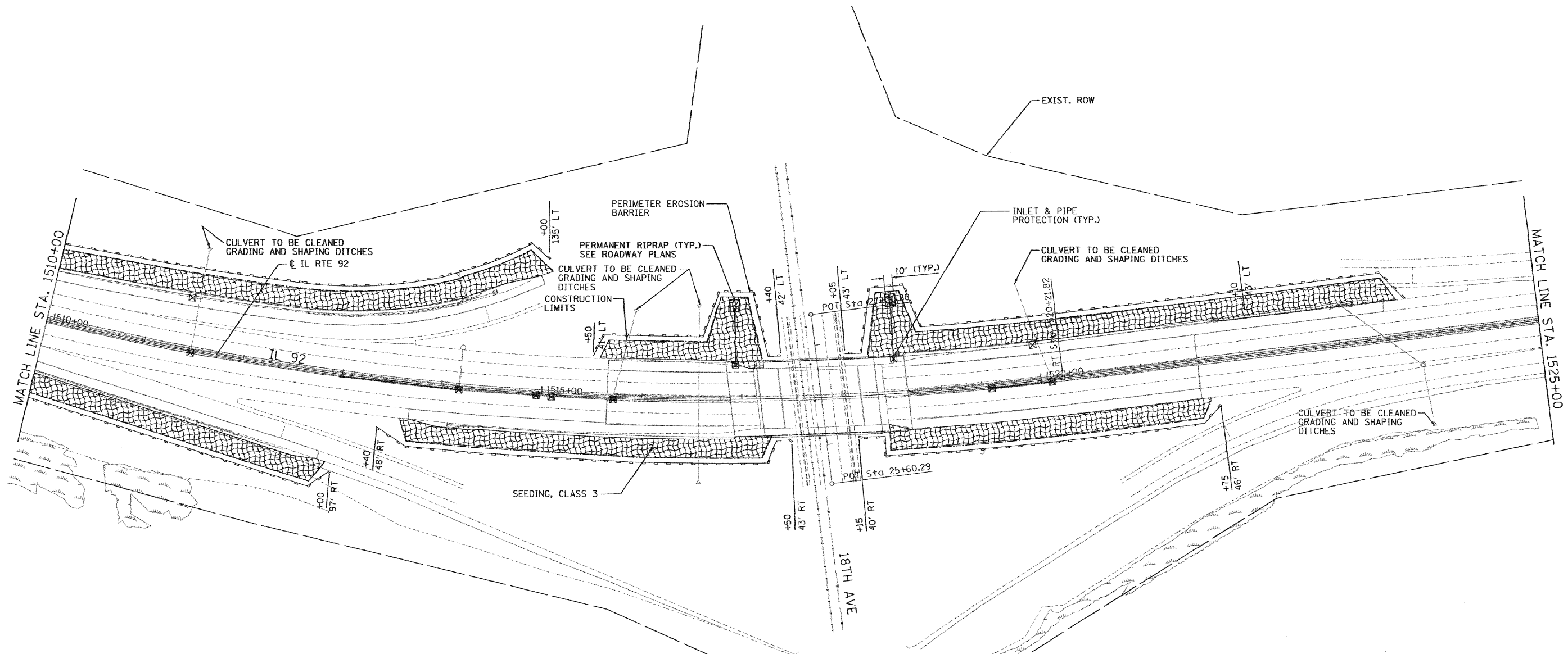

EROSION AND SEDIMENT CONTROL MEASURES APPLICATION NOTES:

1. PLACE THE PERIMETER EROSION BARRIER PRIOR TO ANY EXCAVATION OR GRADING ACTIVITIES. INSTALL PROTECTION AT LOCATIONS SHOWN ON THE PLANS.
2. PLACE EMBANKMENT FOR SHOULDER WIDENING AND STABILIZE WITH SEEDING, CLASS 3 AS THE SHOULDER WIDENING PROGRESSES. FOR ADDITIONAL STABILIZATION ON SLOPES 1:3 OR STEEPER USE EROSION CONTROL BLANKET.
3. TEMPORARILY SEED ANY BARE EARTH OR DISTURBED AREAS EVERY 7 DAYS IN ACCORDANCE WITH ARTICLE 280.04 OF THE STANDARD SPECIFICATIONS. SLOPES 1:3 OR STEEPER WILL REQUIRE MULCH, METHOD 2 APPLICATION.
4. FERTILIZER NUTRIENTS SHALL BE APPLIED IN ACCORDANCE WITH THE ARTICLE 250.04 OF THE STANDARD SPECIFICATIONS.

LEGEND:

- ☒ INLET PROTECTION STD 280001
- PERIMETER EROSION BARRIER
- ▣ STONE RIPRAP
- ▨ SEEDING, CLASS 3
- ▩ EROSION CONTROL BLANKET
- ~ WETLANDS



REVISIONS	
NAME	DATE

ILLINOIS DEPARTMENT OF TRANSPORTATION

SCALE: VERT. _____
 HORIZ. _____
 DATE _____

DRAWN BY JW
 CHECKED BY MGZ

EROSION AND SEDIMENT CONTROL

PLOT DATE * * * * *
 PLOT TIME * * * * *
 PLOT SCALE * * * * *
 USER NAME * * * * *