

F.A.P. RTE.	SECTION	COUNTY	TOTAL SHEETS	SHEET NO.
308	100B, 101B-1, 102B-2R	ROCK ISLAND	210	73
STA. 1525+00		TO STA. 1540+00		
FED. ROAD DIST. NO. 2		ILLINOIS	FED. AID PROJECT	

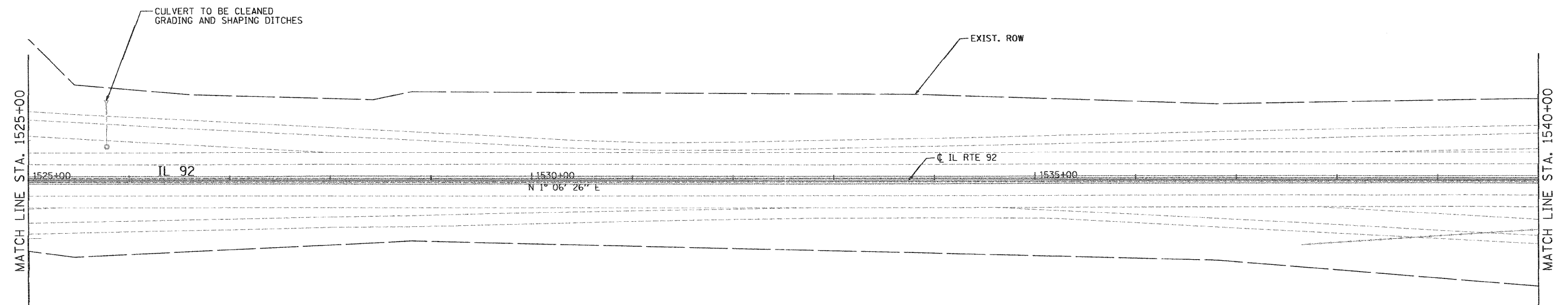

**EROSION AND SEDIMENT CONTROL MEASURES APPLICATION NOTES:**

1. PLACE THE PERIMETER EROSION BARRIER PRIOR TO ANY EXCAVATION OR GRADING ACTIVITIES. INSTALL PROTECTION AT LOCATIONS SHOWN ON THE PLANS.
2. PLACE EMBANKMENT FOR SHOULDER WIDENING AND STABILIZE WITH SEEDING, CLASS 3 AS THE SHOULDER WIDENING PROGRESSES. FOR ADDITIONAL STABILIZATION ON SLOPES 1:3 OR STEEPER USE EROSION CONTROL BLANKET.
3. TEMPORARILY SEED ANY BARE EARTH OR DISTURBED AREAS EVERY 7 DAYS IN ACCORDANCE WITH ARTICLE 280.04 OF THE STANDARD SPECIFICATIONS. SLOPES 1:3 OR STEEPER WILL REQUIRE MULCH, METHOD 2 APPLICATION.
4. FERTILIZER NUTRIENTS SHALL BE APPLIED IN ACCORDANCE WITH THE ARTICLE 250.04 OF THE STANDARD SPECIFICATIONS.

**LEGEND:**

- INLET PROTECTION STD 280001
- PERIMETER EROSION BARRIER
- STONE RIPRAP
- SEEDING, CLASS 3
- EROSION CONTROL BLANKET
- WETLANDS



REVISIONS	
NAME	DATE

ILLINOIS DEPARTMENT OF TRANSPORTATION

SCALE: VERT. \_\_\_\_\_  
 HORIZ. \_\_\_\_\_  
 DATE \_\_\_\_\_

DRAWN BY JW  
 CHECKED BY MGZ

PLOT DATE \* DATE \*  
 PLOT SCALE \* REVISIONS \*  
 USER NAME \* USERID \*

**EROSION AND SEDIMENT CONTROL**