

STATE OF ILLINOIS
DEPARTMENT OF TRANSPORTATION

ROUTE NO.	SECTION	COUNTY	100% EST.	SHEET NO.	SHEET NO. 8
F.A.P. 308	*	ROCK ISLAND	210	92	31 SHEETS
FED. ROAD DIST. NO. 7	ILLINOIS	FED. AID PROJECT-			

Contract #64814 * (1HB,HB-1,VB,HB-2)R

WEST CURB LINE

Location	Station	Offset*	Theoretical Grade Elevations
End S. Appr. Pavement	1469+70.62	-18.42	581.20
A	1469+80.62	-18.42	581.30
B	1469+90.62	-18.42	581.39
Bk. S. Abut.	1470+00.62	-18.42	581.48
Bk. N. Abut.	1471+28.29	-18.42	581.62
C	1471+38.29	-18.42	581.57
D	1471+48.29	-18.42	581.50
End N. Appr. Pavement	1471+58.29	-18.42	581.42

WEST EDGE OF PAVEMENT

Location	Station	Offset*	Theoretical Grade Elevations
End S. Appr. Pavement	1469+67.85	-12.00	581.30
A	1469+77.85	-12.00	581.41
B	1469+87.85	-12.00	581.50
Bk. S. Abut.	1469+97.85	-12.00	581.59
Bk. N. Abut.	1471+25.52	-12.00	581.77
C	1471+35.52	-12.00	581.72
D	1471+45.52	-12.00	581.65
End N. Appr. Pavement	1471+55.52	-12.00	581.57

NORTHBOUND P.G.L.

Location	Station	Offset*	Theoretical Grade Elevations
End S. Appr. Pavement	1469+62.67	0.00	581.43
A	1469+72.67	0.00	581.54
B	1469+82.67	0.00	581.64
Bk. S. Abut.	1469+92.67	0.00	581.73
Bk. N. Abut.	1471+20.34	0.00	581.99
C	1471+30.34	0.00	581.93
D	1471+40.34	0.00	581.87
End N. Appr. Pavement	1471+50.34	0.00	581.80

EAST EDGE OF PAVEMENT

Location	Station	Offset*	Theoretical Grade Elevations
End S. Appr. Pavement	1469+57.49	12.00	581.18
A	1469+67.49	12.00	581.30
B	1469+77.49	12.00	581.40
Bk. S. Abut.	1469+87.49	12.00	581.50
Bk. N. Abut.	1471+15.16	12.00	581.82
C	1471+25.16	12.00	581.77
D	1471+35.16	12.00	581.72
End N. Appr. Pavement	1471+45.16	12.00	581.65

EAST CURB LINE

Location	Station	Offset*	Theoretical Grade Elevations
End S. Appr. Pavement	1469+53.00	22.42	580.91
A	1469+63.00	22.42	581.03
B	1469+73.00	22.42	581.14
Bk. S. Abut.	1469+83.00	22.42	581.24
Bk. N. Abut.	1471+10.67	22.42	581.62
C	1471+20.67	22.42	581.58
D	1471+30.67	22.42	581.53
End N. Appr. Pavement	1471+40.67	22.42	581.47

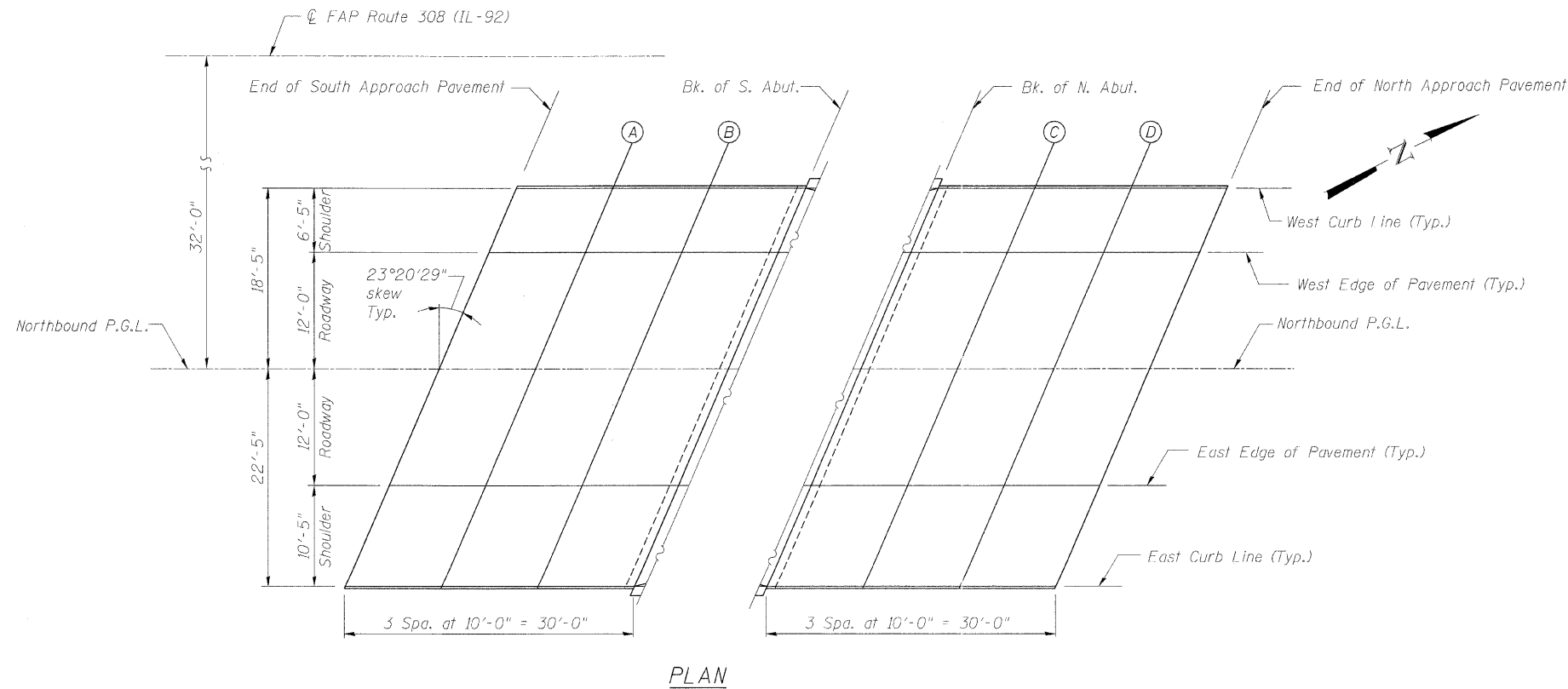

* Offsets are taken from Northbound P.G.L.

TOP OF NORTH AND SOUTH APPROACH
SLAB ELEVATIONS (NB)
IL ROUTE 92 (CENTENNIAL EXPRESSWAY)
OVER 31st AVENUE
FAP ROUTE 308 SEC. 1(HB-2)R
ROCK ISLAND COUNTY
STATION 1470+70.31
STR. 081-0172 (SB) STR. NO. 081-0173 (NB)

DESIGNED	CMM
CHECKED	JSD
DRAWN	EF
CHECKED	RWC

LOCHNER
H.W. LOCHNER, INC., CHICAGO, ILLINOIS

t:\2082\st-uct\dgn\2044023EL4.dgn