

STATE OF ILLINOIS  
DEPARTMENT OF TRANSPORTATION

ROUTE NO.	SECTION	COUNTY	SHEET NO.	SHEET NO.
F.A.P. 308	#	ROCK ISLAND	210	182
27 SHEETS				
FED. ROAD DIST. NO. 7	ILLINOIS FED. AID PROJECT			
Contract #64814 * (HB,HB-1,VB,HB-2)R				

WEST CURB LINE

Location	Station	Offset	Theoretical Grade Elevations
End S. Appr. Pavement	1546+34.35	-37.00	572.14
A	1546+44.23	-37.26	572.26
B	1546+54.11	-37.56	572.36
Bk. S. Abut.	1546+63.99	-37.89	572.46
Bk. N. Abut.	1547+81.12	-37.89	572.53
C	1547+91.00	-37.56	572.45
D	1548+00.88	-37.26	572.36
End N. Appr. Pavement	1548+10.76	-37.00	572.26

WEST EDGE OF PAVEMENT

Location	Station	Offset	Theoretical Grade Elevations
End S. Appr. Pavement	1546+34.04	-27.00	571.94
A	1546+43.95	-27.00	572.05
B	1546+53.86	-27.00	572.15
Bk. S. Abut.	1546+63.77	-27.00	572.24
Bk. N. Abut.	1547+81.34	-27.00	572.32
C	1547+91.25	-27.00	572.24
D	1548+01.16	-27.00	572.16
End N. Appr. Pavement	1548+11.07	-27.00	572.06

PROFILE GRADE LINE

Location	Station	Offset	Theoretical Grade Elevations
End S. Appr. Pavement	1546+33.30	-3.00	571.45
A	1546+43.30	-3.00	571.56
B	1546+53.29	-3.00	571.66
Bk. S. Abut.	1546+63.29	-3.00	571.75
Bk. N. Abut.	1547+81.82	-3.00	571.83
C	1547+91.82	-3.00	571.76
D	1548+01.82	-3.00	571.67
End N. Appr. Pavement	1548+11.81	-3.00	571.57

STAGE CONST. LINE

Location	Station	Offset	Theoretical Grade Elevations
End S. Appr. Pavement	1546+33.38	-5.50	571.50
A	1546+43.36	-5.21	571.61
B	1546+53.34	-4.95	571.70
Bk. S. Abut.	1546+63.32	-4.73	571.79
Bk. N. Abut.	1547+81.80	-4.73	571.87
C	1547+91.78	-4.95	571.80
D	1548+01.76	-5.21	571.71
End N. Appr. Pavement	1548+11.74	-5.50	571.62

Q FAP ROUTE 308 (IL-92)

Location	Station	Offset	Theoretical Grade Elevations
End S. Appr. Pavement	1546+33.21	0.00	571.39
A	1546+43.21	0.00	571.50
B	1546+53.22	0.00	571.60
Bk. S. Abut.	1546+63.22	0.00	571.69
Bk. N. Abut.	1547+81.90	0.00	571.77
C	1547+91.90	0.00	571.70
D	1548+01.90	0.00	571.61
End N. Appr. Pavement	1548+11.90	0.00	571.51

EAST EDGE OF PAVEMENT

Location	Station	Offset	Theoretical Grade Elevations
End S. Appr. Pavement	1546+32.36	27.00	570.84
A	1546+42.46	27.00	570.95
B	1546+52.56	27.00	571.06
Bk. S. Abut.	1546+62.65	27.00	571.15
Bk. N. Abut.	1547+82.46	27.00	571.23
C	1547+92.56	27.00	571.15
D	1548+02.66	27.00	571.06
End N. Appr. Pavement	1548+12.76	27.00	570.96

EAST CURB LINE

Location	Station	Offset	Theoretical Grade Elevations
End S. Appr. Pavement	1546+32.04	37.00	570.63
A	1546+42.17	37.12	570.75
B	1546+52.30	37.21	570.85
Bk. S. Abut.	1546+62.44	37.26	570.94
Bk. N. Abut.	1547+82.67	37.26	571.02
C	1547+92.81	37.21	570.94
D	1548+02.94	37.12	570.86
End N. Appr. Pavement	1548+13.07	37.00	570.75

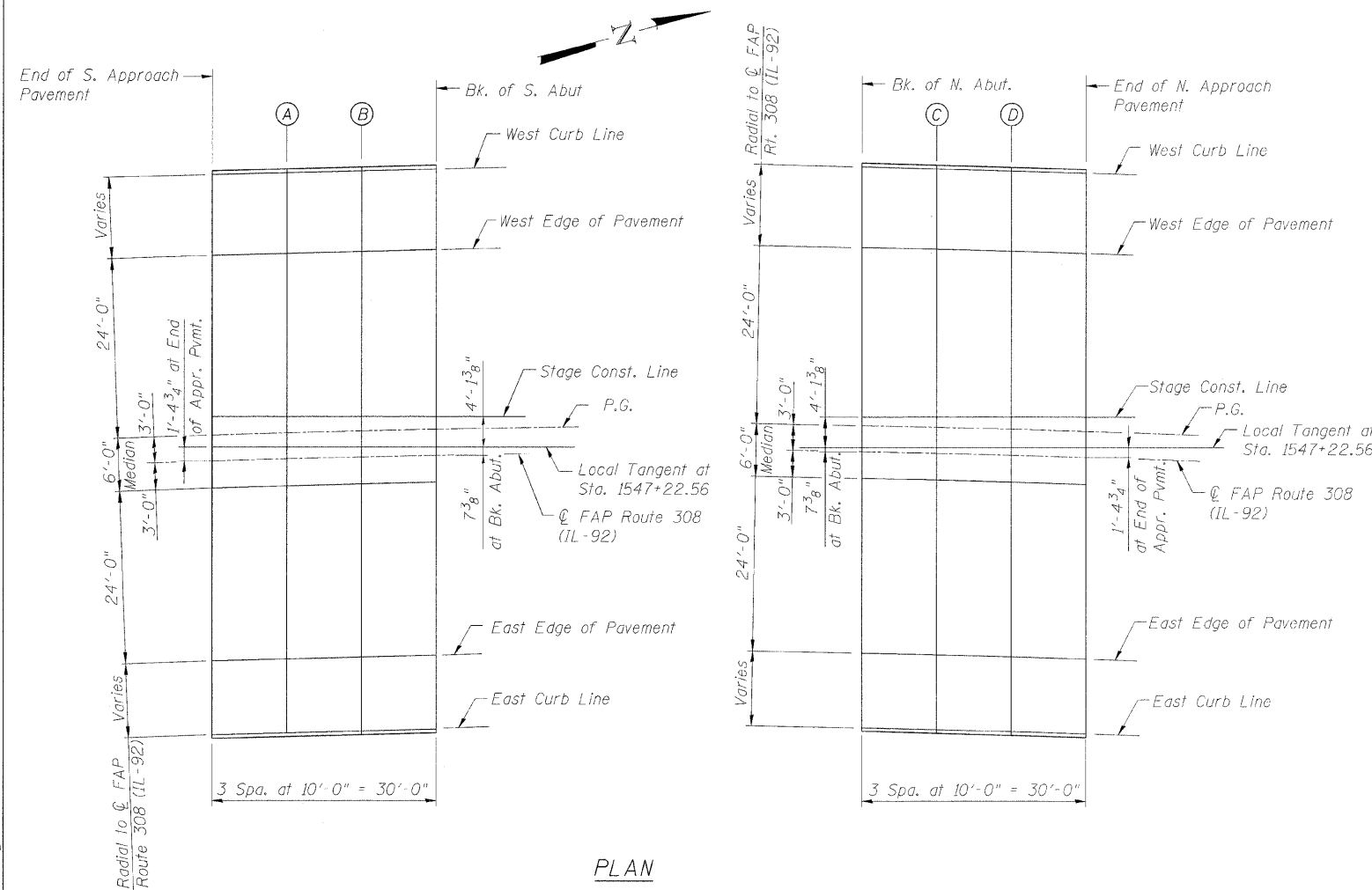

PLAN

DESIGNED	CMM
CHECKED	JSD
DRAWN	EF
CHECKED	AMK

**LOCHNER**  
H.W. LOCHNER, INC., CHICAGO, ILLINOIS

TOP OF APPROACH SLAB ELEVATIONS  
IL ROUTE 92 (CENTENNIAL EXPRESSWAY)  
OVER 7th AVENUE  
FAP ROUTE 308 SEC. 1(HB)R  
ROCK ISLAND COUNTY  
STATION 1547+22.56  
STRUCTURE NO. 081-0170