

F.A. RTE.	SECTION	COUNTY	TOTAL SHEETS	SHEET NO.
308		ROCK ISLAND	210	204
STA. _____		TO STA. _____		
FED. ROAD DIST. NO. _____		ILLINOIS FED. AID PROJECT		

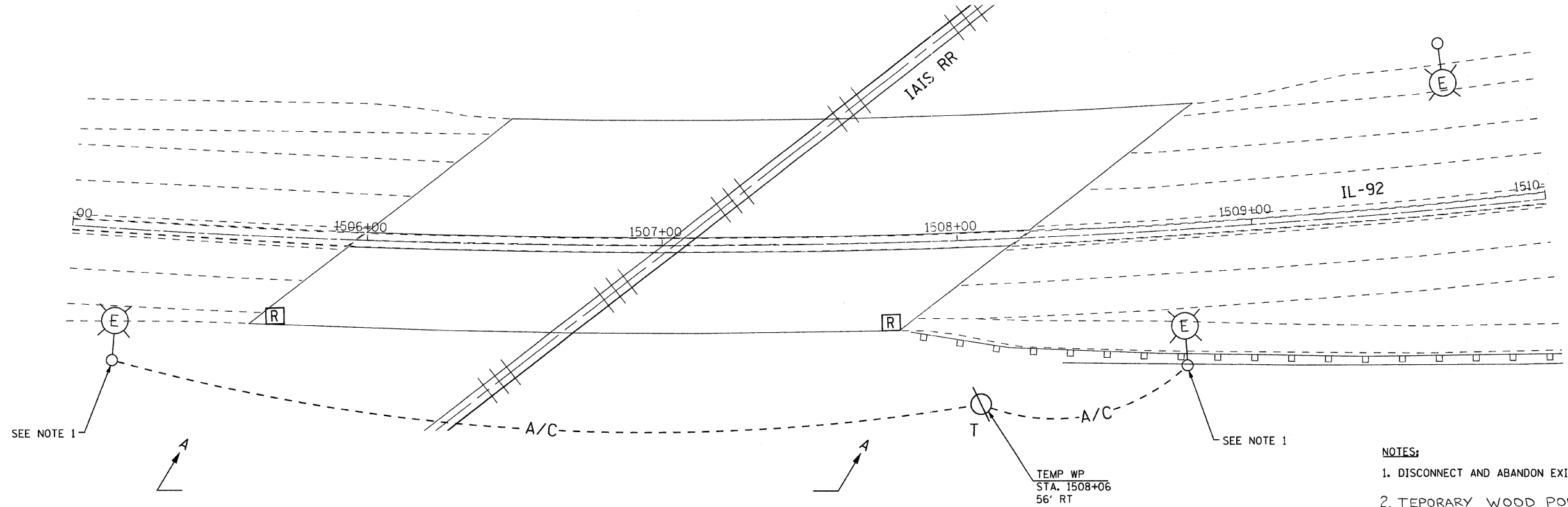

PLAN
1" = 20'

- NOTES:**
1. DISCONNECT AND ABANDON EXISTING CIRCUITRY TO UNDERPASS JUNCTION BOX.
 2. TEMPORARY WOOD POLES AND AERIAL CABLE SHALL BE REMOVED AFTER PROPOSED CIRCUIT IS OPERATIONAL. REMOVAL OF WOOD POLES AND AERIAL CABLE SHALL BE PAID FOR UNDER "REMOVAL OF TEMPORARY LIGHTING UNITS."

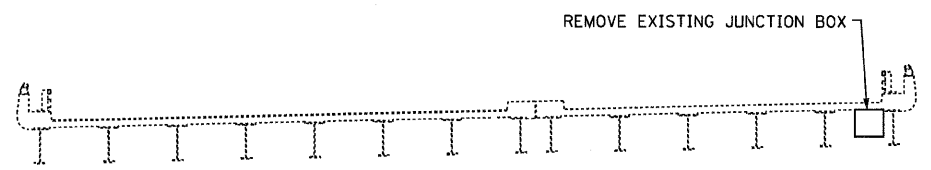

SECTION THROUGH BRIDGE
LOOKING NORTH
NOT TO SCALE

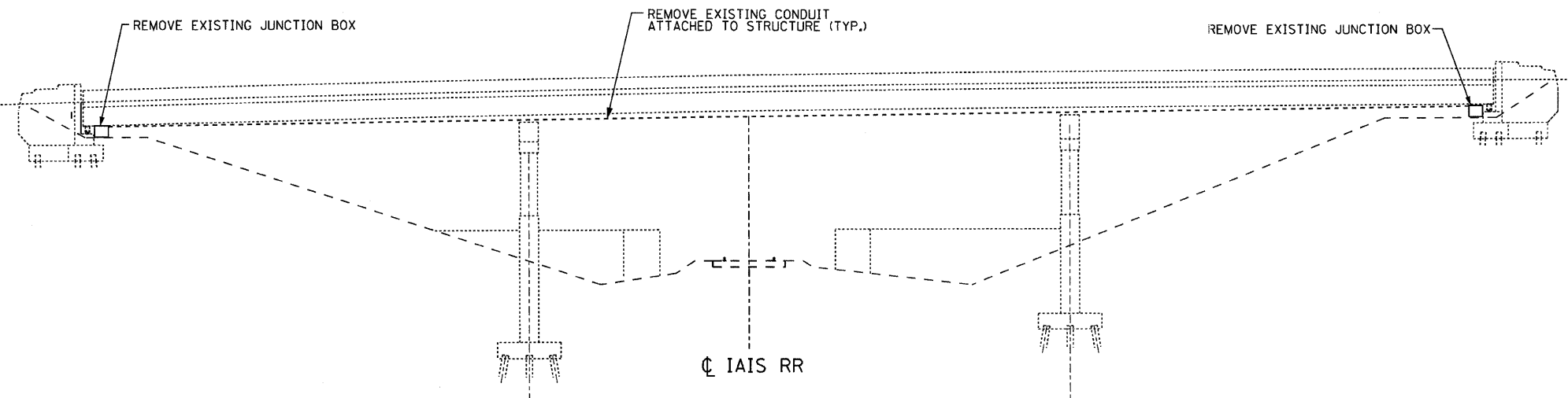

SECTION A-A
LOOKING EAST
NOT TO SCALE

EJM EJM ENGINEERING, INC.
411 South Wells Street Suite 800
Chicago, Illinois 60607

REVISIONS	
NAME	DATE

ILLINOIS DEPARTMENT OF TRANSPORTATION
ILLINOIS ROUTE 92
TEMPORARY AND REMOVAL PLAN
IAIS RAILROAD

SCALE: 1"=20'
DATE: 11/26/07
DRAWN BY: JDM
CHECKED BY: JH

PLOT DATE = #DATE#
FILE NAME = #FILE#
USER NAME = #USER#