

STATE OF ILLINOIS
DEPARTMENT OF TRANSPORTATION

ROUTE NO.	SECTION	COUNTY	TOTAL SHEETS	SHEET NO.	SHEET NO. 27
F.A.P. 308	*	ROCK ISLAND	210	202	27 SHEETS
FED. ROAD DIST. NO. 7	ILLINOIS	FED. AID PROJECT			

Contract #64814 * (1HB,HB-1,VB,HB-2)R

Illinois Department of Transportation
Division of Highways
IDOT

SOIL BORING LOG Page 1 of 1
Date 3/25/04

ROUTE FAP 308 DESCRIPTION P-92-044-02 IL 92 bridge (Centennial Expressway) over 7th Avenue LOGGED BY W. Garza

SECTION 1(HB, HB-1, VB, HB-2) R LOCATION . SEC. TWP. RNG.

COUNTY Rock Island DRILLING METHOD Hollow Stem Auger HAMMER TYPE CME-45 Automatic

STRUCT. NO. 1
Station 344+58
BORING NO. B-3a
Station 344+88
Offset 70.50ft Lt CL
Ground Surface Elev. 82.2 ft

SOIL TYPE	DEPTH (ft)	(ft)	(ft)	(%)	Failure Mode
MEDIUM brown SILTY LOAM	80.20		0.5	25	
MEDIUM brown SANDY LOAM	78.70	6	0.5	40	
MEDIUM brown SILTY CLAY LOAM	75.70	2	0.5	28	
MEDIUM tan/gray fine SAND with CLAY lens	73.70	3		14	
DENSE gray/tan well cemented fine SAND	71.20	12			
VERY DENSE tan SANDSTONE	69.20	100/1"			

Borehole continued with rock coring.

The Unconfined Compressive Strength (UCS) Failure Mode is indicated by (B-Bulge, S-Shear, P-Penetrometer)
The SPT (N value) is the sum of the last two blow values in each sampling zone (AASHTO T206)

BBS, from 137 (Rev. 8-99)

Illinois Department of Transportation
Division of Highways
IDOT

SOIL BORING LOG Page 1 of 1
Date 4/1/04

ROUTE FAP 308 DESCRIPTION P-92-044-02 IL 92 bridge (Centennial Expressway) over 7th Avenue LOGGED BY W. Garza

SECTION 1(HB, HB-1, VB, HB-2) R LOCATION . SEC. TWP. RNG.

COUNTY Rock Island DRILLING METHOD Hollow Stem Auger HAMMER TYPE B-53 Diehrich Automatic

STRUCT. NO. 1
Station 344+58
BORING NO. B-4a
Station 345+40
Offset 33.00ft Rt CL
Ground Surface Elev. 99.0 ft

SOIL TYPE	DEPTH (ft)	(ft)	(ft)	(%)	Failure Mode
MEDIUM tan SILTY LOAM	96.50		0.5	13	
MEDIUM tan SILT	95.00	4	0.8	16	
MEDIUM tan SILT	92.50	4	0.6	17	
MEDIUM tan SILT	90.00	5	0.6	21	
SOFT tan SILT	87.50	4	0.4	21	
SOFT tan SILT with LOAM lens at bottom	85.00	2	0.4	24	
MEDIUM tan SILT	82.00	6	0.9	20	
VERY DENSE tan weathered LIMESTONE	80.00	2	100/3"		

Auger Refusal at 19.0' old concrete road

The Unconfined Compressive Strength (UCS) Failure Mode is indicated by (B-Bulge, S-Shear, P-Penetrometer)
The SPT (N value) is the sum of the last two blow values in each sampling zone (AASHTO T206)

BBS, from 137 (Rev. 8-99)

t:\20826\st-uc\tdgn\20440275B2.dgn

DESIGNED
CHECKED
DRAWN
CHECKED

LOCHNER
H.W. LOCHNER, INC., CHICAGO, ILLINOIS

SOIL BORINGS 2
IL ROUTE 92 (CENTENNIAL EXPRESSWAY)
OVER 7th AVENUE
FAP ROUTE 308 SEC. 1(HB)R
ROCK ISLAND COUNTY
STATION 1547+22.56
STRUCTURE NO. 081-0170

F.A. RTE.	SECTION	COUNTY	TOTAL SHEETS	SHEET NO.
308		ROCK ISLAND	210	203
STA. _____		TO STA. _____		
FED. ROAD DIST. NO. _____		ILLINOIS FED. AID PROJECT		











NOTES:

1. THE ELECTRICAL WORK SHALL BE PERFORMED IN ACCORDANCE WITH THE LATEST IDOT STANDARDS, NATIONAL ELECTRICAL CODE AS WELL AS THE NATIONAL ELECTRICAL SAFETY CODE.
2. COORDINATE THE INSTALLATION OF TEMPORARY AND PERMANENT ROADWAY LIGHTING WITH THE CONSTRUCTION STAGING.
3. COORDINATE THE INSTALLATION OF ROADWAY LIGHTING AND UNDERGROUND WORK WITH THE OTHER TRADES.
4. CONTRACTOR SHALL BE RESPONSIBLE FOR MAINTENANCE OF THE EXISTING AND PROPOSED LIGHTING DURING CONSTRUCTION, AS INDICATED ON THE PLANS AND AS DIRECTED BY THE ENGINEER.

SCHEDULE OF QUANTITIES - IL-92

PAY ITEM	DESCRIPTION	UNIT	QUANTITY
81078500	CONDUIT PUSHED, 2" DIA., GALVANIZED STEEL	FOOT	470
81100300	CONDUIT ATTACHED TO STRUCTURE, 1" DIA., GALVANIZED STEEL	FOOT	380
81300220	JUNCTION BOX, STAINLESS STEEL, ATTACHED TO STRUCTURE, 6" X 6" X 4"	EACH	6
81300530	JUNCTION BOX, STAINLESS STEEL, ATTACHED TO STRUCTURE, 12" X 10" X 6"	EACH	4
81300730	JUNCTION BOX, STAINLESS STEEL, ATTACHED TO STRUCTURE, 16" X 14" X 6"	EACH	4
81306500*	REMOVE EXISTING JUNCTION BOX	EACH	8
81603010	UNIT DUCT, 600V, 2-1C NO.10, 1/C NO.10 GROUND, XLP TYPE USE, 3/4" DIA. POLYETHYLENE	FOOT	420
81603040	UNIT DUCT, 600V, 2-1C NO.6, 1/C NO.8 GROUND, XLP TYPE USE, 1" DIA. POLYETHYLENE	FOOT	1930
81800230	AERIAL CABLE, 2-1/C NO. 6 WITH MESSENGER WIRE	FOOT	1760
81900200	TRENCH AND BACKFILL FOR ELECTRICAL WORK	FOOT	1000
82107300	UNDERPASS LUMINAIRE, 150 WATT, HIGH PRESSURE SODIUM VAPOR	EACH	8
83057340	LIGHT POLE, WOOD, 60 FOOT, CLASS 3	EACH	5
84200600	REMOVAL OF EXISTING LIGHTING UNIT, NO SALVAGE	EACH	4
84400110	REMOVAL OF TEMPORARY LIGHTING UNITS	EACH	5
81100600	CONDUIT ATTACHED TO STRUCTURE, 2" DIA., GALVANIZED STEEL	FOOT	210

LEGEND

-  EXISTING ROADWAY LIGHTING UNIT TO REMAIN
-  PROPOSED 150 WATT UNDERPASS LIGHTING UNIT
-  EXISTING UNDERPASS LIGHTING UNIT TO BE REMOVED
-  EXISTING JUNCTION BOX TO BE REMOVED
-  PROPOSED JUNCTION BOX, ATTACHED TO STRUCTURE, SIZE AS NOTED
-  TEMPORARY WOOD POLE, 60' WOOD POLE (TEMP WP)
-  PROPOSED AERIAL CABLE, 2-1/C #6 WITH MESSENGER WIRE, UNLESS OTHERWISE NOTED
-  PROPOSED 2" CONDUIT, PUSHED WITH 2*6 & 1*8 GROUND IN 1" UD
-  PROPOSED UNIT DUCT IN TRENCH, SIZE AS NOTED
-  PROPOSED CONDUIT ATTACHED TO STRUCTURE, SIZE AS NOTED
- RGS RIGID GALVANIZED STEEL
- ATS CONDUIT ATTACHED TO STRUCTURE
- UD UNIT DUCT, 1", WITH 2*6 & 1*8 GROUND, UNLESS OTHERWISE NOTED



REVISIONS	
NAME	DATE

ILLINOIS DEPARTMENT OF TRANSPORTATION
ILLINOIS ROUTE 92

LIGHTING GENERAL NOTES,
SYMBOLS AND QUANTITIES

SCALE: 1"=20'
DATE: 11/26/07

DRAWN BY: JDM
CHECKED BY: JH

F.A. RTE.	SECTION	COUNTY	TOTAL SHEETS	SHEET NO.
308		ROCK ISLAND	210	204
STA. _____		TO STA. _____		
FED. ROAD DIST. NO. _____		ILLINOIS FED. AID PROJECT		

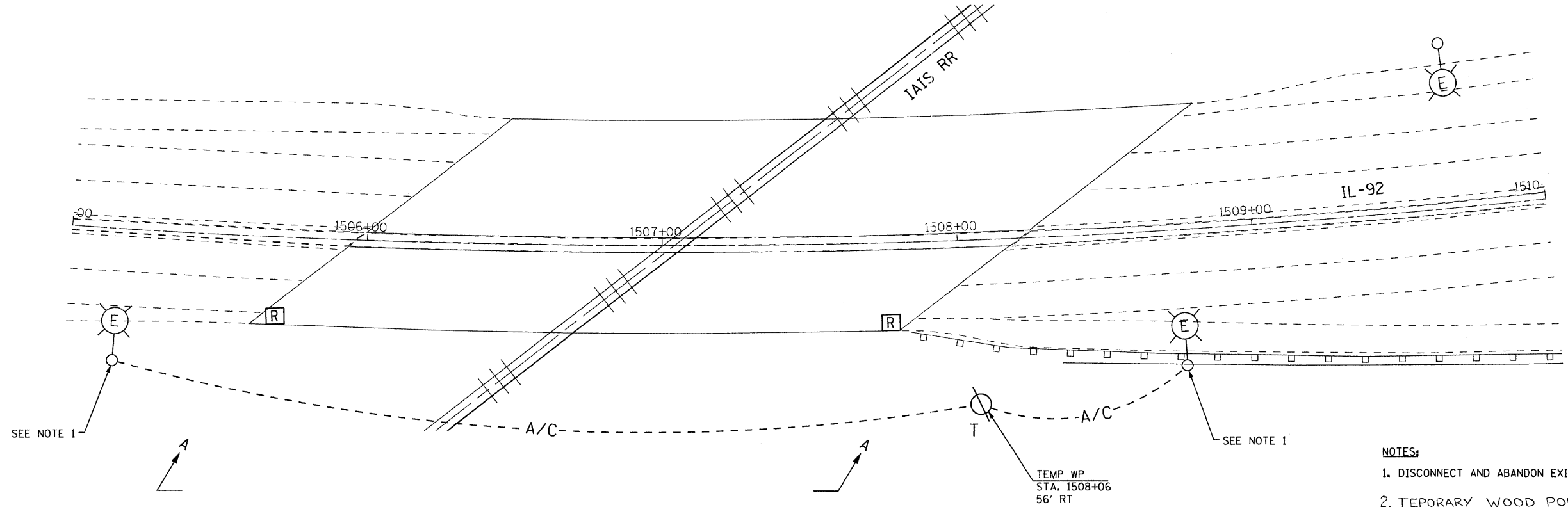

PLAN
1" = 20'

- NOTES:
1. DISCONNECT AND ABANDON EXISTING CIRCUITRY TO UNDERPASS JUNCTION BOX.
 2. TEMPORARY WOOD POLES AND AERIAL CABLE SHALL BE REMOVED AFTER PROPOSED CIRCUIT IS OPERATIONAL. REMOVAL OF WOOD POLES AND AERIAL CABLE SHALL BE PAID FOR UNDER "REMOVAL OF TEMPORARY LIGHTING UNITS."

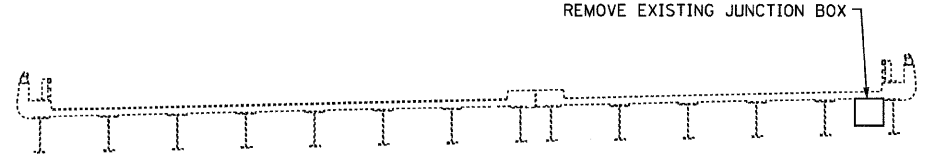

SECTION THROUGH BRIDGE
LOOKING NORTH
NOT TO SCALE

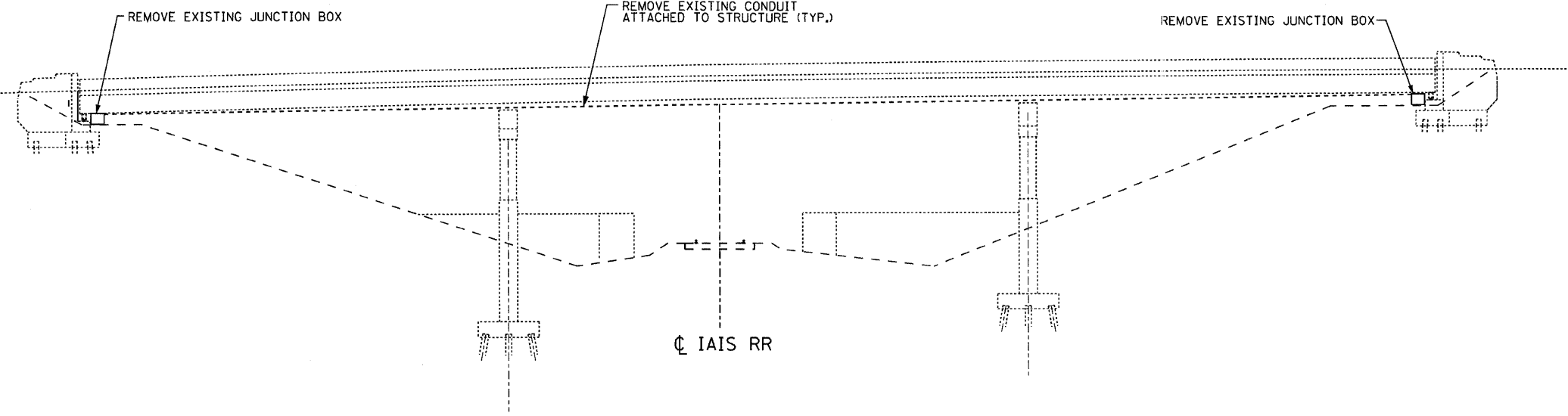

SECTION A-A
LOOKING EAST
NOT TO SCALE

EJM EJM ENGINEERING, INC.
411 South Wells Street Suite 800
Chicago, Illinois 60607

REVISIONS	
NAME	DATE

ILLINOIS DEPARTMENT OF TRANSPORTATION
ILLINOIS ROUTE 92
TEMPORARY AND REMOVAL PLAN
IAIS RAILROAD

SCALE: 1"=20'
DATE: 11/26/07
DRAWN BY: JDM
CHECKED BY: JH

PLOT DATE = #DATE#
FILE NAME = #FILE#
USER NAME = #USER#

F.A. RTE.	SECTION	COUNTY	TOTAL SHEETS	SHEET NO.
308		ROCK ISLAND	210	205
STA.		TO STA.		
FED. ROAD DIST. NO.		ILLINOIS FED. AID PROJECT		

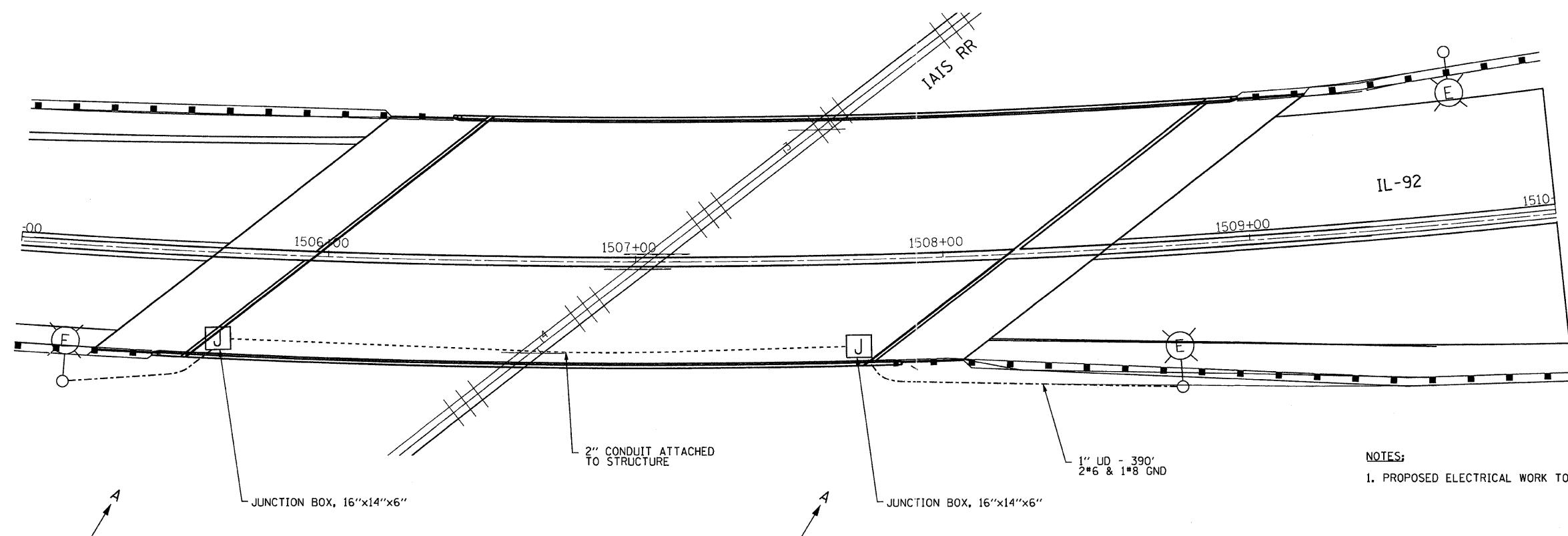

NOTES:
1. PROPOSED ELECTRICAL WORK TO BE DONE DURING STAGE 3.

PLAN
1" = 20'

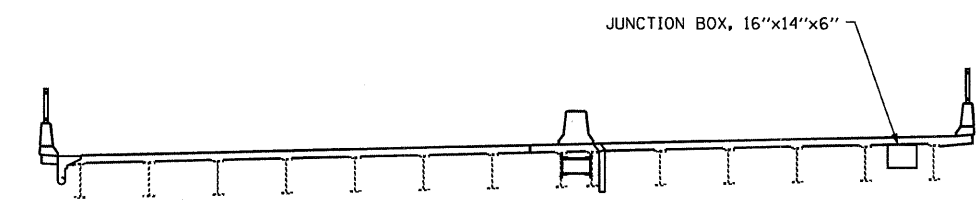

SECTION THROUGH BRIDGE
LOOKING NORTH
NOT TO SCALE

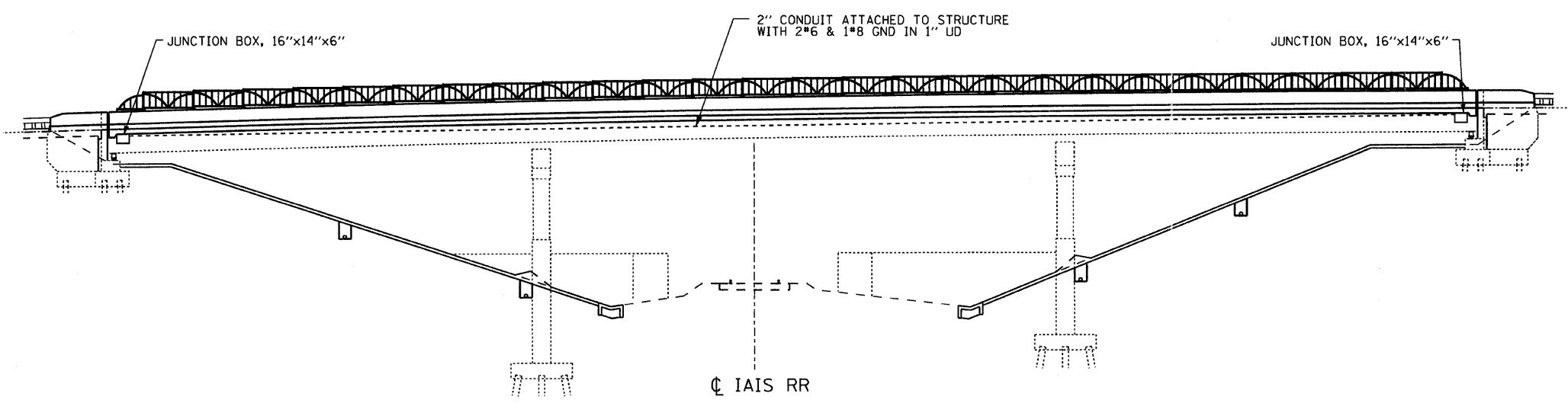

SECTION A-A
LOOKING WEST
NOT TO SCALE

EJM EJM ENGINEERING, INC.
411 South Wells Street Suite 800
Chicago, Illinois 60607

REVISIONS	
NAME	DATE

ILLINOIS DEPARTMENT OF TRANSPORTATION
ILLINOIS ROUTE 92

PROPOSED ELECTRICAL PLAN
IAIS RAILROAD

SCALE: 1"=20'
DATE: 11/26/07

DRAWN BY: JDM
CHECKED BY: JH

PLOT DATE * DATES
FILE NAME * FILEL
USER NAME * USERB

F.A. RTE.	SECTION	COUNTY	TOTAL SHEETS	SHEET NO.
308		ROCK ISLAND	210	206
STA. _____		TO STA. _____		
FED. ROAD DIST. NO. _____		ILLINOIS FED. AID PROJECT		

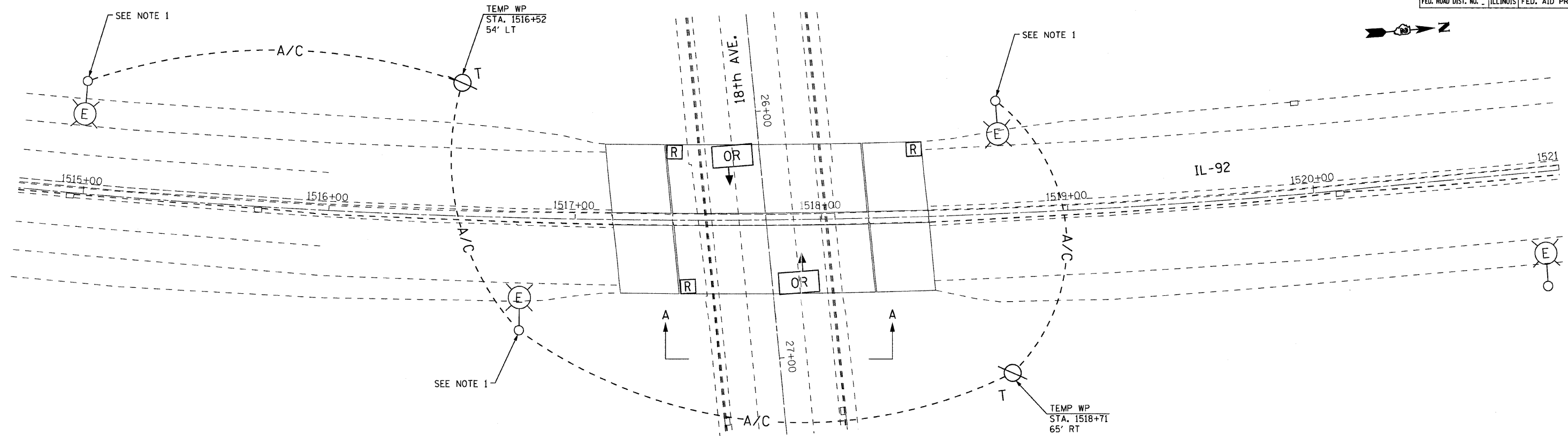

NOTES:

1. DISCONNECT AND ABANDON EXISTING CIRCUITRY TO UNDERPASS JUNCTION BOX.
2. TEMPORARY WOOD POLES AND AERIAL CABLE SHALL BE REMOVED AFTER PROPOSED CIRCUIT IS OPERATIONAL. REMOVAL OF WOOD POLES AND AERIAL CABLE SHALL BE PAID FOR UNDER "REMOVAL OF TEMPORARY LIGHTING UNITS."

PLAN
1" = 20'

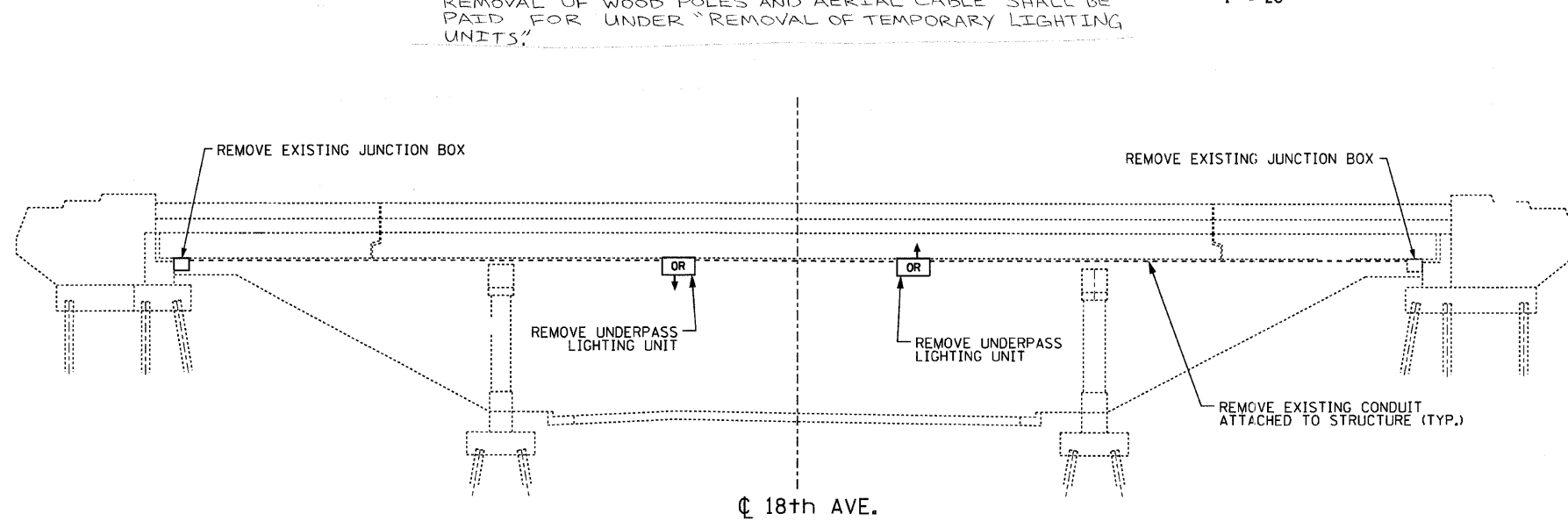

SECTION A-A
LOOKING WEST
NOT TO SCALE

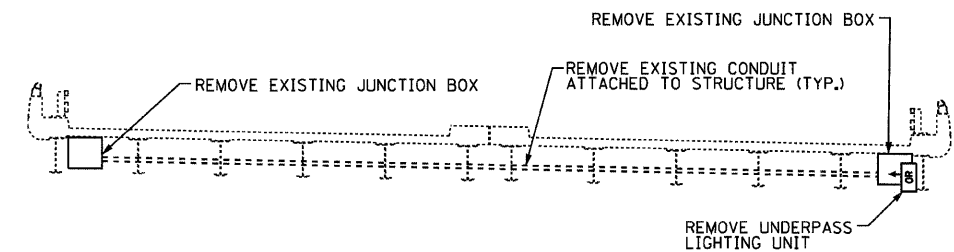

SECTION THROUGH BRIDGE
LOOKING SOUTH
NOT TO SCALE



REVISIONS	
NAME	DATE

ILLINOIS DEPARTMENT OF TRANSPORTATION
ILLINOIS ROUTE 92
TEMPORARY AND REMOVAL PLAN
18TH AVE.

SCALE: 1"=20'
DATE: 11/26/07

DRAWN BY: JDM
CHECKED BY: JH

F.A. RTE. NO.	SECTION	COUNTY	TOTAL SHEETS	SHEET NO.
308	*	ROCK ISLAND	210	207
STA.	TO STA.			
FED. ROAD DIST. NO.	ILLINOIS	FED. AID PROJECT		

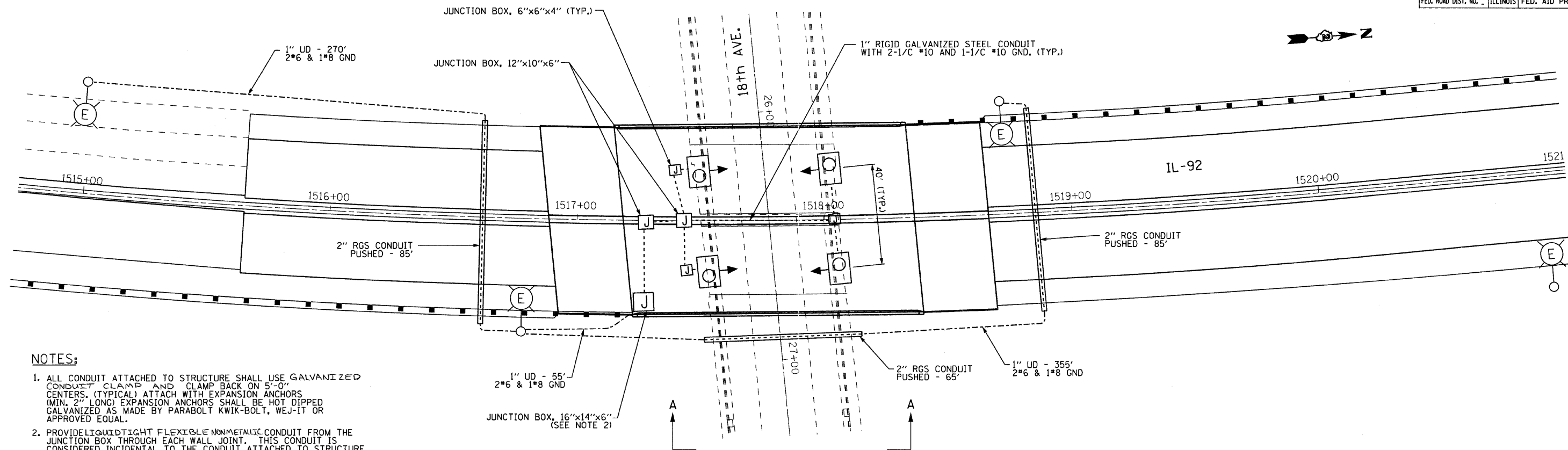

NOTES:

1. ALL CONDUIT ATTACHED TO STRUCTURE SHALL USE GALVANIZED CONDUIT CLAMP AND CLAMP BACK ON 5'-0" CENTERS. (TYPICAL) ATTACH WITH EXPANSION ANCHORS (MIN. 2" LONG) EXPANSION ANCHORS SHALL BE HOT DIPPED GALVANIZED AS MADE BY PARABOLT KWIK-BOLT, WEJ-IT OR APPROVED EQUAL.
2. PROVIDE LIQUID TIGHT FLEXIBLE NONMETALLIC CONDUIT FROM THE JUNCTION BOX THROUGH EACH WALL JOINT. THIS CONDUIT IS CONSIDERED INCIDENTAL TO THE CONDUIT ATTACHED TO STRUCTURE. NO ADDITIONAL COMPENSATION WILL BE ALLOWED.
3. LUMINAIRES SHALL BE SURFACE MOUNTED TO WALL WITH UNISTRUT P5500 STAINLESS STEEL CHANNELS (12 GAUGE) OR APPROVED EQUAL TO PROVIDE A MINIMUM CLEARANCE OF 2" BETWEEN THE BACK OF LUMINAIRE AND THE FACE OF THE WALL.
4. PROPOSED ELECTRICAL WORK TO BE DONE DURING STAGE 3.

PLAN

1" = 20'

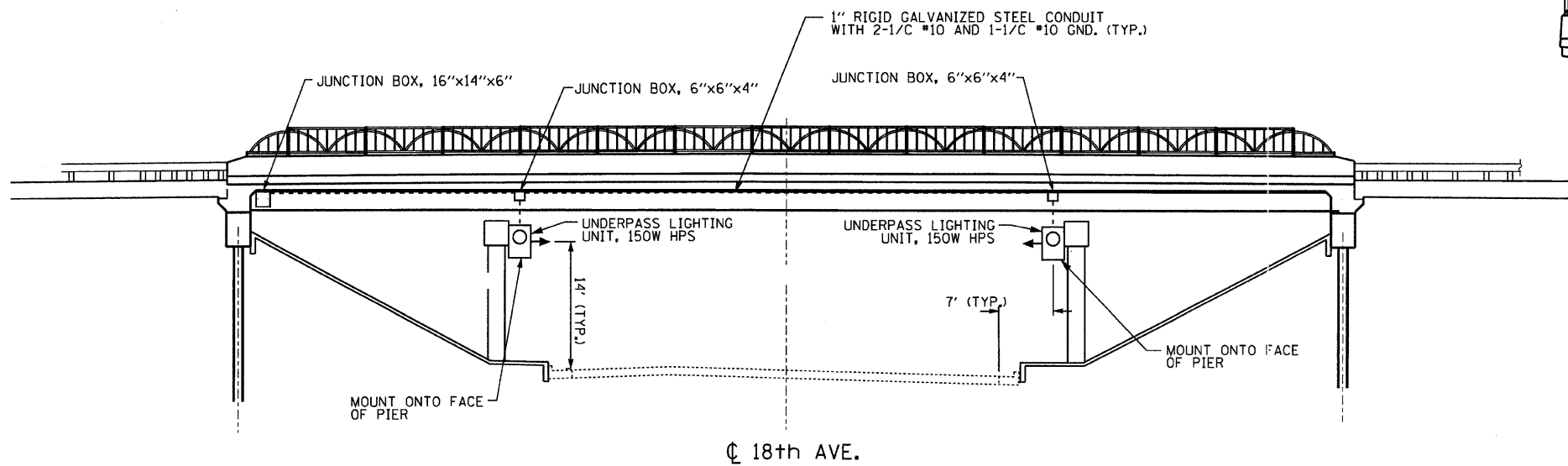

SECTION A-A

LOOKING WEST
NOT TO SCALE

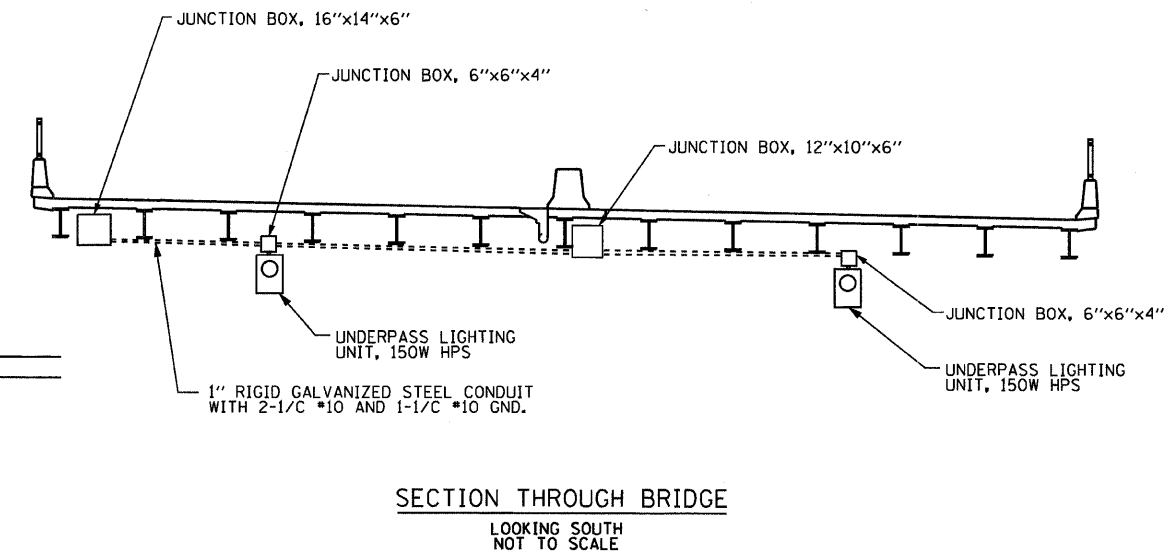

SECTION THROUGH BRIDGE

LOOKING SOUTH
NOT TO SCALE



REVISIONS	
NAME	DATE

ILLINOIS DEPARTMENT OF TRANSPORTATION
ILLINOIS ROUTE 92
PROPOSED ELECTRICAL PLAN
18TH AVE.

SCALE: 1"=20'
DATE: 11/26/07

DRAWN BY: JDM
CHECKED BY: JH

PLOT DATE * DATE *
FILE NAME * FILE *
USER NAME * USER *

F.A. RTE.	SECTION	COUNTY	TOTAL SHEETS	SHEET NO.
308		ROCK ISLAND	210	208
STA.		TO STA.		
FED. ROAD DIST. NO.		ILLINOIS FED. AID PROJECT		

NOTES:

1. DISCONNECT AND ABANDON EXISTING CIRCUITRY TO UNDERPASS JUNCTION BOX.
2. TEMPORARY WOOD POLES AND AERIAL CABLE SHALL BE REMOVED AFTER PROPOSED CIRCUIT IS OPERATIONAL. REMOVAL OF WOOD POLES AND AERIAL CABLE SHALL BE PAID FOR UNDER "REMOVAL OF TEMPORARY LIGHTING UNITS."

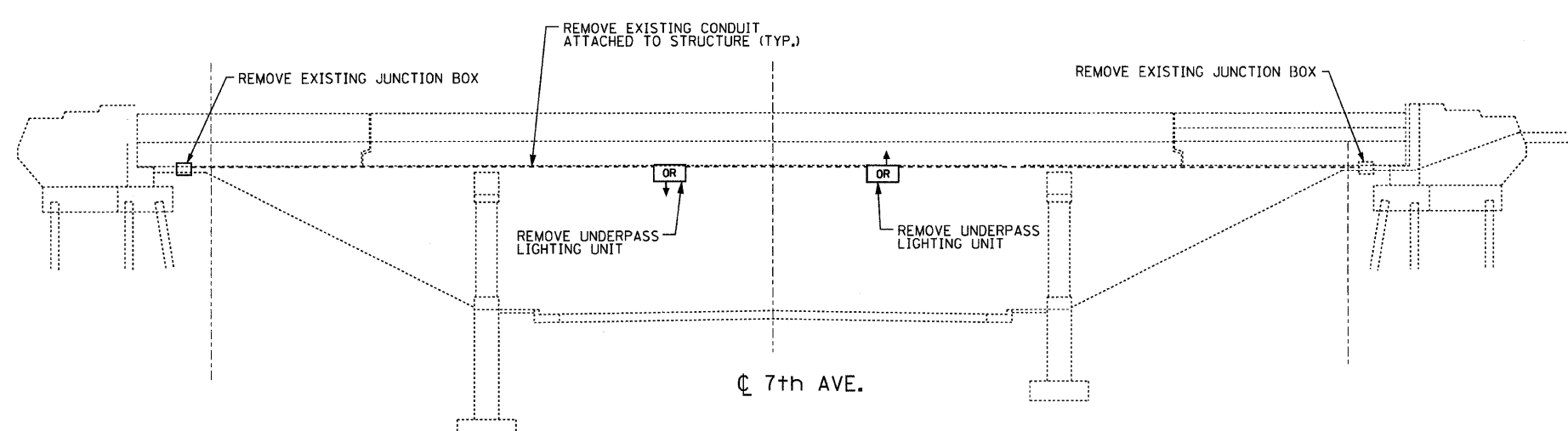
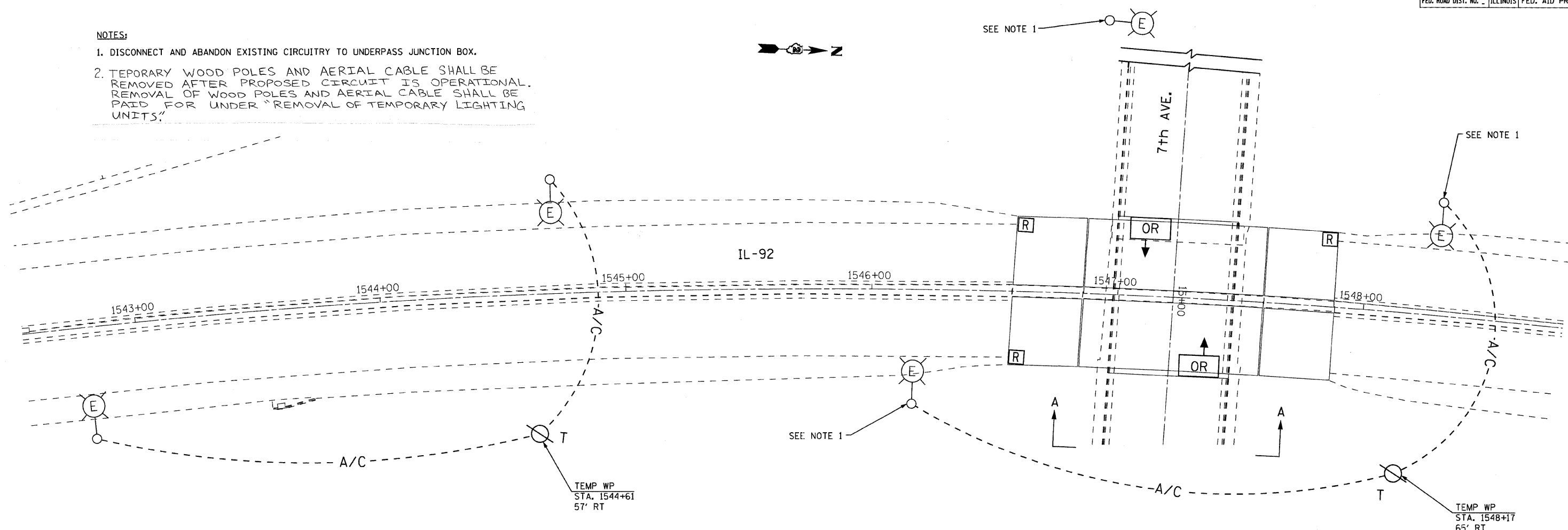

SECTION A-A
LOOKING WEST
NOT TO SCALE

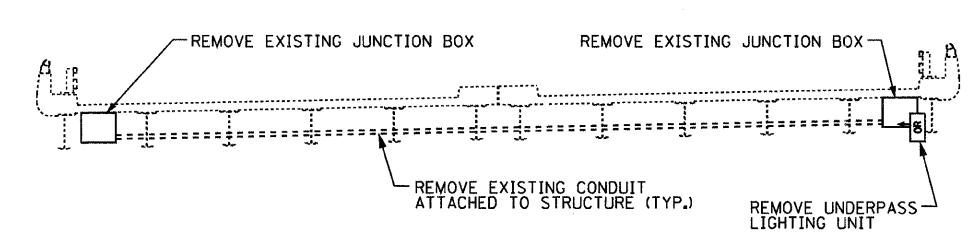

SECTION THROUGH BRIDGE
LOOKING SOUTH
NOT TO SCALE



REVISIONS	
NAME	DATE

ILLINOIS DEPARTMENT OF TRANSPORTATION
ILLINOIS ROUTE 92
TEMPORARY AND REMOVAL PLAN
7TH AVE.
SCALE: 1"=20'
DATE: 11/26/07
DRAWN BY: JDM
CHECKED BY: JH

PLOT DATE: * * * * *
FILE NAME: * * * * *
USER NAME: * * * * *

F.A. RTE.	SECTION	COUNTY	TOTAL SHEETS	SHEET NO.
308		ROCK ISLAND	210	209
STA.	TO STA.			
FED. ROAD DIST. NO.	ILLINOIS	FED. AID PROJECT		

NOTES:

1. ALL CONDUIT ATTACHED TO STRUCTURE SHALL USE GALVANIZED CONDUIT CLAMP AND CLAMP BACK ON 5'-0" CENTERS. (TYPICAL) ATTACH WITH EXPANSION ANCHORS (MIN. 2" LONG) EXPANSION ANCHORS SHALL BE HOT DIPPED GALVANIZED AS MADE BY PARABOLT KWIK-BOLT, WEJ-IT OR APPROVED EQUAL.
2. PROVIDE LIQUID TIGHT FLEXIBLE NONMETALLIC CONDUIT FROM THE JUNCTION BOX THROUGH EACH WALL JOINT. THIS CONDUIT IS CONSIDERED INCIDENTAL TO THE CONDUIT ATTACHED TO STRUCTURE. NO ADDITIONAL COMPENSATION WILL BE ALLOWED.
3. LUMINAIRES SHALL BE SURFACE MOUNTED TO WALL WITH UNISTRUT P5500 STAINLESS STEEL CHANNELS (12 GAUGE) OR APPROVED EQUAL TO PROVIDE A MINIMUM CLEARANCE OF 2" BETWEEN THE BACK OF LUMINAIRE AND THE FACE OF THE WALL.
4. PROPOSED ELECTRICAL WORK TO BE DONE DURING STAGE 3.

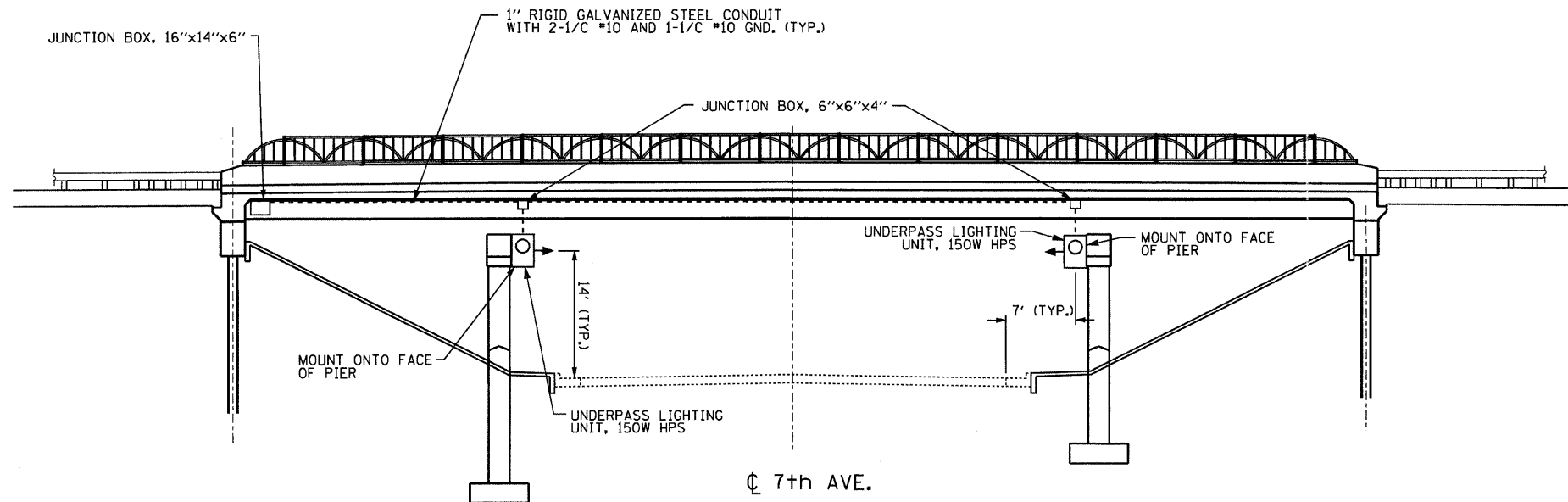
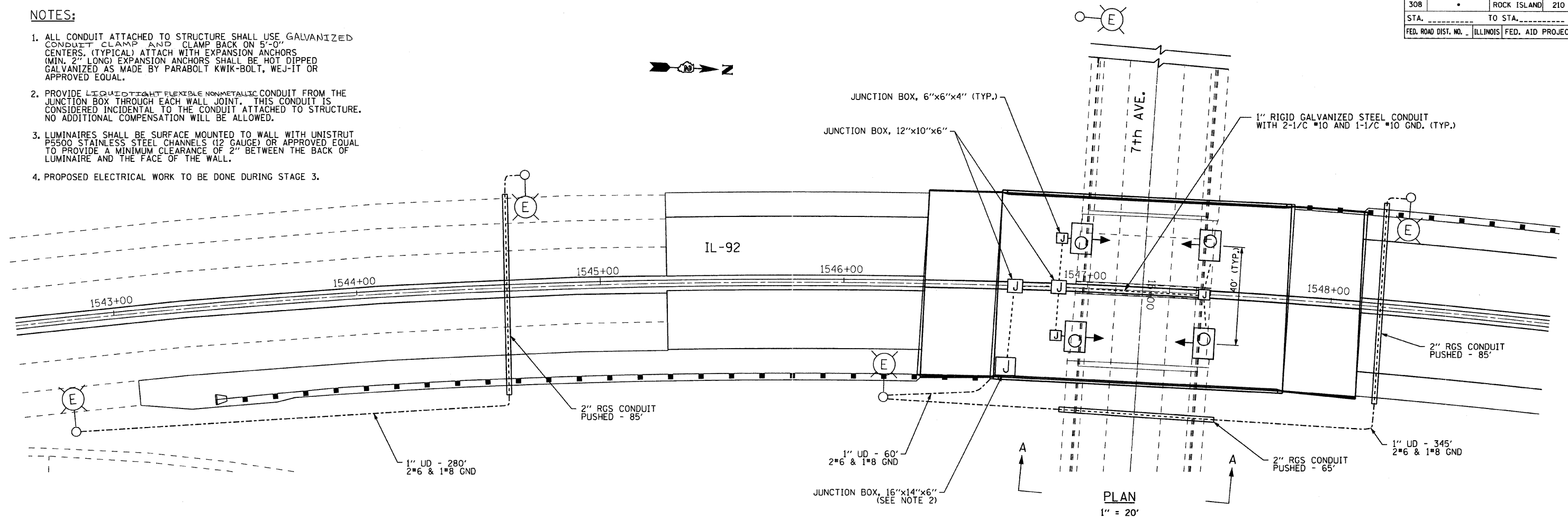

SECTION A-A
LOOKING WEST
NOT TO SCALE

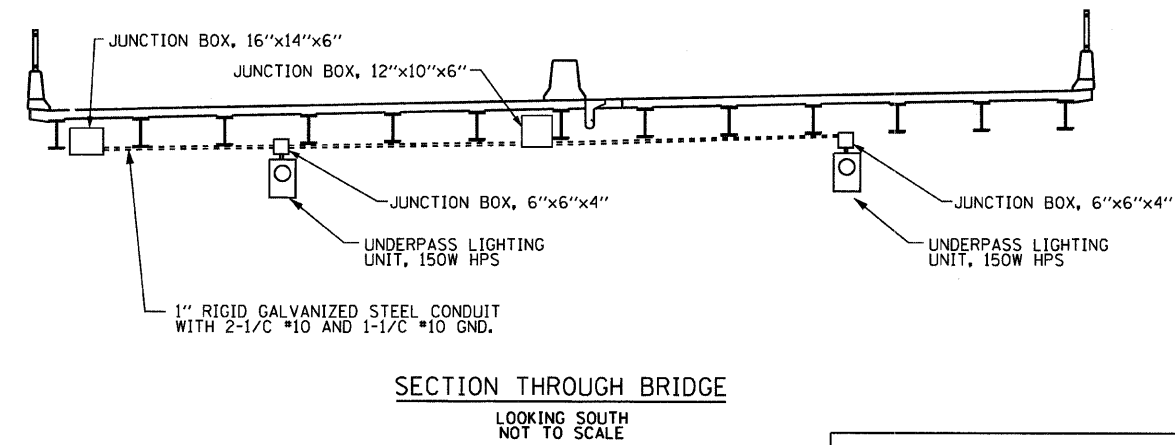

SECTION THROUGH BRIDGE
LOOKING SOUTH
NOT TO SCALE



ILLINOIS DEPARTMENT OF TRANSPORTATION
ILLINOIS ROUTE 92
PROPOSED ELECTRICAL PLAN
7TH AVE.

REVISIONS	
NAME	DATE

SCALE: 1"=20'
DATE: 11/26/07
DRAWN BY: JDM
CHECKED BY: JH

PLOT DATE: # DATES
FILE NAME: # FILES
PLOT SCALE: # SCALES
USER NAME: # USERS

F.A. RTE.	SECTION	COUNTY	TOTAL SHEETS	SHEET NO.
308		ROCK ISLAND	210	210
STA. _____		TO STA. _____		
FED. ROAD DIST. NO. _____		ILLINOIS FED. AID PROJECT		

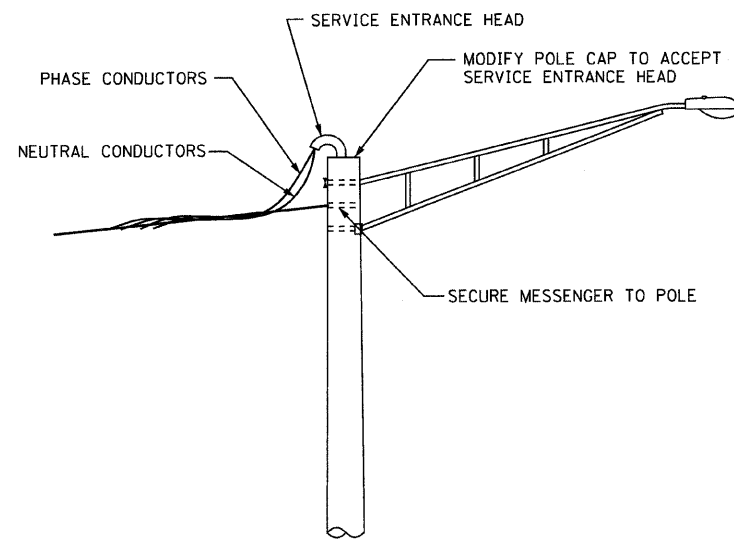

**TEMPORARY POWER FEED
TO EXISTING ALUMINUM POLE**
NOT TO SCALE

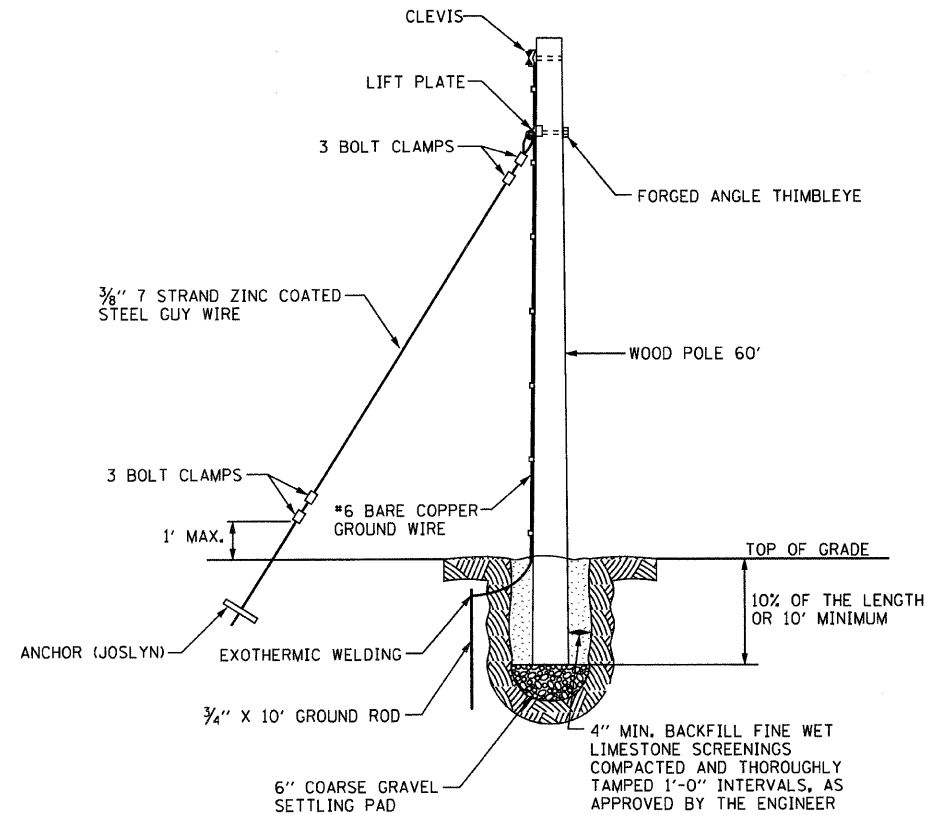

TEMPORARY WOOD POLE DETAIL
NOT TO SCALE

PLOT DATE = #DATE#
FILE NAME = #FILE#
PLOT SCALE = #SCALE#
USER NAME = #USER#

EJM EJM ENGINEERING, INC.
411 South Wells Street Suite 800
Chicago, Illinois 60607

REVISIONS	
NAME	DATE

ILLINOIS DEPARTMENT OF TRANSPORTATION
ILLINOIS ROUTE 92

TEMPORARY FEED DETAILS

SCALE: 1"=20'
DATE: 11/26/07

DRAWN BY: JDM
CHECKED BY: JH