

HORIZONTAL VERTICAL CONTROL

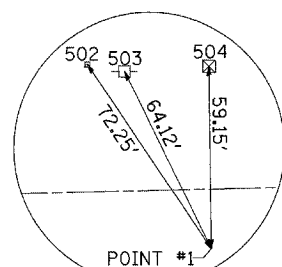

HORIZONTAL CONTROL POINT #1

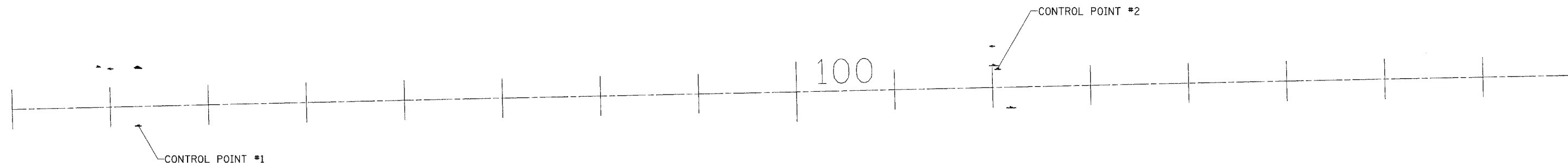
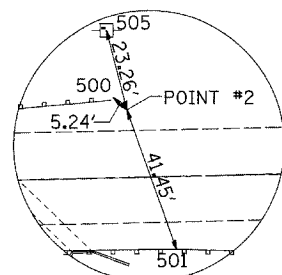

HORIZONTAL CONTROL POINT #2

Chain IL64 contains:
G0261260 CUR 200 CUR 210 220

Beginning chain IL64 description

Point G0261260 N 1,962,533.3202 E 2,427,842.9914 Sta 5+52.6233

Course from G0261260 to PC 200 88° 03' 57.3801" Dist 6,249.8235'

Curve Data

Curve 200
P.I. Station 76+30.6429 N 1,962,772.1986 E 2,434,916.9788

Delta = 0° 39' 47.3182" (RT)

Degree = 0° 02' 24.1292"

Tangent = 828.1960'

Length = 1,656.3736'

Radius = 143,111.0348'

External = 2.3964'

Long Chord = 1,656.3643'

Mid. Ord. = 2.3964'

P.C. Station 68+02.4468 N 1,962,744.2475 E 2,434,089.2546

P.T. Station 84+58.8204 N 1,962,790.5678 E 2,435,744.9711

C.C. N 1,819,714.7389 E 2,438,919.1552

Course from PT 200 to PC 210 88° 43' 44.6983" Dist 10,179.0097'

Curve Data

Curve 210
P.I. Station 188+90.9552 N 1,963,021.9512 E 2,446,174.5396

Delta = 0° 37' 18.3331" (RT)

Degree = 0° 07' 22.1439"

Tangent = 253.1252'

Length = 506.2454'

Radius = 46,651.0557'

External = 0.6867'

Long Chord = 506.2429'

Mid. Ord. = 0.6867'

P.C. Station 186+37.8300 N 1,963,016.3370 E 2,445,921.4767

P.T. Station 191+44.0754 N 1,963,024.8191 E 2,446,427.6485

C.C. N 1,916,376.7576 E 2,446,956.1910

Course from PT 210 to 220 89° 21' 03.0314" Dist 7,387.9239'

Point 220 N 1,963,108.5220 E 2,453,815.0982 Sta 265+31.9993

Ending chain IL64 description

HORIZONTAL CONTROL POINTS							
POINT	NORTH	EAST	ELEVATION	CHAIN	STATION	OFFSET	DESCRIPTION
1	1962790.5890	2436614.4020	860.1600	IL64	93+28.0379	19.2627' RT	PIN
2	1962848.1290	2437490.8820	841.1810	IL64	102+05.5785	18.8229' LT	PIN
65722926	1947200.3330	2445080.8679	918.8367	IL64	174+46.6311	15793.4686' RT	NGS MONUMENT
65722925	1948558.9644	2442895.4309	904.3167	IL64	152+91.8660	14386.6987' RT	NGS MONUMENT

BENCH MARKS							
POINT	NORTH	EAST	ELEVATION	CHAIN	STATION	OFFSET	DESCRIPTION
401	1962849.0935	2436614.6498	863.4652	IL64	93+29.5832	39.2219' LT	R.O.W. MARKER

REFERENCE TIES					
POINT	CHAIN	STATION	OFFSET	DESCRIPTION	
500	IL64	102+01.8072	22.4585' LT	GUARDRAIL STEEL PLATE BEAM, END	
501	IL64	102+18.6413	20.5115' RT	GUARDRAIL STEEL PLATE BEAM, END	
502	IL64	92+88.8313	41.4268' LT	FENCE CORNER, SHINER	
503	IL64	93+00.9372	38.8517' LT	POWER POLE, SHINER	
504	IL64	93+28.5300	39.8889' LT	R.O.W. MARKER, FACE	
505	IL64	102+00.3417	41.4806' LT	POWER POLE, SHINER	

CURVE POINT NUMBERS					
CHAIN	CURVE	PI	CC	PC	PT
IL64	200	200	201	202	203
IL64	210	210	211	212	213