

F.A. RTE.	SECTION	COUNTY	TOTAL SHEETS	SHEET NO.
•	••	HENRY	80	29
STA.	TO STA.			
FED. ROAD DIST. NO.	ILLINOIS	FED. AID PROJECT		
• FAP 22 (IL 78) & FAS 1247 (US 6)				
•• (125BR-1)D & (6BR)D				

# STAGE 2

**LEGEND**

- = WORK AREA
- = SIGN
- = TYPE III BARRICADE
- = DOUBLE VERTICAL PANEL
- = TYPE C BIDIRECTIONAL REFLECTOR
- = TRAFFIC SIGNAL
- = INDUCTION LOOP DETECTOR
- = IMPACT ATTENUATORS, TEMPORARY (NON-REDIRECTIVE), TEST LEVEL 3

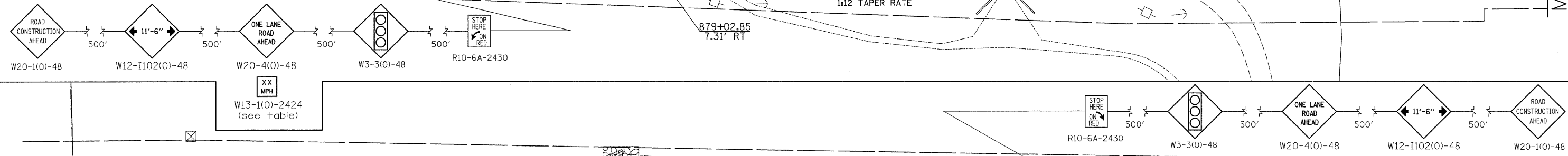
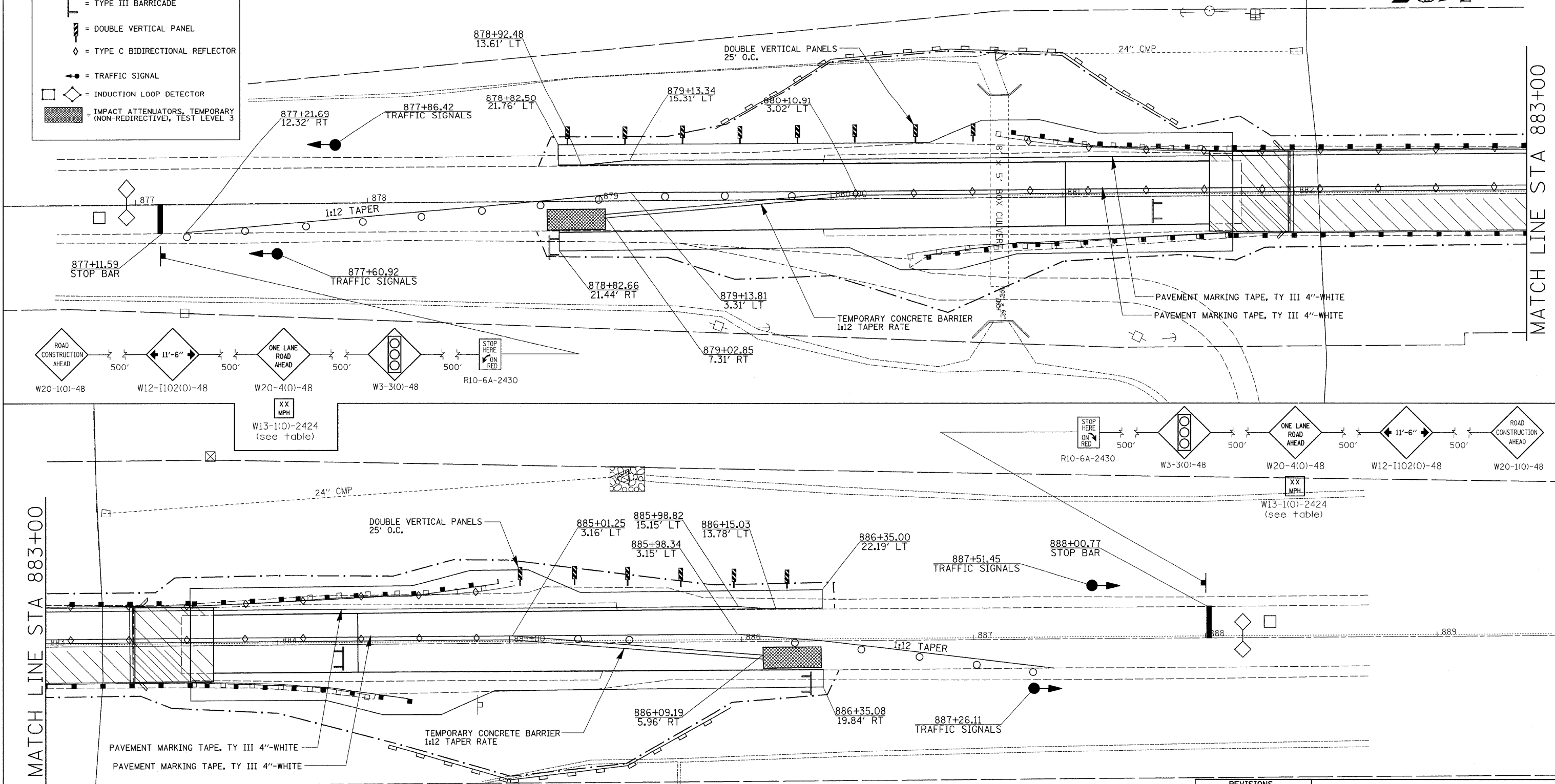

PLOT DATE = 14-JUN-2014 10:11:29  
 FILE NAME = \\syracuse\c200007\605807\fig.dgn  
 PLOT SCALE = 20.000000 / IN.  
 USER NAME = gman10m

SET UP ACCORDING TO TRAFFIC CONTROL AND PROTECTION STANDARD 701321

REVISIONS	
NAME	DATE

ILLINOIS DEPARTMENT OF TRANSPORTATION

SCALE: VERT. \_\_\_\_\_  
 HORIZ. \_\_\_\_\_  
 DATE \_\_\_\_\_

DRAWN BY \_\_\_\_\_  
 CHECKED BY \_\_\_\_\_

## STAGING DETAILS FOR IL 78 OVER GREEN RIVER