

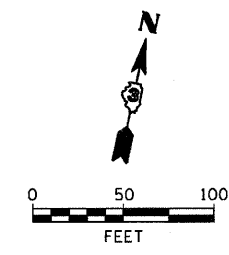

F.A.P. RTE.	SECTION	COUNTY	TOTAL SHEETS	SHEET NO.
786	(109) BR	LASALLE	351	27
STA. 61+50		TO STA. 100+00		
FED. ROAD DIST. NO.	ILLINOIS	FED. AID PROJECT		

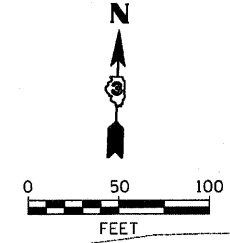

- LEGEND**
- CONCRETE REMOVAL
  - BITUMINOUS REMOVAL
  - LINEAR ITEMS TO BE REMOVED
  - TREE REMOVAL AREA

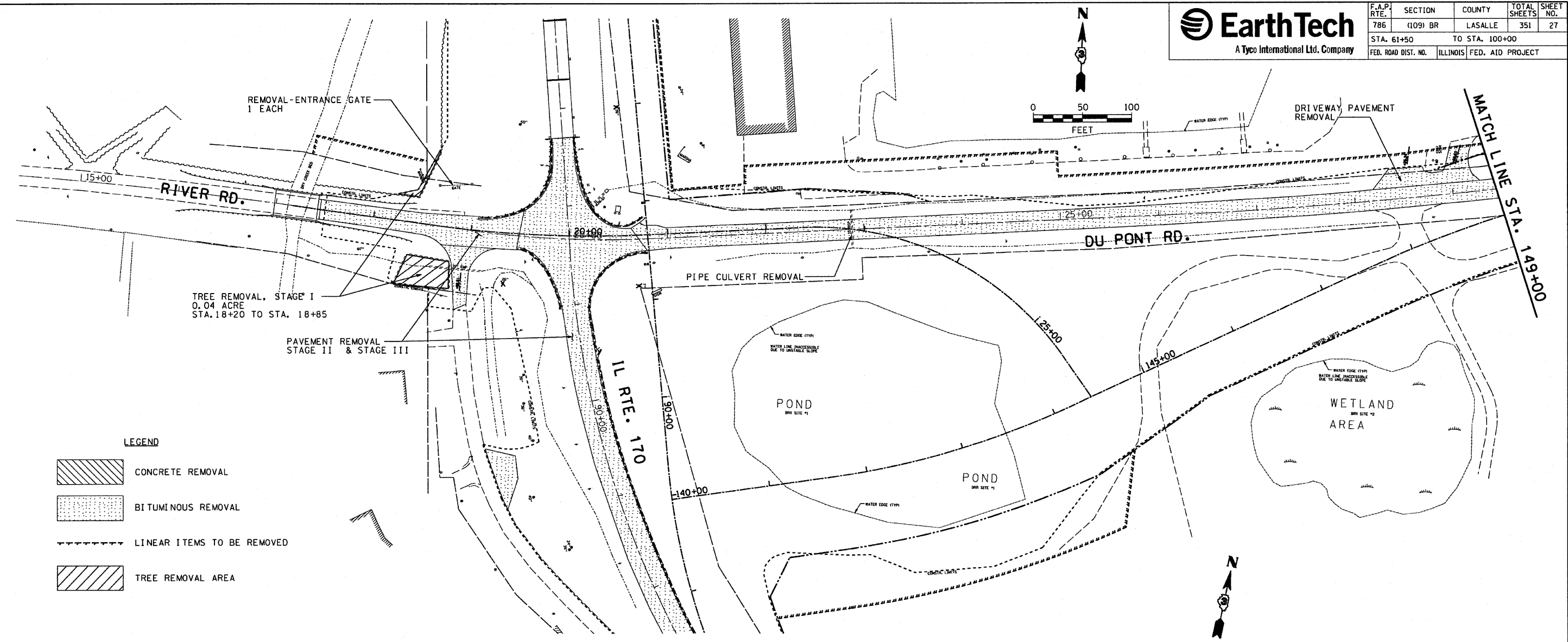
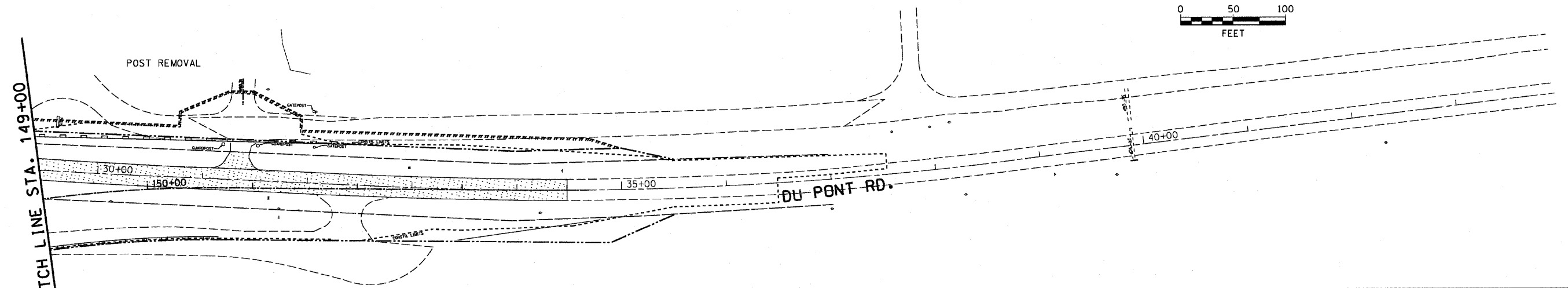

REVISIONS	
NAME	DATE

ILLINOIS DEPARTMENT OF TRANSPORTATION

**DEMOLITION AND REMOVAL PLAN**  
**IL 170 BRIDGE REPLACEMENT AT SENECA**

SCALE: 1" = 50'  
 DATE: OCTOBER, 2007

DRAWN BY: CJO  
 CHECKED BY: JCL

PLOT DATE = 10/11/2007  
 FILE NAME = 817115  
 PLOT SCALE = 850/1000  
 USER NAME = project