

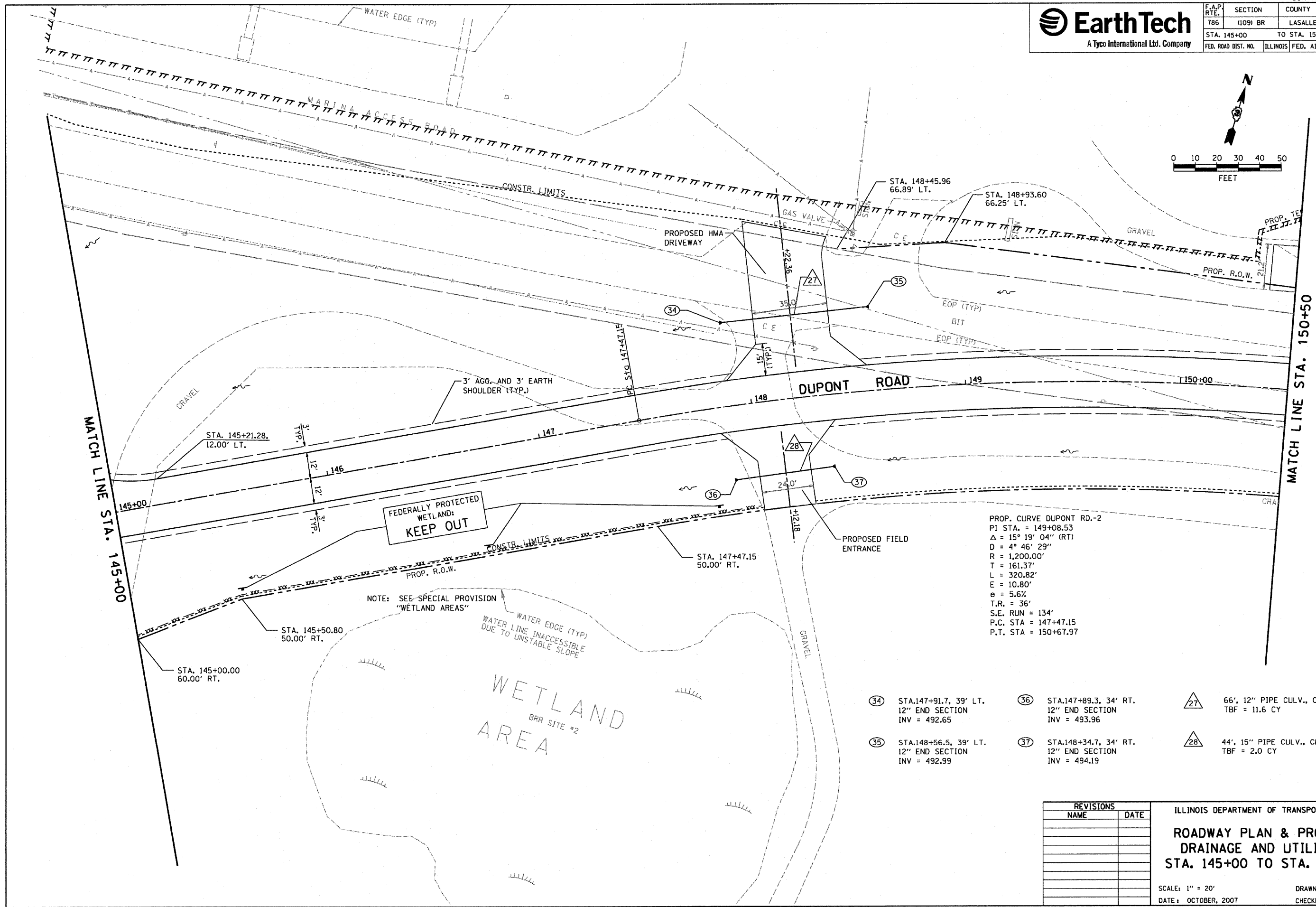

F.A.P. RTE.	SECTION	COUNTY	TOTAL SHEETS	SHEET NO.
786	(109) BR	LASALLE	351	43
STA. 145+00		TO STA. 150+50		
FED. ROAD DIST. NO.		ILLINOIS	FED. AID PROJECT	

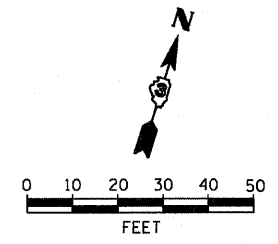

PROP. CURVE DUPONT RD.-2
 PI STA. = 149+08.53
 $\Delta = 15^\circ 19' 04''$ (RT)
 $D = 4^\circ 46' 29''$
 $R = 1,200.00'$
 $T = 161.37'$
 $L = 320.82'$
 $E = 10.80'$
 $e = 5.6\%$
 $T.R. = 36'$
 $S.E. RUN = 134'$
 $P.C. STA = 147+47.15$
 $P.T. STA = 150+67.97$

- (34) STA.147+91.7, 39' LT. 12" END SECTION INV = 492.65
- (35) STA.148+56.5, 39' LT. 12" END SECTION INV = 492.99
- (36) STA.147+89.3, 34' RT. 12" END SECTION INV = 493.96
- (37) STA.148+34.7, 34' RT. 12" END SECTION INV = 494.19
- (27) 66', 12" PIPE CULV., CL. D. @ 0.5%, TBF = 11.6 CY
- (28) 44', 15" PIPE CULV., CL. D. @ 0.5%, TBF = 2.0 CY

FEDERALLY PROTECTED WETLAND: KEEP OUT

NOTE: SEE SPECIAL PROVISION "WETLAND AREAS"

WETLAND AREA
 BRR SITE #2

REVISIONS	
NAME	DATE

ILLINOIS DEPARTMENT OF TRANSPORTATION
**ROADWAY PLAN & PROFILE,
 DRAINAGE AND UTILITIES
 STA. 145+00 TO STA. 150+50**

SCALE: 1" = 20'
 DATE: OCTOBER, 2007
 DRAWN BY: CJO
 CHECKED BY: JCL

PLOT DATE = 10/17/2007
 PLOT SCALE = ESCALES
 USER NAME = project