



F.A.P. RTE.	SECTION	COUNTY	TOTAL SHEETS	SHEET NO.
786	(109) BR	LASALLE	351	44
STA. 145+00		TO STA. 150+50		
FED. ROAD DIST. NO.		ILLINOIS FED. AID PROJECT		

SCALE: HORIZ. 1" = 20'  
VERT. 1" = 2'

DU PONT ROAD

PLAN	SURVEYED	DATE
	PLotted	
	NOTED	
	BY	
	NO. OF MAY CHECKED	
	FILE NAME	
	NO.	

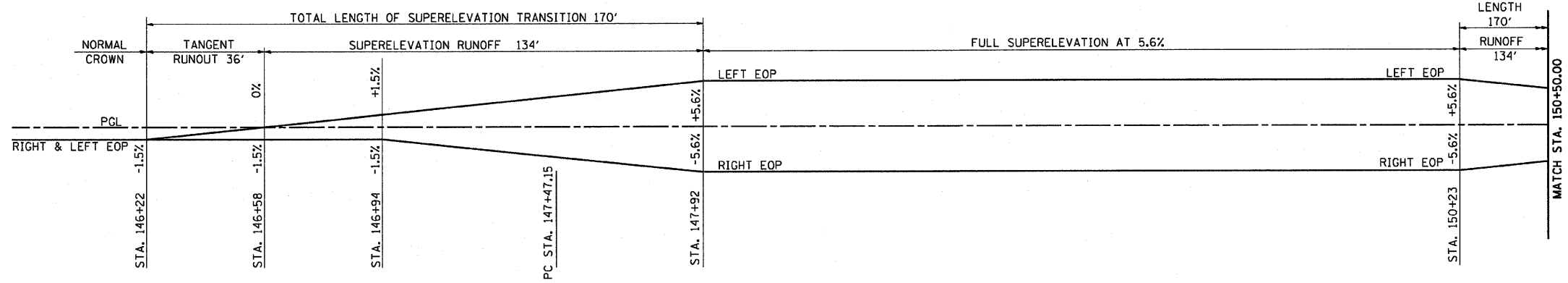

SUPERELEVATION TRANSITION DIAGRAM

PROFILE	SURVEYED	DATE
	Plotted	
	NOTED	
	BY	
	NO. OF MAY CHECKED	
	FILE NAME	
	NO.	

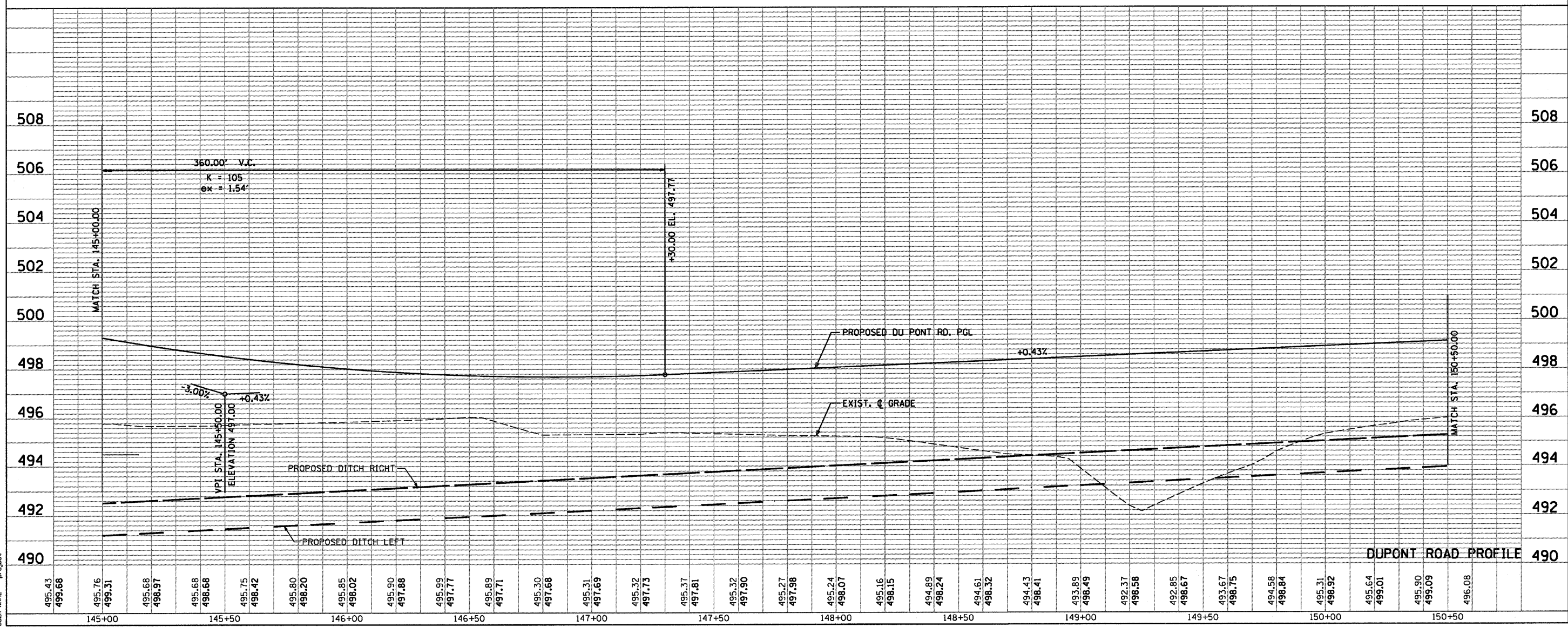

DUPONT ROAD PROFILE

PLOT DATE = 10/11/2007  
FILE NAME = #FILE#  
PLOT SCALE = #SCALE#  
USER NAME = #PROJECT#