

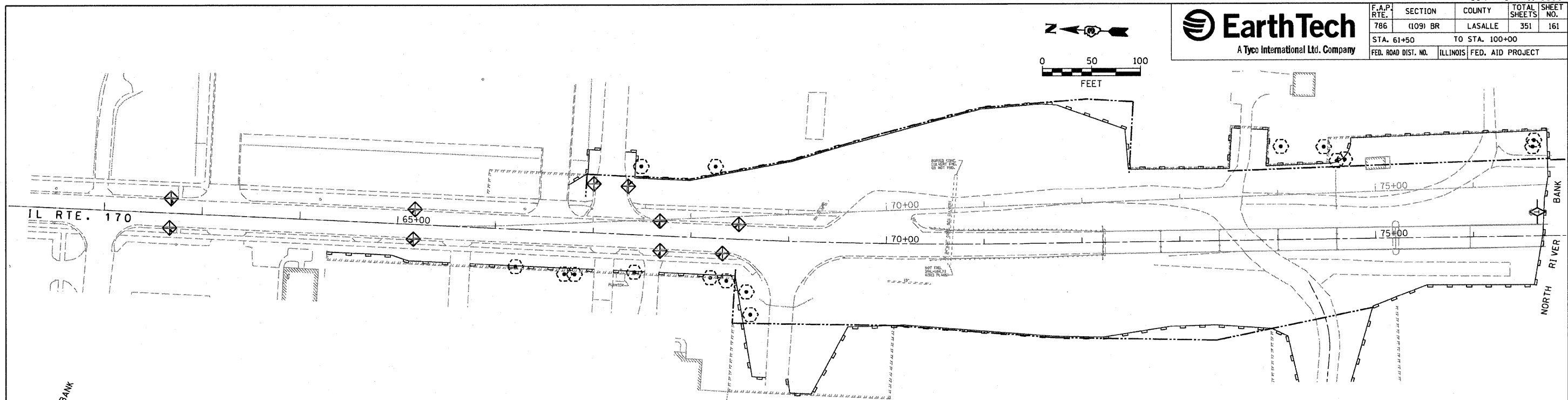

F.A.P. RTE.	SECTION	COUNTY	TOTAL SHEETS	SHEET NO.
786	(109) BR	LASALLE	351	161
STA. 61+50		TO STA. 100+00		
FED. ROAD DIST. NO.	ILLINOIS	FED. AID PROJECT		

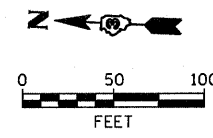

**EROSION CONTROL AND SEDIMENT CONTROL NOTES:**

1. THE CONTRACTOR SHALL BE REQUIRED TO INSTALL TEMPORARY EROSION CONTROL MEASURES IN ACCORDANCE WITH THIS PLAN AND AS DIRECTED BY THE ENGINEER TO PROVIDE A STORMWATER POLLUTION PREVENTION PLAN FOR COMPLIANCE WITH THE NATIONAL POLLUTANT DISCHARGE ELIMINATION SYSTEM (NPDES) PROGRAM OF THE FEDERAL CLEAN WATER ACT.
2. THE PURPOSE OF THIS PLAN IS TO MINIMIZE EROSION AND SEDIMENT DAMAGE TO THE ILLINOIS RIVER AND SENSITIVE ENVIRONMENTAL RESOURCES AND TO ELIMINATE SEDIMENTS FROM ENTERING AND LEAVING THE CONSTRUCTION ZONE BY UTILIZING PROPER TEMPORARY EROSION CONTROL SYSTEMS AND PROVIDING GROUND COVER AFTER EACH MAJOR CONSTRUCTION PHASE.
3. CERTAIN ITEMS, AS SHOWN IN THIS PLAN AND REFERENCED BY THE LEGEND, SHALL BE PLACED BY THE CONTRACTOR AT THE BEGINNING OF CONSTRUCTION. OTHER ITEMS SHALL BE PLACED BY THE CONTRACTOR AS DIRECTED BY THE ENGINEER ON A CASE BY CASE BASIS RESULTING FROM THE CONTRACTOR'S SEQUENCE OF ACTIVITIES, TIME OF YEAR, AND FORECASTED WEATHER CONDITIONS.
4. THE CONTRACTOR SHALL CONSTRUCT PERMANENT EROSION CONTROL SYSTEMS AND SEEDING AS SOON AS POSSIBLE OR AS DIRECTED BY THE ENGINEER, TO REDUCE THE AMOUNT OF AREA SUSCEPTIBLE TO EROSION AND REDUCE THE AMOUNT OF TEMPORARY EROSION CONTROL SYSTEMS AND TEMPORARY SEEDING NECESSARY. THE ENGINEER WILL DETERMINE IF ANY TEMPORARY EROSION CONTROL ITEMS SHOWN IN THE PLANS CAN BE DELETED, THE PROPER METHOD OF INSTALLATION, AND IF ANY ADDITIONAL TEMPORARY EROSION CONTROL MEASURES SHALL BE REQUIRED WHICH ARE NOT INCLUDED IN THIS PLAN. THE CONTRACTOR SHALL PERFORM ALL WORK AS DIRECTED BY THE ENGINEER IN ACCORDANCE WITH IDOT STANDARD 280001.

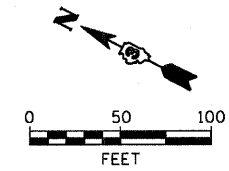
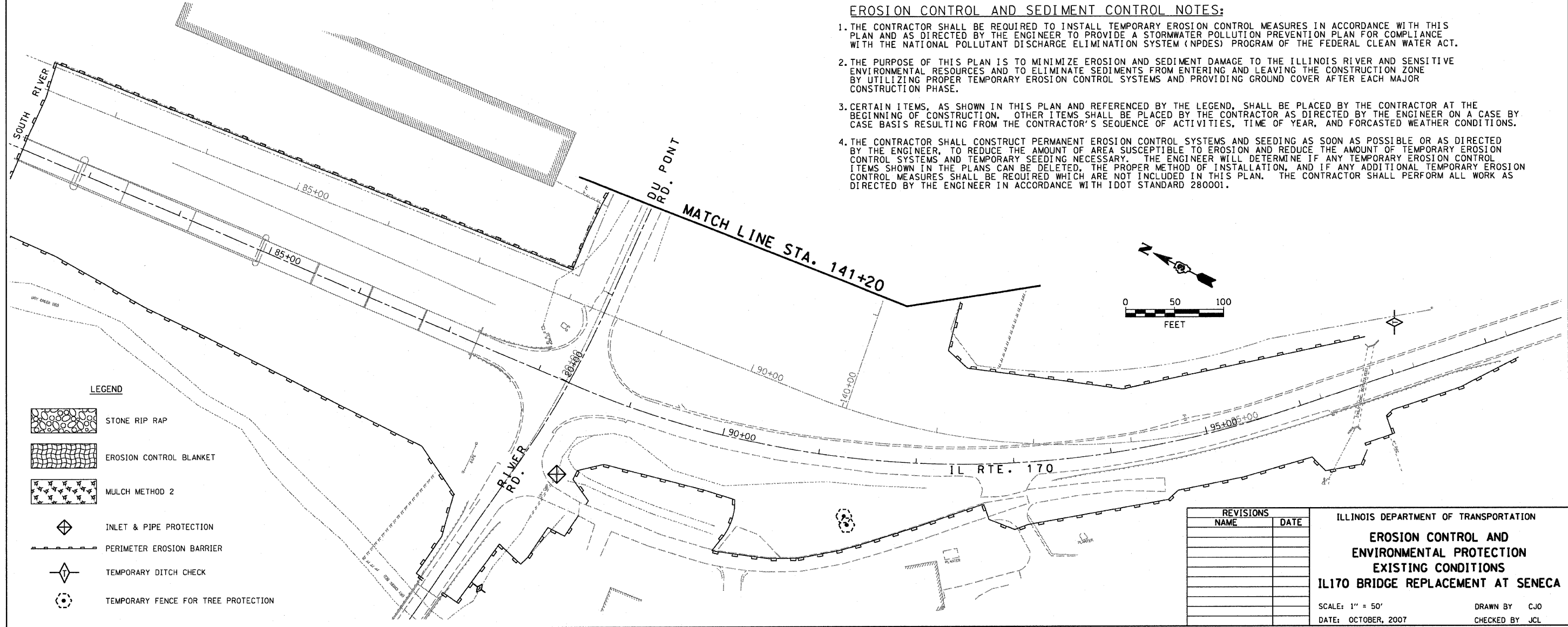

**LEGEND**

- STONE RIP RAP
- EROSION CONTROL BLANKET
- MULCH METHOD 2
- INLET & PIPE PROTECTION
- PERIMETER EROSION BARRIER
- TEMPORARY DITCH CHECK
- TEMPORARY FENCE FOR TREE PROTECTION

PLOT DATE = 10/17/2007  
 PLOT DATE = 10/17/2007  
 PLOT SCALE = 1" = 50'  
 USER NAME = Project

REVISIONS	
NAME	DATE

ILLINOIS DEPARTMENT OF TRANSPORTATION  
**EROSION CONTROL AND ENVIRONMENTAL PROTECTION**  
**EXISTING CONDITIONS**  
**IL170 BRIDGE REPLACEMENT AT SENECA**  
 SCALE: 1" = 50'  
 DATE: OCTOBER, 2007  
 DRAWN BY: CJO  
 CHECKED BY: JCL