

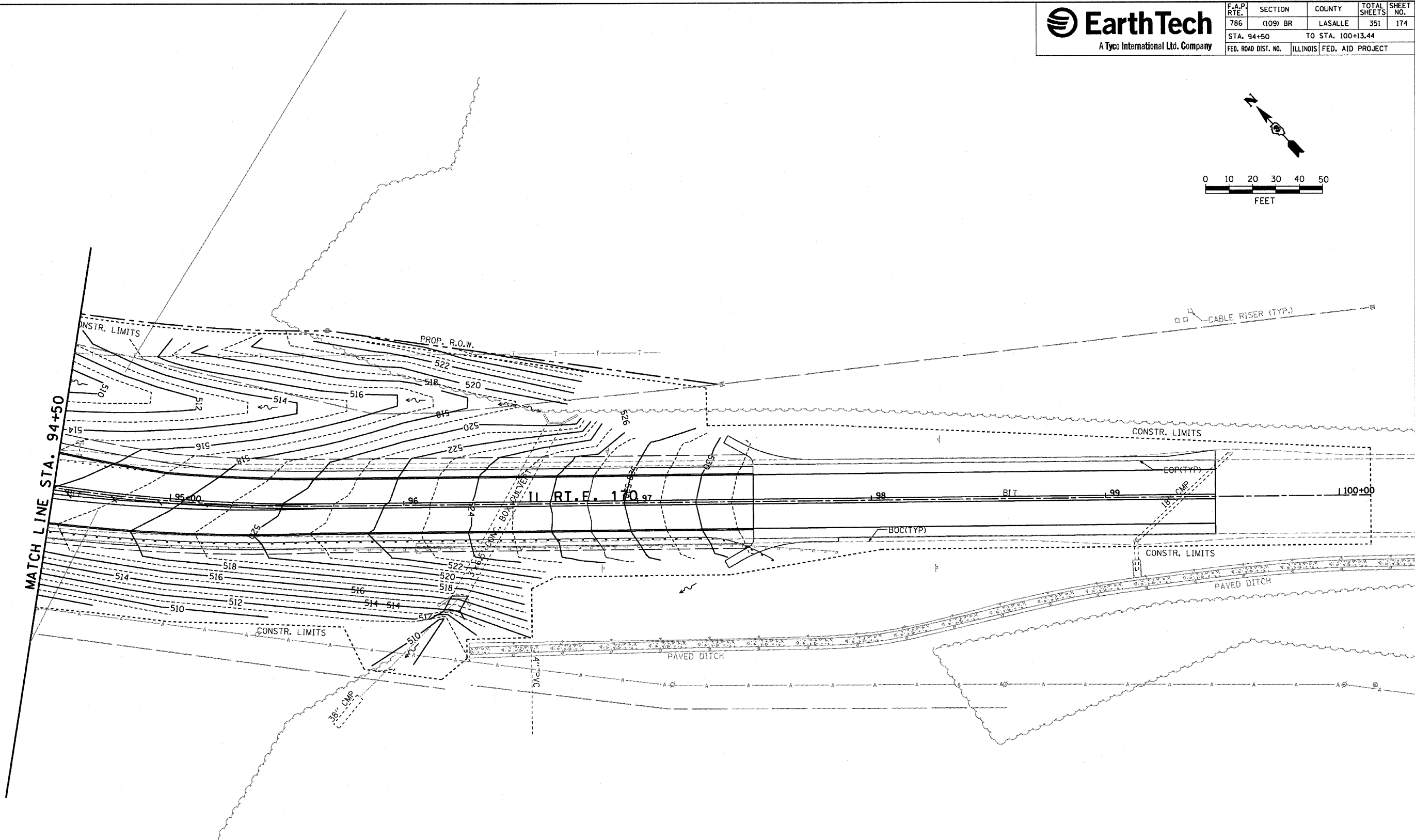

F.A.P. RTE.	SECTION	COUNTY	TOTAL SHEETS	SHEET NO.
786	(109) BR	LASALLE	351	174
STA. 94+50		TO STA. 100+13.44		
FED. ROAD DIST. NO.		ILLINOIS FED. AID PROJECT		

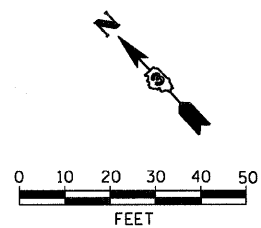

NOTE: FOR PROFILE SEE SHEET

REVISIONS	
NAME	DATE

ILLINOIS DEPARTMENT OF TRANSPORTATION

GRADING PLAN
STA. 94+50 TO STA. 100+13.44

SCALE: 1" = 20'
 DATE: OCTOBER, 2007

DRAWN BY: CJO
 CHECKED BY: JCL

PLOT DATE = 10/17/2007
 PLOT SCALE = 850/1000
 USER NAME = project