

STATE OF ILLINOIS  
DEPARTMENT OF TRANSPORTATION



F.A.P. ROUTE NO.	SECTION	COUNTY	STA. 0+00 TO STA. 100+00	SHEET
786	109 BR	La Salle	351	218
FED. ROAD DIST. NO. 7	ILLINOIS	FED. AID PROJECT-		

SHEET NO. 18  
89 SHEETS

Contract # 66607

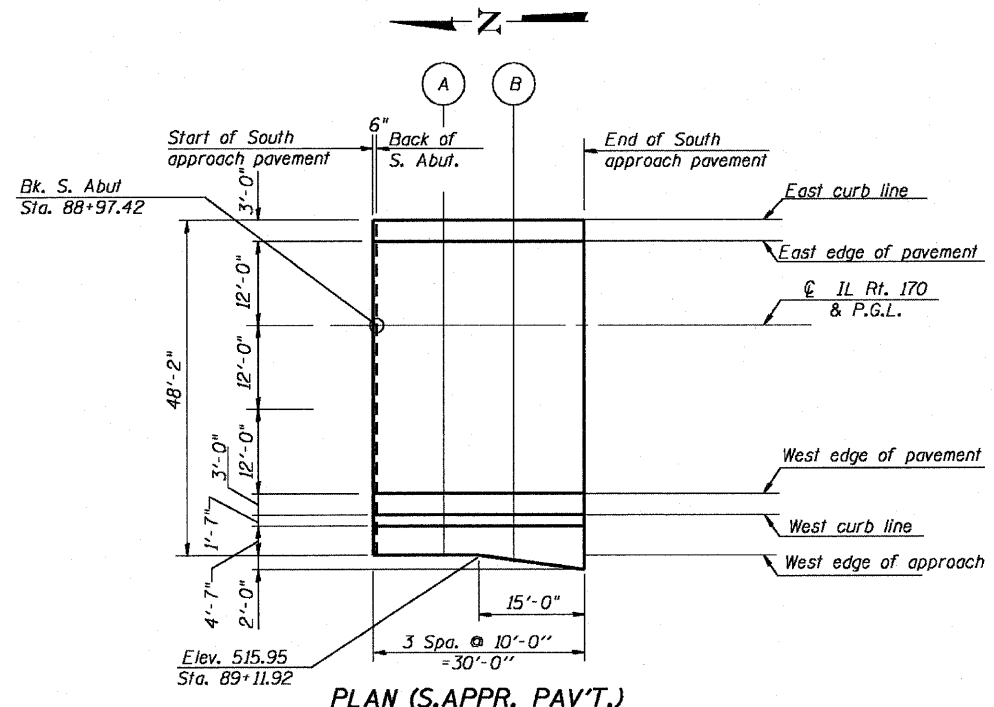

PLAN (S.APPR. PAV'T.)

**EAST CURB LINE**

Location	Station	Offset	Theoretical Grade Elevations
Start S.Appr. Slab	88+96.92	-15.00	516.63
A	89+06.92	-15.00	516.43
B	89+16.92	-15.00	516.23
End S. Appr. Slab	89+26.92	-15.00	516.03

**EAST EDGE OF PAVEMENT**

Location	Station	Offset	Theoretical Grade Elevations
Start S.Appr. Slab	88+96.92	-12.00	516.69
A	89+06.92	-12.00	516.49
B	89+16.92	-12.00	516.29
End S. Appr. Slab	89+26.92	-12.00	516.09

DESIGNED - DEV
CHECKED - RJC
DRAWN - JHR
CHECKED - RJC

**P.G.L. & CL STAGE CONSTRUCTION JOINT**

Location	Station	Offset	Theoretical Grade Elevations
Start S.Appr. Slab	88+96.92	0.00	516.88
A	89+06.92	0.00	516.68
B	89+16.92	0.00	516.48
End S. Appr. Slab	89+26.92	0.00	516.28

**WEST EDGE OF PAVEMENT**

Location	Station	Offset	Theoretical Grade Elevations
Start S.Appr. Slab	88+96.92	24.00	516.14
A	89+06.92	24.00	516.24
B	89+16.92	24.00	516.04
End S. Appr. Slab	89+26.92	24.00	515.84

**WEST CURB LINE**

Location	Station	Offset	Theoretical Grade Elevations
Start S.Appr. Slab	88+96.92	27.00	516.38
A	89+06.92	27.00	516.18
B	89+16.92	27.00	515.98
End S. Appr. Slab	89+26.92	27.00	515.78

**WEST SIDEWALK EDGE**

Location	Station	Offset	Theoretical Grade Elevations
Start S.Appr. Slab	88+96.92	33.17	516.25
A	89+06.92	33.17	516.05
B	89+16.92	33.83	515.83
End S. Appr. Slab	89+26.92	35.17	515.61

**TOP OF SLAB ELEVATIONS  
SOUTH APPROACH PAVEMENT  
IL. 170 F.A.P. 786 OVER  
ILLINOIS RIVER AT SENECA  
PUBLIC WATERS  
LA SALLE COUNTY, SECTION 109 BR  
STATION 79+04.42  
STRUCTURE NO. 050-0246**