

WIDTH RESTRICTION SIGNING

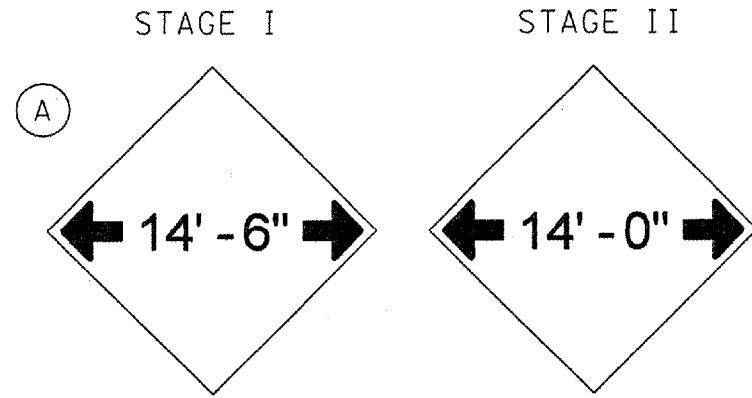

W12-I102-48"x48" - ORANGE (O)

- SIGN (A) 2 SIGNS - W12-2(O)-48"x48" - ORANGE (O)
1. TO BE PLACED 200' SOUTH OF OF US-51 NB TO I-74 EB RAMP
 2. TO BE PLACED JUST PRIOR TO I-74 BRIDGE ON US-51 BUS. SB TO I-74 EB RAMP

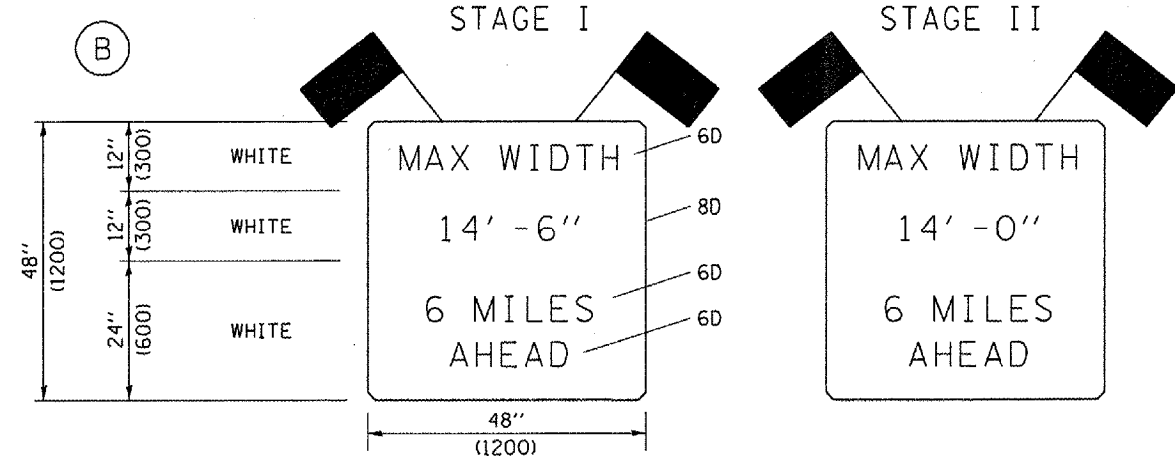

W12-I103-48"x48" - WHITE

- SIGN (B) 2 SIGNS - W12-I103 - 48" X 48" WHITE
- AS SHOWN ARE TO BE PLACED
- FLAGS REQUIRED
- PLACED APPROXIMATELY
- 1/4 MILES WEST OF US-51 (DUAL DISPLAY) ON I-74EB

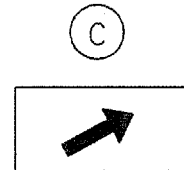

M6-2R 21" X 15" ORANGE (O)
PLACED UNDER (A) SIGNS

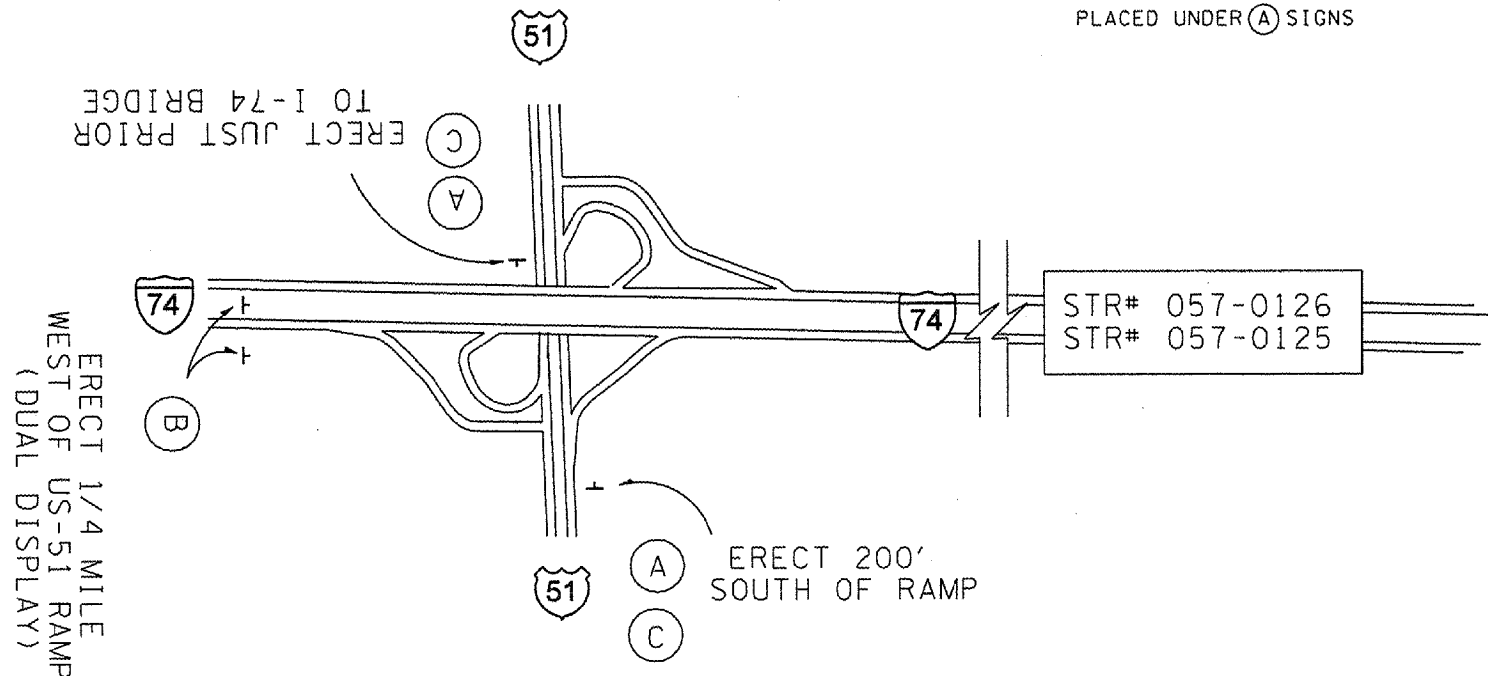

NOTE: STAGE I 14' -6"
STAGE II 14' -0"

GENERAL NOTES

NOTE: STAGE I WIDTH 14' -6" STAGE II WIDTH 14' -0"

1. ALL TRAFFIC CONTROL DEVICES SHALL BE FURNISHED, ERECTED AND MAINTAINED BY THE CONTRACTOR.
2. ALL (B) SIGNS SHALL HAVE FLAGS INSTALLED UNLESS OTHERWISE DIRECTED.
3. LOCATIONS OF TRAFFIC CONTROL DEVICES MAY BE ADJUSTED BY THE ENGINEER.
4. ALL TRAFFIC CONTROL SHOWN ON THIS SHEET SHALL BE PAID FOR AT THE CONTRACT LUMP SUM PRICE FOR WIDTH RESTRICTION SIGNING.
5. ALL SIGNS SHALL BE POST MOUNTED UNLESS OTHERWISE DIRECTED.
6. ALL SIGNS SHOWN ORANGE (O) SHALL BE FLUORESCENT ORANGE.

Note: All dimensions are in INCHES (millimeters) unless otherwise shown.

DESIGNER NOTE: PROVIDE MAP WITH SIGN LOCATIONS (A, B, ETC.) AND COORDINATE WITH TRAFFIC OPERATIONS ENGINEER.
INCLUDE DISTRICT SPECIAL PROVISION - "WIDTH RESTRICTION SIGNING"

DISTRICT 5 DETAIL NO. X7200201

FILE NAME : c:\projects\4d585207 (v8)\70672.stage.dgn	USER NAME : collorbw	DESIGNED - DRAWN -	REVISED - 11/06 REVISED - REVISED - REVISED -
PLOT SCALE = 100.0000 1/1 IN.	CHECKED -	DATE -	REVISED -
PLOT DATE = 12/21/2007			

**STATE OF ILLINOIS
DEPARTMENT OF TRANSPORTATION**

WIDTH RESTRICTION SIGNING

SCALE: SHEET NO. OF SHEETS STA. TO STA.

F.A. I RTE.	SECTION	COUNTY	TOTAL SHEETS
74	(57-22)BR-3	MCLEAN	21/21
FED. ROAD DIST. NO.			ILLINOIS FED. AID PROJECT
			CONTRACT NO. 70672

A-2-2007 12-2008