

F.A.P. RTE.	SECTION	COUNTY	TOTAL SHEETS	SHEET NO.
753	143RS-6	CHRISTIAN	127	96
STA. 151+50.00		TO STA. 152+00.00		
FED. ROAD DIST. NO.		ILLINOIS	FED. AID PROJECT	
SHEET 26 OF 26				

BY	DATE

NO.	AREAS CHECKED

NO.	AREAS CHECKED

BY	DATE

NO.	AREAS CHECKED

NO.	AREAS CHECKED

PLOT DATE = Dec-12-2007 10:35:56AM
FILE NAME = 1015582.dwg
PLOT SCALE = 10:1
USER NAME = laughlin-1

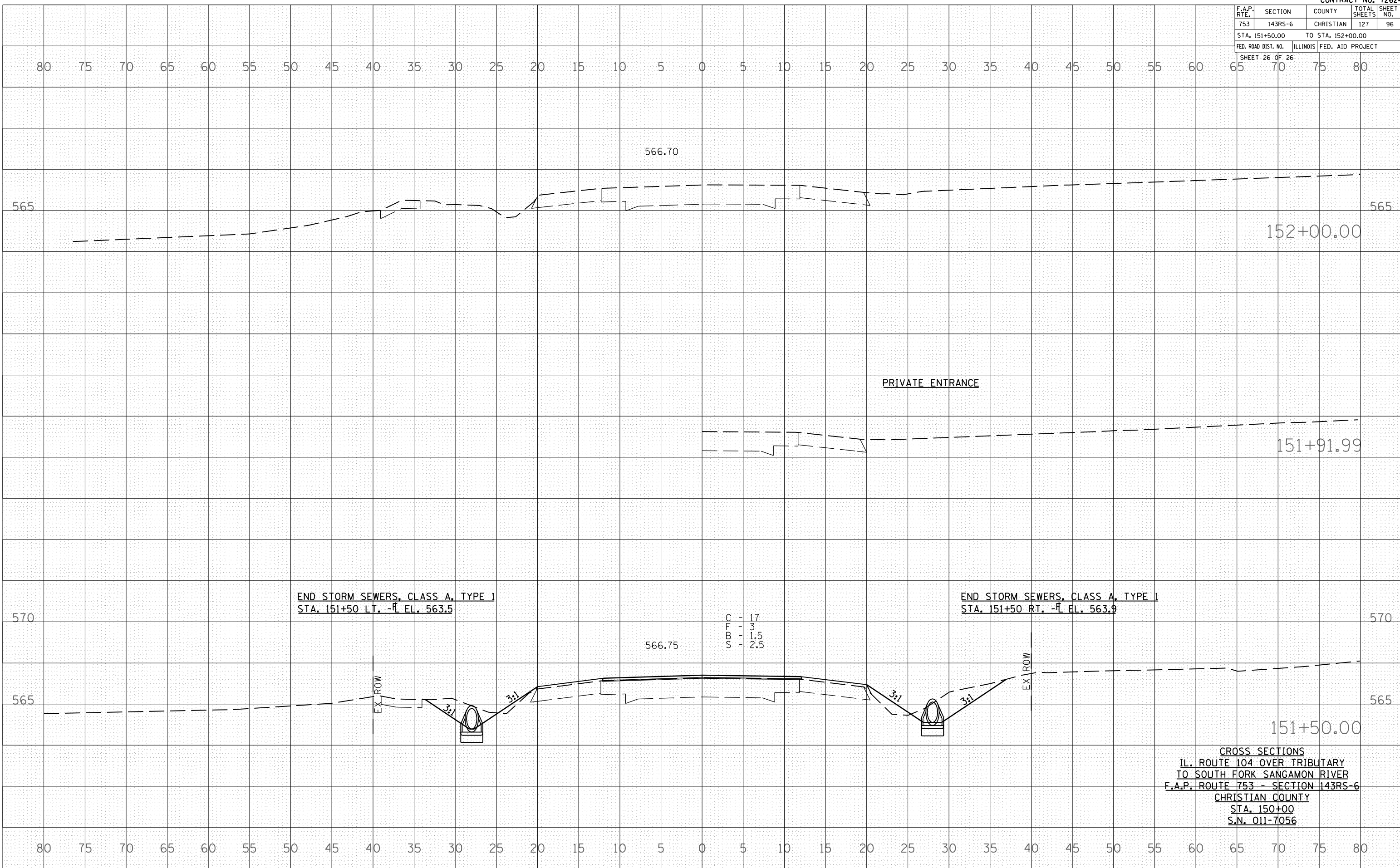

CROSS SECTIONS
IL. ROUTE 104 OVER TRIBUTARY
TO SOUTH FORK SANGAMON RIVER
F.A.P. ROUTE 753 - SECTION 143RS-6
CHRISTIAN COUNTY
STA. 150+00
S.N. 011-7056