

**PROJECT LOCATION**  
**S.N. 085-0016**  
**SECTION (120BR)I-2**

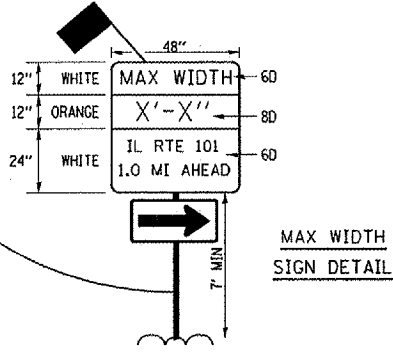
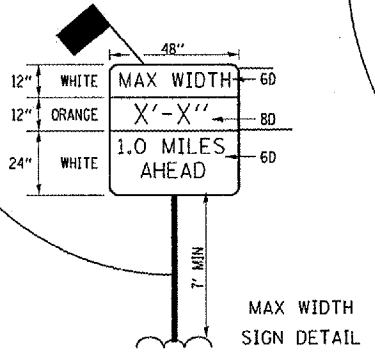
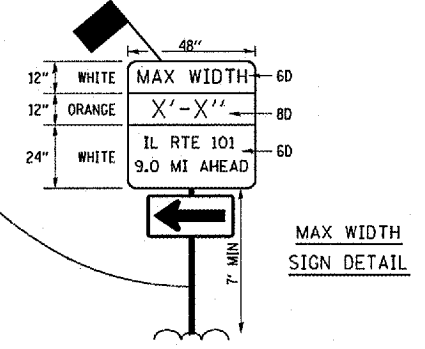
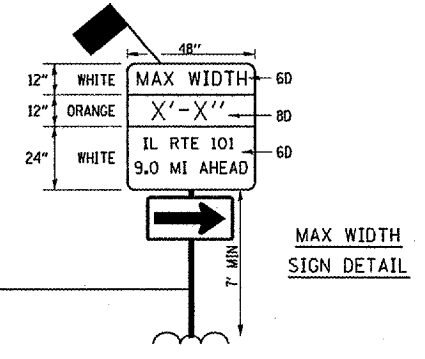
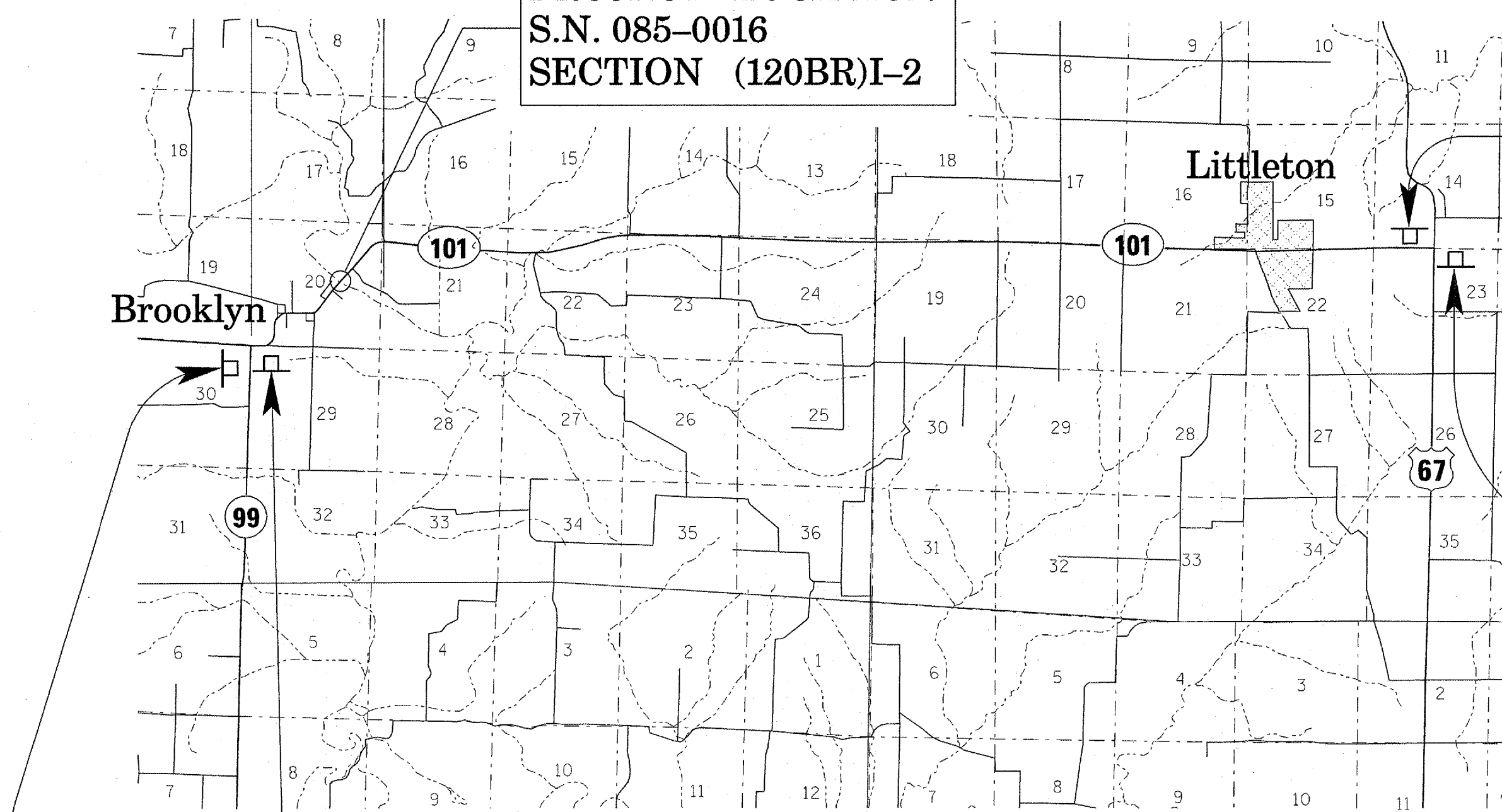

**MAXIMUM WIDTH SIGNING LOCATIONS**

FILE NAME = c:\Projects\682508\shdetails.dgn	USER NAME = laughtlin1	DESIGNED - RTS	REVISED - DEC. 11, 2007	<b>STATE OF ILLINOIS</b> <b>DEPARTMENT OF TRANSPORTATION</b>	<b>TRAFFIC CONTROL DETAILS</b>		FAP RTE.	SECTION	COUNTY	TOTAL SHEETS	SHEET NO.	
	PLOT SCALE = 40.0000' / IN.	DRAWN - RTS	REVISED -		SCALE:	SHEET NO. 4 OF 5 SHEETS	STA.	713	(120BR)I-2	SCHUYLER	12	7
	PLOT DATE = Dec-12-2007 03:34:08PM	CHECKED - MEB	REVISED -		TO STA.			CONTRACT NO. 72B65				
							FED. ROAD DIST. NO. ILLINOIS FED. AID PROJECT					