

- NOTES:
1. ALL DIMENSIONS, BARRICADES, SIGNS, ETC., AS SHOWN ON TRAFFIC CONTROL AND PROTECTION STANDARD 701321 SHALL APPLY.
  2. ALL TEMPORARY PAVEMENT MARKING NECESSARY TO COMPLY WITH THIS DETAIL SHALL BE CONSIDERED INCLUDED IN THE TRAFFIC CONTROL PAY ITEMS IN THE PLANS.
  3. CONTRACTOR SHALL FILL EXISTING GUARD RAIL POST AFTER REMOVING AND SHALL BE CONSIDERED INCIDENTAL TO STEEL PLATE BEAM GUARD RAIL REMOVAL.
  4. TEMPORARY PAVEMENT MARKING SHALL BE PLACED FROM STOP BAR TO STOP BAR DURING ALL STAGES OF CONSTRUCTION.
  5. SIGNS LOCATED AT FIELD ENTRANCE WITHIN THE STAGE CONSTRUCTION AREA SHALL REMAIN IN PLACE WHEN TEMPORARY TRAFFIC SIGNALS ARE IN USE.

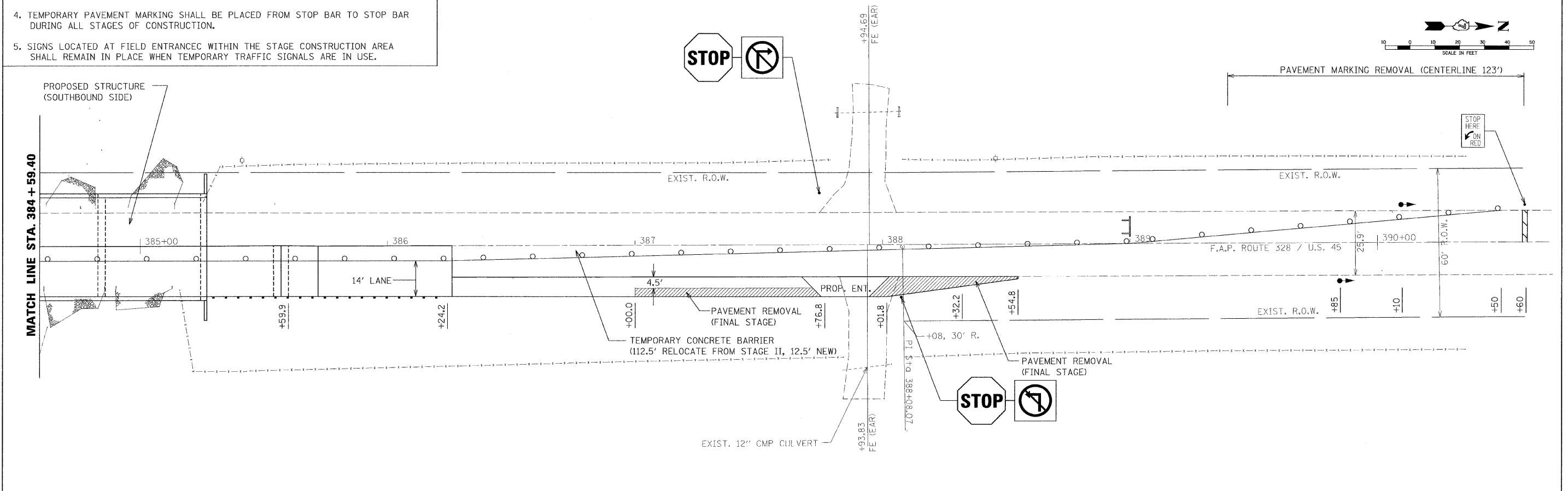

FILE NAME = #FILEL#	USER NAME = #USER#	DESIGNED - WJS	REVISED -	<b>STATE OF ILLINOIS DEPARTMENT OF TRANSPORTATION</b>	<b>STAGE IV CONSTRUCTION</b>			F.A.P. RTE. 328	SECTION (10BR-2)B-1	COUNTY WAYNE	TOTAL SHEETS 140	SHEET NO. 93A
	PLOT SCALE = #SCALE#	DRAWN - WJS	REVISED -		SCALE:	SHEET NO.	OF	SHEETS	STA.	TO STA.	CONTRACT NO. 74040	
	PLOT DATE = #DATE#	CHECKED - AJD	REVISED -		FED. ROAD DIST. NO. ILLINOIS FED. AID PROJECT							
		DATE - 10/24/07	REVISED -									