

12/14/2007 11:59:32 AM

ps:\02\files\020409\02-0409\028 wo 17\_bridges\plans\bridge\plans\014-0077\_03\_RiprapPlanDetails.dwg

ROUTE NO.	SECTION	COUNTY	TOTAL SHEETS	SHEET NO.
F.A.S. 1780	27-1BR-1	CLINTON	69	28
FED. ROAD DIST. NO. 6	ILLINOIS	FED. AID PROJECT		

SHEET NO. 3  
27 SHEETS

Contract # 76961

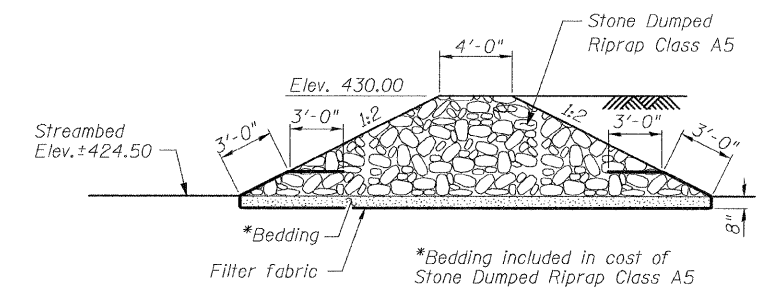
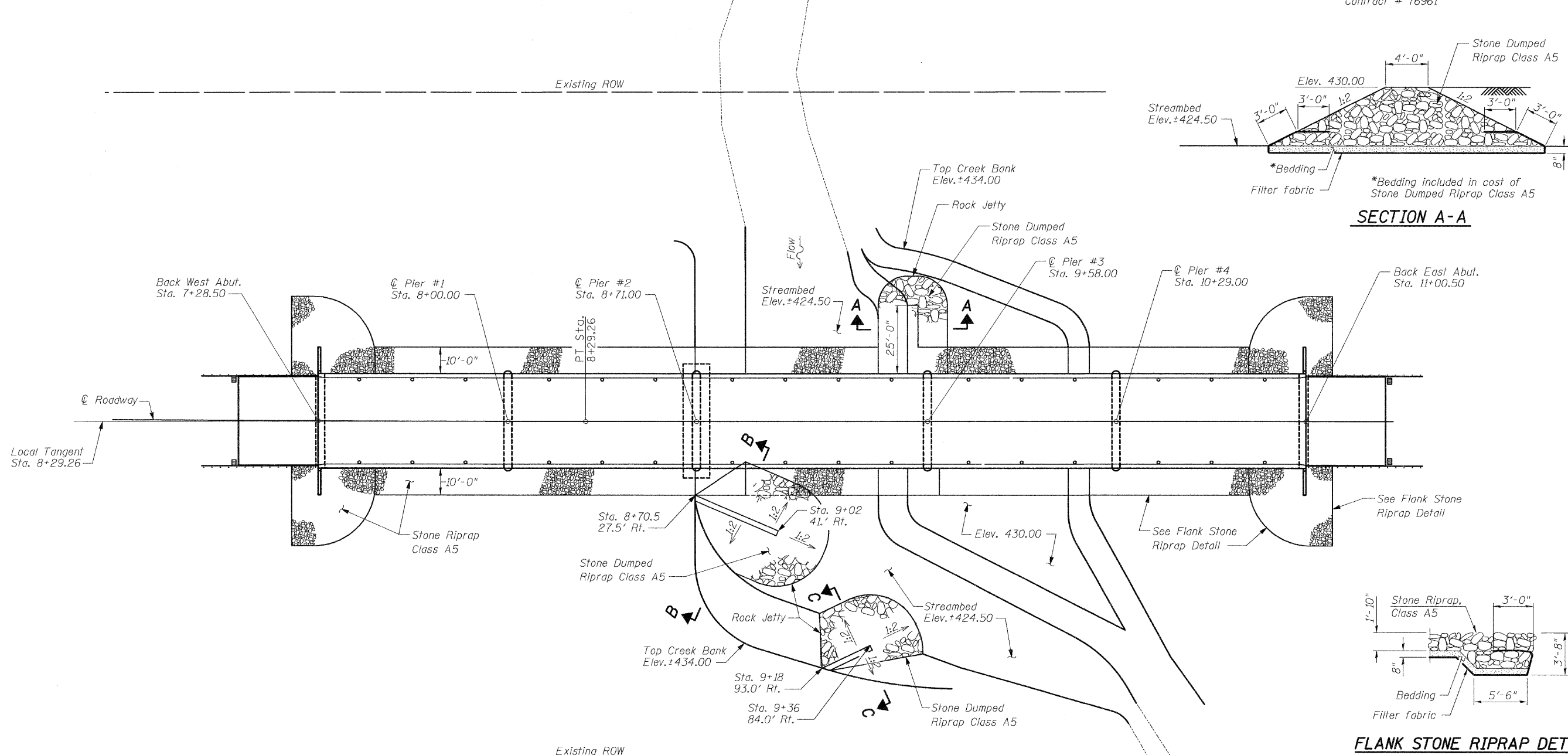

SECTION A-A

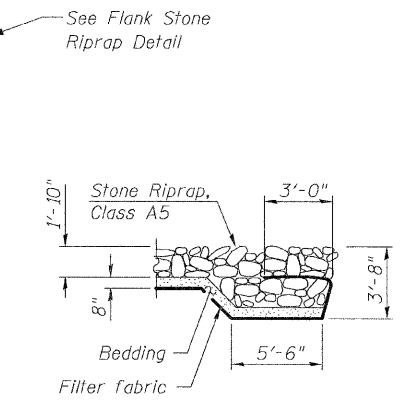

FLANK STONE RIPRAP DETAIL

Note: The flank detail shall be used along both the upstream and downstream ends of the riprap treatment, except rock jetties.

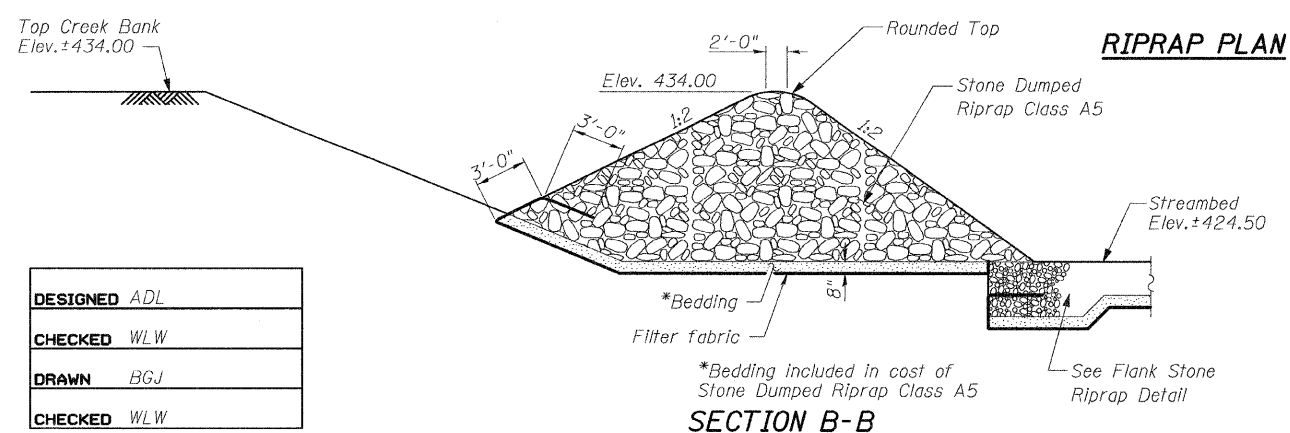

SECTION B-B

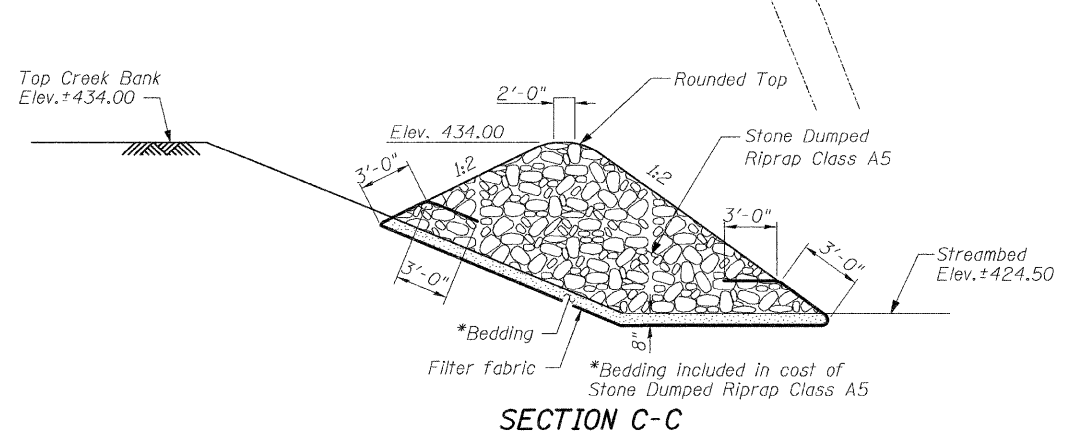

SECTION C-C

RIPRAP PLAN

DESIGNED	ADL
CHECKED	WLW
DRAWN	BGJ
CHECKED	WLW

**RIPRAP PLAN AND DETAILS**  
**FAS RTE 1780 (OLD US 50) OVER**  
**SUGAR CREEK**  
**SECTION 27-1BR-1**  
**CLINTON COUNTY**  
**STATION 9+14.50**  
**STRUCTURE NUMBER 014-0077**