

F.A.S. DIST.	SECTION	COUNTY	TOTAL SHEETS	SHEET NO.
1780	27-1BR-1	CLINTON	69	53
STA.	TO STA.			
FED. ROAD DIST. NO.	ILLINOIS	FED. AID PROJECT		

FED. ROAD DIST. NO.	STATE	FED. AID PROJ. NO.	FISCAL YEAR	SHEET NO.	TOTAL SHEETS
1780	ILL.	34	1952	24	26

SHEET No. 3
3 Sheets.

STATE OF ILLINOIS
DEPARTMENT OF PUBLIC WORKS & BUILDINGS
DIVISION OF HIGHWAYS

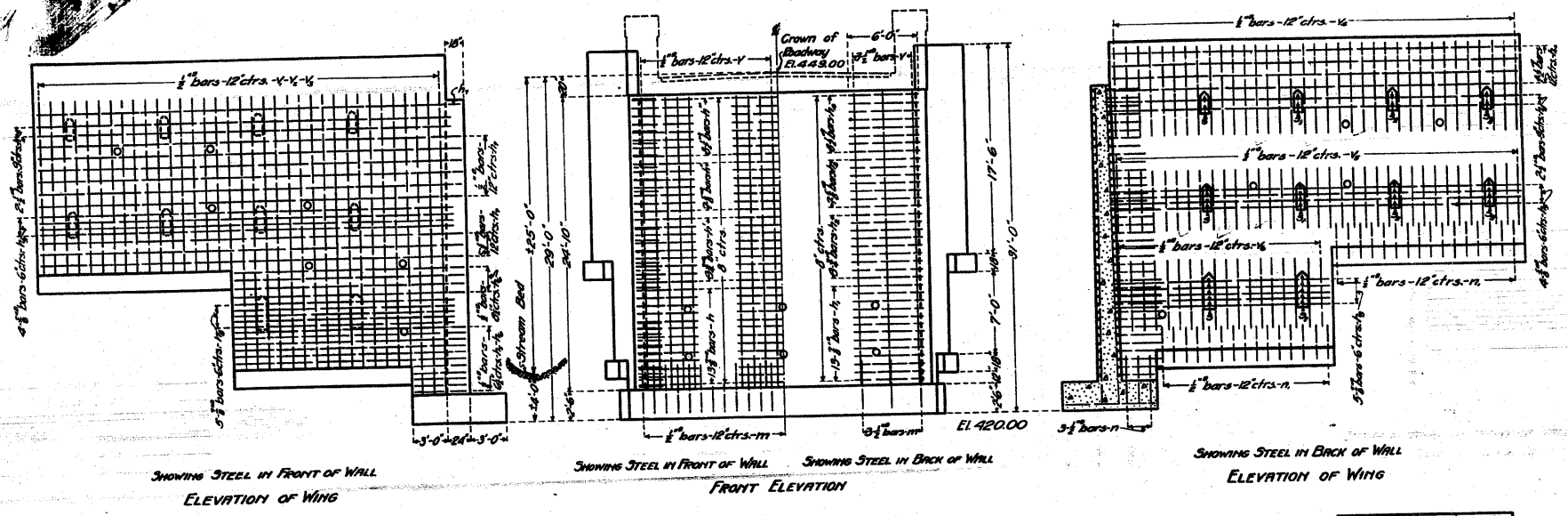

SHOWING STEEL IN FRONT OF WALL
ELEVATION OF WING

SHOWING STEEL IN FRONT OF WALL SHOWING STEEL IN BACK OF WALL
FRONT ELEVATION

SHOWING STEEL IN BACK OF WALL
ELEVATION OF WING

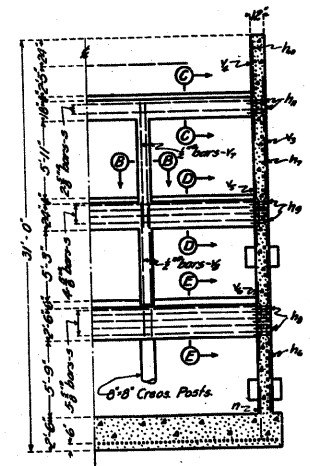

SECTION A



SECTION B

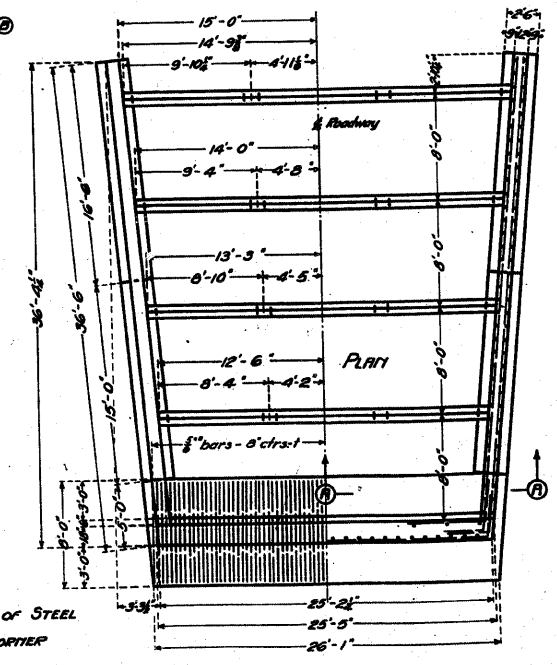

SECTION D

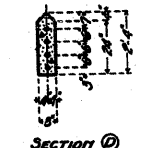

SECTION E

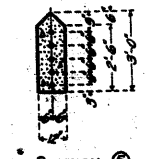

SECTION F

Bars	No.	Size	Length
v	64	1/2"	9'-6"
v	60	"	24'-6"
v	68	"	14'-6"
v	80	"	25'-0"
v	12	"	25'-6"
v	140	"	7'-6"
v	140	"	5'-0"
v	72	3/8"	6'-0"
h	26	3/8"	32'-0"
h	18	3/8"	31'-0"
h	14	3/8"	30'-0"
h	16	3/8"	29'-0"
h	52	3/8"	9'-6"
h	36	3/8"	9'-0"
h	28	3/8"	8'-6"
h	32	3/8"	8'-0"
h	20	"	6'-6"
h	40	"	21'-6"
h	80	"	20'-0"
h	40	3/8"	21'-0"
h	32	3/8"	37'-0"
h	32	3/8"	20'-0"
s	22	3/8"	28'-0"
s	22	3/8"	30'-0"
s	12	3/8"	31'-6"
s	12	3/8"	33'-0"
h	16	3/8"	37'-0"
m	62	1/2"	4'-0"
n	12	"	4'-0"
n	124	"	3'-0"
v	32	"	10'-0"
Steel-Lbs.			23100
Concrete-Cu.Yds.			286.5

Class A Concrete to be used throughout. Proportions 1:2 1/2:4

Sta. 365+63
Section 27B - Clinton Co.
F.A. Proj. 34

COMPUTED	A. H. Tager
CHECKED	A. H. Tager
DRAWN	A. H. F.
CHECKED	A. H. G.
ASSEMBLED	
CHECKED	
EXAMINED	May 23, 1952
PASSED	<i>[Signature]</i> BRIDGE ENGINEER
APPROVED	<i>[Signature]</i> ENGINEER OF DESIGN
	<i>[Signature]</i> CHIEF HIGHWAY ENGINEER

DETAIL OF STEEL IN CORNER

FOR INFORMATION ONLY

REVISIONS	
NAME	DATE

ILLINOIS DEPARTMENT OF TRANSPORTATION
EXISTING STRUCTURE PLAN
FAS ROUTE 1780
SECTION 27-1BR-1
CLINTON COUNTY
SN 014-0030 (E) 0077 (P)

PLOT DATE = 7/10/2007
FILE NAME = 60100101.dwg
REFERENCE = 44RETS