



LEGEND
 W1-4b-(0)-48
 (NO. OF ARROW SHALL MATCH THE NO. OF LANES OPEN TO TRAFFIC AND THE DIRECTION OF TRAVEL.)



W13-1-(0) -24



4' x 8'; 1" BORDER WITH 10" CAPITAL LETTERS
 BACKGROUND SHEETING SHALL BE THE SAME AS ALL DIAMOND SHAPED CONSTRUCTION SIGNS. (STATE OWNED)



W1-6(0) 7236 ATOP TYPE III BARRICADE
 (DIRECTION OF ARROW SHALL MATCH DIRECTION OF TRAVEL.)



G20-1103(0)-4830



LEGEND
 DRUM WITH STEADY BURNING LIGHT



DIRECTION INDICATOR BARRICADE WITH STEADY BURNING LIGHT



TYPE III BARRICADE WITH STEADY BURNING LIGHTS



TEMPORARY CONCRETE BARRIER



IMPACT ATTENUATORS

STAGE II DESCRIPTION OF WORK

TRAFFIC CONTROL SHALL BE INSTALLED AS SHOWN IN THE PLANS. THE COST OF THIS TRAFFIC CONTROL SHALL BE INCLUDED IN THE PAY ITEM "TRAFFIC CONTROL AND PROTECTION."

TWO LANES OF THE ROADWAY SHALL BE OPENED ON THE LEFT SIDE OF THE DIRECTION OF TRAFFIC.

SEQUENCE OF CONSTRUCTION, STAGE II

REMOVE SKIP-DASH AND CONFLICTING SOLID EDGE PAVEMENT MARKINGS.

PLACE TRAFFIC CONTROL DETAILS ACCORDING TO PLANS.

RELOCATE TEMPORARY CONCRETE BARRIER AND IMPACT ATTENUATORS, TEMPORARY.

PERFORM ALL NECESSARY BRIDGE WORK IN STAGE II WORK ZONE.

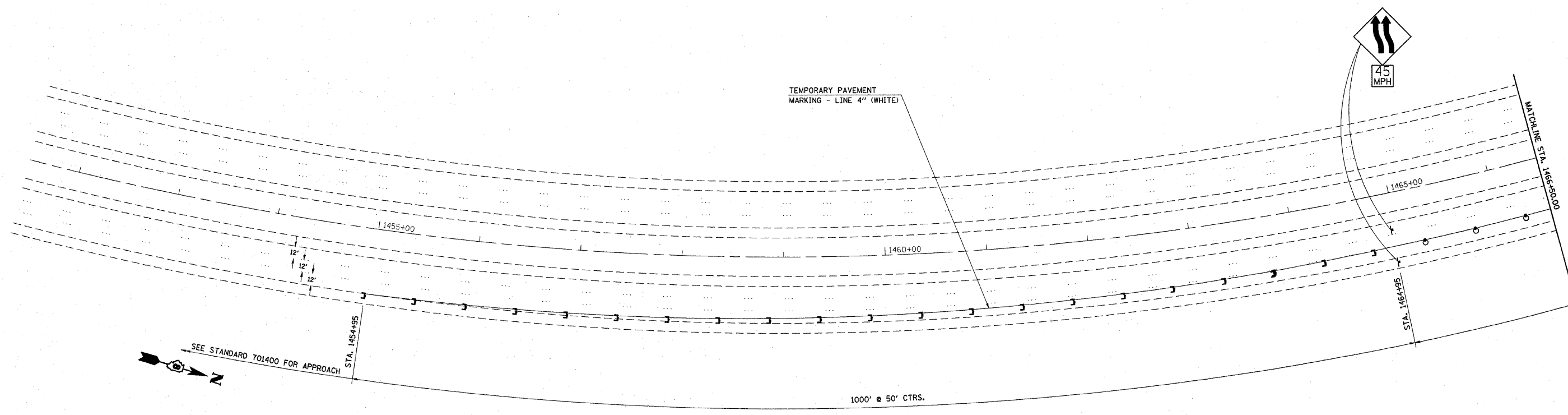

EXIST. CURVE 3
 PI STA. = 1459+11.93
 $\Delta = 64^\circ 55' 19''$ (LT)
 $D = 2^\circ 00' 00''$
 $R = 2,864.79'$
 $T = 1,822.33'$
 $L = 3,246.10'$
 $E = 530.49'$
 $E = \text{-----}$
 $T.R. = \text{-----}$
 $S.E. RUN = \text{-----}$
 $P.C. STA. = 1440+89.60$
 $P.T. STA. = 1473+35.70$

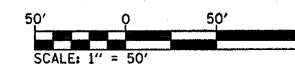

FILE NAME = c:\projects\ed06306\plan\stg06306cl.dgn	USER NAME = harbaughrd	DESIGNED -	REVISED -	STATE OF ILLINOIS DEPARTMENT OF TRANSPORTATION	STAGE II CONSTRUCTION, NORTH BOUND	F.A.I. RTE.	SECTION	COUNTY	TOTAL SHEETS	SHEET NO.	
		DRAWN -	REVISED -			255	60-8B-II	MADISON	42	13	
		PLLOT SCALE = 50.0000 / IN.	CHECKED -			SCALE: 50 SHEET NO. 13 OF 42 SHEETS STA. 1451+50 TO STA. 1466+50					
		PLLOT DATE = 12/28/2007	DATE -			FED. ROAD DIST. NO. ILLINOIS FED. AID PROJECT					
						CONTRACT NO. 76A25					