

STATE OF ILLINOIS  
DEPARTMENT OF TRANSPORTATION

ROUTE NO.	SECTION	COUNTY	TOTAL SHEETS	SHEET NO.	SHEET NO. 5
S.B.I. F.A.I. 255	60-8B-II	Madison	27	42	14 SHEETS
FED. ROAD DIST. NO. 7	ILLINOIS	FED. AID PROJECT			

Contract # 76A25

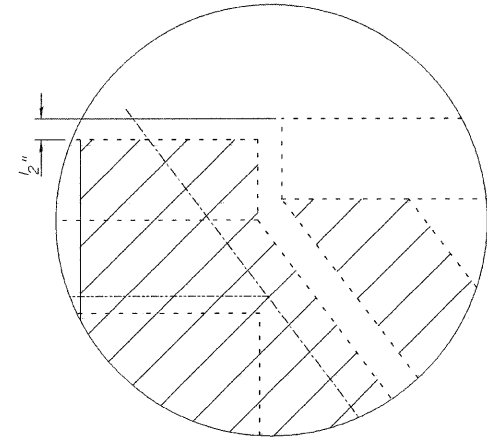
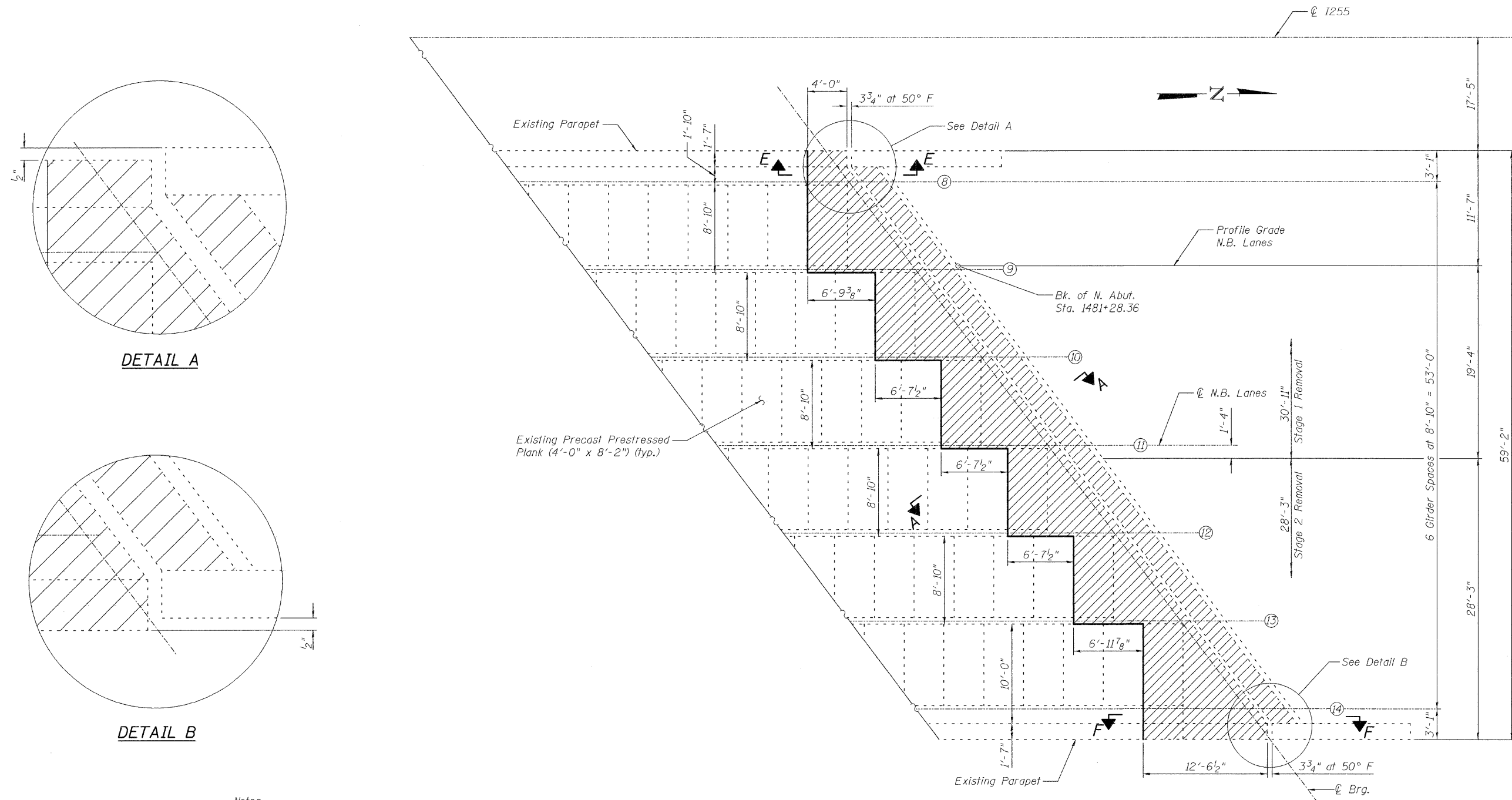

DETAIL A

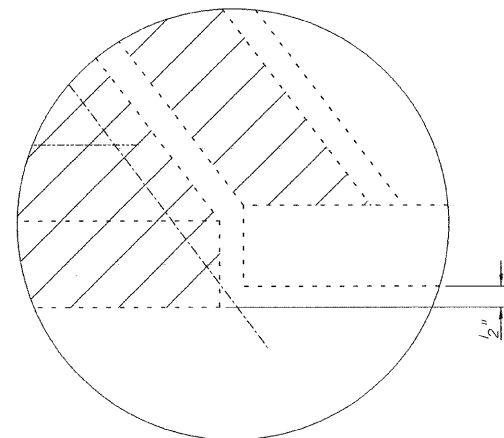

DETAIL B

Notes:  
Existing reinforcement extending into the removal area shall be cleaned, straightened and incorporated into the new construction. Any reinforcement bars that are damaged during concrete removal shall be replaced with an approved bar splicer or anchorage system. Cost shall be included with Concrete Removal.  
Hatched areas indicate Concrete Removal.  
Dimensions along outside parapets are measured along inside face of parapet. See Sheet No. 10 of 14 for Superstructure Bill of Material.  
See Sheet No. 12 of 14 for existing Section A-A.  
Contractor shall verify location of existing precast prestressed plank joints prior to removal.  
See Sheet No. 12 of 14 for concrete removal at North Abutment.  
See Sheet No. 10 of 14 for Fore View E-E & F-F.

PARTIAL PLAN  
at North Abut. N.B. Lanes

SUPERSTRUCTURE DECK AND  
PARAPET REMOVAL NORTHBOUND LANES  
F.A.I. RTE. 255 OVER CAHOKIA CANAL  
SECTION 60-8B-II  
STATION 1479+10.00  
MADISON COUNTY  
S.N. 060-0218 & 0219

DESIGNED	DB
CHECKED	RS
DRAWN	CLS
CHECKED	WWH