

STATE OF ILLINOIS  
DEPARTMENT OF TRANSPORTATION

ROUTE NO.	SECTION	COUNTY	TOTAL SHEETS	SHEET NO.	SHEET NO. 7 14 SHEETS
S.B.I. F.A.I. 255	60-8B-II	Madison	29	42	
FED. ROAD DIST. NO. 7	ILLINOIS	FED. AID PROJECT-			
Contract # 76A25					

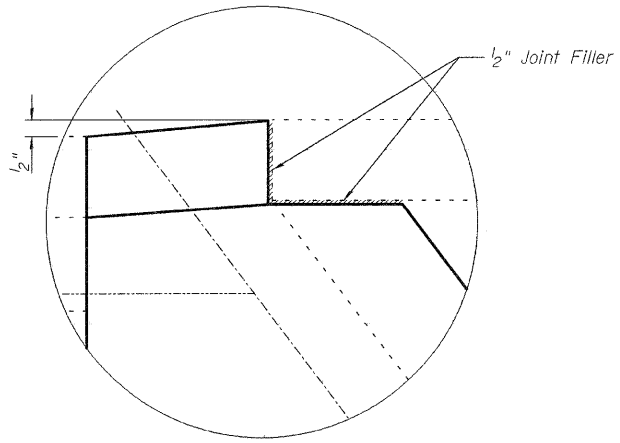

DETAIL A

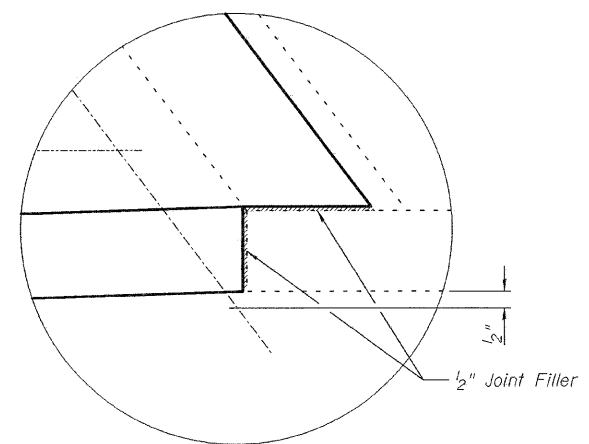

DETAIL B

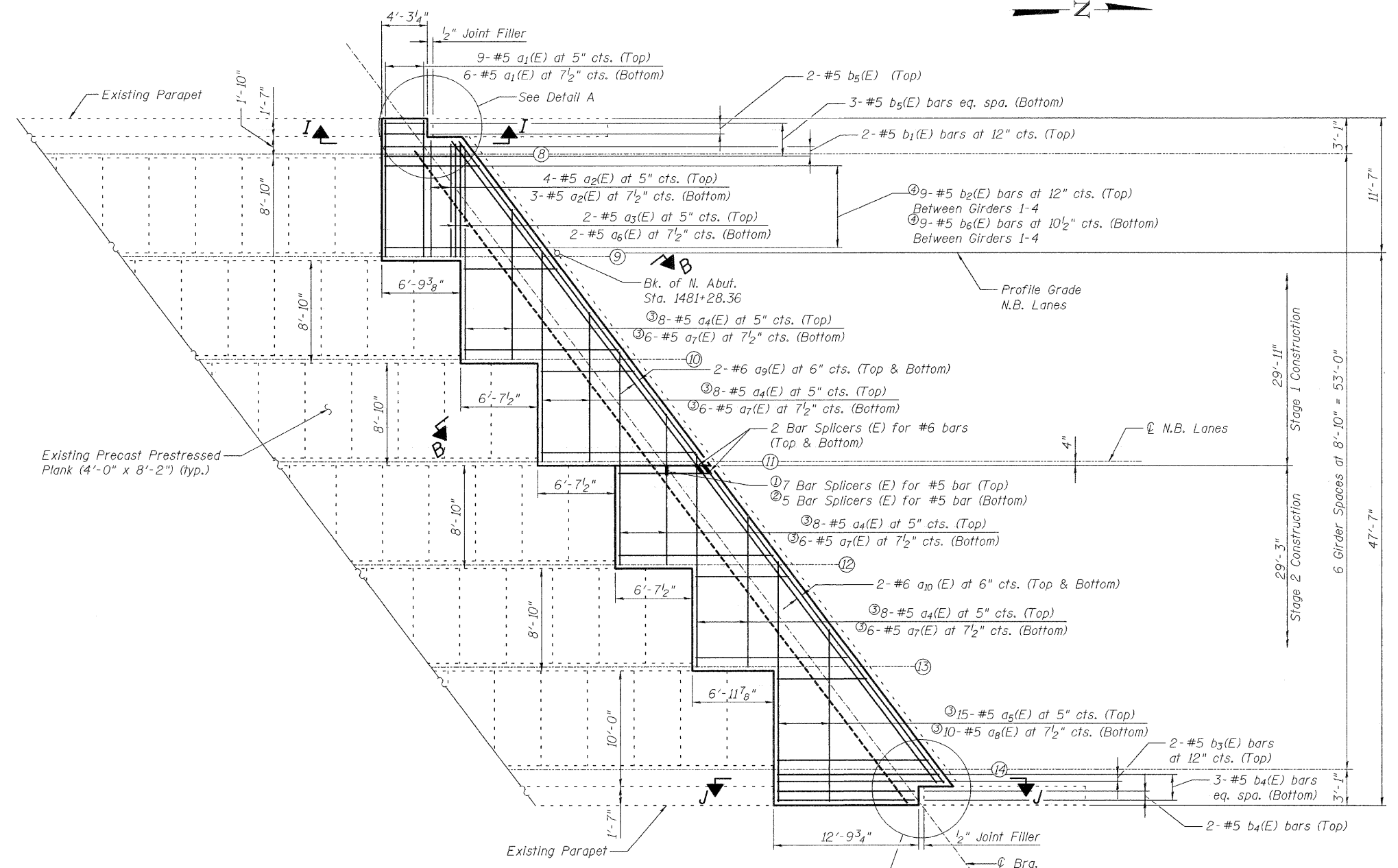

PARTIAL PLAN  
at North Abut. N.B. Lanes

MIN BAR LAPS	
#5	2'-2"
#6	2'-7"

DESIGNED	DB
CHECKED	RS
DRAWN	CLS
CHECKED	WWH

Notes:  
Existing reinforcement extending into the removal area shall be cleaned, straightened and incorporated into the new construction. Any reinforcement bars that are damaged during concrete removal shall be replaced with an approved bar splicer or anchorage system. Cost shall be included with Concrete Removal. Dimensions along outside parapets are measured along inside face of parapet. See Sheet No. 10 of 14 for Superstructure Bill of Material. See Sheet No. 12 of 14 for proposed Section B-B. Contractor shall verify location of existing precast prestressed plank joints prior to removal. See Sheet No. 10 of 14 for View I-I & J-J.

- ① Lap bar splicer with top "a bars". Cut top "a bars" to fit Stage 1 and use remainder in Stage 2.
- ② Lap bar splicer with bottom "a bars". Cut bottom "a bars" to fit Stage 1 and use remainder in Stage 2.
- ③ Order bars full length. Cut to fit wedge (skew). Use remainder in same wedge.
- ④ Order bars full length. Cut to fit wedge (skew). Use remainder between girders 11-14.

**SUPERSTRUCTURE DECK & PARAPET  
REPLACEMENT NORTHBOUND LANES  
F.A.I. RTE. 255 OVER CAHOKIA CANAL  
SECTION 60-8B-II  
STATION 1479+10.00  
MADISON COUNTY  
S.N. 060-0218 & 0219**